



FOR LEASE

2500 Dinneen Ave,
Orlando, FL 32804



Total Square Feet:	8,000 ± SF
Warehouse:	7,700 ± SF
Office:	300 ± SF
Clear Height:	16'
Doors:	(2) Grade 12'x 13'
Power:	3 Phase
Zoning:	ORL-I-G/W
Annual Rent PSF	\$14.00/SF NNN
Operating Expenses	Call for details

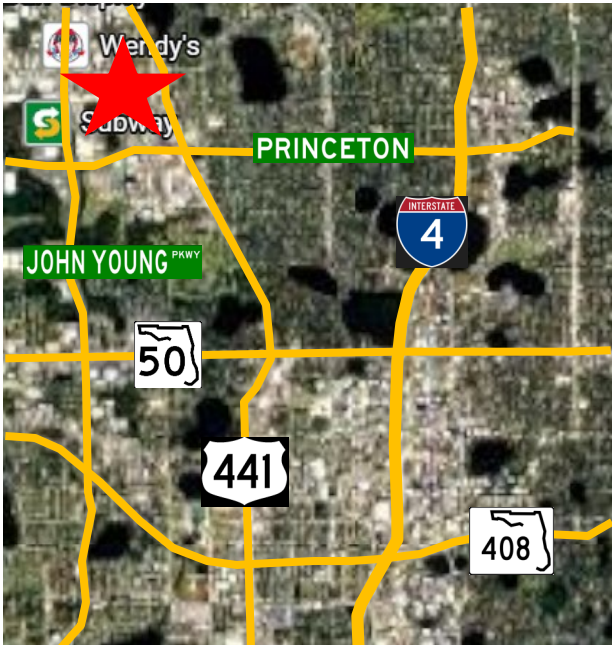

McNulty Group, Inc. is the agent of the Landlord or Seller of this property and will be paid by the Landlord or Seller. All information furnished with respect to the subject property has been obtained from sources deemed reliable. No representation as to accuracy thereof is made. This offering is subject to errors, omissions, prior sales or withdrawal without notice.

Eugene Kwak
Sales Associate
Eugene@mcnultygroupinc.com
(321) 278-5372 Direct

McNulty Group Inc.
2315 Lynx Lane, Suite 6
Orlando, Florida 32804
407-532-3441



McNulty Group
Incorporated

FOR LEASE

2500 Dinneen Ave

Orlando, FL 32804

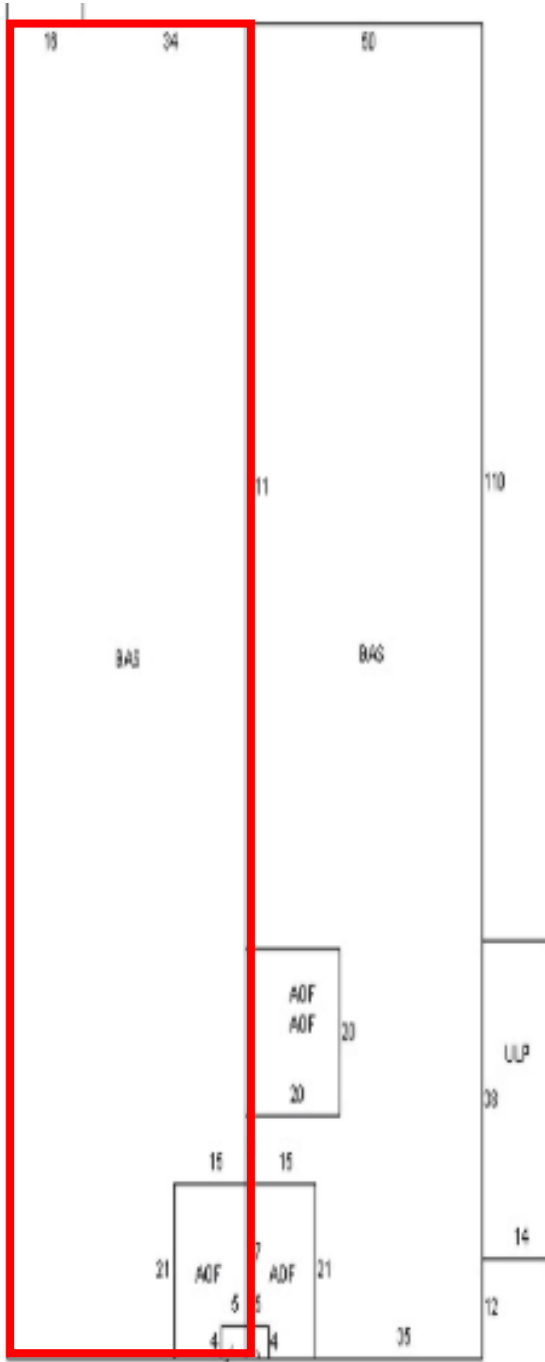

Eugene Kwak

Sales Associate

Eugene@mcnultygroupinc.com

(321) 278-5372 Direct

mcnultygroupinc.com

McNulty Group Inc.

2315 Lynx Lane, Suite 6

Orlando, Florida 32804

407-532-3441