

63,968 SF

Industrial Space For Lease



Prologis iPort | 8001 Industrial Avenue



8001 Industrial Avenue
Carteret, NJ 07008 USA

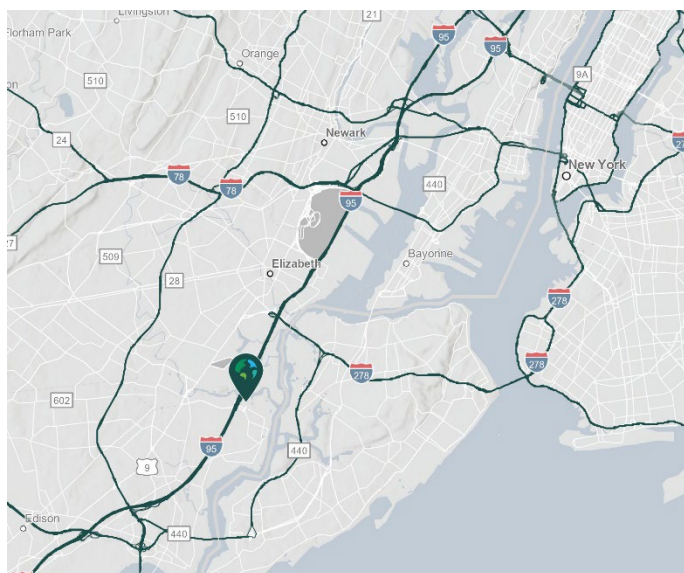

LOCATION

- Immediate access off Exit 12 of the NJ Turnpike
- ± 13 miles from Port Newark-Elizabeth
- ± 10 miles from Newark Liberty International Airport

FACILITY

- 200,218 SF total building size
- 63,968 SF available space
- 5,672 SF office
- 36' clear height
- 72' 6" x 80' column spacing
- 5 dock doors
- 1 drive-in door
- 22 car parking spaces
- 800 amps, 600-volt, 3-phase electrical service
- ESFR sprinkler system

ADVANTAGES AND AMENITIES

- Fast, cost-effective forklift and racking sourcing through Prologis Essentials
- Prologis Clear Lease® – Know your lease expenses and capital costs with greater certainty before you sign

Your single-source service for efficient move-in and operations: [prologisessentials.com](https://www.prologisessentials.com)



Scan the QR code for more info!

63,968 SF

Industrial Space For Lease



Prologis iPort | 8001 Industrial Avenue

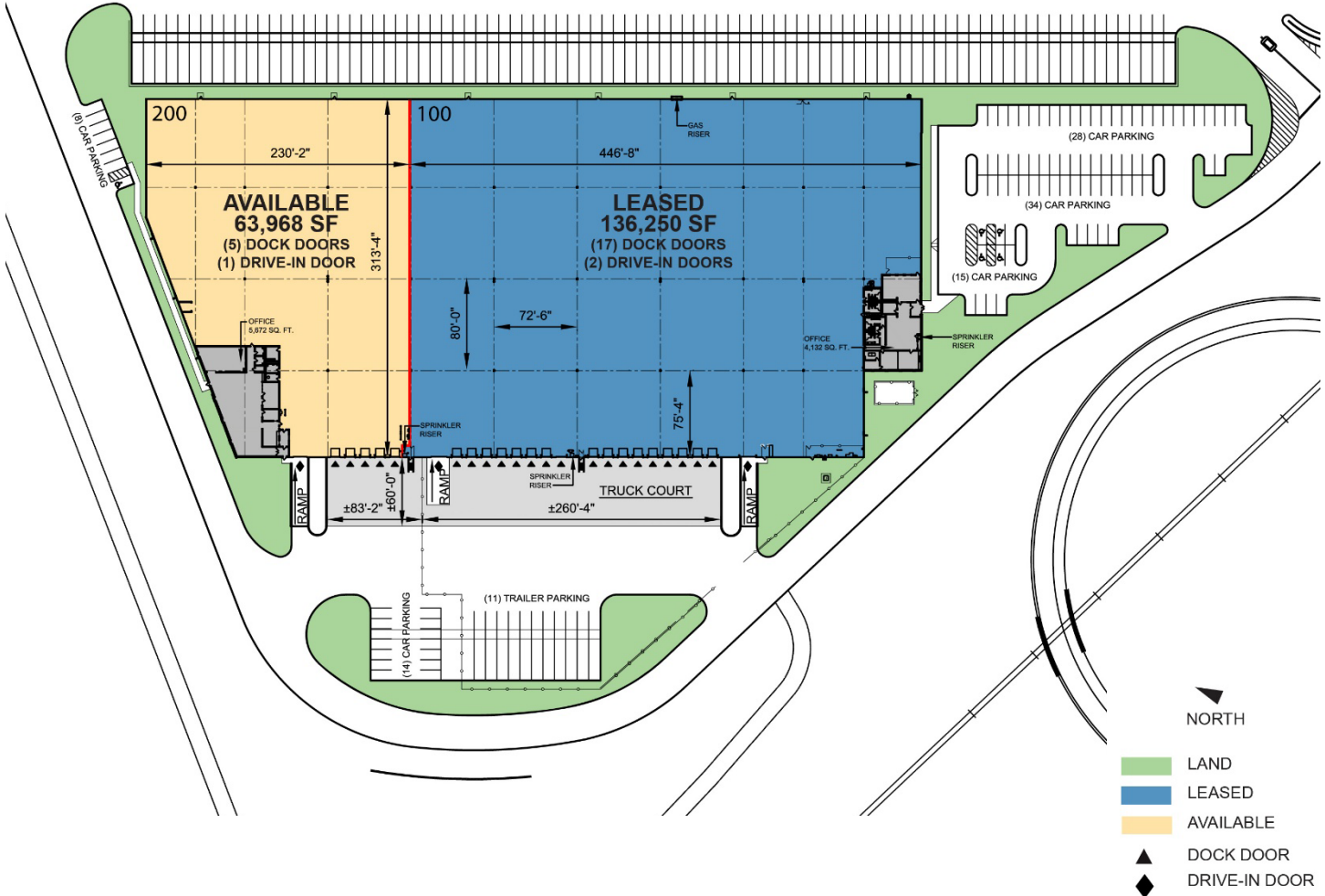

NEWMARK

Newmark

Kyle Eaton
Kyle.eaton@nrmk.com
ph +1 732 867 9001
cell +1 908 902 8354
1 Tower Center Boulevard
Suite 1201
East Brunswick, NJ 08816 USA

Newmark

Rob Loderstedt
Robert.loderstedt@nrmk.com
ph +1 732 867 9001
cell +1 973 998 1093
1 Tower Center Boulevard
Suite 1201
East Brunswick, NJ 08816 USA

Newmark

Michael Schipper
Michael.schipper@nrmk.com
ph +1 732 867 9001
cell +1 973 936 4173
1 Tower Center Boulevard
Suite 1201
East Brunswick, NJ 08816 USA

Prologis

Paul Rosen
prosen@prologis.com
ph +1 201 635 6013
cell +1 201 306 1332
One Meadowlands Plaza
Suite 100
East Rutherford, NJ 07073 USA