

NEW MIXED USE DEVELOPMENT



Hallmark

Fanwood Bagels

FANWOOD CROSSING  
28 UNITS

STATION SQUARE  
AT FANWOOD  
35 UNITS

Kessler  
INSTITUTE FOR REHABILITATION

Seng Couture

Provident BANK

SHELEN'S  
AT THE CROSSING  
PUB & RESTRO

Edward Jones

RAILSIDE  
CAFE

fabio's bistro  
PIZZA PASTA

NTRANSIT  
The Way To Go

Ginger  
Sushi

GOLDEN  
HANGER  
CLEANERS



DUNKIN'

SOUTH AVE. 8,270 VPD

MARTINE AVE. 9,216 VPD

Charles  
Studio  
Hair & Color Design

Well  
Groomed

CHELSEA  
SENIOR LIVING

Share  
Left

Scotchwood  
FLORIST

DELIVERY  
SUMMER 2024



JEFFERY REALTY  
Retail Specialist

the  
SOHO  
AT FANWOOD STATION

282 SOUTH AVE. | FANWOOD, NJ  
THE SOHO AT FANWOOD STATION

SHANE WIERKS | swierks@jefferyrealty.com  
C: 908.581.7781 O: 908.668.9600 x223

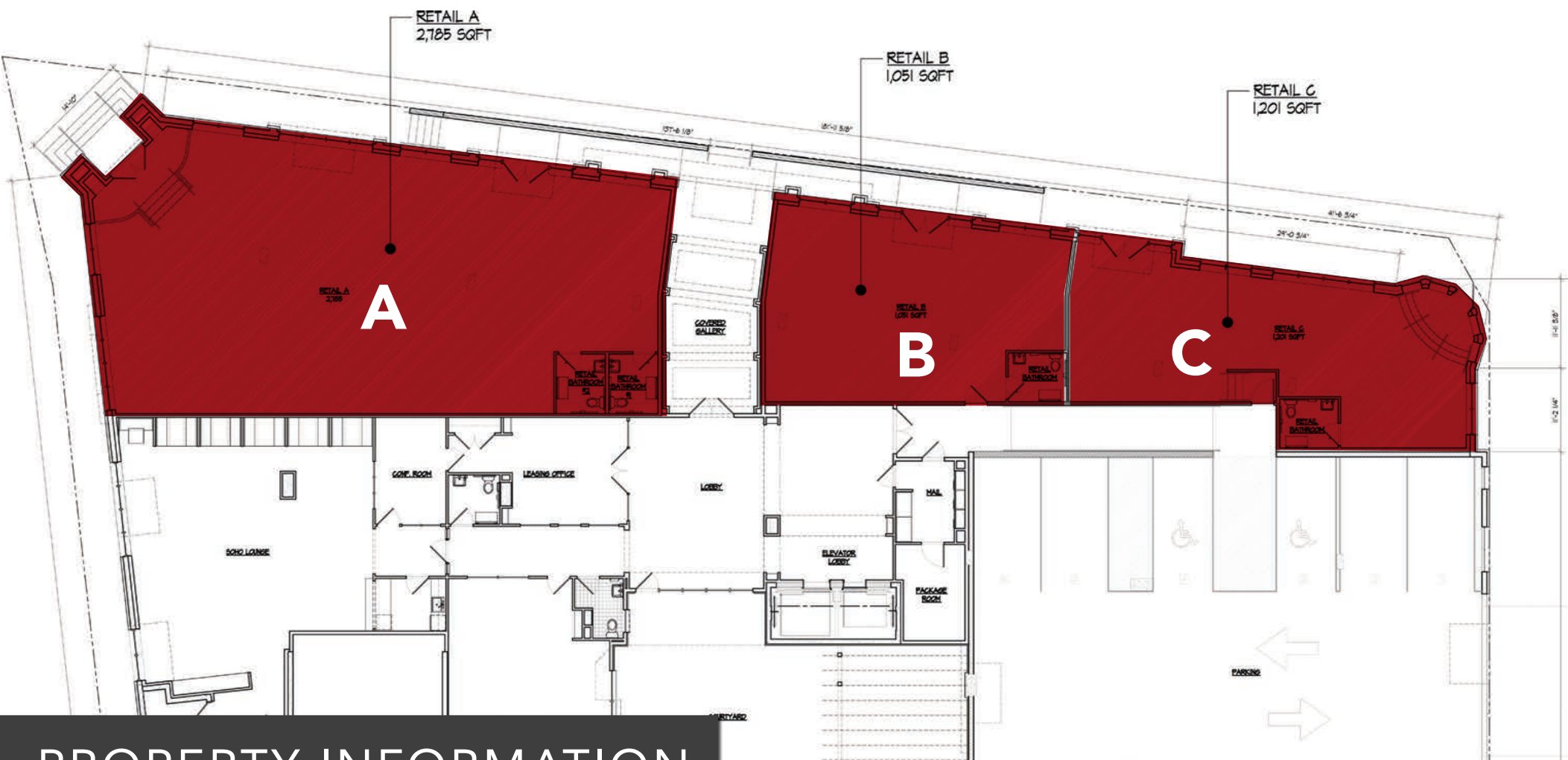

## PROPERTY INFORMATION

- **Total retail square footage: 5,037 demisable into 3 (possibly 4) areas.**
- **Retail A on western side—2,785 SF**
- **Retail B in middle—1,051 sf**
- **Retail C on eastern side—1,201 sf**
- Build to suit and custom work available
- Attractive storefront, signage, awning, lighting

- Located in Fanwood's downtown central commercial corridor referred to as South Ave
- Dedicated retail parking spaces
- Steps from Fanwood's NJ Transit train station
- Fanwood located within Scotch Plains, near Westfield. Convenient to Parkway, Rt 22, Turnpike, etc
- Target opening Fall 2023





## RENDERINGS



ALL INFORMATION IN THIS BROCHURE IS FROM SOURCES DEEMED RELIABLE AND IS SUBMITTED SUBJECT TO ERRORS, OMISSIONS, CHANGE OF PRICE, TERMS, PRIOR SALES AND WITHDRAWALS.



**SHANE WIERKS** | [swierks@jefferyrealty.com](mailto:swierks@jefferyrealty.com)  
C: 908.581.7781 O: 908.668.9600 x223

