

AVAILABLE
±2,347 RSF
(2,275 USF)



4209-4213

FIRST STREET | LIVERMORE, CA

retailwest

RETAIL WEST
HILARY PARKER
925.400.9930 ext 700
hparker@retailwestinc.com

DRE 01760862



JOIN THESE TENANTS & MORE:



4209-4213

FIRST STREET | LIVERMORE, CA

- ±2,347 SF for lease next to Dave's Hot Chicken
- Stand-alone pad building at First Street (31,153 ADT) & Mines Road (20,037 ADT)
- Co-tenants include Lowe's, Panda Express, Great Clips & Subway
- Adjacent to busy Safeway anchored Arroyo Park Shopping Center (15th busiest Safeway in California)
- Easy access to I-580 (201,163 CPD)





AVAILABLE
±2,347 RSF
 (2,275 USF)

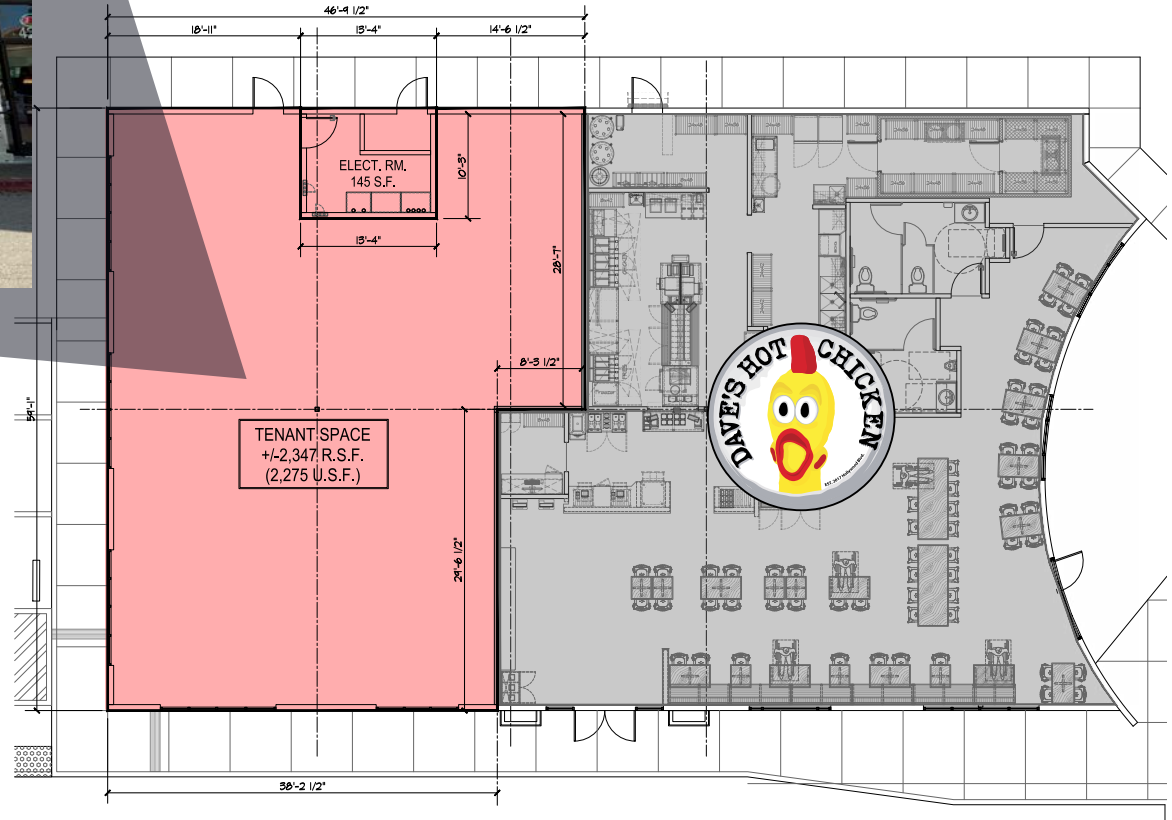

2025 DEMOGRAPHIC HIGHLIGHTS

\$1.04M

MEDIAN
 HOME VALUE
 (within 1 mile)

+48K

DAYTIME
 EMPLOYEES
 (within 5 miles)

\$197K

AVG. HH
 INCOME
 (within 1 mile)

580 201,163 ADT

36,588 ADT

PLAZA 580

TARGET ROSS DRESS FOR LESS
 TJ-maxx PETCO BIG LOTS!
 DOLLAR TREE BIG 5 SPORTING GOODS FedExOffice
 crumbl cookies BOOT BARN

IHOP Panera BREAD CHIPOTLE



CHASE

BevMo!

CVS pharmacy



SAFeway
1.9 Million annual visits

PANDA EXPRESS Great Clips SUBWAY



LOWE'S
691K annual visits

31,153 ADT 1st Street



20,037 ADT



SITE

retailwest



Neighboring tenant Chili's



Neighboring tenants



Anchored by Lowe's



ARROYO PLAZA



Walmart
OfficeMax
THE HOME DEPOT
IN-N-OUT BURGER



KOHL'S

PLAZA 580



TARGET ROSS DRESS FOR LESS
TJ-MAXX PETCO BIG LOTS!
DOLLAR TREE BIG 5 SPORTING GOODS SEPHORA

ARROYO SECO



CHIPOTLE
Panera BREAD
IHOP

ARROYO PARK



LOWE'S SAFEWAY
BevMo! CVS pharmacy
PANDA EXPRESS STARBUCKS PEPPERCORN

SITE

TRADER JOE'S
Michaels



SAFEWAY
PETCO CVS pharmacy

PEPPERTREE PLAZA



NOB HILL FOODS

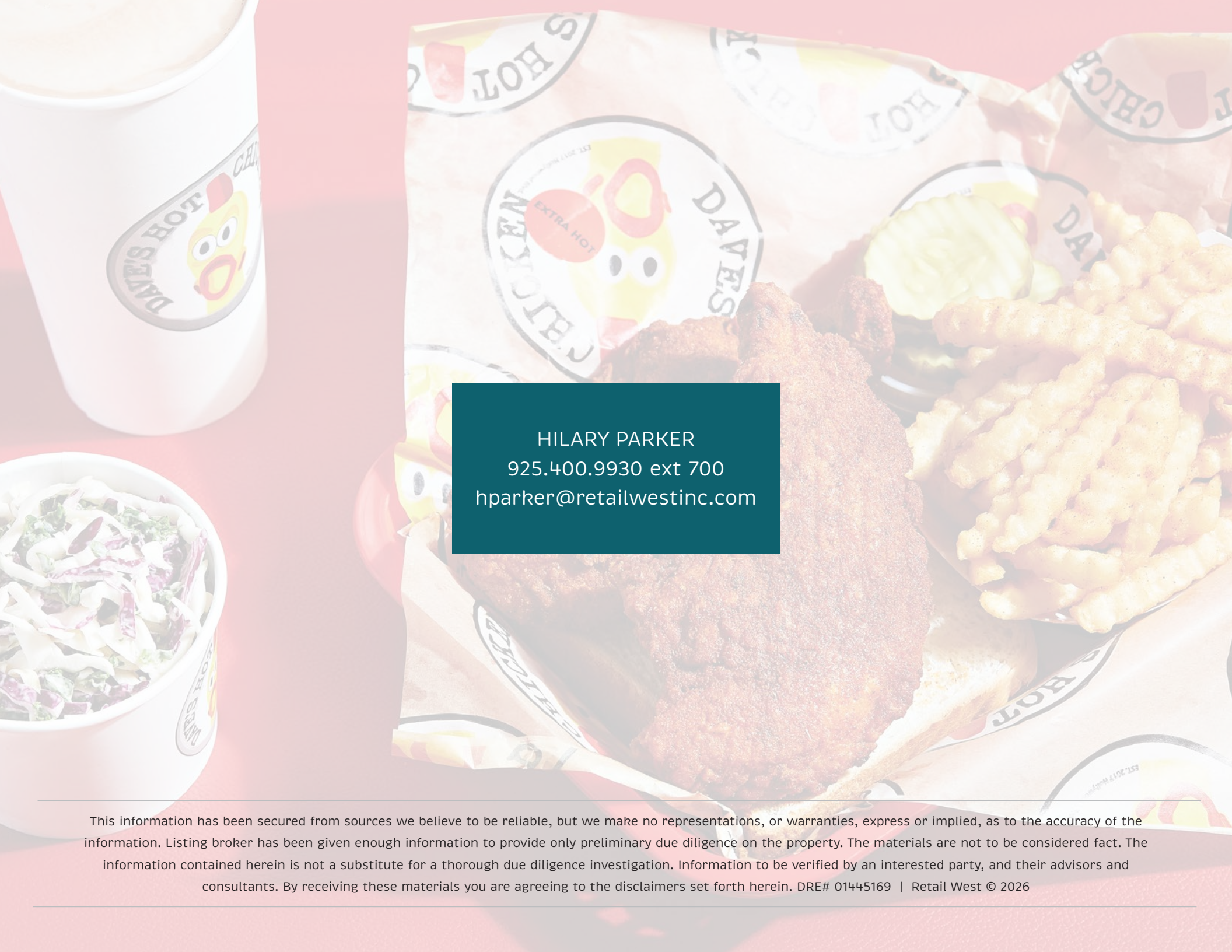

HILARY PARKER
925.400.9930 ext 700
hparker@retailwestinc.com

This information has been secured from sources we believe to be reliable, but we make no representations, or warranties, express or implied, as to the accuracy of the information. Listing broker has been given enough information to provide only preliminary due diligence on the property. The materials are not to be considered fact. The information contained herein is not a substitute for a thorough due diligence investigation. Information to be verified by an interested party, and their advisors and consultants. By receiving these materials you are agreeing to the disclaimers set forth herein. DRE# 01445169 | Retail West © 2026