

Exceptionally Well Connected
Leasing Opportunity



2001 / 2005
SHEPPARD AVENUE EAST

NORTH YORK

taylor+ CBRE

	2001 Sheppard Ave E	2005 Sheppard Ave E
Net Rent	\$16.00 per SF	\$16.00 per SF
Operating Costs	\$14.61 per SF	\$15.00 per SF
Realty Taxes	\$4.79 per SF	\$4.31 per SF
Additional Rent (2024 EST)	\$19.40 per SF	\$19.31 per SF
Parking	3 per 1,000 SF @ \$55 per month	3 per 1,000 SF @ \$55 per month

2001 Sheppard Ave E

Suite	SF	Availability
104	Click here For Floorplan 1,246	Immediate
200	Click here For Floorplan 6,457	Immediate
204	1,732	Immediate
401	Click here For Floorplan 8,906	Immediate
506	Click here For Floorplan 2,320	Immediate
800A (Model Suite)	Click here For Floorplan 5,396	Immediate
800B	Click here For Floorplan 3,823	Immediate
810	Click here For Floorplan 10,876	Immediate

LEASED

**POTENTIAL FULL FLOOR AVAILABILITY
up to +/-20,000 SF**

2005 Sheppard Ave E

Suite	SF	Availability
102	2,716	Immediate
120	2,195	Immediate
200	Click here For Floorplan 17,731	Immediate
400	Click here For Floorplan 8,733	Immediate
401	Click here For Floorplan 3,816	Immediate
402	4,874	Immediate
403	Click here For Floorplan 2,916	Immediate
503 (Model Suite)	Click here For Floorplan 1,588	Immediate
600	Click here For Floorplan 4,972	Immediate
603	Click here For Floorplan 1,600	Immediate
700	15,315	Immediate
702	Click here For Floorplan 3,333	Immediate

LEASED

LEASED

LEASED

LEASED

LEASED



Heron's Hill

A premier, two building office complex located at the major intersection of highways 401/404, offering excellent exposure and accessibility.

Combining high efficiency Class A office space with prime tenant amenities, such as day care, fitness centre and outdoor green spaces, Heron's Hill is an exceptional choice for companies looking for an enhanced tenant experience in a superb central GTA location.

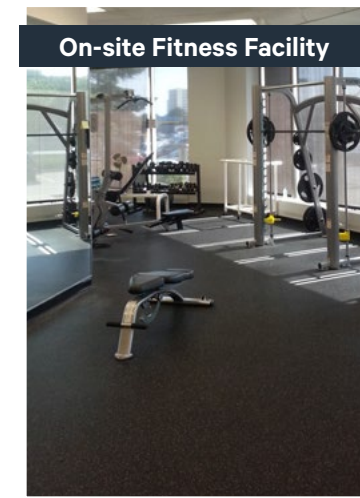

2001 Sheppard Avenue E. Unit 800A 5,396 SF

- Brand new model suite
- Exposed ceiling
- Glass offices
- New LED lighting
- Polished Concrete Reception
- Kitchenette

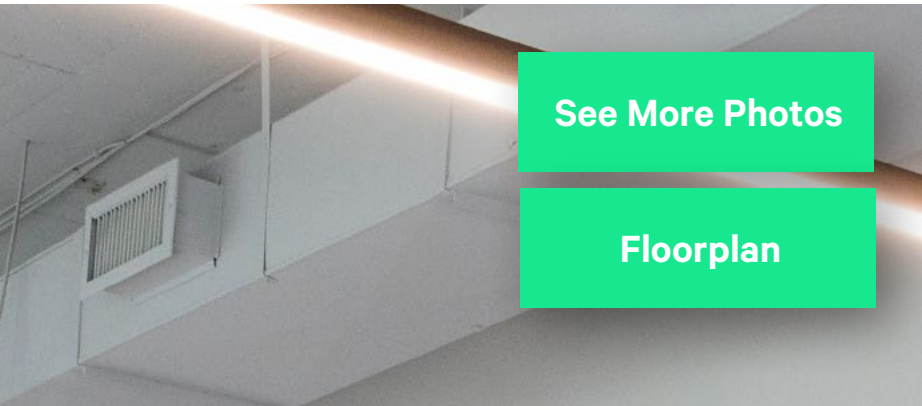

2005 Sheppard Avenue E. Unit 503 1,588 SF

[See More Photos](#)

[Floorplan](#)

- Brand new model suite
- Boardroom and offices on glass
- Kitchenette
- Open space for workstations

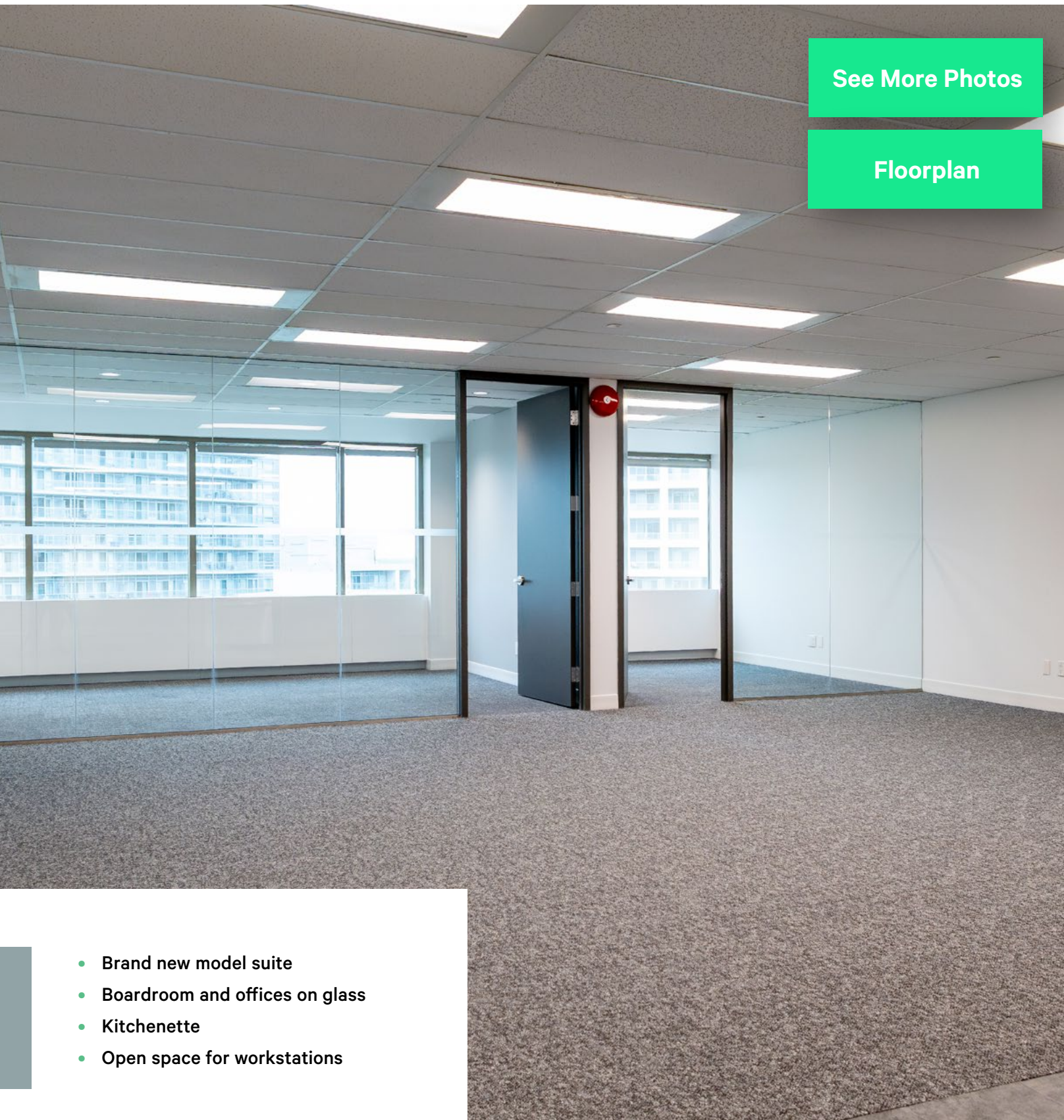

Suite 503 • 2005 Sheppard Ave. E



Suite 503 • 2005 Sheppard Ave. E

Area Map & Amenities

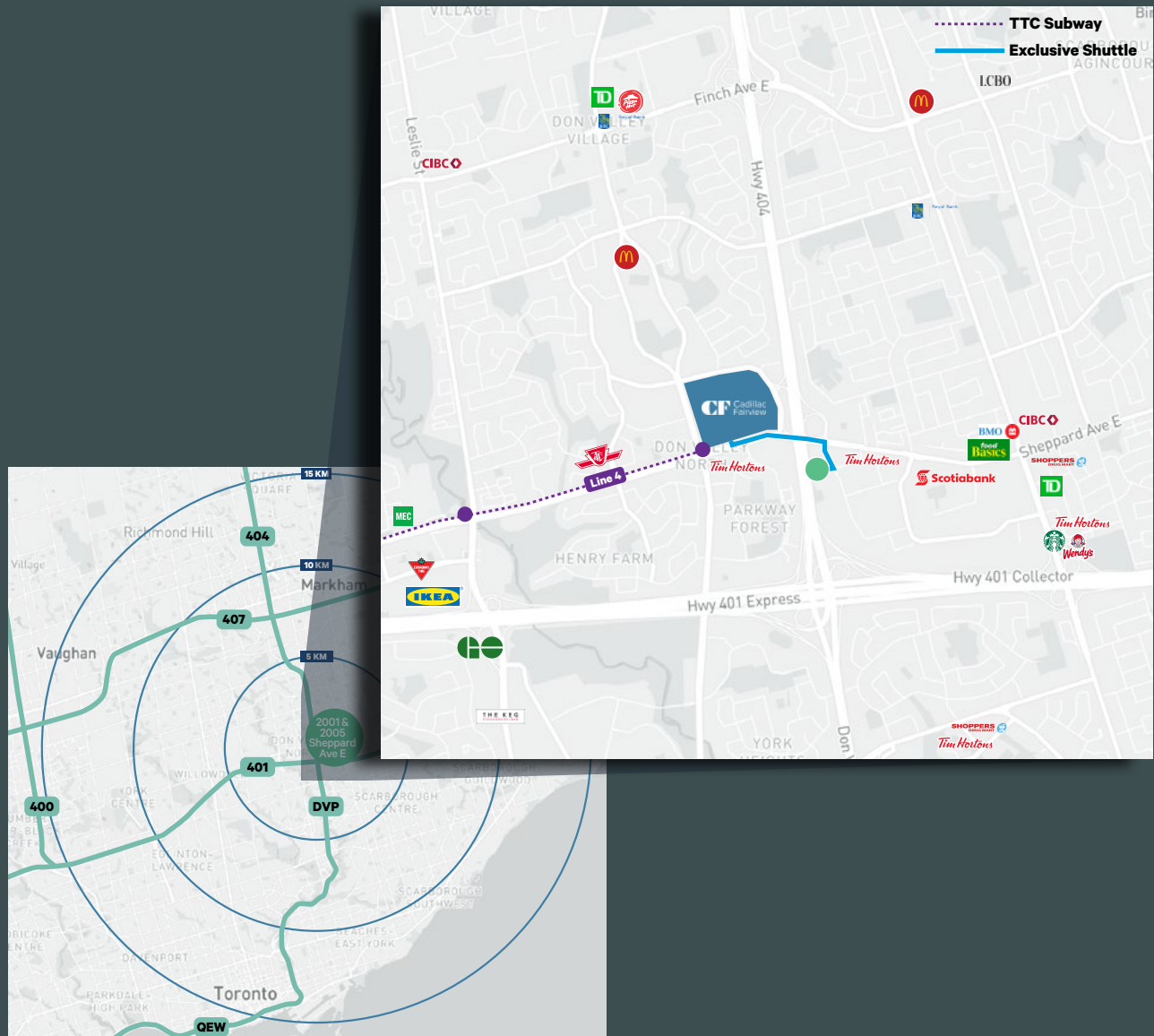

CBRE

taylor+

For More Information, Please Contact:

Tony Gill*
Executive Vice President

(416) 495-6261
tony.gill@cbre.com

Miles Kettner*
Senior Vice President

(416) 495-6238
miles.kettner@cbre.com

Bryant Wilson*
Vice President

(416) 495-6278
bryant.wilson@cbre.com

Michelle Saberon*
Senior Transaction Manager

(416) 495-6318
michelle.saberon@cbre.com

*Sales Representative

This disclaimer shall apply to CBRE Limited, Real Estate Brokerage, and to all other divisions of the Corporation; to include all employees and independent contractors ("CBRE"). The information set out herein, including, without limitation, any projections, images, opinions, assumptions and estimates obtained from third parties (the "Information") has not been verified by CBRE, and CBRE does not represent, warrant or guarantee the accuracy, correctness and completeness of the Information. CBRE does not accept or assume any responsibility or liability, direct or consequential, for the Information or the recipient's reliance upon the Information. The recipient of the Information should take such steps as the recipient may deem necessary to verify the Information prior to placing any reliance upon the Information. The Information may change and any property described in the Information may be withdrawn from the market at any time without notice or obligation to the recipient from CBRE. CBRE and the CBRE logo are the service marks of CBRE Limited and/or its affiliated or related companies in other countries. All other marks displayed on this document are the property of their respective owners. All Rights Reserved. Mapping Sources: Canadian Mapping Services canadamapping@cbre.com; MapPoint, DMTI Spatial, Environics Analytics, Microsoft Bing, Google Earth.