

35

TECHNOLOGY DRIVE

WARREN, NEW JERSEY

BIO-TECH/LAB & OFFICE SPACE AVAILABLE

AVAILABLE

10,000 - 55,700 SF

BUILDING SIZE

107,416 SF

YEAR BUILT/RENOVATED

1986/2020-2021

ELECTRICAL SERVICE

3 PHASE, 4 WIRE, 277 AMP, 480 VOLT

PARKING RATIO

3.5/1,000 SF

GUARANTEED ABSOLUTE LOWEST MARKET PRICING



Colliers

NEIGHBORING TENANTS



STRATEGICALLY LOCATED

| | |
|--------------------------|------------|
| I-78 | 15 Miles |
| Millington Train Station | 4.0 Miles |
| Route 22 | 5.0 Miles |
| Dunellen Train Station | 6.7 Miles |
| Route 28 | 6.9 Miles |
| I-287 | 7.0 Miles |
| Route 202 | 7.3 Miles |
| Rutgers University | 14.6 Miles |
| New Jersey Turnpike | 15.9 Miles |
| Garden State Parkway | 18.1 Miles |
| Newark Airport | 22.7 Miles |
| Newark Penn Station | 23.8 Miles |
| Princeton University | 26.3 Miles |
| Manhattan | 31.2 Miles |



AREA AMENITIES

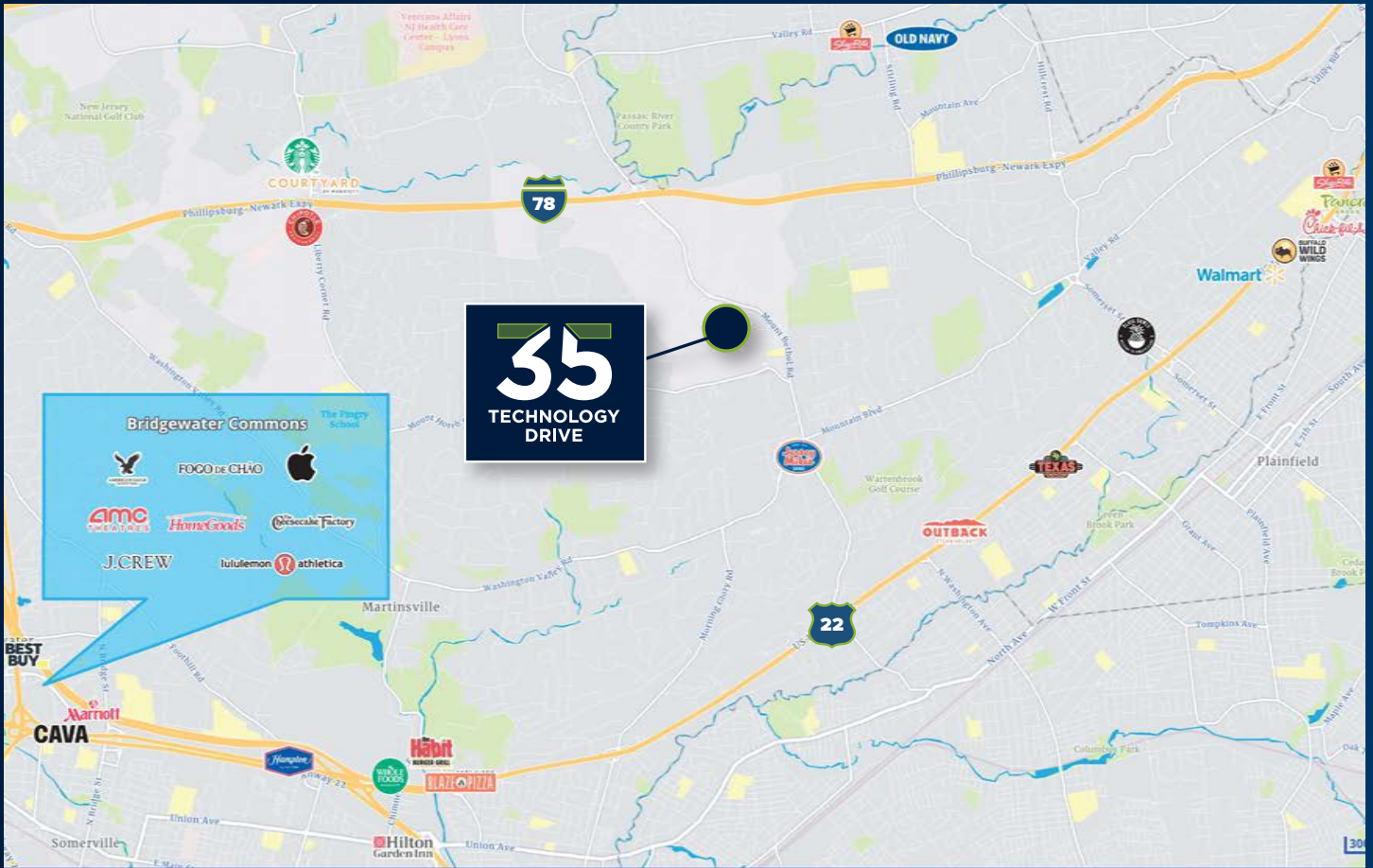

SECOND FLOOR

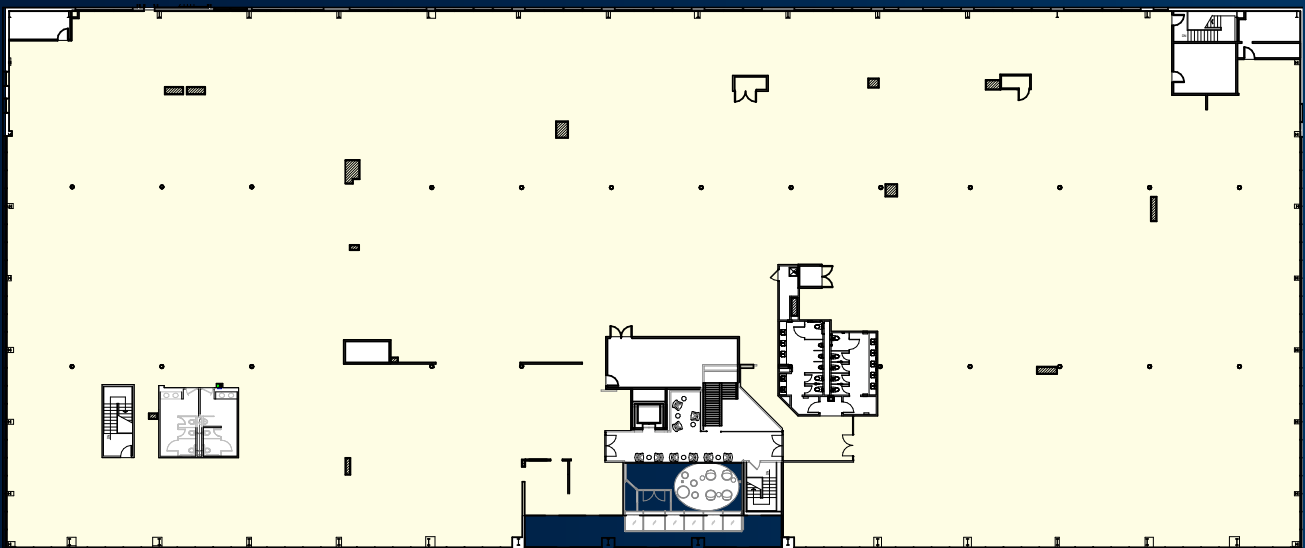



DOUG TWYMAN, SIOR
Licensed Broker Salesperson
+1 732 236 8899 (C)
doug.twyman@colliers.com

35
**TECHNOLOGY
DRIVE**
WARREN, NEW JERSEY

CHIDI EGESIONU
Licensed Salesperson
+1 732 734 0492 (D)
chidi.egesionu@colliers.com



COLLIERS INTERNATIONAL NJ LLC
10 WOODBRIDGE CENTER DRIVE, SUITE 1010
WOODBRIDGE, NJ 07095
732 807 0400

No representation is made as to the accuracy of the information furnished herein and same is submitted subject to errors, omissions, change of prices, rental, or other conditions, prior sale, lease, sublease, and/or withdrawal without notice. While every attempt is made to ensure accuracy, the floor plan(s) is for guidance only. The measurements, dimensions, specifications, and other data shown are approximate and may not be to scale. We assume no responsibility for the accuracy of the floor plan(s) or for any action taken in reliance thereon. The floor plan(s) do not create any representation, warranty or contract. All parties should consult a professional, such as an architect, to verify the information contained herein. The furnishing of this information shall not be deemed a hiring. A commission in accordance with our principal's schedule of rates and conditions will be paid to the procuring Broker who executes our or our principal's brokerage agreement, subject to a fully consummated transaction upon terms and conditions acceptable to our principal. Colliers International NJ LLC