

FOR LEASE

4275 N. PALM ST.

FULLERTON | CA 92835



Suite 200
±69,032 SF±3,000 SF Office Space

RANDY ELLISON

Executive Director
Direct +1 949 930 4371
randy.ellison@cushwake.com
Lic #01469586

BRETT LOCKWOOD

Director
Direct +1 949 930 2481
brett.lockwood@cushwake.com
Lic #01495872

KYLE MCGILLEN

Senior Director
Direct +1 949 930 9229
kyle.mcgillen@cushwake.com
Lic #01959388

ANDREW RYAN

Senior Associate
Direct +1 949 336 3484
andrew.ryan@cushwake.com
Lic # 02218585



**CUSHMAN &
WAKEFIELD**

PROPERTY HIGHLIGHTS

- **±69,032 SQ. FT. PART OF LARGER INDUSTRIAL BUILDING**
- **±3,000 SQ. FT. OFFICE SPACE**
- **±10,967 SQ. FT. OF BONUS MEZZANINE SPACE**
- **4 DOCK HIGH DOORS**
- **1 GROUND LEVEL DOOR**
- **800 AMPS; 480V POWER (VERIFY)**
- **FENCED YARD (POSSIBLE)**



FLOOR PLAN

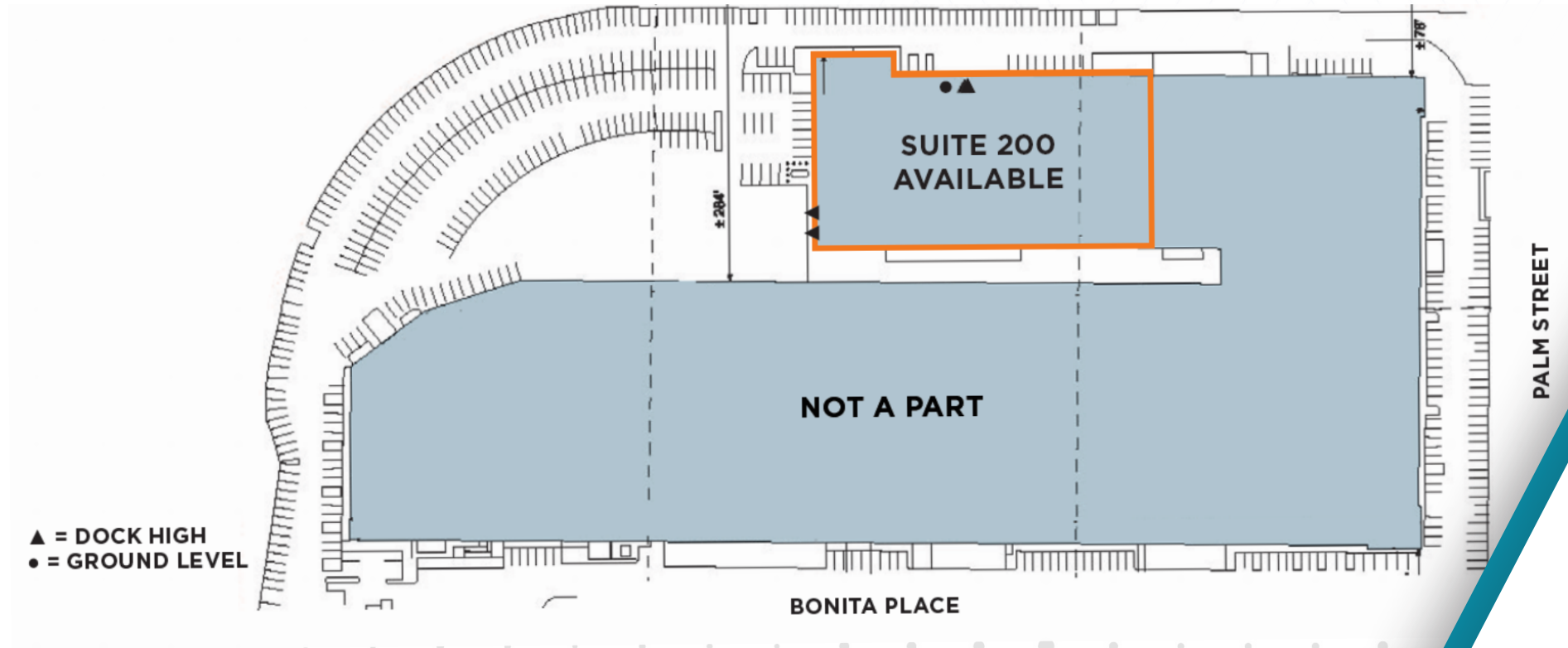



CONTACT INFO

RANDY ELLISON

Executive Director
Direct +1 949 930 4371
randy.ellison@cushwake.com
Lic #01469586

BRETT LOCKWOOD

Director
Direct +1 949 930 2481
brett.lockwood@cushwake.com
Lic #01495872

KYLE MCGILLEN

Senior Director
Direct +1 949 930 9229
kyle.mcgillen@cushwake.com
Lic #01959388

ANDREW RYAN

Senior Associate
Direct +1 949 336 3484
andrew.ryan@cushwake.com
Lic # 02218585



©2025 Cushman & Wakefield. All rights reserved. The material in this presentation has been prepared solely for information purposes, and is strictly confidential. Any disclosure, use, copying or circulation of this presentation (or the information contained within it) is strictly prohibited, unless you have obtained Cushman & Wakefield's prior written consent. The views expressed in this presentation are the views of the author and do not necessarily reflect the views of Cushman & Wakefield. Neither this presentation nor any part of it shall form the basis of, or be relied upon in connection with any offer, or act as an inducement to enter into any contract or commitment whatsoever. NO REPRESENTATION OR WARRANTY IS GIVEN, EXPRESS OR IMPLIED, AS TO THE ACCURACY OF THE INFORMATION CONTAINED WITHIN THIS PRESENTATION, AND CUSHMAN & WAKEFIELD IS UNDER NO OBLIGATION TO SUBSEQUENTLY CORRECT IT IN THE EVENT OF ERRORS.