

9999

Muirlands
Irvine, CA



SINGLE STORY OFFICE **FOR LEASE**



PROPERTY HIGHLIGHTS



±7,603 SF of Single Story
Office/R&D Building



Above Standard 10' Ceilings in Office Area



High Image Building in Business Park
Environment



Excellent Identity on Bake/Muirlands



Easy Access to the 5, 405, and 133 Freeways



Numerous Amenities Nearby



Short Drive to Irvine Spectrum Center and
Los Olivos Marketplace

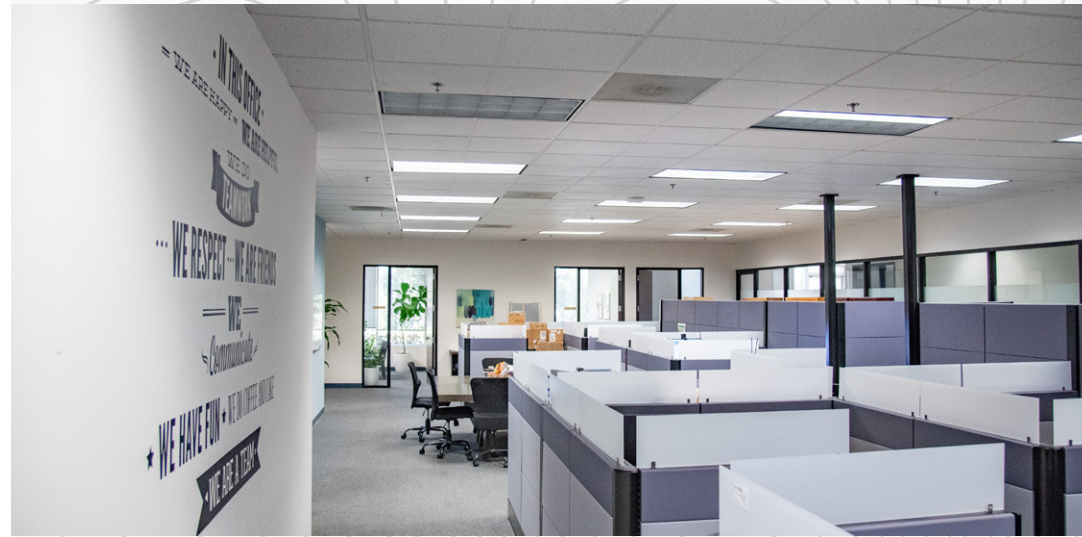

FLOOR PLAN

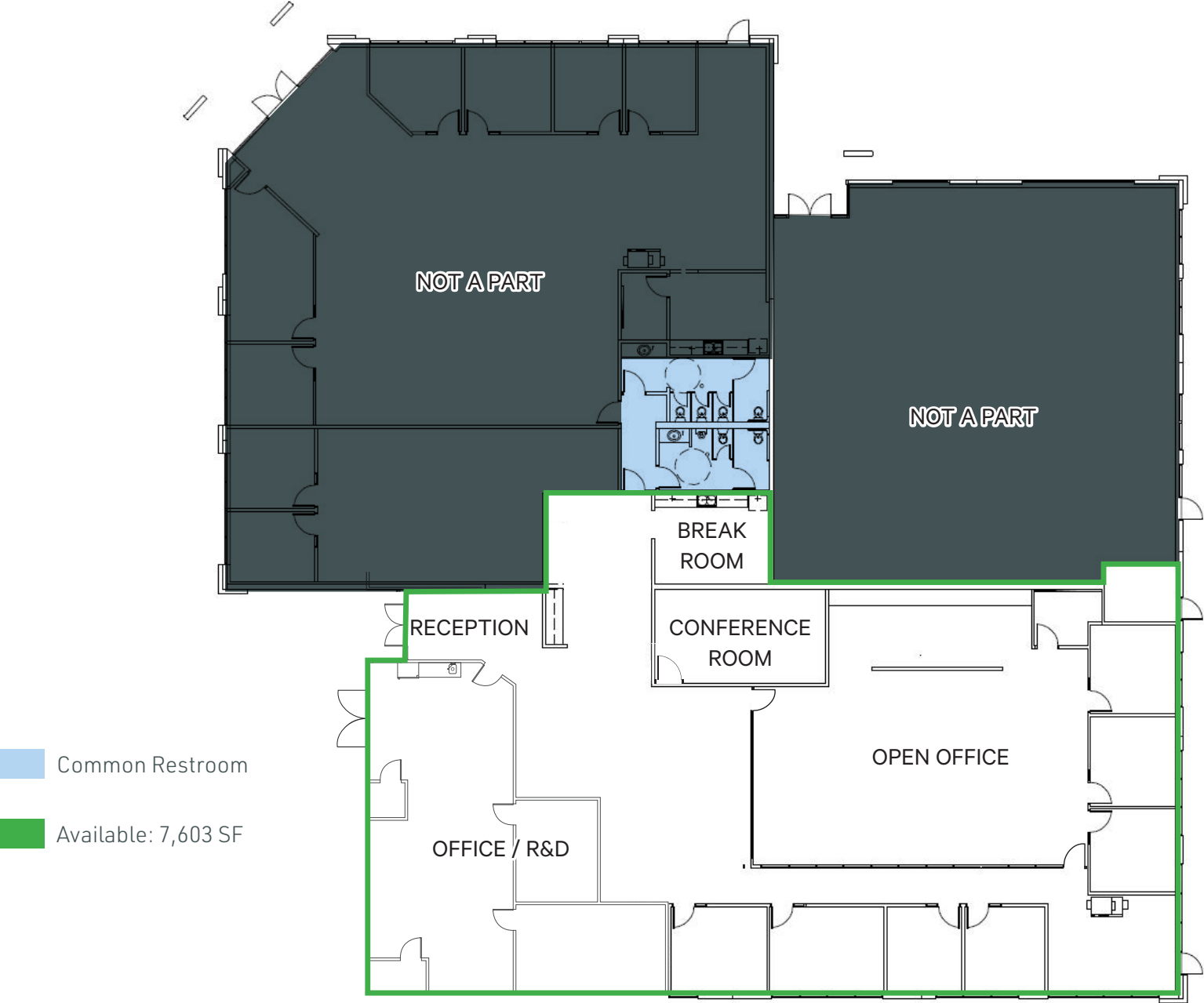

9999 MUIRLANDS

CONTACT US

KEITH BLACK

+1 949 725 8633

keith.black@cbre.com

Lic #01266477

JONATHAN CARR

+1 949 725 8418

jonathan.carr@cbre.com

Lic #02217785

© 2026 CBRE, Inc. All rights reserved. This information has been obtained from sources believed reliable but has not been verified for accuracy or completeness. CBRE, Inc. makes no guarantee, representation or warranty and accepts no responsibility or liability as to the accuracy, completeness, or reliability of the information contained herein. You should conduct a careful, independent investigation of the property and verify all information. Any reliance on this information is solely at your own risk. CBRE and the CBRE logo are service marks of CBRE, Inc. All other marks displayed on this document are the property of their respective owners, and the use of such marks does not imply any affiliation with or endorsement of CBRE. Photos herein are the property of their respective owners. Use of these images without the express written consent of the owner is prohibited.

CBRE