

2330

2330

EAST BIDWELL ST.

Folsom, CA

JERDE
WWW.JERDECRE.COM

JOSIE JERDE

lic. 01344316

(916) 849-1514

josie@jerdecre.com

LOCATION/AMENITIES



FOLSOM BRIDGE



PALLADIO MALL



HISTORIC FOLSOM



FOLSOM LAKE

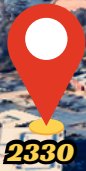

EAST BIDWELL STREET

EAST BIDWELL STREET

OAK AVE PARKWAY

OAK AVE PARKWAY

CALIFORNIA Family Fitness





BUILDING HIGHLIGHTS

 LUSH LANDSCAPING AND OUTDOOR PATIO AREA

 CLOSE TO THE AMERICAN RIVER BIKE TRAIL

 MODERN FINISHES, EXPANSIVE WINDOWLINES

 BUILDING SIGNAGE AVAILABLE

 PARKING RATIO: 5/1,000 SF (MED. USE OK!)

 IMMEDIATE PROXIMITY TO MERCY HOSPITAL

 CLOSE TO A VARIETY OF AMENITIES INCLUDING THE PALLADIO MALL AND HISTORIC FOLSOM



SUITE 130

+/- 1,425 SF

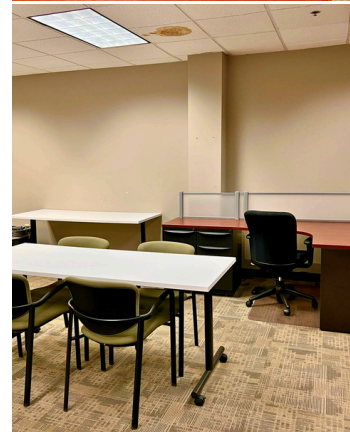
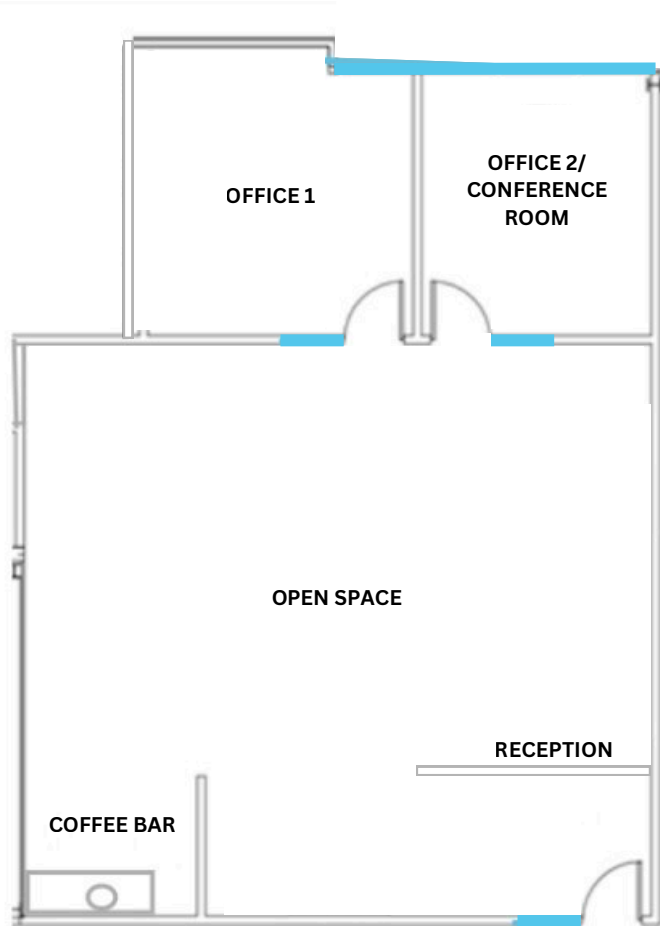

JOSIE JERDE

lic. 01344316

(916) 849-1514

josie@jerdecre.com

 FLOOR-TO-CEILING GLASS