

# 2300 SHATTUCK AVENUE

BERKELEY, CA



+/- 10,631 SF

HARD CORNER LOCATION IN BERKELEY, CA

maven  
RETAIL



# DOWNTOWN BERKELEY

BERKELEY, CA

**2300 SHATTUCK AVENUE IS LOCATED IN BERKELEY, CA, ON THE VIBRANT INTERSECTION OF SHATTUCK AND UNIVERSITY AVENUE.**

Shattuck and University Avenue is the heart of downtown Berkeley, a vibrant and walkable urban hub. This lively intersection blends the academic energy of the nearby UC Berkeley campus with the arts and theatre district and cultural scene. Major landmarks include the Berkeley Art Museum and Pacific Film Archive (BAMPFA) and the Berkeley Repertory Theatre. The area is a culinary hotspot, offering everything from acclaimed restaurants and hotspots like Comal, La Note, Jupiter, Angeline's, to a wide array of international cuisines. Retailers range from a multi-story Target, Equinox, to beloved local institutions like Moe's Books and Amoeba Music, creating a dynamic and eclectic atmosphere, providing a dynamic mix of shopping opportunities that cater to both residents and visitors alike.

**100**  
WALK  
SCORE

**72**  
TRANSIT  
SCORE

**100**  
BIKE  
SCORE

# FEATURES

- **Approximately ±10,631 SF**
- **Unrivald frontage and identity**
- **Located In Downtown Berkeley**
- **Two Blocks From UC Berkeley, campus has approx. 43,000 Students & 20,000 Faculty & Staff**
- **High Visibility Hard Corner Visibility**



2300



# FLOOR PLAN

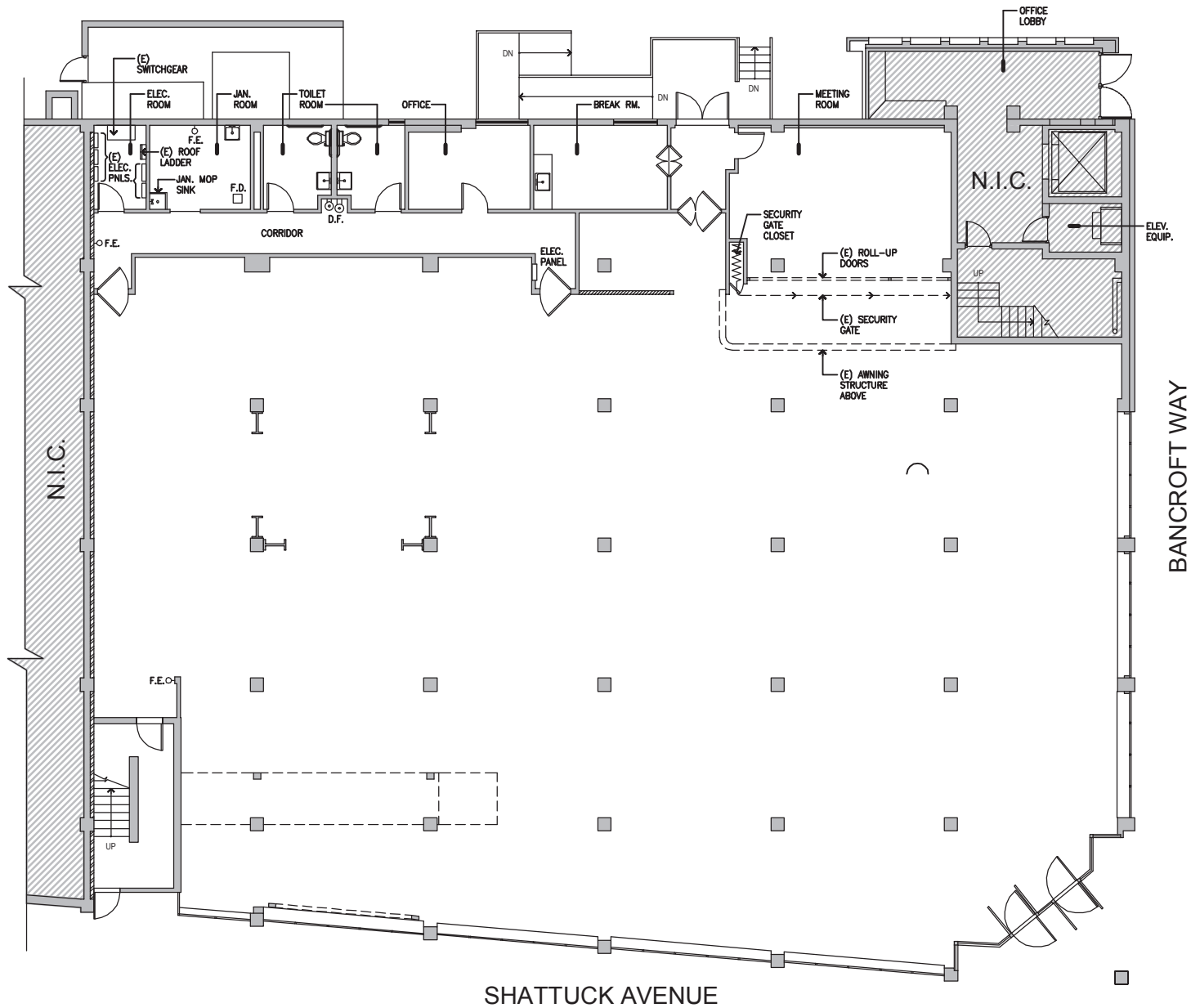



**ANGELINE'S LOUISIANA KITCHEN**



**BAMPFA**



**CORNERSTONE**



**LA NOTE**



**BLUEBOTTLE COFFEE**



**U.C. BERKELEY**



**IPPUDO**



**GATHER**



**JUPITER**



**THE BUTCHER'S SON**



**BERKELEY REPERTORY THEATRE**



**COMAL**

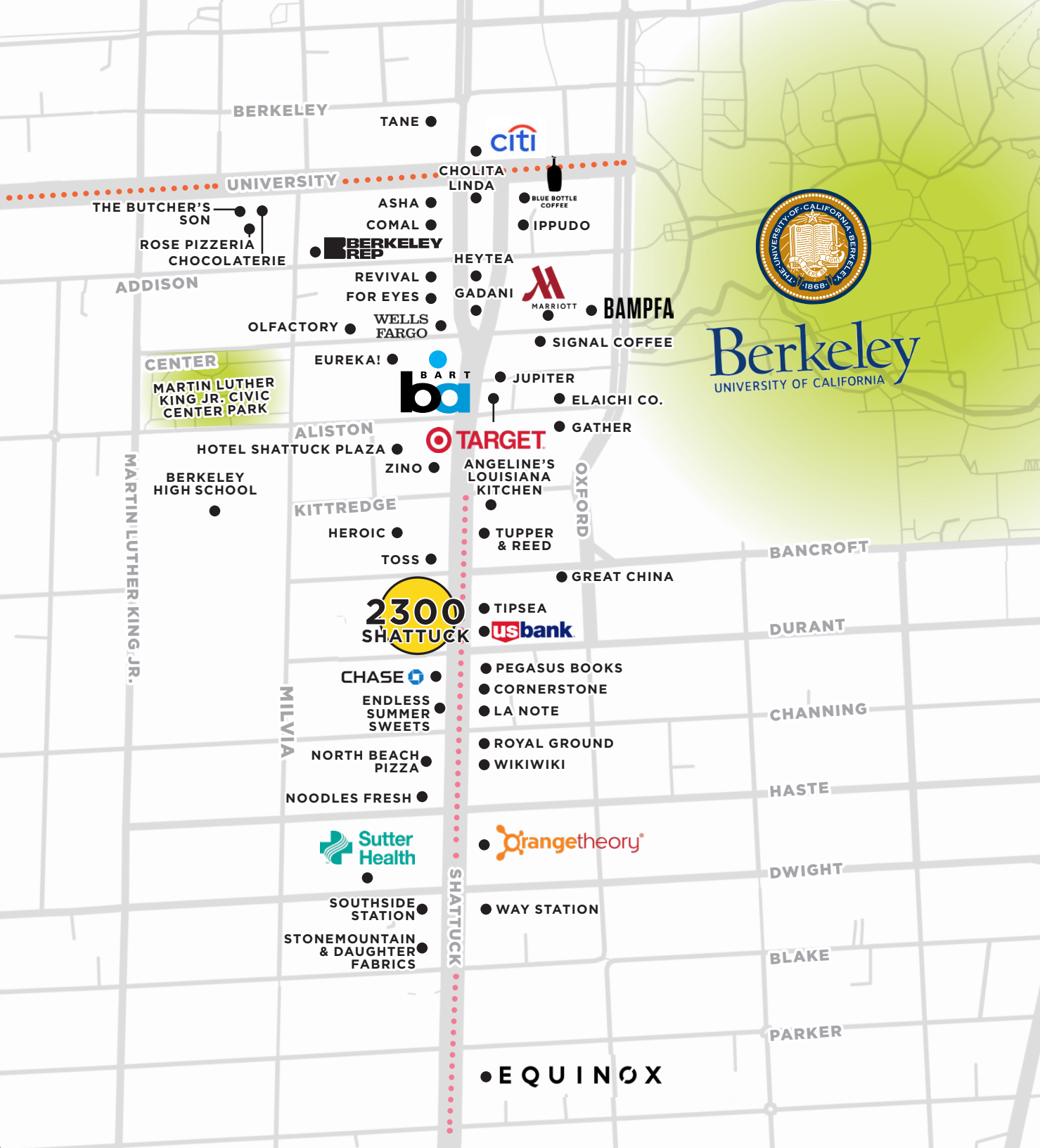

2300 SHATTUCK AVENUE  
**DOWNTOWN BERKELEY**

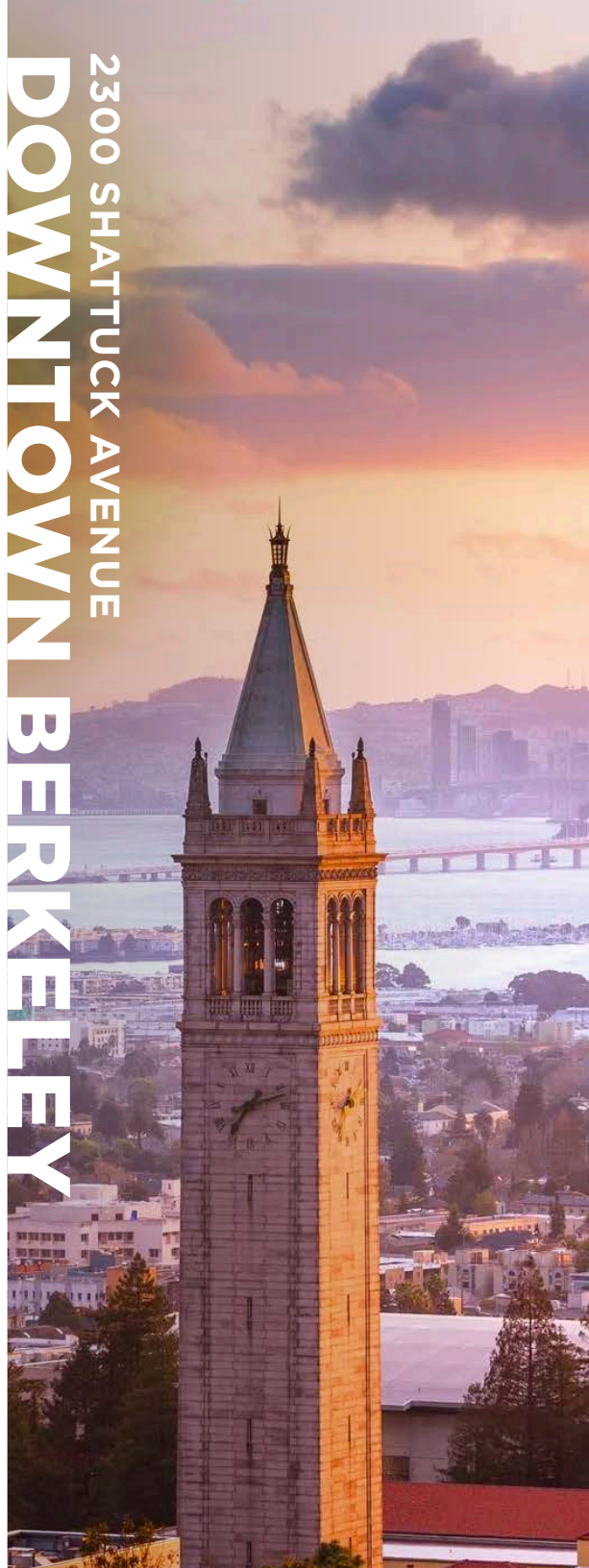

**2300 SHATTUCK**

- CITI
- BLUE BOTTLE COFFEE
- IPPUDO
- BAMPFA
- MARRIOTT
- SIGNAL COFFEE
- JUPITER
- ELAICHI CO.
- GATHER
- TARGET
- ANGELINE'S LOUISIANA KITCHEN
- TUPPER & REED
- GREAT CHINA
- TIPSEA
- USBANK
- PEGASUS BOOKS
- CORNERSTONE
- LA NOTE
- ROYAL GROUND
- WIKIWIKI
- Orangetheory
- WAY STATION
- EQUINOX

- THE BUTCHER'S SON
- ROSE PIZZERIA
- CHOCOLATERIE
- ASHA
- COMAL
- BERKELEY REP
- HEYTEA
- REVIVAL FOR EYES
- OLFACTORY
- WELLS FARGO

MARTIN LUTHER KING JR. CIVIC CENTER PARK

- HOTEL SHATTUCK PLAZA
- ZINO
- BERKELEY HIGH SCHOOL

- CHASE
- ENDLESS SUMMER SWEETS
- NORTH BEACH PIZZA
- NOODLES FRESH

Sutter Health

- SOUTHSIDE STATION
- STONEMOUNTAIN & DAUGHTER FABRICS



# 2300 SHATTUCK AVENUE

BERKELEY, CA

maven  
RETAIL

## CONTACTS

### NADINE WHISNANT

510.413.7813  
nadine@mavenproperties.com  
DRE #00966437

### CATHERINE MEUNIER

415.806.5566  
catherine@mavenproperties.com  
DRE #01843732

### HALLIE FORMAN

415.426.7808  
hallie@mavenproperties.com  
DRE #02252563

---

NOTICE: This information has been secured from sources we believe to be reliable but we make no representations, warranties, express or implied, as to the accuracy of the information. Listing broker has been given enough information to provide only a preliminary interest in the property. The materials are not to be considered fact. The information contained herein is not a substitute for thorough due diligence investigation. References to square footage, zoning, use, or age are approximate. Please contact the San Francisco Planning Department to verify zoning at (415) 558-6378, as neither broker or landlord represent that this space is suitable for your use. Tenant or Buyer must verify the information at their own expense and bears all the risk for any inaccuracies. By receiving these materials you are agreeing to the disclaimers set forth herein. DRE#01878802

---

466 GREEN STREET SUITE #203 | SAN FRANCISCO, CA 94133  
415-781-7700 | [www.mavenproperties.com](http://www.mavenproperties.com)