

TURN-KEY OFFICE SPACE FOR LEASE



2601 Skyway Dr, Suite A3, Santa Maria, CA



Office 805.481.9010
170 West Grand Ave, Suite 203
Grover Beach, CA 93433

OVERVIEW

Summary

Located at the signalized intersection of Skyway and Fairway, The Fair Sky Park is close to the Santa Maria Airport with easy access to Broadway (HWY 135). This well maintained building offers great visibility and plenty of parking. This suite offers 6 private offices, large bullpen area, huge conference room and private restrooms.



Suite	Gross SF	Rate
A3	± 3,143 SF	\$1.65/SF, Gross

- Improved office space near the Santa Maria Airport
- Excellent visibility at corner of Fairway & Skyway Dr
- Ample Parking
- Zoning M1

FLOORPLAN

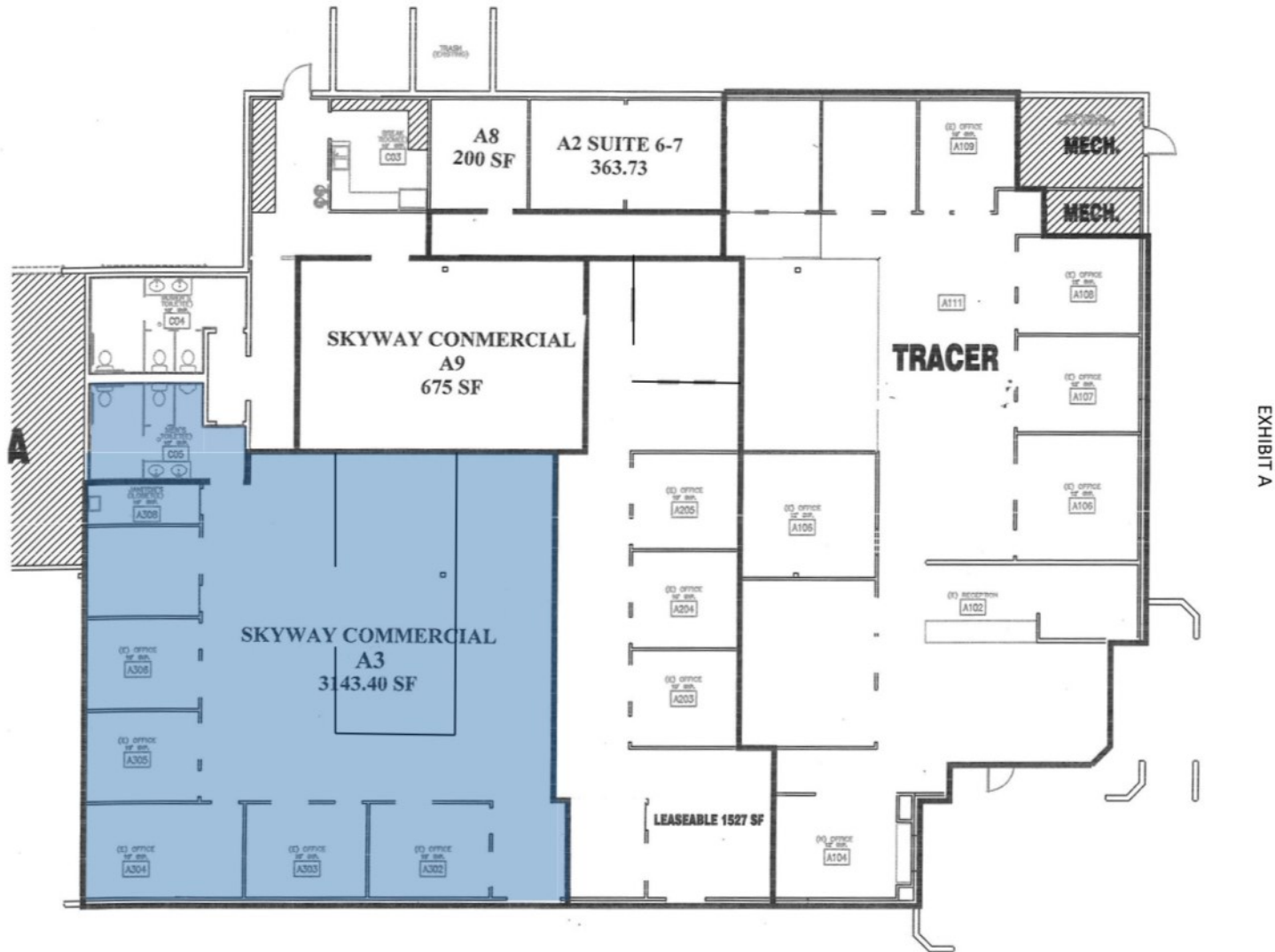

PHOTOS

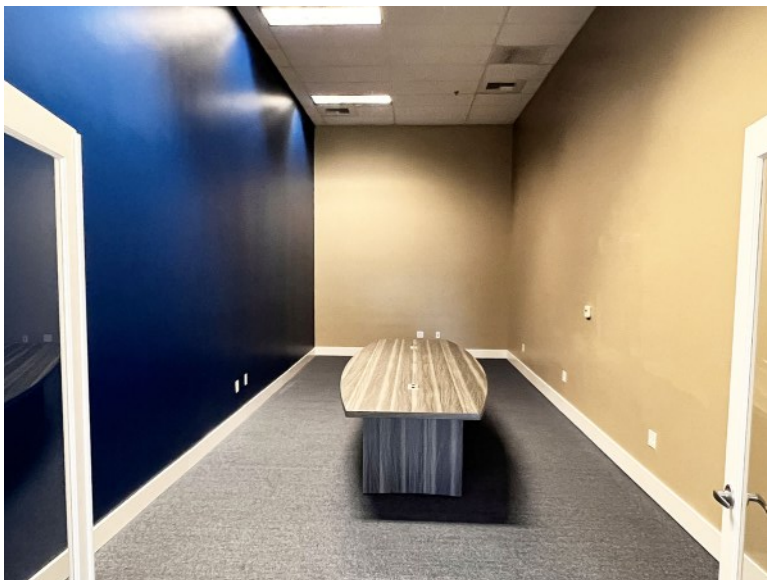

AREA MAP

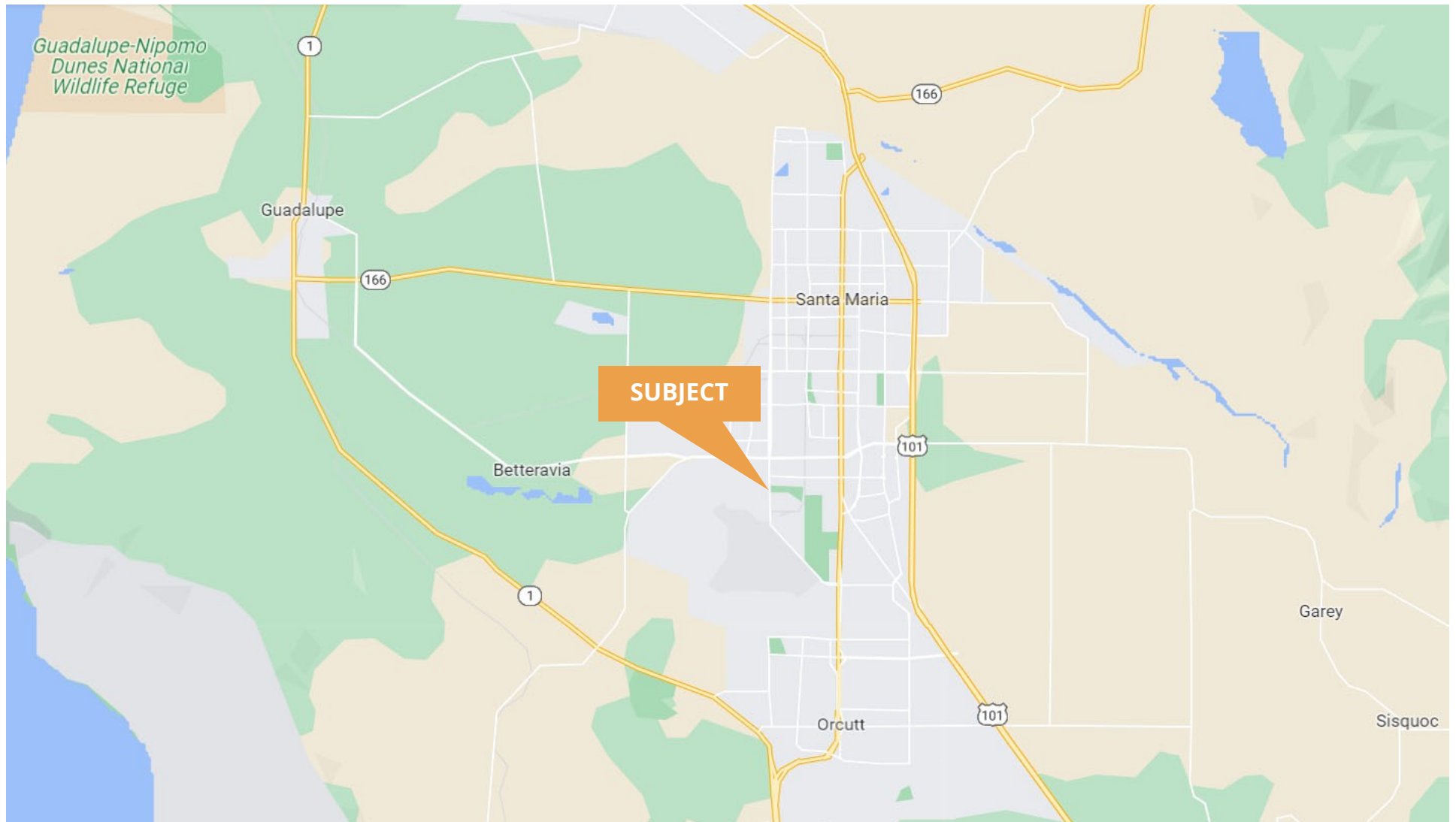

Jason Hart

Broker/Owner DRE 01334694

Mobile 805.709.6491

Email jason@hartcre.com

Carlos J Perla

Associate DRE 02093997

Mobile 805.249.0930

Email carlos@hartcre.com