

SUNSET LOGAN

E C H O P A R K

1701 W Sunset Blvd.
& 1309 Logan St

WELCOMING A CELEBRATED EAST-COAST INSPIRED DELI CONCEPT
AND A CASUAL QSR BY JAMES BEARD NOMINATED TEAM

ONE SPACE
REMAINING

QUINCE
COMPLEX

Logan

Sunset

ERIK KRASNEY
ZACHARY CARD
SOPHIA KESSLER

CBRE

Property Highlights

Iconic character building in the heart of Echo Park

Across from Lassens Natural Foods and Jensen's Recreation Center

Building renovations underway including new storefronts and heavily improved patio

Eligible for Restaurant Beverage Program (tenant to confirm)

Available Now

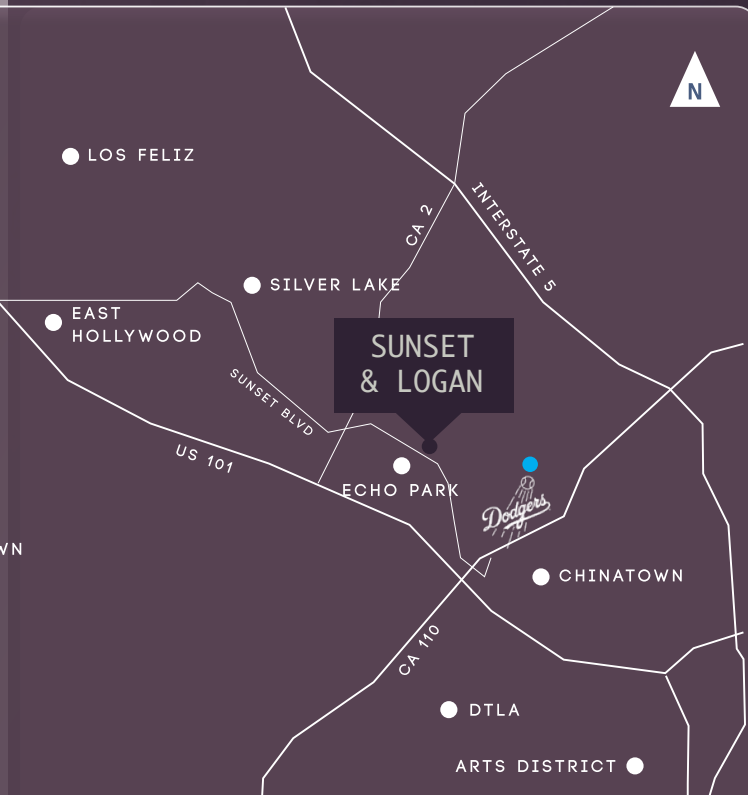

400+ PARKING NEARBY LOTS



+40K Cars Per Day



91 WALK SCORE



Sunset Corner

New storefront pending

Eligible for Restaurant
Beverage Program

Some TIA Available

New building systems
(HVAC, electrical,
grease interceptor)

Walk-In Cooler
& Restrooms

1,657 SF

LEASED

WELCOMING A CELEBRATED EAST-COAST INSPIRED DELI CONCEPT



Logan Street

Sunset Blvd.



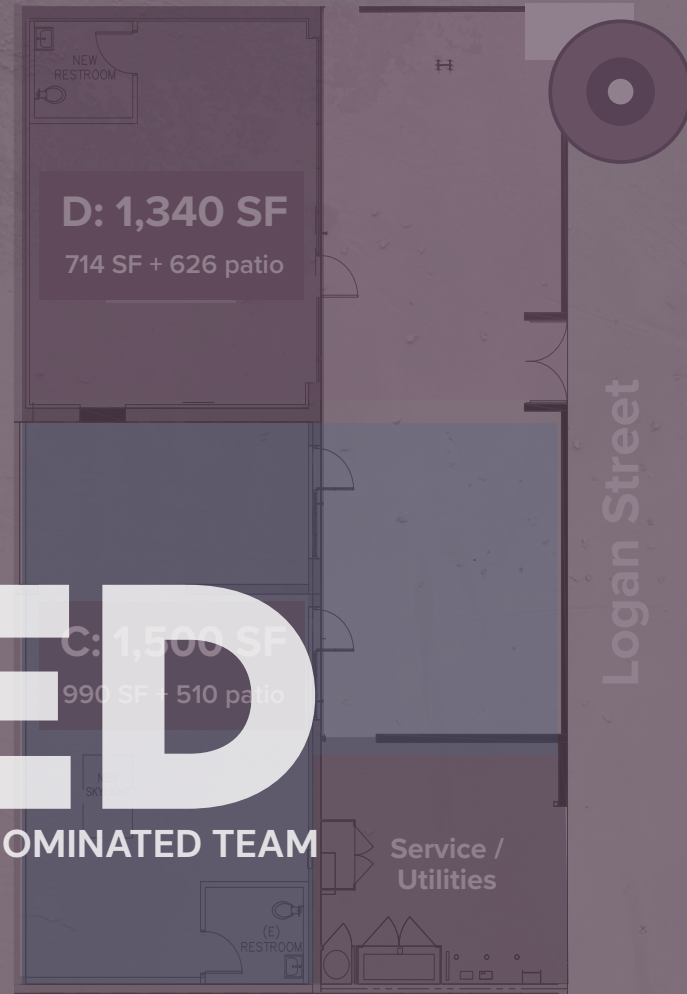

LEASED

WELCOMING AN ELEVATED QSR BY A JAMES BEARD NOMINATED TEAM



Logan Street

New HVAC, Electrical, Plumbing, Restrooms & Grease Interceptor

Eligible for Restaurant Beverage Program

New storefronts and glass-line pending

Heavily improved covered patio dining area w/ ABC enclosure



New Storefronts Underway

Suite A (Sunset Blvd.)

New storefront complete

Eligible for Restaurant Beverage Program

Some TIA Available

New building systems (HVAC, electrical, grease interceptor)

One ADA restroom in place



Logan Street

Sunset Blvd.





HOLLYWOOD

LOS FELIZ

SILVER LAKE

N ALVARADO STREET

GLENDALE BOULEVARD

COSA BUONA

MASA

STICKY RICE

LASSENS / WALGREENS

COOKBOOK

CLUB PILATES
DADA MARKET / DADA

SUNSET & LOGAN

HONEY HI

ECHO PARK AVENUE

BACETTI

CANYON COFFEE

GOGOSHA OPTIQUE

HEY HEY

LOWBOY | DONNAS | BAR FLORES

MONTY'S GOOD BURGER

WOODCAT COFFEE BAR

EL MORO CHURROS

HIRONORI

STEREOSCOPE COFFEE

MONKISH BREWING

LAVETA TERRACE

A TI

SLURPIN RAMEN

H&H BAGELS

QUARTER SHEETS

the echo park community

SUNSET BOULEVARD

LITTLE JOY

PORTIA STREET

UNCLE PAULIE'S

THE SHORT STOP

QUARTER SHEETS PIZZA CLUB



Area Overview

The Eastside's Favorite

Echo Park is the jumping off point for many of the most interesting and dynamic neighborhoods in Los Angeles. With proximity to 4 major freeways: the I-5, the CA-2, the CA-110, and the US-101, Echo Park is bordered by Silver Lake, Los Feliz, Chinatown, Downtown, Hollywood, and convenient to Glendale, Koreatown and more.

Apart from marquee national destinations like Dodgers Stadium and regional draws like Echo Park Lake and Elysian Park, Sunset Blvd. continues to be a bustling draw for many of the city's top chefs and innovative retailers.

Echo Park is approaching a juncture with many large-scale developments under entitlement which will propel the neighborhood into a true live-work-play destination.

BAR FLORES & LOW BOY



CANYON COFFEE



HONEY-HI



DADA



DEMOGRAPHICS (1 MILE RADIUS)

POPULATION

Est Population
43,702
1 MILE

Daytime Population
36,753
1 MILE

INCOME

Average Income (HOUSEHOLD)
\$80,734
1 MILE

GENERATIONS

Generations
33%
Millennials '81 - '98

BUSINESSES

Employees
6,937
1 MILE

EMPLOYEES

Businesses
1,132
1 MILE

SUNSET & LOGAN

E C H O P A R K

For Inquiries:

Erik Krasney

Lic. 01970585

+1 323 270 1920

erik.krasney@cbre.com

Zachary Card

Lic. 01717802

+1 310 497 5218

zachary.card@cbre.com

Sophia Kessler

Lic. 02168824

+1 310 940 5545

sophia.kessler@cbre.com

© 2025 CBRE, Inc. All rights reserved. This information has been obtained from sources believed reliable, but has not been verified for accuracy or completeness. Any projections, opinions, or estimates are subject to uncertainty. The information may not represent the current or future performance of the property. You and your advisors should conduct a careful, independent investigation of the property and verify all information. Any reliance on this information is solely at your own risk. CBRE and the CBRE logo are service marks of CBRE, Inc. and/or its affiliated or related companies in the United States and other countries. All other marks displayed on this document are the property of their respective owners.

CBRE