

Proposed Layout – 25th Street Entrance

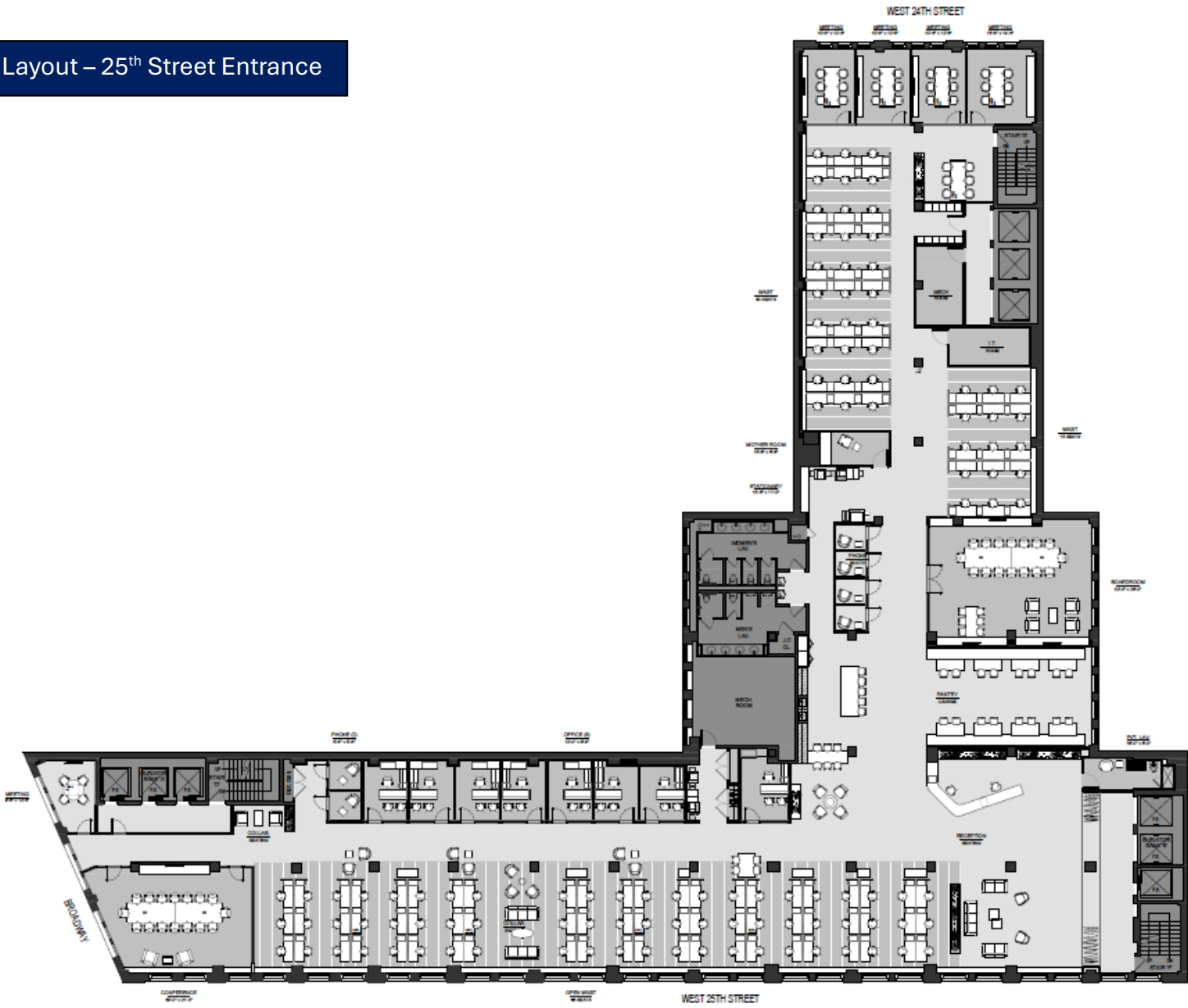

A 25TH STREET ENTRANCE
PRELIMINARY PLAN

RICHARD IAN DESIGNS
WWW.RICHARDIAN.COM PH: 212.64.1886

REVISION	DATE	DESCRIPTION
1	04.17.2018	PRELIMINARY DESIGN ONLY

CLIENT: _____

SCALE: AS NOTED

PROJECT: 18 MADISON SQUARE WEST, NEW YORK, NY 10010

DRAWING: 300 FLOOR PLAN, PRELIMINARY PLAN

DATE: JAN 2018

PROJECT NO: _____

DRAWING BY: EGI

DATE: _____

DRAWING NO: _____

TEST FIT

** LAYOUT FOR SPACE PLANNING PURPOSES ONLY
PLAN MAY NEED TO BE ADJUSTED BASED ON FIELD SURVEY. LANDLORD APPROVAL AND/OR BUILDING CODE REQUIREMENT. **