

16K SUITE WITH DIRECT FREIGHT ACCESS

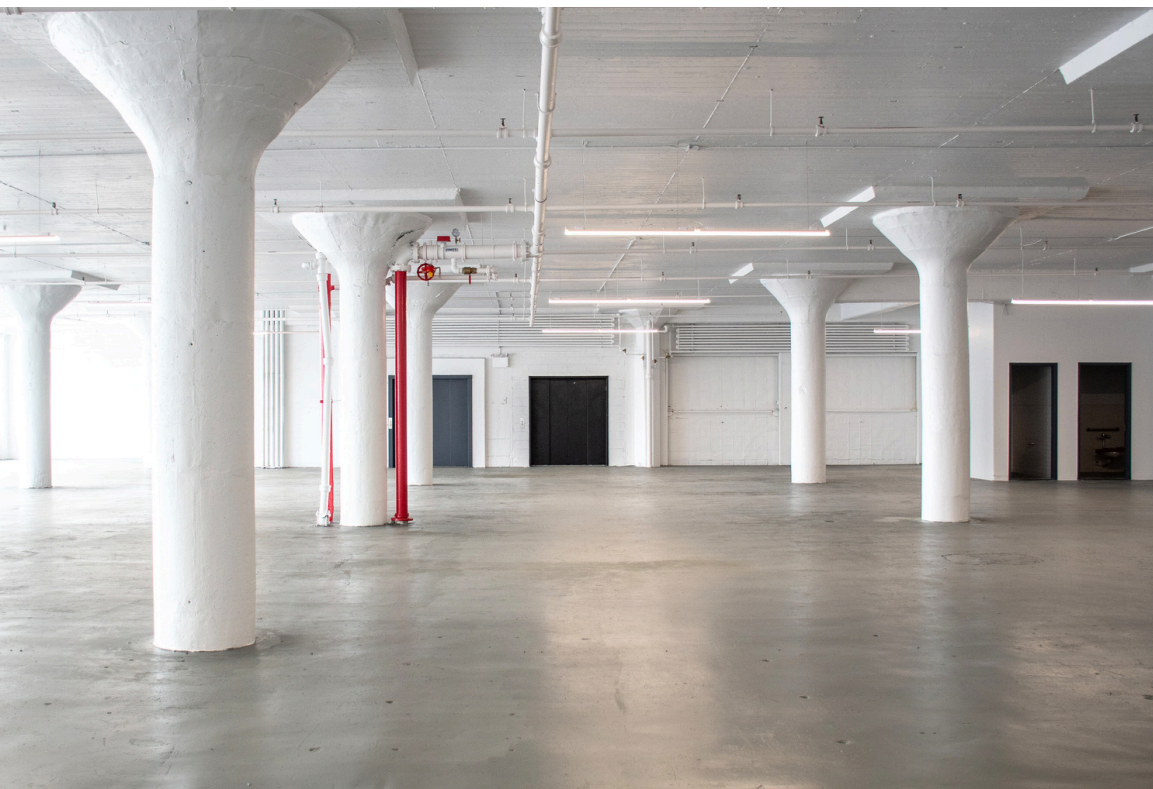

INDUSTRY CITY

JEFF FEIN, SENIOR VICE PRESIDENT OF LEASING
e. jfein@industrycity.com | p. 347.751.6749

NICK SHEARS, VICE PRESIDENT OF LEASING
e. nshears@industrycity.com | p. 516.774.1602

BRAD BLUM, LEASING MANAGER
e. bblum@industrycity.com | p. 347.934.6899

26-704

Direct freight elevator access to suite, an industrial slop sink, and private restrooms

SPACE INFO

Building 26
Floor 7
RSF 16,058

CAMPUS KEY

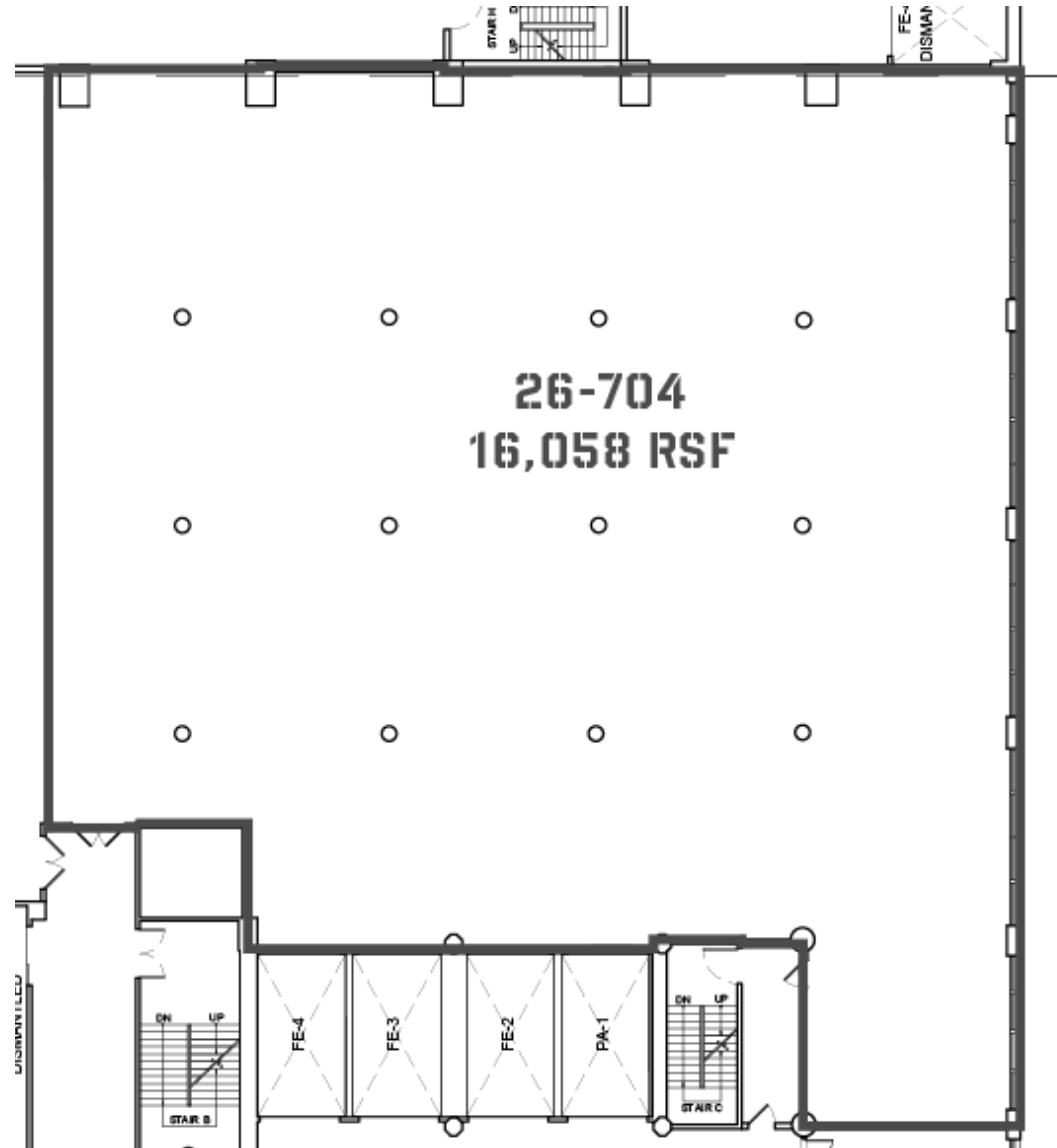
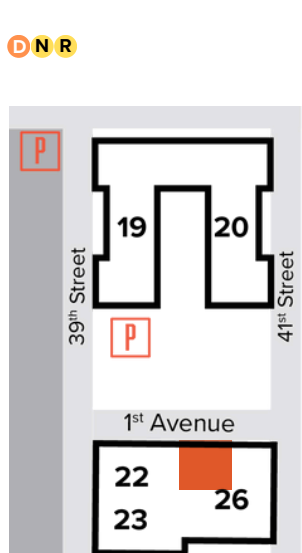

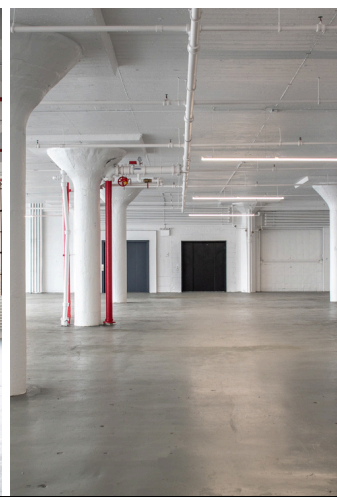

BUILDING FEATURES



**13 COVERED LOADING DOCKS,
53' TRAILER ACCESSIBLE**

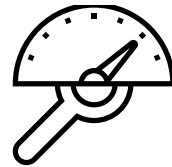

**200 LB. PSF
FLOOR LOADS**

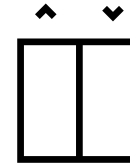

**17' LONG AUTOMATED
FREIGHT ELEVATORS**

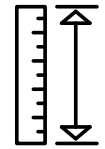

**13' 15' CEILING
HEIGHTS**

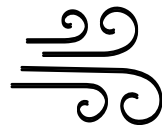

**OPERABLE WINDOWS;
VENTING PERMITTED**



**INDUSTRIAL POWER; ROOF
SPACE AVAILABLE FOR BACKUP**



24/7 SECURITY



**CAMPUS SHUTTLE TO
36TH STREET SUBWAY**

INDUSTRY CITY

JEFF FEIN, SENIOR VICE PRESIDENT OF LEASING
e. jfein@industrycity.com | p. 347.751.6749

NICK SHEARS, VICE PRESIDENT OF LEASING
e. nshears@industrycity.com | p. 516.774.1602

BRAD BLUM, LEASING MANAGER
e. bblum@industrycity.com | p. 347.934.6899



ECONOMIC INCENTIVES

THE VALUE OF MOVING TO BROOKLYN

Establishing your business presence in Brooklyn could unlock a host of financial benefits and incentives, potentially saving your company hundreds of thousands of dollars.

RELOCATION EMPLOYMENT ASSISTANCE PROGRAM (REAP)

REAP benefits companies relocating to Brooklyn from Manhattan (below 96th St), or outside of NYC, by providing up to \$3,000 in tax credits annually for each full-time employee, for up to 12 years.

For example, an eligible business relocating to Industry City with 40 full-time employees would receive a New York City income tax credit equal to \$120,000 (\$3,000 x 40) per year - effectively reducing the annual rent of a 5,000 SF office from \$175,000 to \$55,000.

Industry City will assist your business in securing benefits through the above program.

COMMERCIAL RENT TAX (CRT)

Brooklyn office tenants are exempt from the NYC Commercial Rent Tax.

INDUSTRY CITY

JEFF FEIN, SENIOR VICE PRESIDENT OF LEASING
e. jfein@industrycity.com | p. 347.751.6749

NICK SHEARS, VICE PRESIDENT OF LEASING
e. nshears@industrycity.com | p. 516.774.1602

BRAD BLUM, LEASING MANAGER
e. bblum@industrycity.com | p. 347.934.6899

CAMPUS MAP

Industry City is a 16-building campus spanning 35 acres on the Brooklyn waterfront. To date, the redevelopment has included the addition of destination courtyards, experience-driven dining, design retail and other amenitization and event programming.

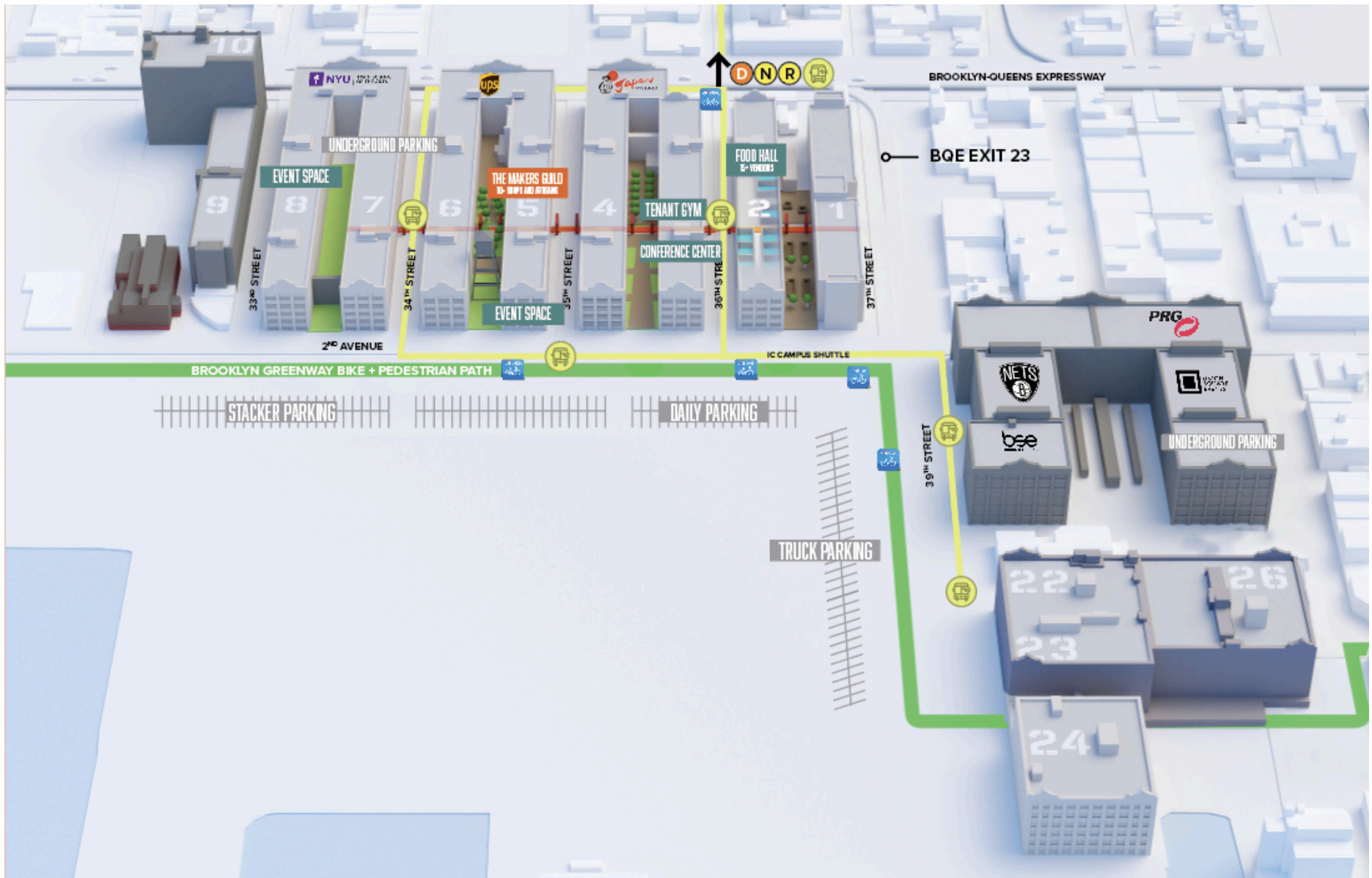



CAMPUS AMENITIES

*

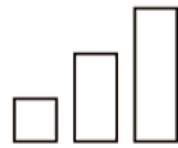

30+ ISPS AND DARK FIBER CABLING



40+ EATERIES + SHOPS

*



BIKE STORAGE



CAR AND TRUCK PARKING AVAILABLE

*



IC APP AND TENANT PERKS

*

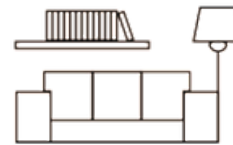

EXECUTIVE LOUNGE AND EVENT VENUES

*

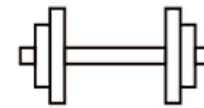

INDUSTRY CITY ATHLETIC CLUB

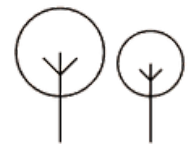

FIVE ACRES OF OUTDOOR SPACE

*** TENANT-EXCLUSIVE**

INDUSTRY CITY

JEFF FEIN, SENIOR VICE PRESIDENT OF LEASING
e. jfein@industrycity.com | p. 347.751.6749

NICK SHEARS, VICE PRESIDENT OF LEASING
e. nshears@industrycity.com | p. 516.774.1602

BRAD BLUM, LEASING MANAGER
e. bblum@industrycity.com | p. 347.934.6899