

WAYLINE

WAYLINE

WELCOME



6711, 6721 + 6731 Columbia Gateway Drive | Columbia, MD
wayline.copt.com

 COPT

WORKDAYS YOUR WAY

Meet WAYLINE—your all-inclusive workday destination, exclusively available to tenants of 6711, 6721 and 6731 Columbia Gateway Drive.

WAYLINE features modern bohemian design details and a lush lineup of amenities—from flexible conference space and a sweetgreen Outpost, to a yoga lawn and sun drenched terrace.

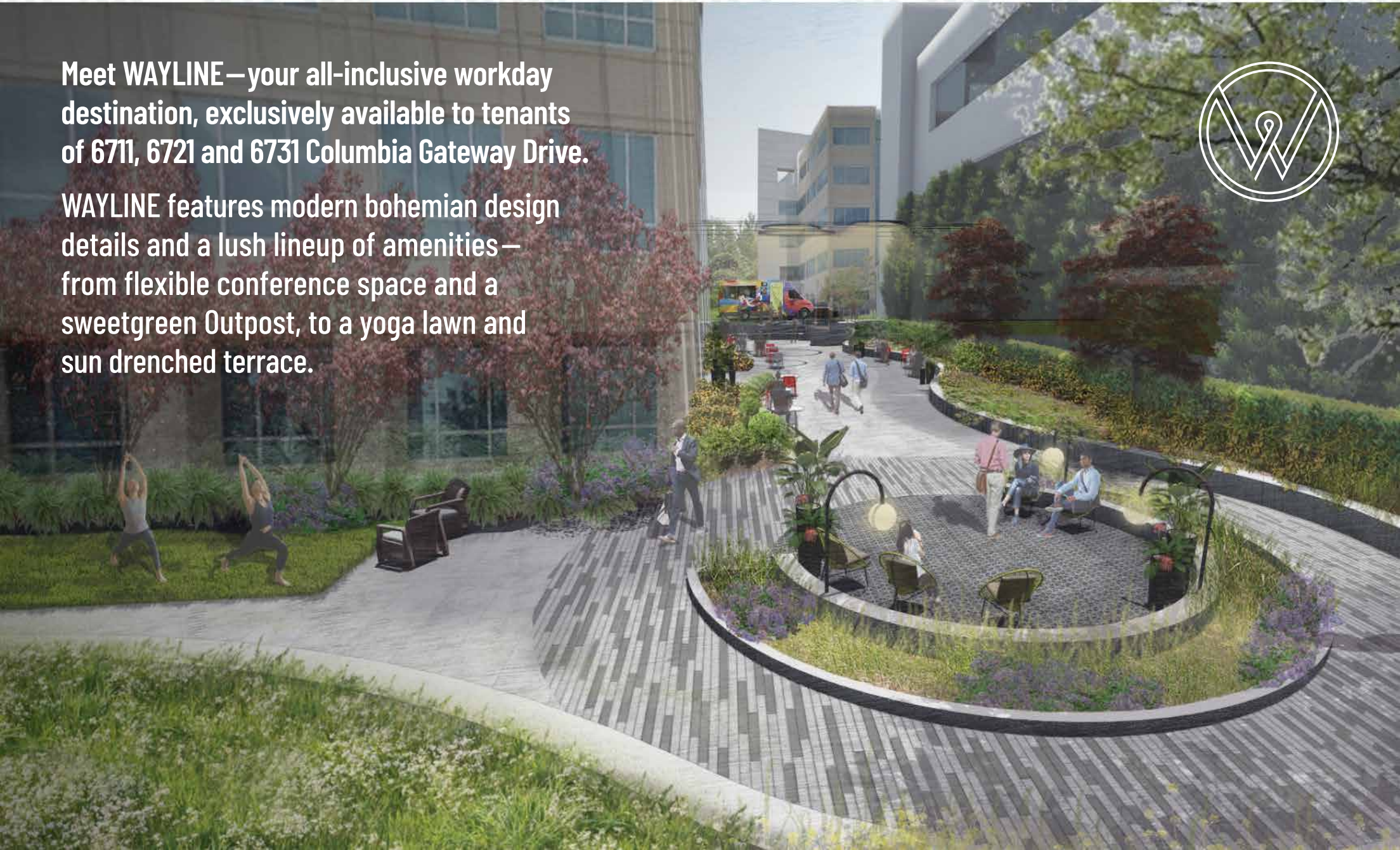

COLUMBIA GATEWAY

28 Buildings | 2.3M SF

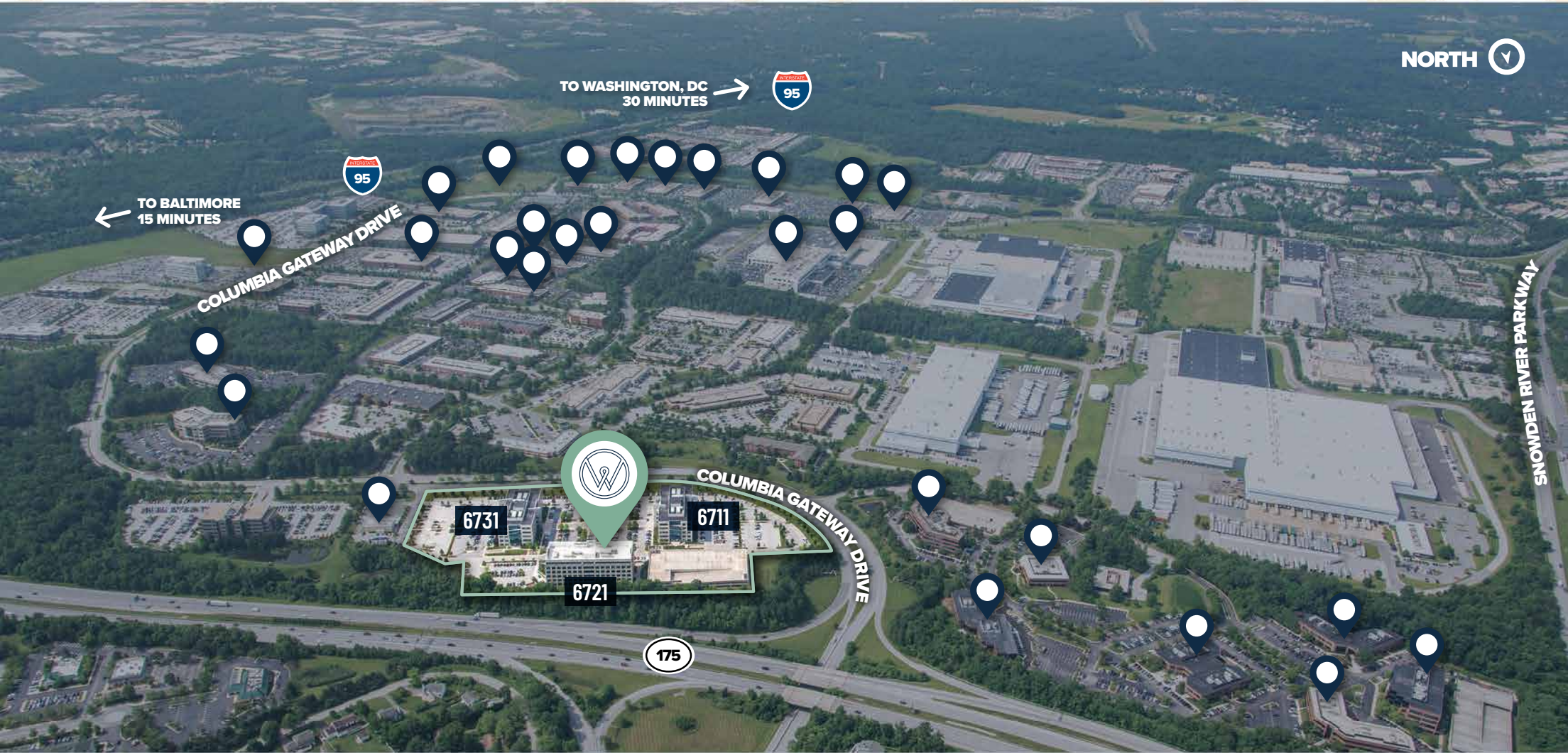

**WAYLINE
CAMPUS**



**OTHER COPT PROPERTIES
+ DEVELOPABLE LAND**

IMMEDIATE ACCESS TO I-95

Located Within 1 Mile of I-95 Entrance + Exit Ramps

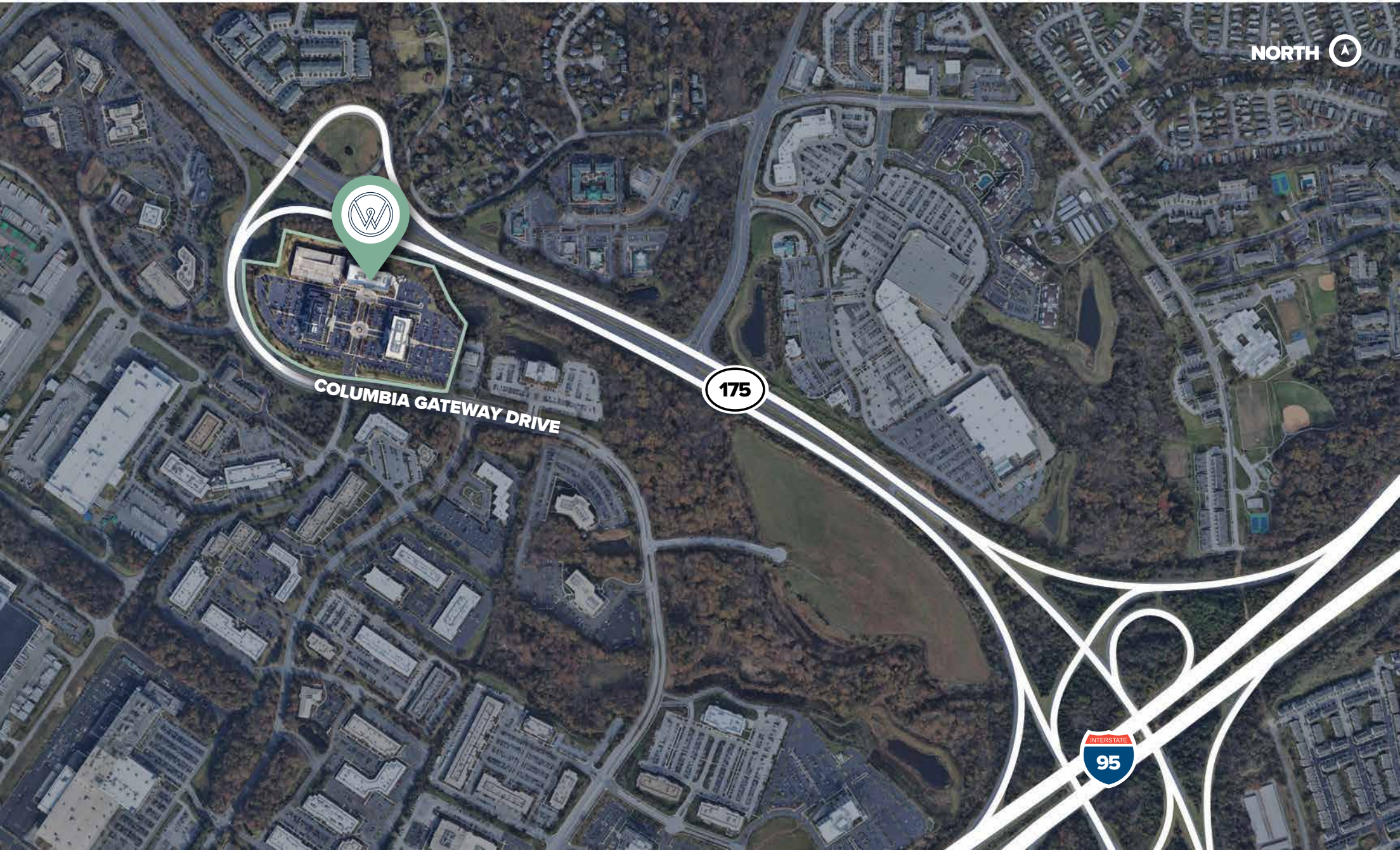

WAYLINE CAMPUS

3 Buildings | 390,100 SF



NORTH 

6711

fitness center

the alley

food trucks

6721

yoga lawn

6731

COLUMBIA GATEWAY DRIVE

175

BIOPHILIC DESIGN

Connecting to nature through materials, natural light, green spaces, and views to reduce stress and enhance creativity, productivity and overall wellbeing

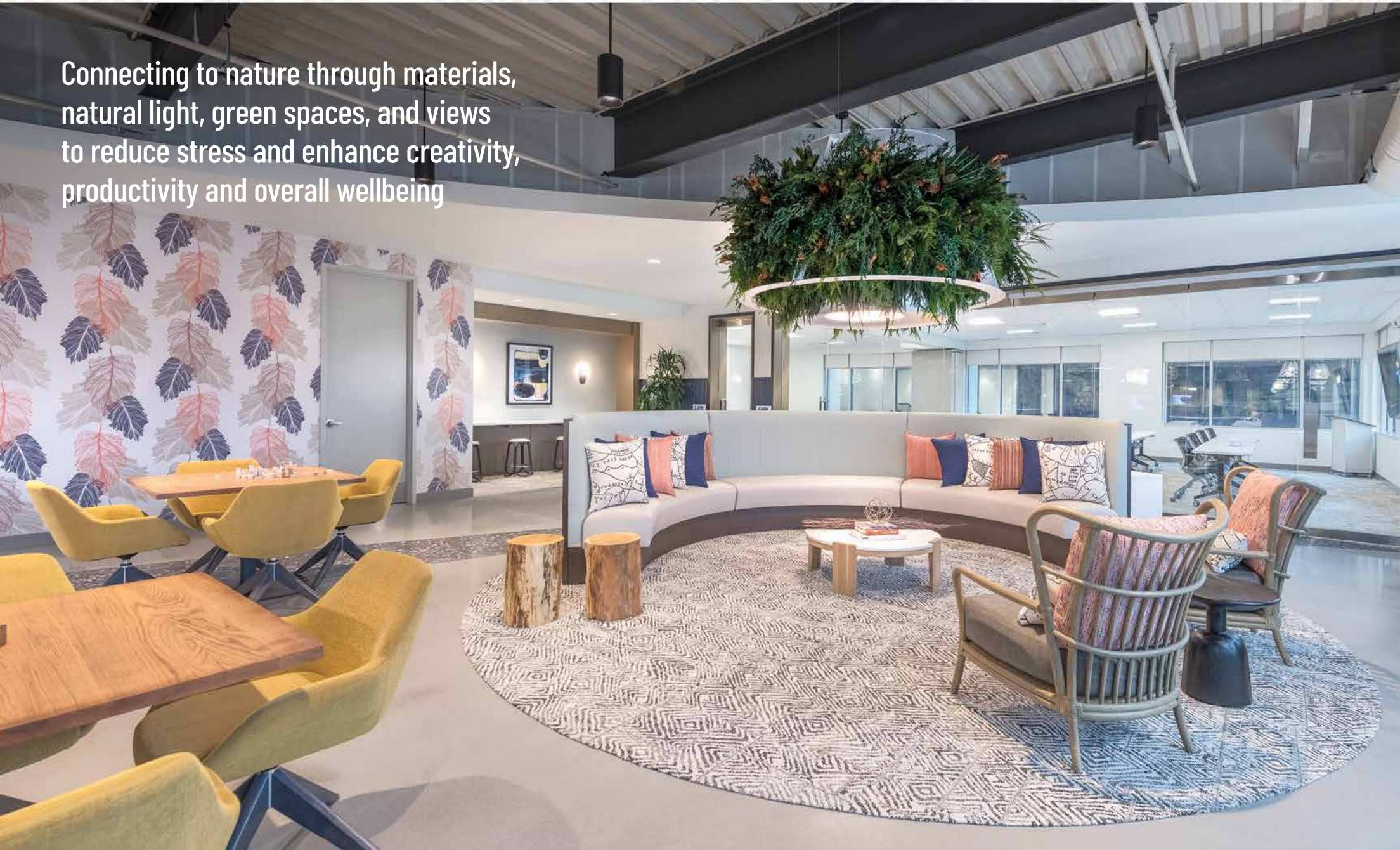

WAYLINE EXPERIENCE

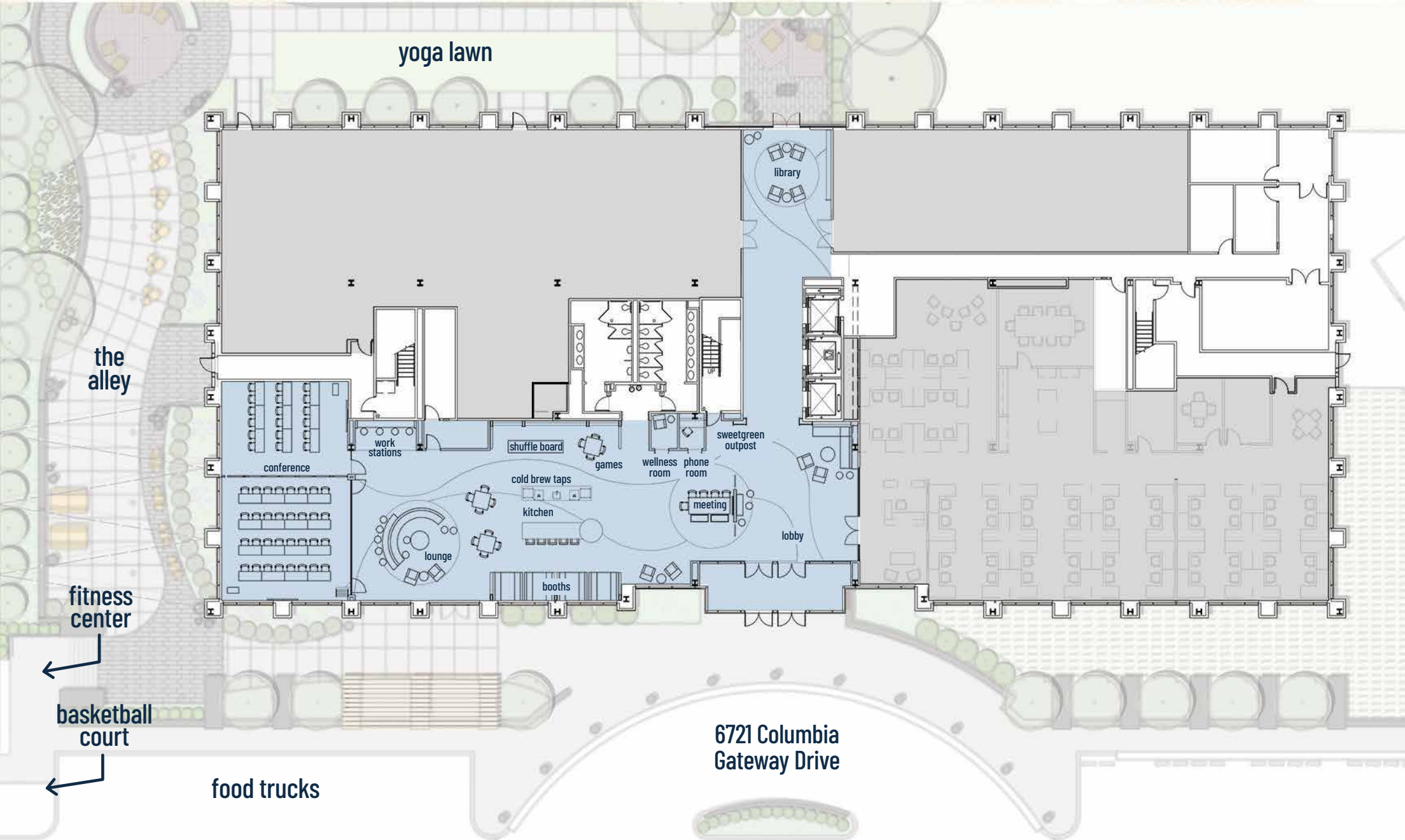

yoga lawn

library

the alley

fitness center

basketball court

food trucks

6721 Columbia Gateway Drive

conference

work stations

shuffle board

games

wellness room

phone room

sweetgreen outpost

cold brew taps

kitchen

meeting

lobby

lounge

booths

SPA-QUALITY FITNESS CENTER

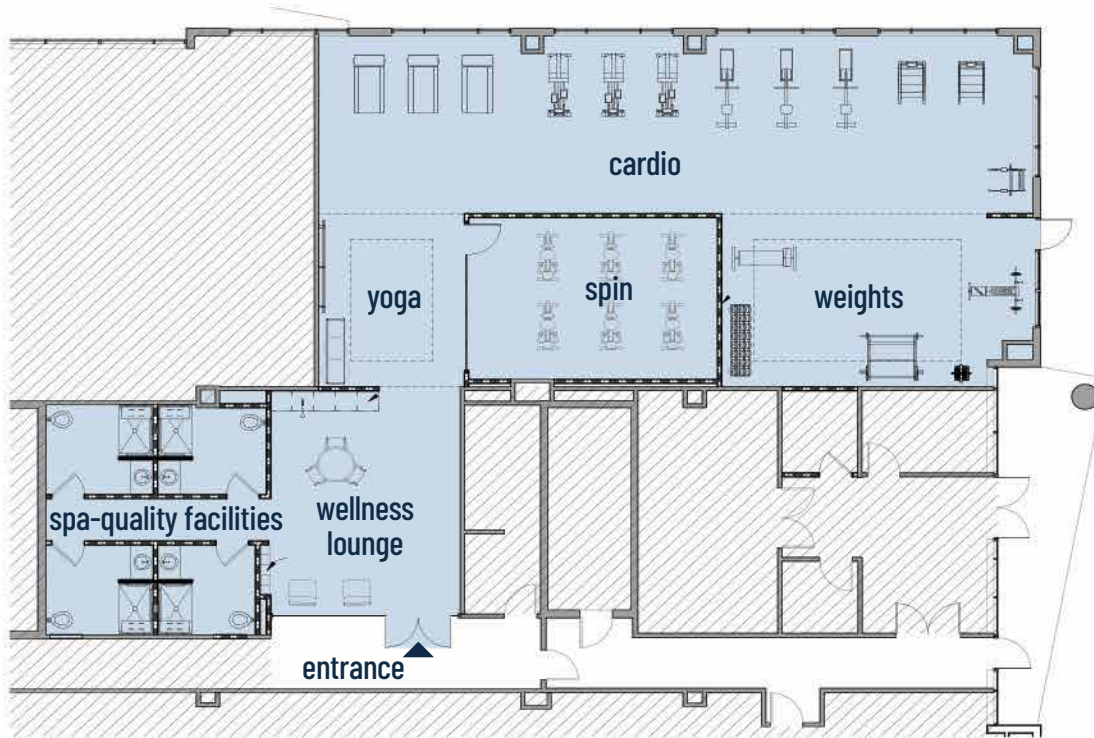

FLEXIBLE CONFERENCE ROOMS

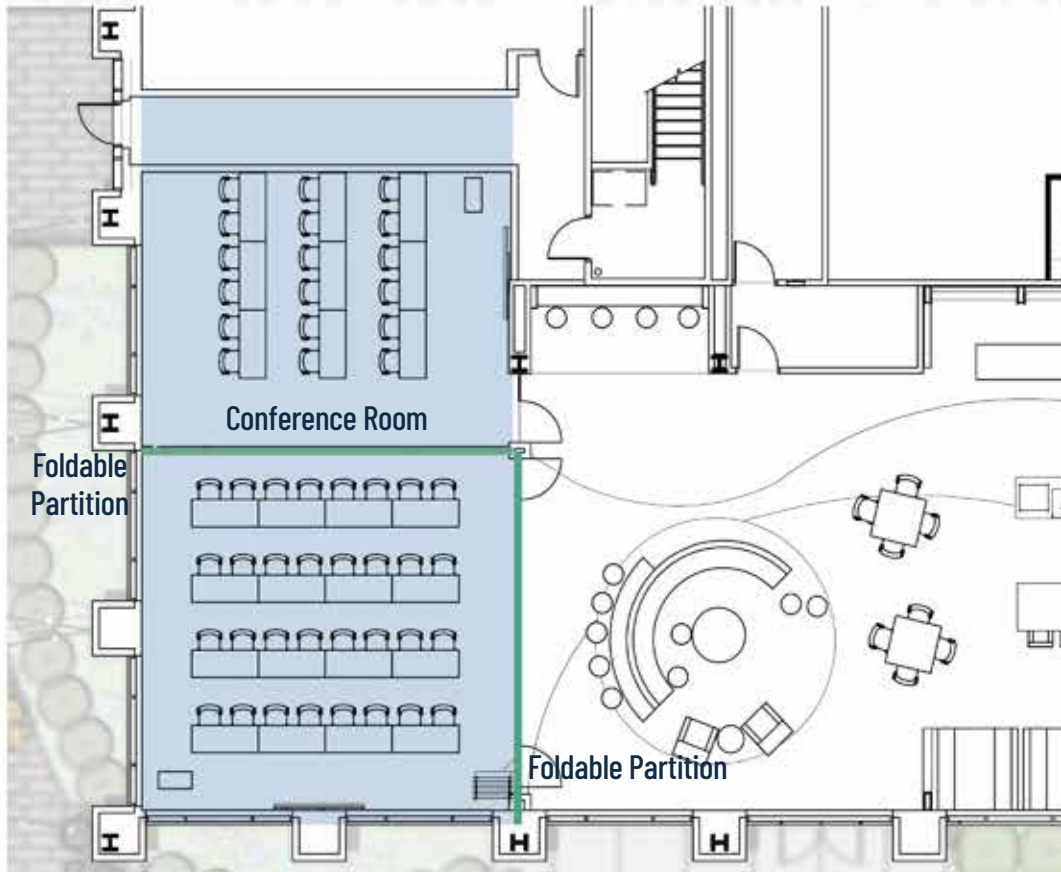

- Combined 50+ person capacity
- Cisco Room Kit Plus with video conferencing
- 2 large format monitors

COMMUNITY KITCHEN WITH COFFEE, NITRO BREW + GAMES



A VARIETY OF COMMUNAL WORK + SOCIAL SPACES



SWEETGREEN OUTPOST— CONVENIENT, MADE FROM SCRATCH, HEALTHY FOOD DELIVERED DAILY

12



sweetgreen  OUTPOST™



SURROUNDING AMENITIES

70+ Restaurants | 7 Hotels | 1.5 Mile Radius

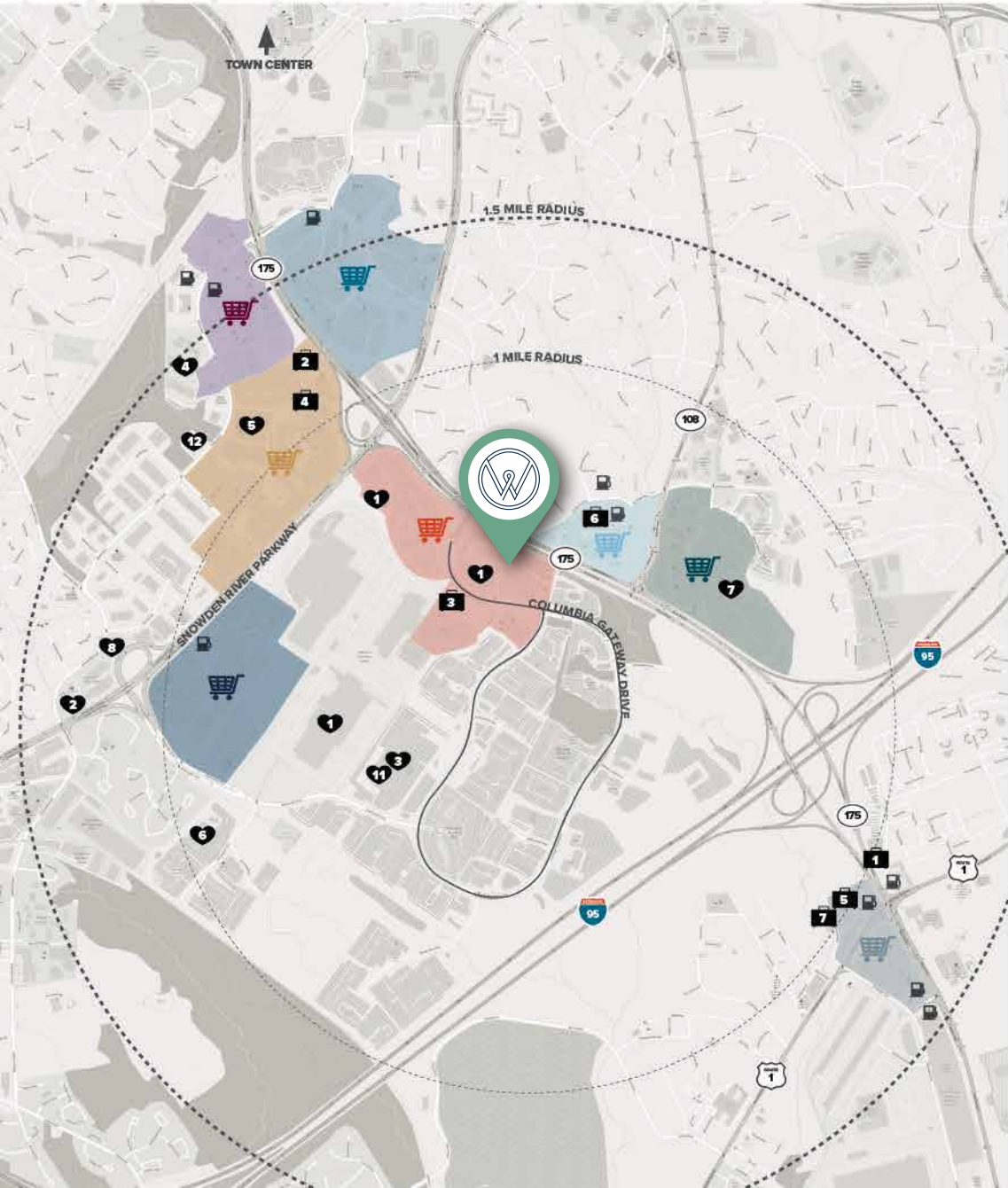

- Columbia Gateway Retail**
- Abby's Gourmet Deli
 - Aida Bistro & Wine Bar
 - Capital Bank
 - The Columbia Bank
 - Dunkin'
 - Flavors of India
 - Kinder Care Learning Center
 - Rudy's Mediterranean Grill

- Columbia Crossing**
- Bank of America
 - BB&T
 - Big Lots
 - BJ's Restaurant & Brewhouse
 - Bob's Discount Furniture
 - Buffalo Wild Wings
 - BurgerFi
 - The Burger Joint
 - California Tortilla
 - Cava
 - Chipotle Mexican Grill
 - Dick's Sporting Goods
 - Famous Dave's
 - FedEx Office
 - Jimmy John's
 - Jo-Ann Fabric
 - La Madeleine Bakery & Café
 - La-Z-boy
 - Long Horn Steakhouse
 - Maiwand Kabob
 - Mission BBQ
 - Noodles & Co.
 - Nordstrom Rack
 - Old Navy
 - Party City
 - PETCO
 - PNC Bank
 - Red Robin
 - Romano's Macaroni Grill
 - Starbucks
 - Subway
 - Target
 - THB Bagelry + Grill
 - T.J.Maxx
 - Tutti Frutti

- Columbia Restaurant Park**
- Bob Evans
 - McDonald's
 - Olive Garden
 - Royal Taj
 - TGI Fridays

- Gateway Overlook**
- Aldi
 - Best Buy
 - Capital One
 - Costco & Costco Gas
 - Ethan Allen
 - Five Below
 - Golf Galaxy
 - Jersey Mike's
 - Lowes
 - Massage Envy
 - On The Border
 - The Perfect Pour
 - Road Runner Sports
 - Silver Diner
 - Trader Joe's
 - Ulta
 - Wells Fargo

- Dobbin Road Retail**
- 2nd Ave
 - Advance Auto Parts
 - AT&T
 - Auto Zone
 - Bray & Scarf Appliances and Kitchen
 - Capital One Bank
 - Chick-fil-A
 - Columbia Ale House
 - Destination XL
 - First Watch Café
 - Five Guys Burgers & Fries
 - Frisco Tap House
 - Gamestop
 - Hand & Stone Massage and Facial Spa
 - Lane Bryant
 - M&T Bank

- McDonald's**
- MVA
 - MyEyeDr
 - Nalley Fresh
 - Panera Bread
 - Pei Wei Asian Diner
 - Pie Five Pizza Company
 - Potbelly Sandwich Works
 - Qdoba
 - Quickway Hibachi
 - Roggenart Bakery
 - Ross Dress for Less
 - Sprint
 - Starbucks
 - Sushi King
 - Tropical Smoothies Café
 - Walmart
 - Wendys

- Snowden Square**
- Bed Bath & Beyond
 - Bertucci's Brick Oven
 - BJ's & BJ's Gas
 - Boston Market
 - DSW
 - Dunkin
 - Hobby Lobby
 - Home Depot
 - Homegoods
 - Marshalls
 - Michaels
 - PetSmart
 - Red Lobster
 - Ruby Tuesday
 - Shell
 - Staples
 - Tower Federal Credit Union
 - United Artists Theatres
 - Verizon Wireless

- Stanford Boulevard Retail**
- Cinco de Mayo
 - The Greene Turtle
 - Indigo Indian Cuisine
 - Katana Sushi & Thai
 - Mango Grove
 - Neo Pizza & Taphouse
 - Nottingham's Tavern

- Route 1 Retail**
- Advanced Auto Parts
 - Cricket
 - Enterprise
 - IHOP
 - Jerry's Subs & Pizza
 - McDonald's
 - MOM's Organic Market
 - Ollie's Bargain Outlet
 - Panda Express
 - Squisitos
 - Starbucks
 - Xfinity

- Hotels**
- 1 Comfort Inn & Suites
 - 2 Courtyard by Marriott
 - 3 Extended Stay America
 - 4 Extended Stay America
 - 5 Holiday Inn
 - 6 Homewood Suites
 - 7 La Quinta Inn & Suites

- Fitness/Recreation**
- 1 COPT FitSpot
 - 2 Curves
 - 3 Earth Treks Climbing Center
 - 4 Gymboree Play & Music
 - 5 Krav Maga
 - 6 Life Time Fitness
 - 7 Gold's Gym
 - 8 My Gym
 - 9 Orangetheory Fitness
 - 10 Planet Fitness
 - 11 SoFive Soccer Center
 - 12 Top Tier Fitness

- Hotels**
- 1 Riverside Coffee
 - 2 Smoothie King
 - 3 Stanford Grill
 - 4 Texas Roadhouse
 - 5 Wegmans

COLUMBIA GATEWAY AMENITIES

Conferencing | Fitness Centers | Delis + Restaurants | Banks | Child Care

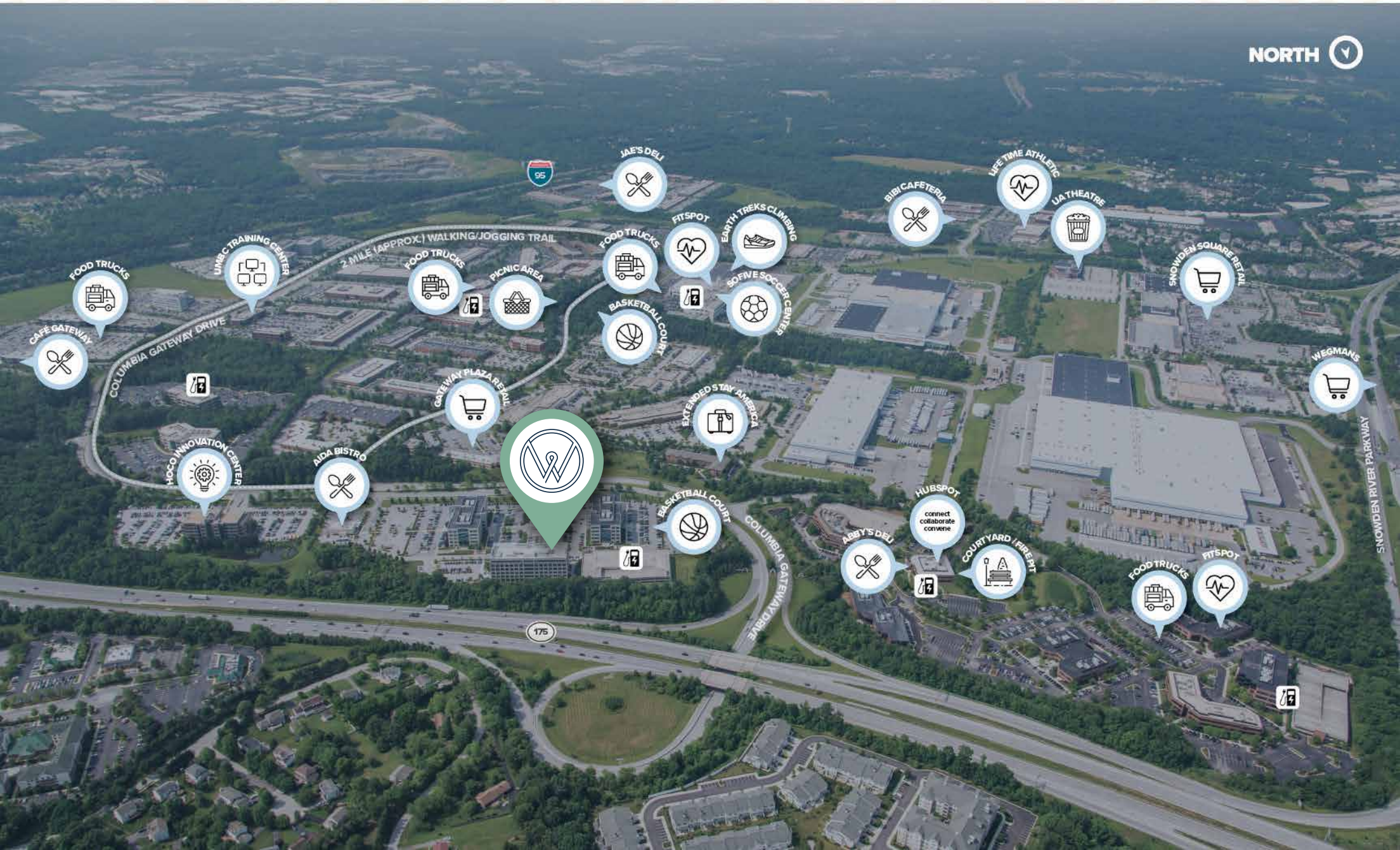

NORTH

- CAFÉ GATEWAY
- FOOD TRUCKS
- UNBC TRAINING CENTER
- 2-MILE (APPROX.) WALKING/JOGGING TRAIL
- FOOD TRUCKS
- PICNIC AREA
- JA'S DELI
- FOOD TRUCKS
- FITSPOT
- EARTH TREKS CLIMBING
- BASKETBALL COURT
- SOFIE SOCCER CENTER
- BIBI CAFETERIA
- LIFE TIME ATHLETIC
- UA THEATRE
- SNOWDEN SQUARE RETAIL
- WEGMANS
- EXTENDED STAY AMERICA
- HUBSPOT
connect
collaborate
convene
- COURTYARD / FRESH
- FOOD TRUCKS
- FITSPOT
- MOO INNOVATION CENTER
- NIDA BISTRO
- W
- ABBY'S DELI
- BASKETBALL COURT
- W
- W

COPT AMENITIES

Exclusively Available to COPT Tenants

HubSpot

A contemporary conference center outfitted with all the essentials for events and conferences

- Wifi- and AV-equipped flexible space
- Collaborative seating accommodates 50 people
- Pre-function lounge + catering kitchen
- Outdoor space with fire pit
- Onsite café
- Abundant free parking
- EV charging stations



Working for the Weekday

Signature programming and practical perks curated by COPT, from festive pop-ups to outstanding onsite services and impactful community initiatives

Tenant App Coming Soon!



LEASING

Krysta Herring

443.285.5709 | krysta.herring@copt.com

John Hermann

443.285.5711 | john.hermann@copt.com



 COPT

