



# INDUSTRIAL - FLEX OFFICE SPACE FOR LEASE:

±1,695 - ±16,653 SF OFFICE AVAILABLE

**Steven Leonard**  
Managing Director  
+1 415 722 1080  
steven.leonard@cushwake.com  
Lic #: 00909604

**Brian Foster**  
Executive Director  
+1 415 451 2437  
brian.foster@cushwake.com  
Lic #: 01393059

**Trevor Buck**  
Executive Managing Director  
+1 415 451 2436  
trevor.buck@cushwake.com  
Lic #: 01255462

**Drew Soltis**  
Associate  
+1 415 451 2415  
drew.soltis@cushwake.com  
Lic #: 02163430

1341-1353 REDWOOD WAY

**THE REDWOODS**

...

**PETALUMA, CA**



## PROPERTY HIGHLIGHTS

- **1351 Suite B + 1353 Suite A**
  - ±10,453 SF expandable to ±16,653 SF
- **1353 Suite B**
  - ±1,695 SF
  - 3 window-lined offices
  - Possibility to add bathroom
- Rent - \$1.20/RSF NNN
- Approximately 242 parking spaces
- Shared dock high loading
- Grade level loading door
- Park-like setting surrounded by mature redwood trees
- North Petaluma location near the intersection of North McDowell Blvd and Old Redwood Highway
- In the heart of Redwood Business Park & Amenities



# AVAILABILITIES

## **Suite 1353 A**

±6,200 RSF Industrial  
Can be added to Suite 1351 B  
for a total of ±16,653 RSF

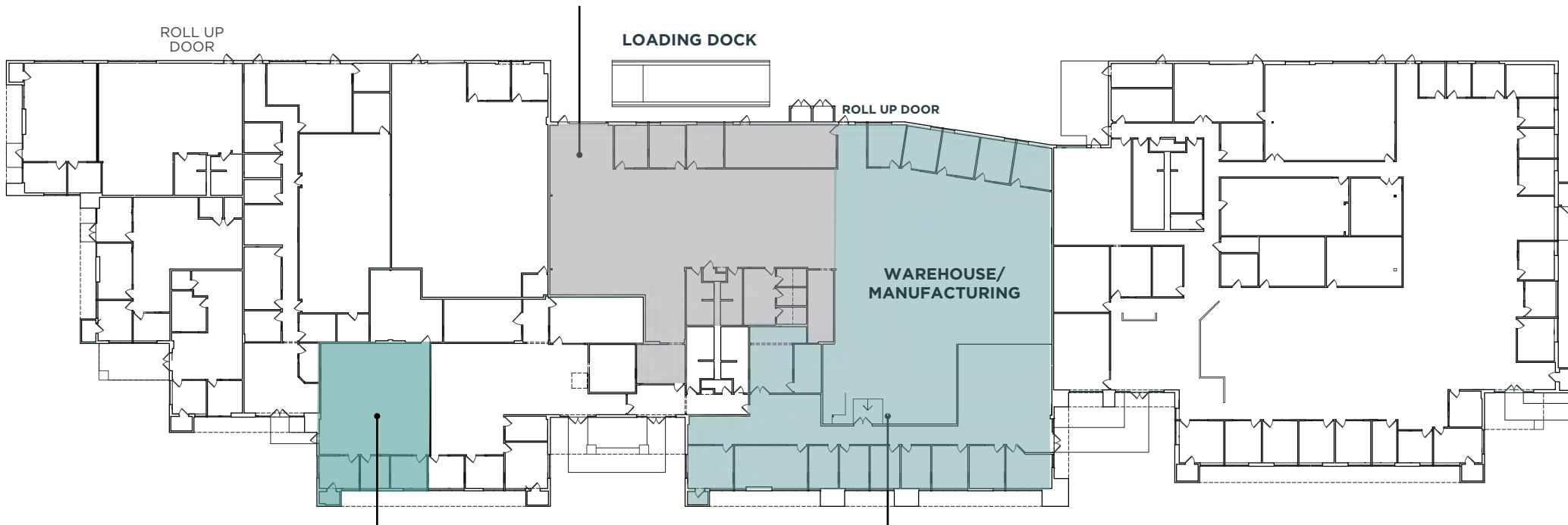

## **Suite 1353 B**

±1,695 RSF  
Office

## **Suite 1351 B**

±10,453 RSF  
Office/Industrial

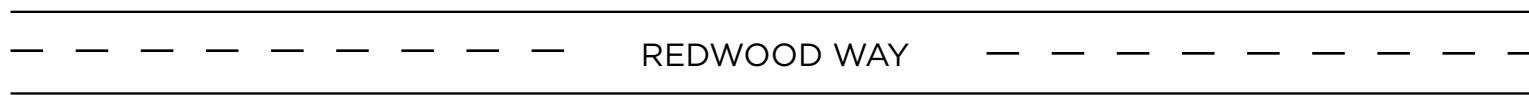

# SUITE 1351B PHOTOS



# REPRESENTATION OF CLEAR HEIGHT

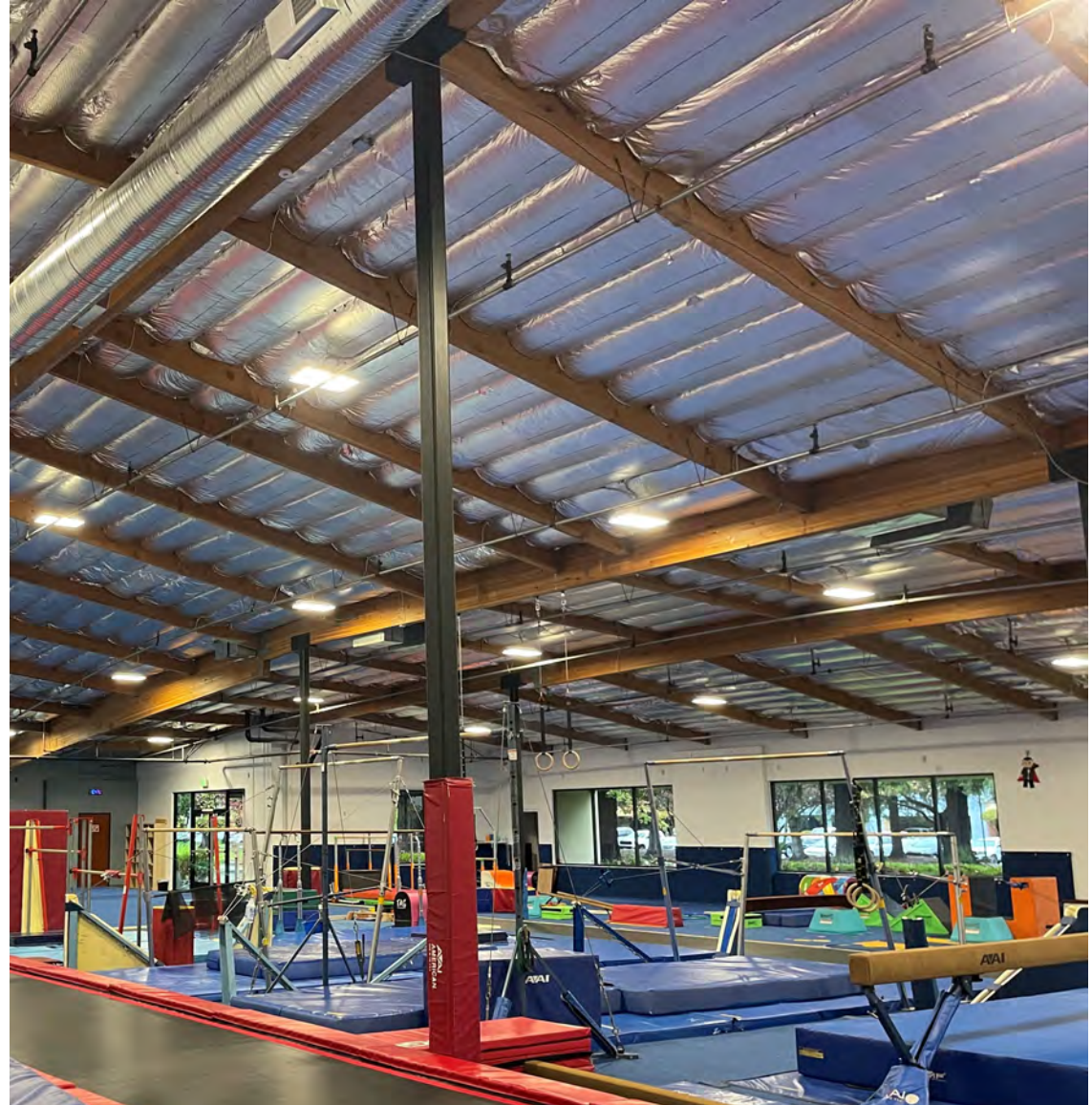



# INDUSTRIAL - FLEX OFFICE SPACE FOR LEASE:

±1,695 - ±16,653 SF OFFICE AVAILABLE

**Steven Leonard**  
Managing Director  
+1 415 722 1080  
steven.leonard@cushwake.com  
Lic #: 00909604

**Brian Foster**  
Executive Director  
+1 415 451 2437  
brian.foster@cushwake.com  
Lic #: 01393059

**Trevor Buck**  
Executive Managing Director  
+1 415 451 2436  
trevor.buck@cushwake.com  
Lic #: 01255462

**Drew Soltis**  
Associate  
+1 415 451 2415  
drew.soltis@cushwake.com  
Lic #: 02163430

1341-1353 REDWOOD WAY

**THE REDWOODS**

...  
**PETALUMA, CA**