

590 SMITH STREET, BROOKLYN, NY 11231

FOR LEASE

7,000 - 14,000 SF SECOND & THIRD FLOOR FLEX OFFICE SPACES

Between Bay Street & Creamer Street



\$18/SF

SHLOMI BAGDADI
212.433.3355 x101
sb@tristatecr.com

FRED BETESH
212.433.3355 x115
fred.b@tristatecr.com

JACK SARDAR
212.433.3355 x106
jack.s@tristatecr.com

TRI STATE COMMERCIAL®

PROPERTY SUMMARY

LOCATION

Located in the Redhook neighborhood of Brooklyn.

SPACE DETAILS

- Price: \$18/SF
- Elevator, 3,500 LB with Wide 42 Inch Door
- 2 Egress
- Sprinkler
- Ceiling Height Second Floor: 12 FT
- Ceiling Height Third Floor: 9.5 FT

TRANSPORTATION

F **G** Trains at Smith – 9th Street

X37 **B61** **B57** **B37** Bus Lines

NEIGHBORS

Harbor Freight, Lumber Liquidators, Lowe's Home Improvement, Stone Street Coffee Company, Claudio's Kitchen, PlayWell Brooklyn, The Secret Science Club, The Secret Science Club, Liberty Industrial Gases and Welding Supply Inc., and more!



FLOOR PLANS

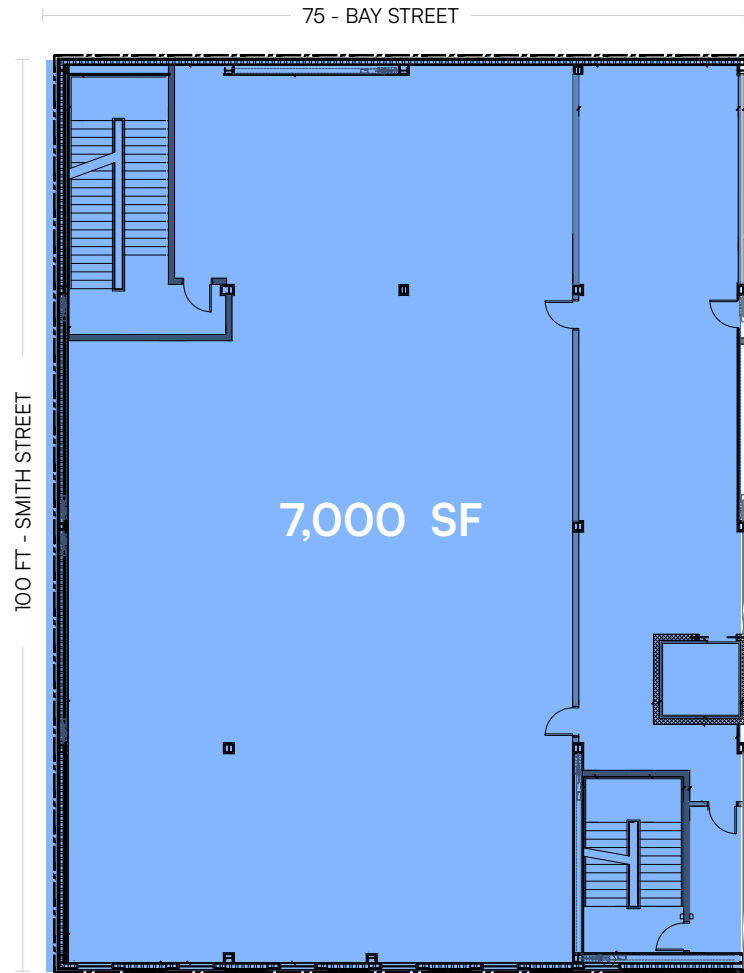

SECOND FLOOR

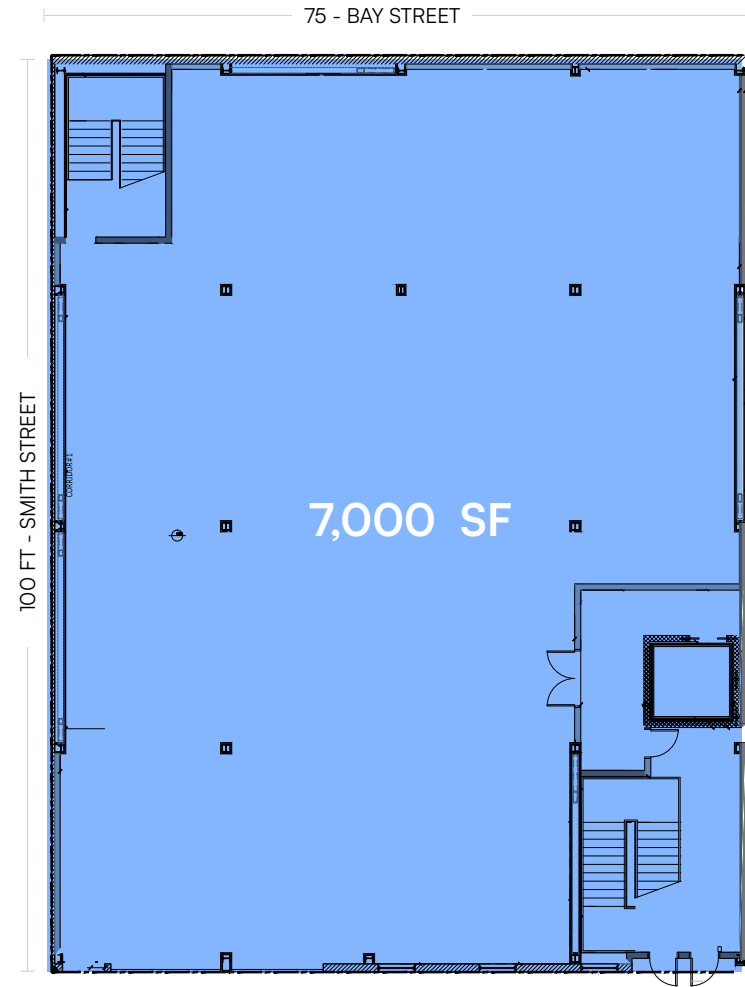

THIRD FLOOR

All square footages are approximate

PROPERTY PHOTOS



RETAIL MAP

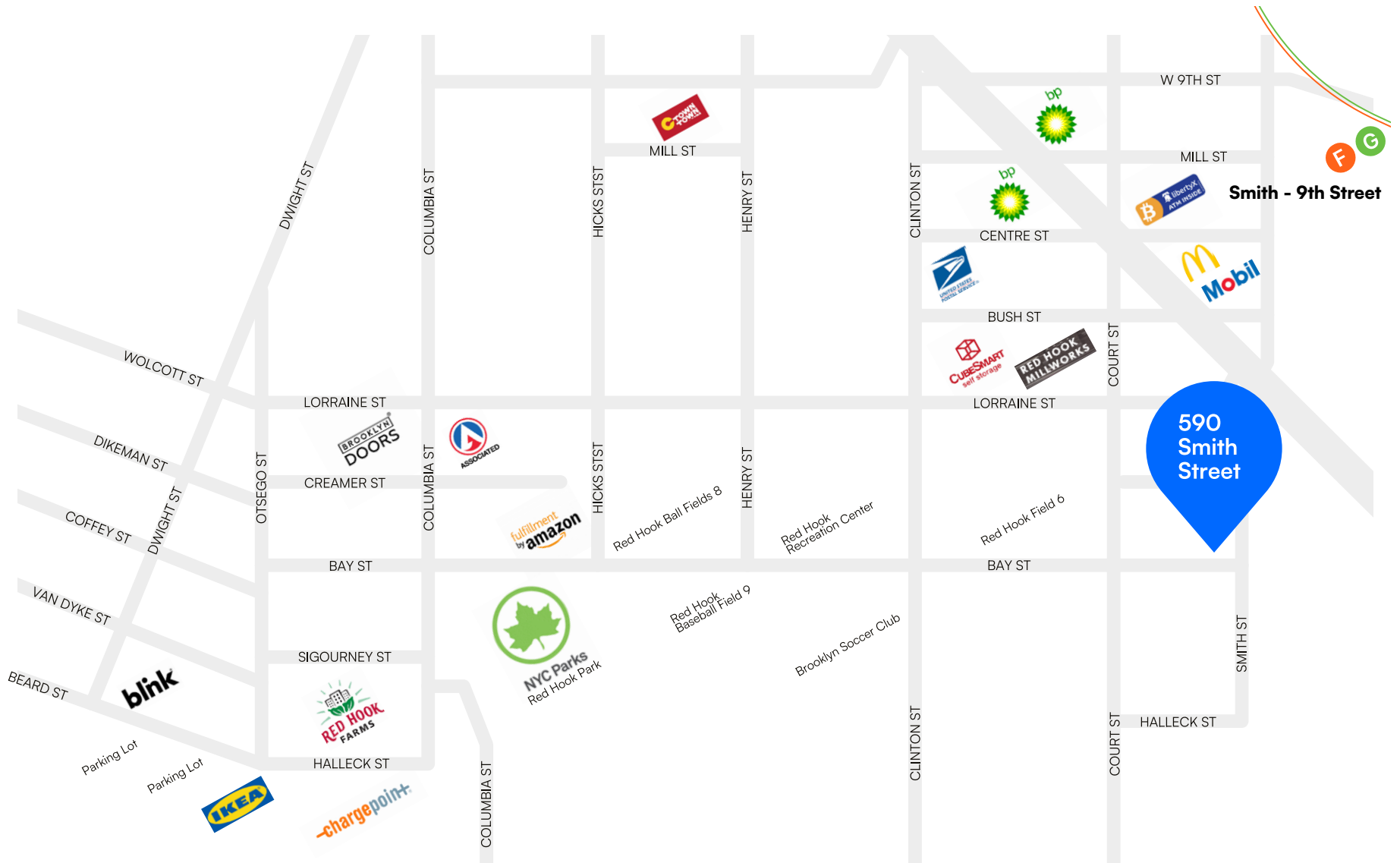

590 SMITH STREET, BROOKLYN, NY 11231

7,000 - 14,000 SF SECOND & THIRD FLOOR FLEX OFFICE SPACES

Between Bay Street & Creamer Street

For Pricing Call: **212.433.3355**

SHLOMI BAGDADI
212.433.3355 x101
sb@tristatecr.com

FRED BETESH
212.433.3355 x115
fred.b@tristatecr.com

JACK SARDAR
212.433.3355 x106
jack.s@tristatecr.com

TSC.