

Livermore Airway Business Park

TERRENCE J. ROSE, INC.
REAL ESTATE

INVESTMENT & DEVELOPMENT

L I V E R M O R E , C A L I F O R N I A



232 & 240 Lindbergh Ave.

Project 3

14,960+/- Sq. Ft.

**Light
Industrial
Warehouse
Space for
Lease**

Convenient I-580/Airway Blvd.
Freeway Accessibility

Local Property Management

Unit Size 14,960+/- Sq. Ft.

38 Parking Stalls Included

Tenant Controlled HVAC

Fire Sprinklered & Insulated

Comcast & AT&T Availability

- (2) 12' x 14' Grade Level & (2) 12' x 16' Dock High Roll-Up Doors
- 18'-20' Interior Clearance
- 200 Amps/208V, 3-Phase Power
- Nearby Tenant Services, Restaurants, Wineries, Golf Courses, Tower-Controlled Airport, and 24 Hr. Fitness

For Information Contact:

Jennifer Walker / Laurie Close Smith

Phone 925 455 1234 • Fax 925 455 1546

E-Mail: jwalker@tjrinc.com / lsmith@tjrinc.com

Website: www.tjrinc.com

2600 Kitty Hawk Road, Suite 100, Livermore, California 94551

Project 3 - 232 & 240 Lindbergh Ave.

L I V E R M O R E , C A L I F O R N I A

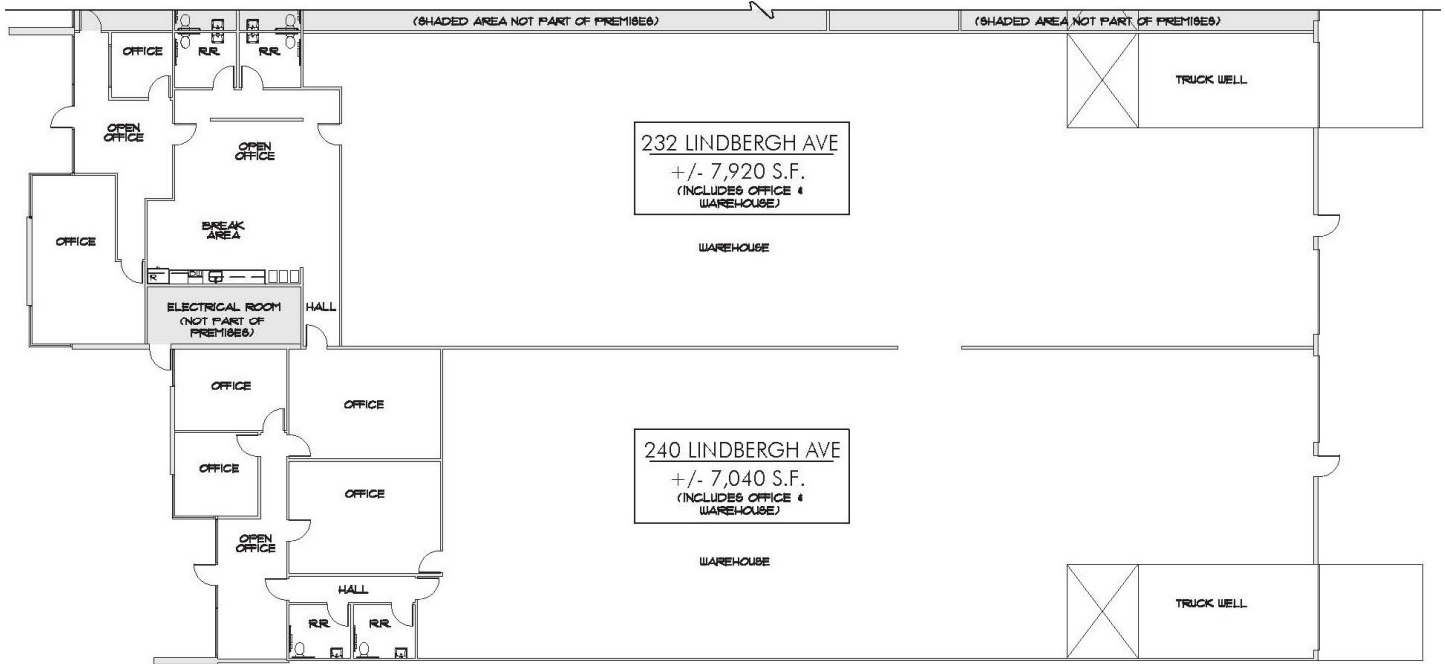

(Floor plan accuracy not warranted and may be changed or updated without notice.)

Available Space

232 & 240 Lindbergh Ave. - \$1.55 Sq. Ft., + CAM

(Rates, terms, and availability subject to change or withdrawal without notice.)

Map

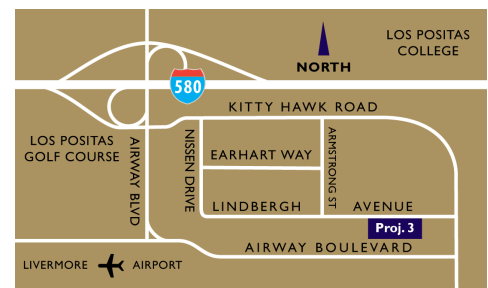

MAP NOT TO SCALE

TERRENCE J. ROSE, INC.
REAL ESTATE

INVESTMENT & DEVELOPMENT

For Information Contact:

Jennifer Walker / Laurie Close Smith

Phone 925 455 1234 • Fax 925 455 1546

E-Mail: jwalker@tjrinc.com / lsmith@tjrinc.com

Website: www.tjrinc.com

2600 Kitty Hawk Road, Suite 100, Livermore, California 94551