

RETAIL / OFFICE AVAILABLE FOR LEASE: 395 – 3,291 SF



Property Highlights

- Excellent S. Bascom Opportunity
- New Ownership!
- Renovations in Progress
- Excellent Visibility
- On-Site Parking
- Burbank Area of SJ
- Prominent Storefront Signage
- High Traffic Area
- Easy Access to Hwy 880 & 280



461-481 S. Bascom, San Jose, CA

www.globalcommercialprop.com

RALPH LONGO
408-529-1362

DRE #01202211

RLONGO@GLOBALCOMMERCIALPROP.COM

RETAIL / OFFICE AVAILABLE FOR LEASE: 395 – 3,291 SF

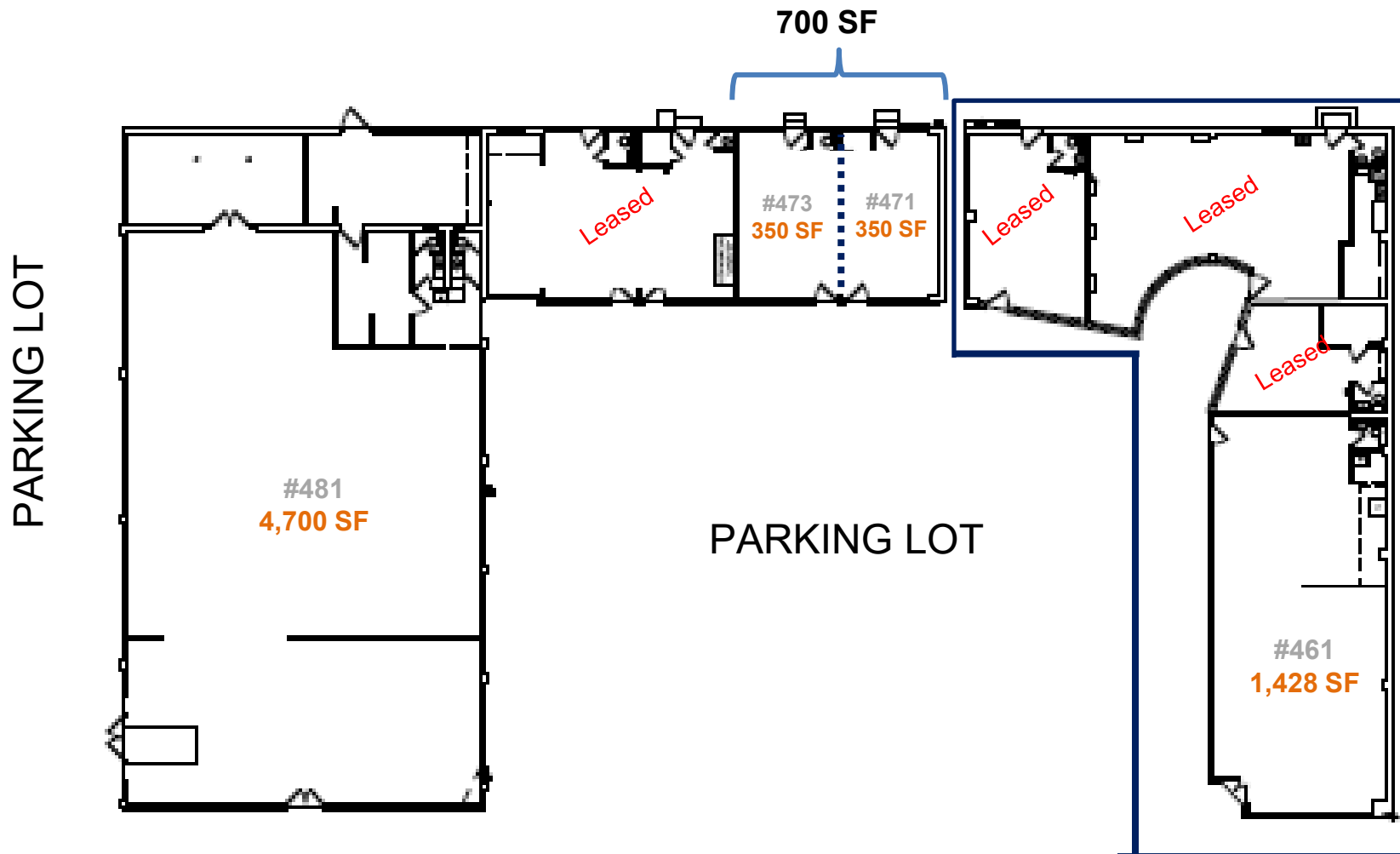

RETAIL / OFFICE AVAILABLE FOR LEASE: 395 – 3,291 SF



RETAIL / OFFICE AVAILABLE FOR LEASE: 395 – 3,291 SF

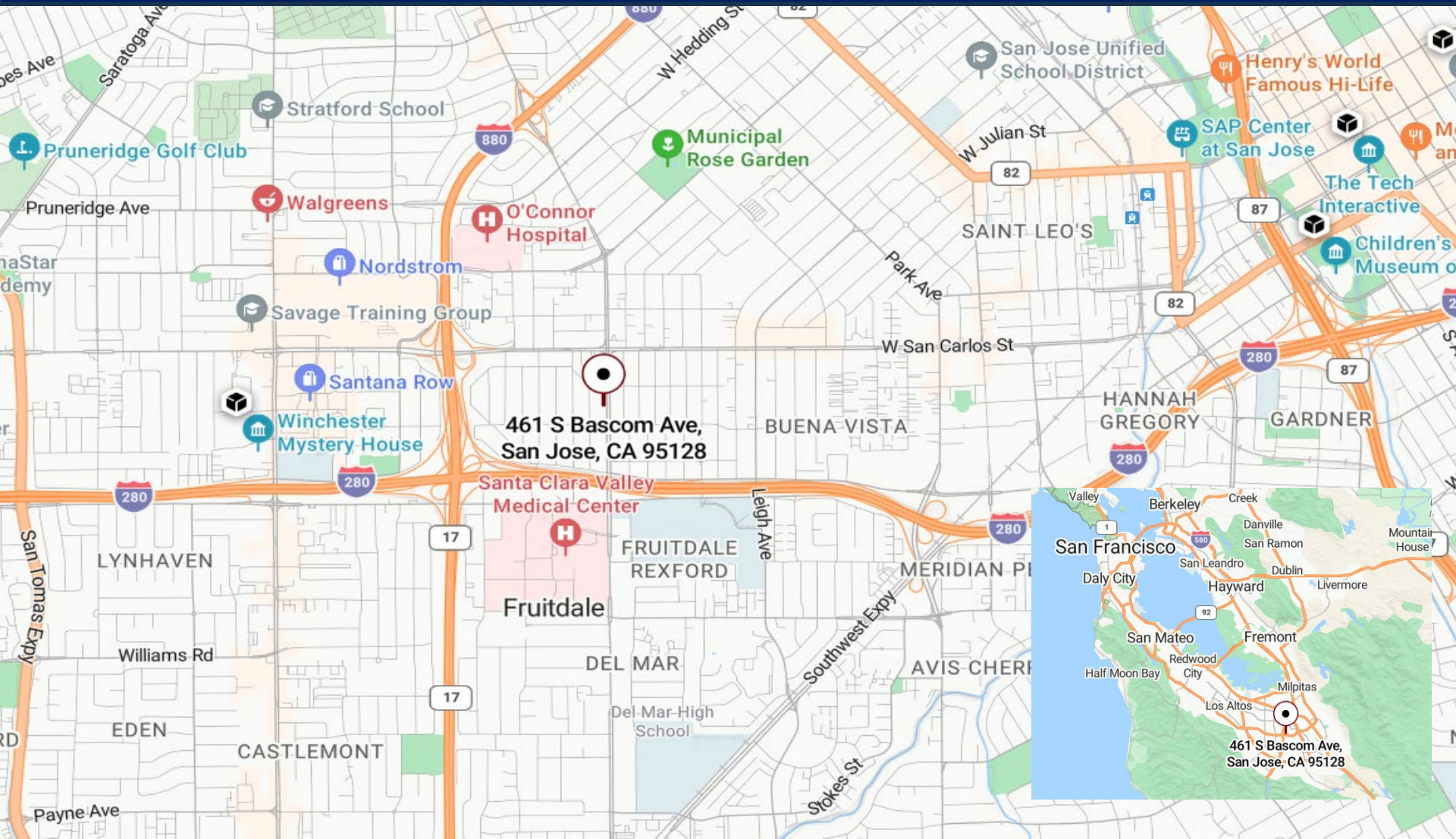

GLOBAL
COMMERCIAL

461-481 S. Bascom, San Jose, CA

www.globalcommercialprop.com

RALPH LONGO
408-529-1362

DRE #01202211

RLONGO@GLOBALCOMMERCIALPROP.COM