

# COLUMN FREE INDUSTRIAL SPACE

500 GRUMMAN ROAD, BETHPAGE NEW YORK  
UNIT 1

**FOR LEASE**



**Frank Frizalone, SIOR**

+1 631 425 1242

[frank.frizalone@cushwake.com](mailto:frank.frizalone@cushwake.com)

**Nick Gallipoli**

+1 631 926 2868

[nickg@cushwake.com](mailto:nickg@cushwake.com)



## Unit 1 Specifications

<b>Total Building SF:</b>	29,300 SF
<b>Warehouse Space:</b>	26,800 SF (Column free)
<b>Office Space:</b>	2,500 SF
<b>Ceiling Height:</b>	34' Clear
<b>Power:</b>	Heavy
<b>Loading:</b>	Two (2) Oversized Drive-Ins
<b>Sprinkler System:</b>	ESFR - High Density
<b>Parking:</b>	Ample
<b>Comments:</b>	<ul style="list-style-type: none"> <li>• Available immediately</li> <li>• Possible to combine Unit 2 (14,000 SF) and Unit 4 (15,000 SF)</li> <li>• Load bearing truss with five-ton overhead crane</li> </ul>

**Frank Frizalone, SIOR**

+1 631 425 1242

frank.frizalone@cushwake.com

**Nick Gallipoli**

+1 631 926 2868

nickg@cushwake.com

**Frank Frizalone, SIOR**

+1 631 425 1242

[frank.frizalone@cushwake.com](mailto:frank.frizalone@cushwake.com)**Nick Gallipoli**

+1 631 926 2868

[nickg@cushwake.com](mailto:nickg@cushwake.com)

# UNIT 1 FLOOR PLAN

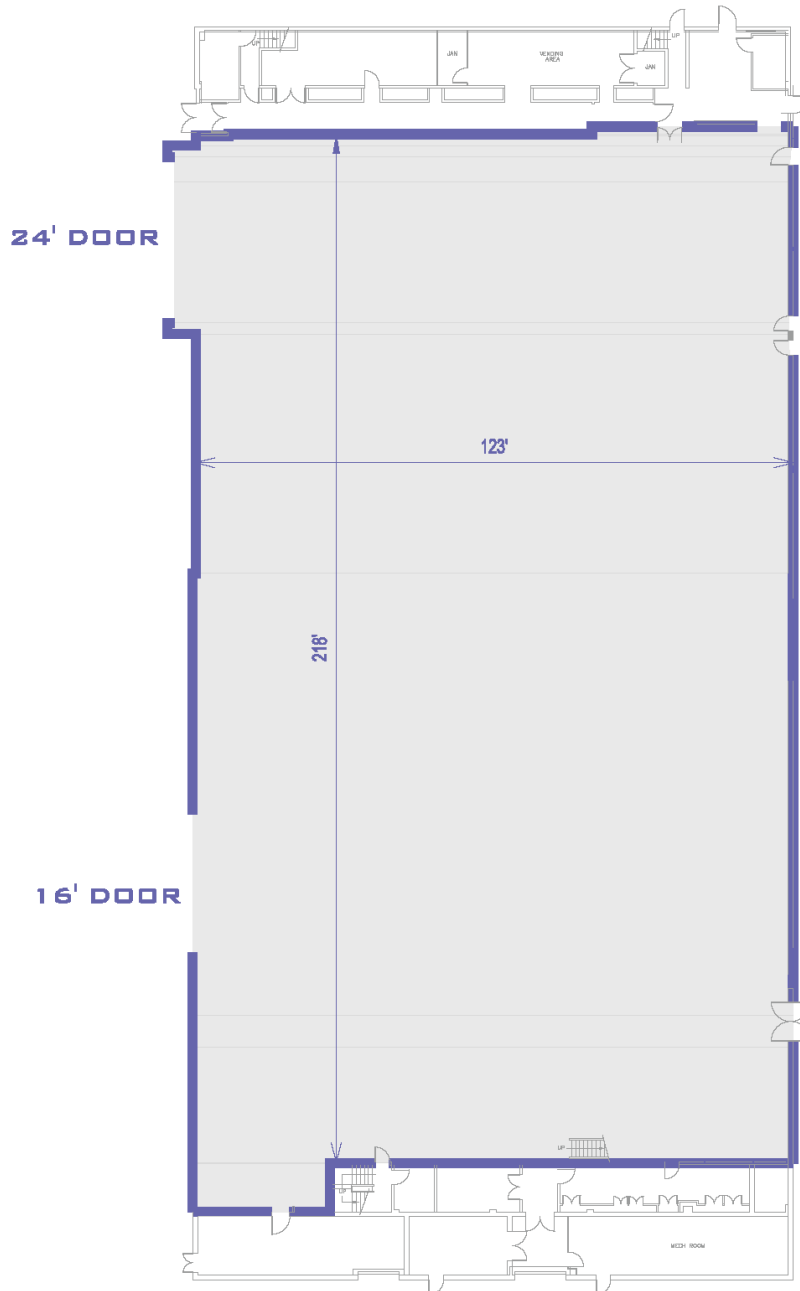

**Frank Frizalone, SIOR**

+1 631 425 1242

frank.frizalone@cushwake.com

**Nick Gallipoli**

+1 631 926 2868

nickg@cushwake.com