

Sant Ambroeus

# 1140 THIRD AVENUE

UPPER EAST SIDE  
NEW YORK, NY

masonre

# OUR TENANTS

Hanley is bringing a downtown edge to the Upper East Side with a curated mix of luxury retail, restaurant, beauty and boutique-fitness brands. Alo Yoga and clean beauty brand Credo, selected Hanley for their first uptown stores. Joined by Aesop, Solidcore, Bondi Sushi, and Madison Reed. The collection has one remaining space with 855 SF available today.



# THE OPPORTUNITY

## DETAILS

### APPROXIMATE SIZE

Space A  
Ground Floor 855 SF  
Lower Level 809 SF

### CEILING HEIGHTS

Ground Floor 9 FT 6 IN

### POSSESSION

Q4 2026

### NEIGHBORING TENANTS

Lululemon, Bluemercury, Pure Barre, Barry's Bootcamp, Janie and Jack, Bond Vet, Glowbar, SLT, Madewell, Sugared + Bronzed, Whole Foods, and Wonder.

### GROUND FLOOR

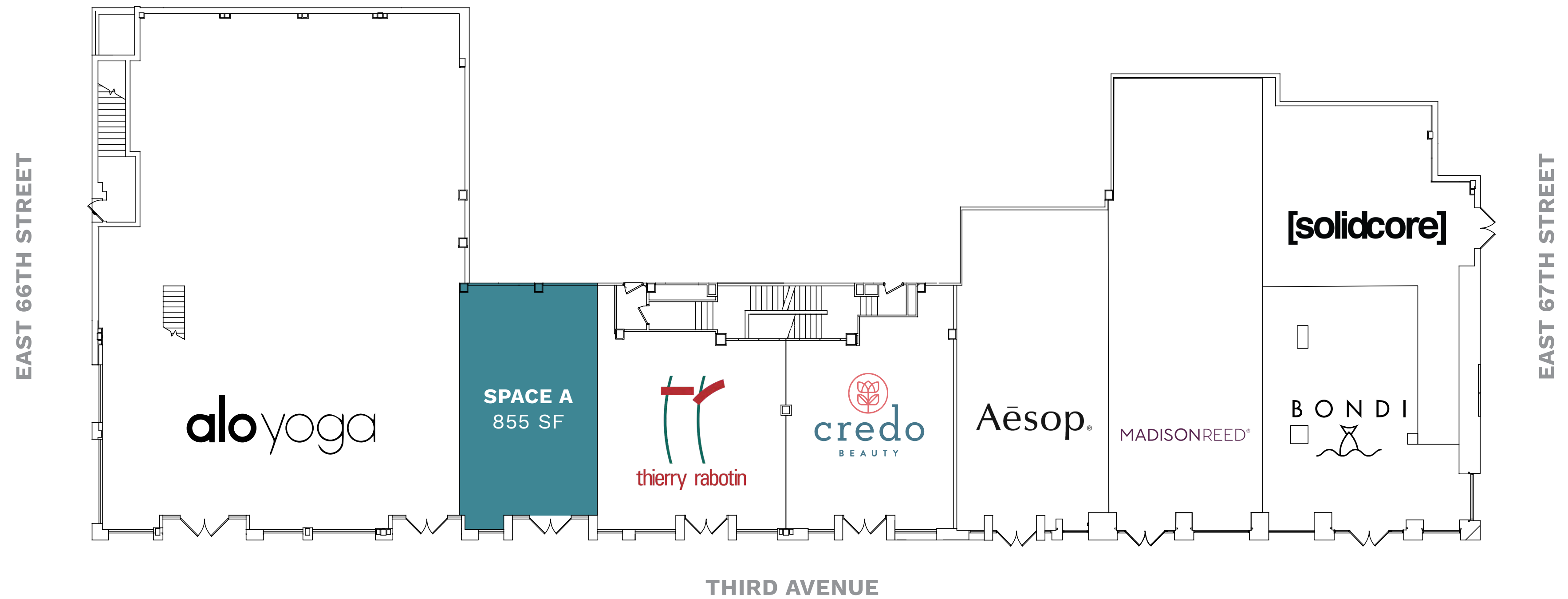

### LOWER LEVEL

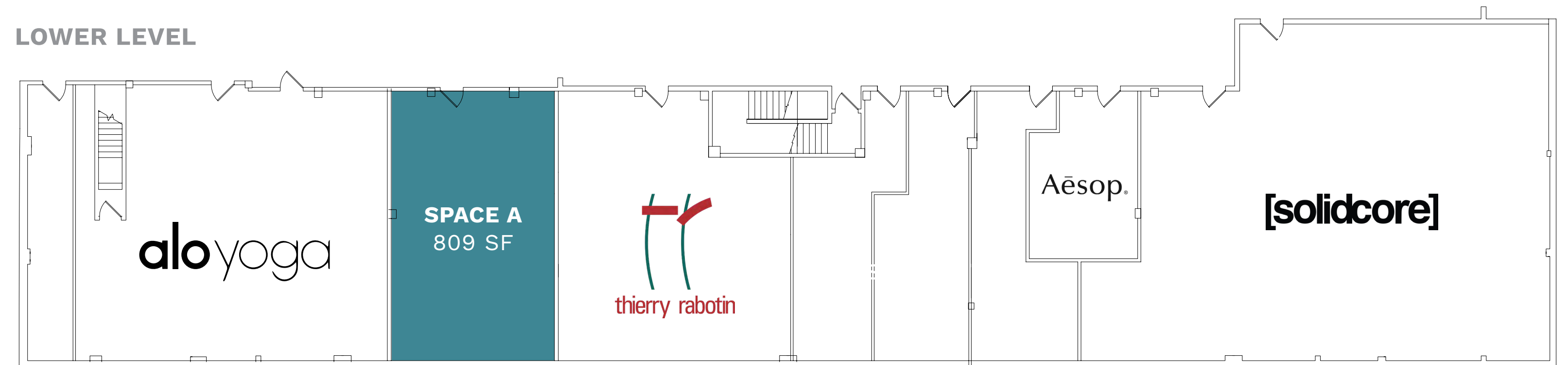

# THE NEIGHBORHOOD

Hanley is easily accessible by all forms of transportation. The 4, 5, 6, N, Q, R and F subway lines are steps away providing convenience from all points on the Upper East Side. The new Q train brings added foot traffic with its new station at East 63rd Street and Third Avenue.

There is a strong day-time population in part from office tenants like Fox Studios and Sotheby's, and many area hospitals including Memorial Sloan Kettering, New York-Presbyterian/Weil Cornell Medical Center and Lenox Hill Hospital. Luxury hotels in the neighborhood, such as The Pierre, The Carlyle, The Mark, The Surrey and Gardens NYC, cater to visiting tourists and diplomats.



# CONTACT EXCLUSIVE AGENTS

## masonre

masonre is a real estate brokerage and advisory firm with a strong history of leading the growth of trophy retail assets and brands in New York City, Miami, and Los Angeles.

[masonre.com](https://masonre.com)

**David Abrams**  
[david@masonre.com](mailto:david@masonre.com)  
212.222.1496

**Jeff Jacobson**  
[jeff@masonre.com](mailto:jeff@masonre.com)  
212.870.6256

