

SHOPPER'S HAVEN

3303-3559 N FEDERAL HIGHWAY POMPANO BEACH, FL 33064

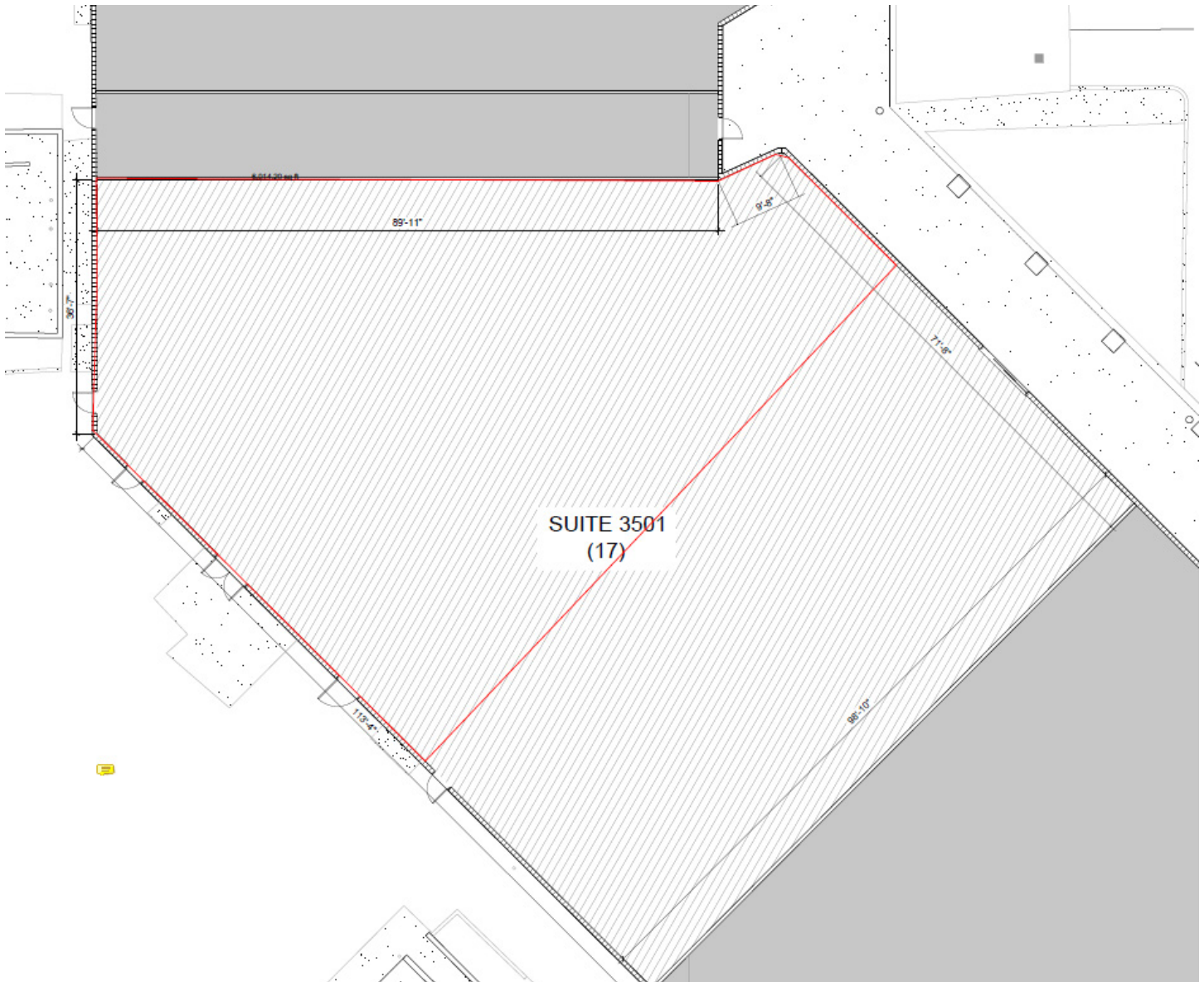

- Space can be split
- Top portion will have 72' of frontage and be offered at \$36 NNN + \$17 PSF
- Bottom portion will have 20'+ of frontage. Due to the shape, space is offered at \$22 NNN + \$10 PSF, delivering approximately 4,000 - 6,000 SF
- Join Publix, Walgreens, and YouFit



Dan Coyle
Dan.Coyle@Stiles.com
954.627.9272

Building Better Retail Experiences
WWW.STILES.COM



STILES
RETAIL GROUP
Invest-Build-Manage

AERIAL

SHOPPER'S HAVEN

3303-3559 N FEDERAL HIGHWAY POMPANO BEACH, FL 33064



Dan Coyle
Dan.Coyle@Stiles.com
954.627.9272

Building Better Retail Experiences



STILES
RETAIL GROUP
Invest·Build·Manage

Licensed Real Estate Broker

NOTE: This offering is subject to errors, omissions, prior sale or withdrawal without notice.

WWW.STILES.COM

SHOPPER'S HAVEN

3303-3559 N FEDERAL HIGHWAY POMPANO BEACH, FL 33064



Dan Coyle
Dan.Coyle@Stiles.com
954.627.9272

Building Better Retail Experiences



STILES
RETAIL GROUP
Invest-Build-Manage

NOTE: This offering is subject to errors, omissions, prior sale or withdrawal without notice.

WWW.STILES.COM

Licensed Real Estate Broker

RETAIL AERIAL

SHOPPER'S HAVEN

3303-3559 N FEDERAL HIGHWAY POMPANO BEACH, FL 33064

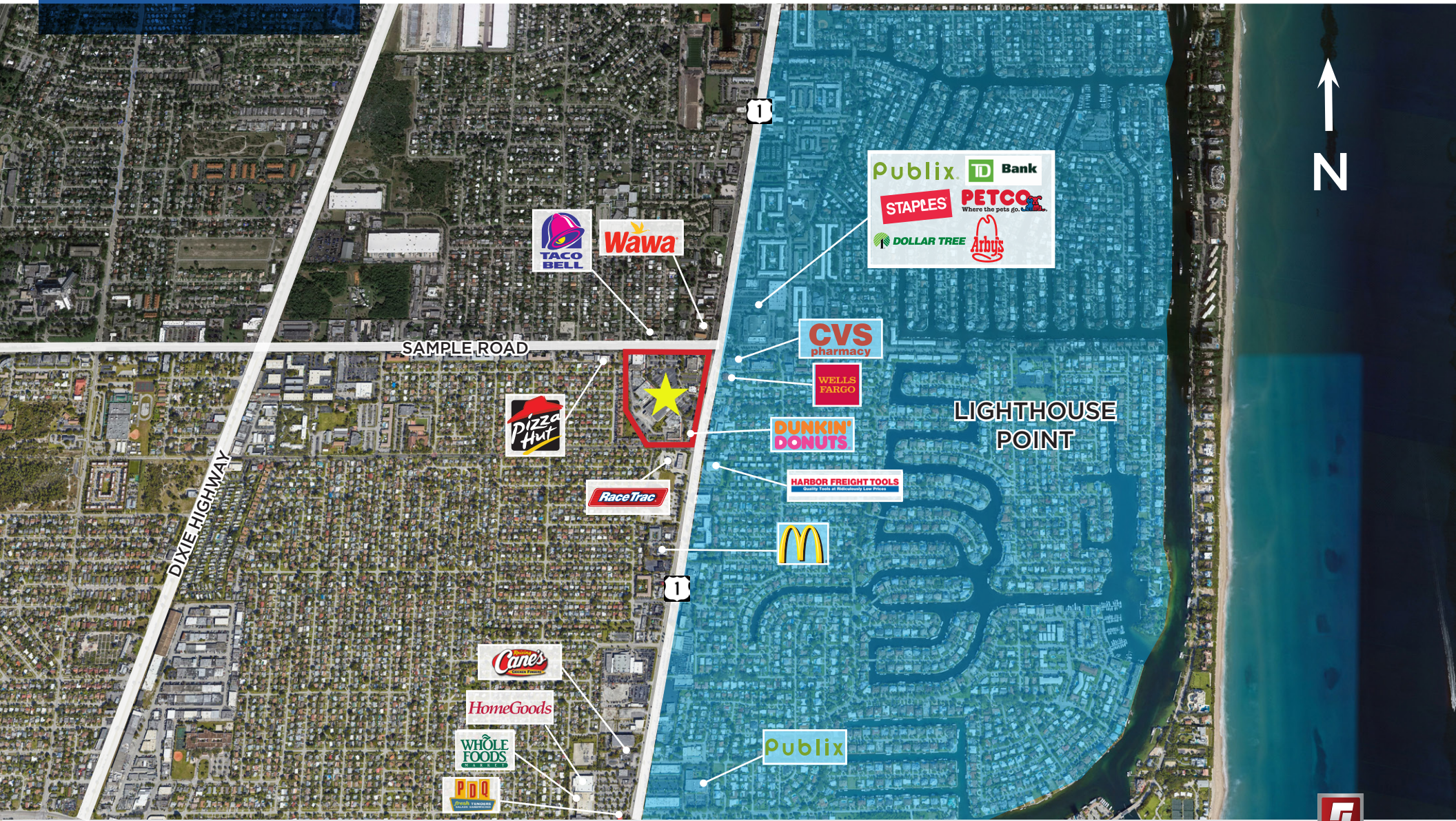

Dan Coyle
Dan.Coyle@Stiles.com
954.627.9272

Building Better Retail Experiences



NOTE: This offering is subject to errors, omissions, prior sale or withdrawal without notice.

WWW.STILES.COM

Licensed Real Estate Broker