

AVAILABLE FOR LEASE

44235

NOBEL DRIVE

FREMONT, CA

Rare ±**34,543 SF**

Industrial End Cap

w/ ±**2.25 Acre** Yard/Parking Area



**New Market Ready
Work Underway!**

YOUR NAME HERE

44247

NEWMARK

Owned and Operated by:









EverWest
REAL ESTATE INVESTORS

510.300.0212 // mike.spiro@nrmk.com

MIKE SPIRO

CA RE Lic #01433395

PROJECT HIGHLIGHTS

-  ±34,543 SF Industrial End Cap
-  ±2.25 Acres Secure Rear Yard / Parking Area
-  Five (5) Dock Doors
-  One (1) Grade Level Door
-  28' Clear Height
-  ±3,610 SF of Brand New Offices
-  500 amps 277/480 volt power (Tenant to Confirm)

-  High Impact Lobby Area
-  3.85/1,000 SF Parking Ratio
-  AT&T High-Speed Fiber Connectivity
-  Prime Auto Mall location within walking distance of Pacific Commons retail, restaurants, & shopping
-  Available Now
-  **Lease Rate: \$1.85/SF NNN**



MARKET-READY FLOOR PLAN



- GRADE LEVEL DOOR
- ▲ DOCK HIGH DOOR

NEW MARK

NOBEL DRIVE

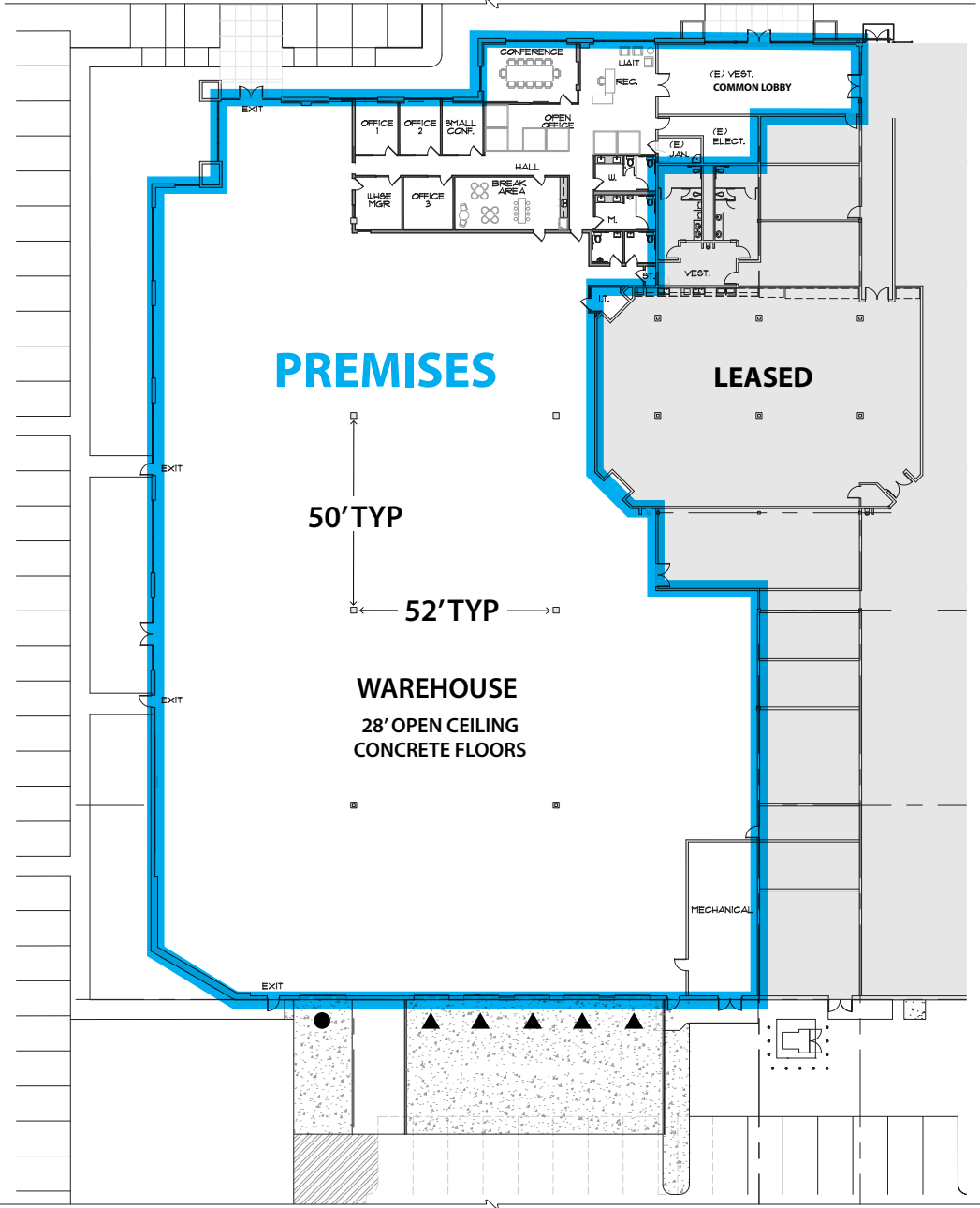

EXISTING FLOOR PLAN



NEW MARK

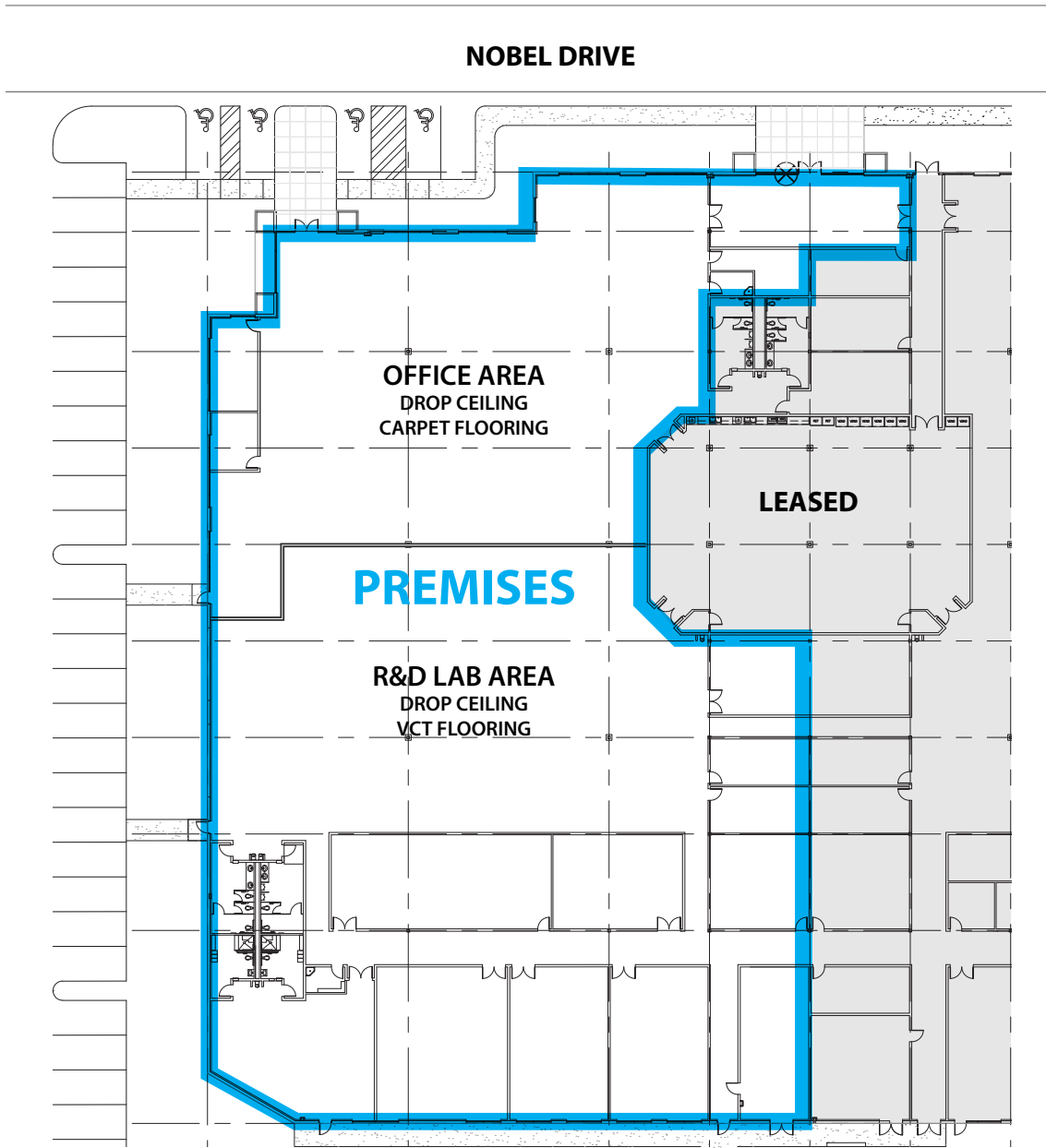

44235 NOBEL DRIVE \\/ FREMONT

Rare ±2.25 Acre Secure Rear Yard / Parking Area



LOCATION MAP

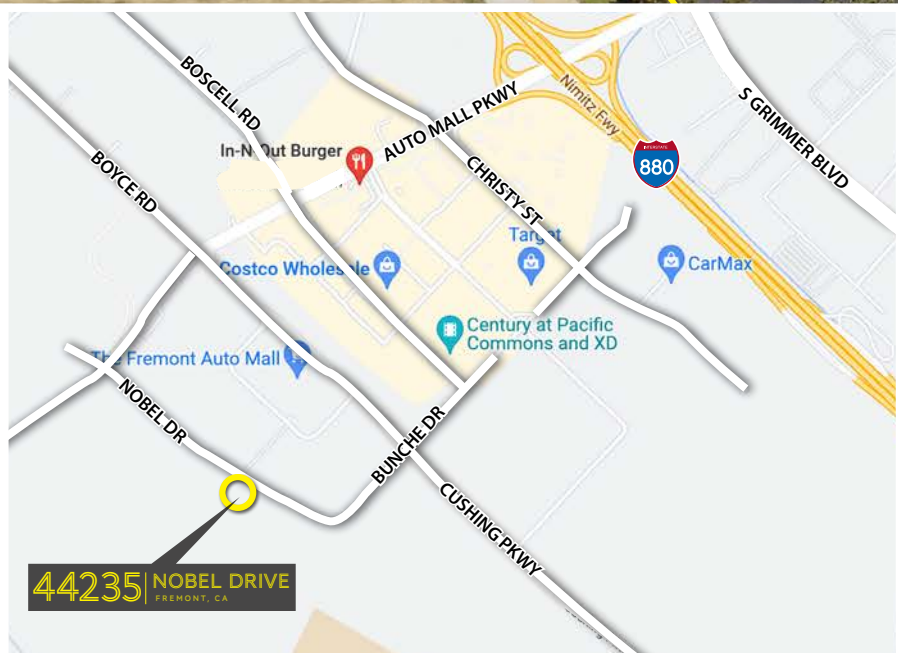

44235 NOBEL DRIVE
FREMONT, CA

44235 NOBEL DRIVE // FREMONT

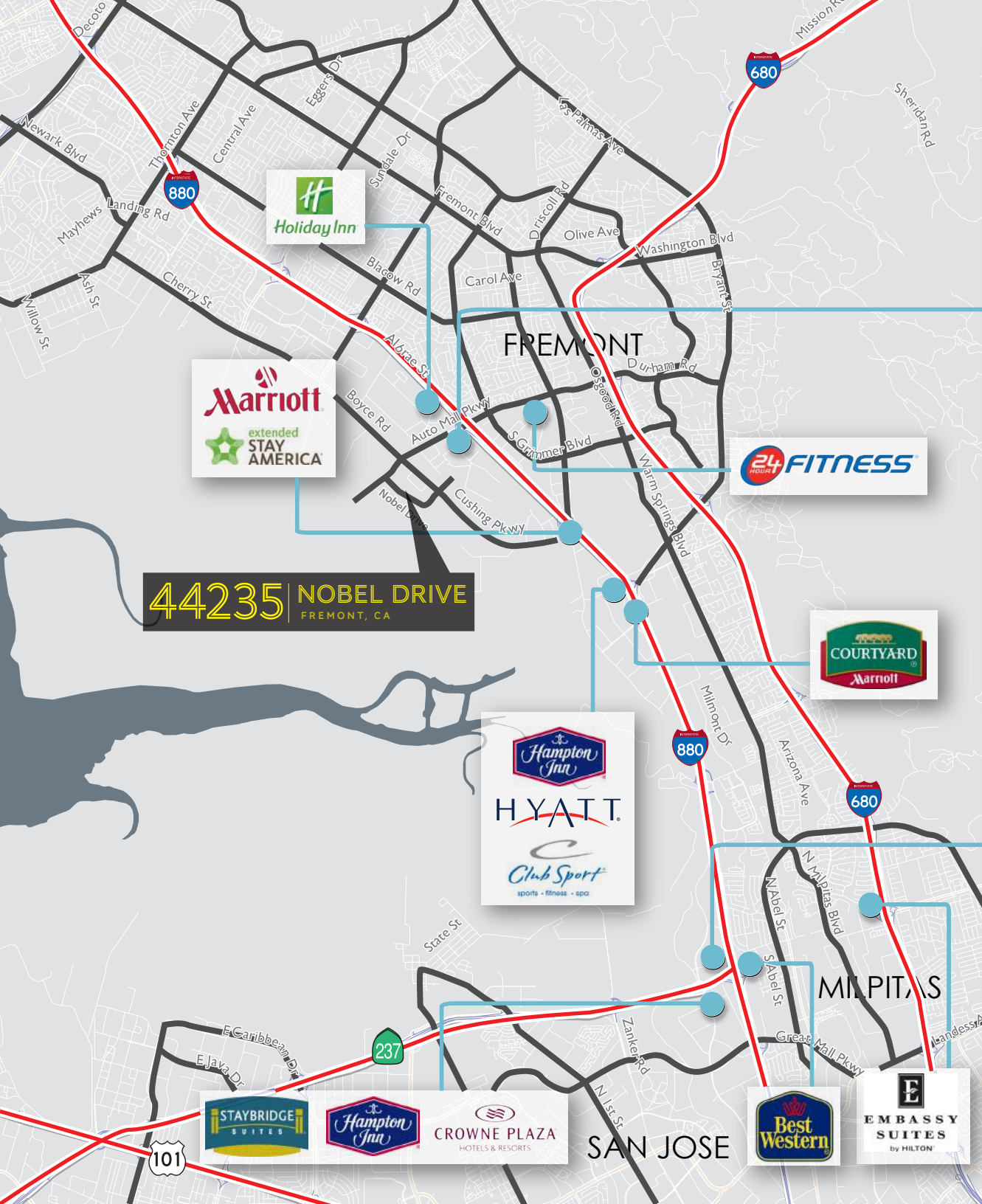

44235 NOBEL DRIVE
FREMONT, CA

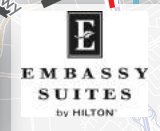
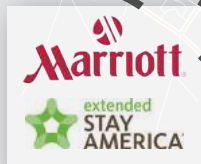

4 4 2 3 5 NOBEL DRIVE // FREMONT

AVAILABLE FOR LEASE



44235
NOBEL DRIVE
FREMONT, CA

NEWMARK

Owned and Operated by:

EverWest
REAL ESTATE INVESTORS

MIKE SPIRO
510.300.0212 // mike.spiro@nrmk.com
CA RE Lic #01433395

The distributor of this communication is performing acts for which a real estate license is required. The information contained herein has been obtained from sources deemed reliable but has not been verified and no guarantee, warranty or representation, either express or implied, is made with respect to such information. Terms of sale or lease and availability are subject to change or withdrawal without notice. 22-0485.08/01