



LENOX PARK - SILVER SPRING

1400 EAST WEST HIGHWAY SILVER SPRING, MARYLAND 20910

RETAIL OPPORTUNITIES AVAILABLE
407 RESIDENTIAL UNITS
LOCATED AT THE INTERSECTION OF EAST-WEST HIGHWAY
& COLESVILLE ROAD IN THE HEART OF SILVER SPRING

1,200 SF AVAILABLE

2,000 SF AVAILABLE

1,461 SF AVAILABLE

ACCESS TO PARKING ON SITE

COLESVILLE RD
9,970 ADT

EAST WEST HWY
21,301 ADT

MATT SKALET
mskalet@klnb.com | 202-420-7775

KELLY ATKINSON
katkinson@klnb.com | 202-420-7762

klnb.com

LOCATION

LENOX PARK - SILVER SPRING

1400 EAST WEST HIGHWAY SILVER SPRING, MARYLAND 20910

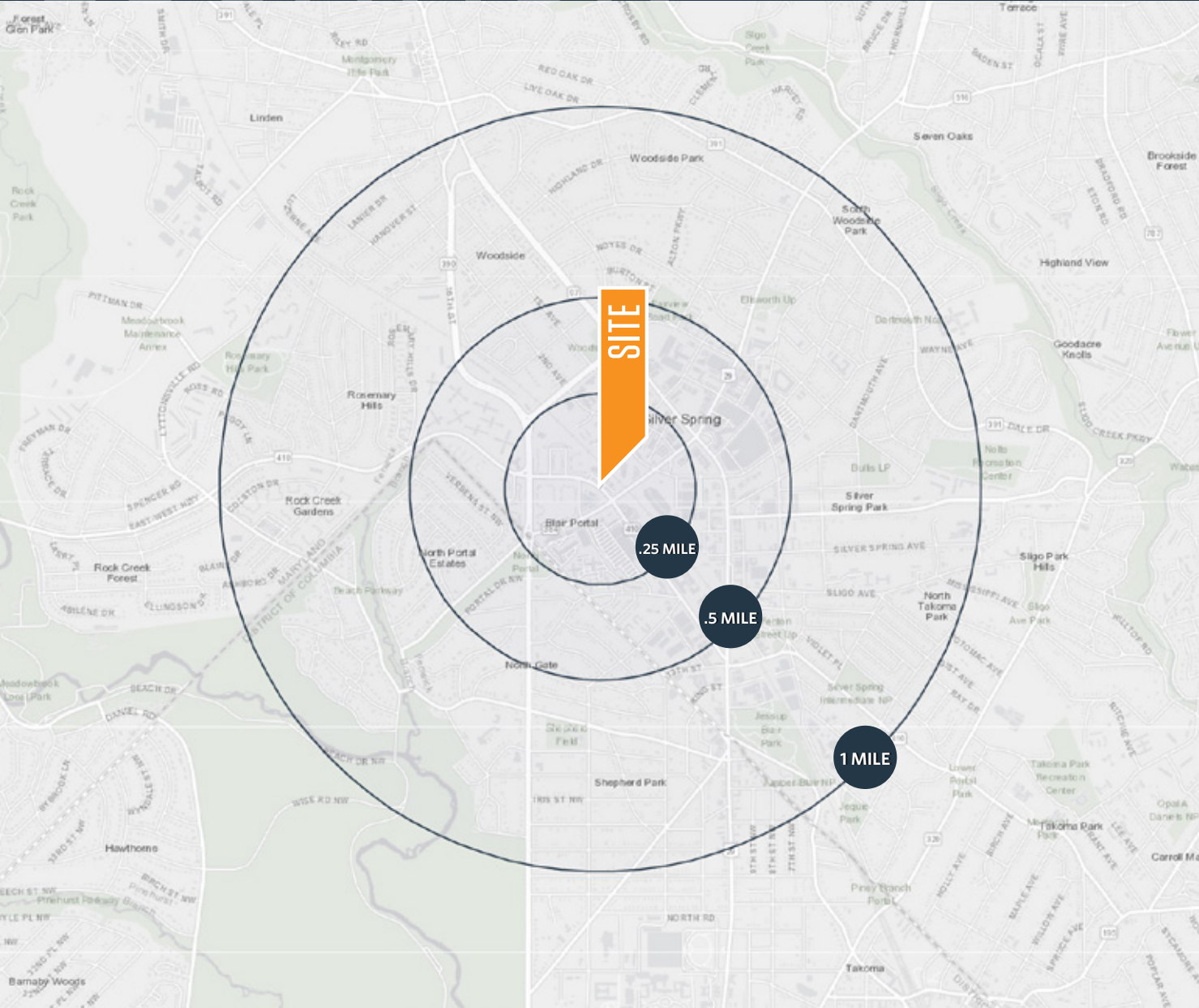

AVAILABLE SPACE

2,000 SF Available Immediately

- Wide open shell condition

1,200 SF Available Immediately

- Wide open shell condition

1,461 SF Available Immediately

- Former massage therapist office

DEMOGRAPHICS | 2025:

WALK TIME

	5 MIN	10 MIN	0.25-MILE	0.5-MILE	1-MILE
Population	5,346	17,625	6,624	18,963	39,089
Daytime Population	6,465	24,526	7,785	26,026	43,156
Households	3,209	10,381	4,038	11,033	19,599
Average HH Income	\$108,894	\$117,460	\$103,142	\$121,132	\$141,381

TRAFFIC COUNTS | 2024:

Colesville Road	9,970 ADT
East-West Hwy	21,301 ADT
Georgia Ave	26,360 ADT



4,536 ADR

MATT SKALET

maskalet@klnb.com | 202-420-7775

KELLY ATKINSON

katkinson@klnb.com | 202-420-7762



SITE PLAN

LENOX PARK - SILVER SPRING

1400 EAST WEST HIGHWAY SILVER SPRING, MARYLAND 20910

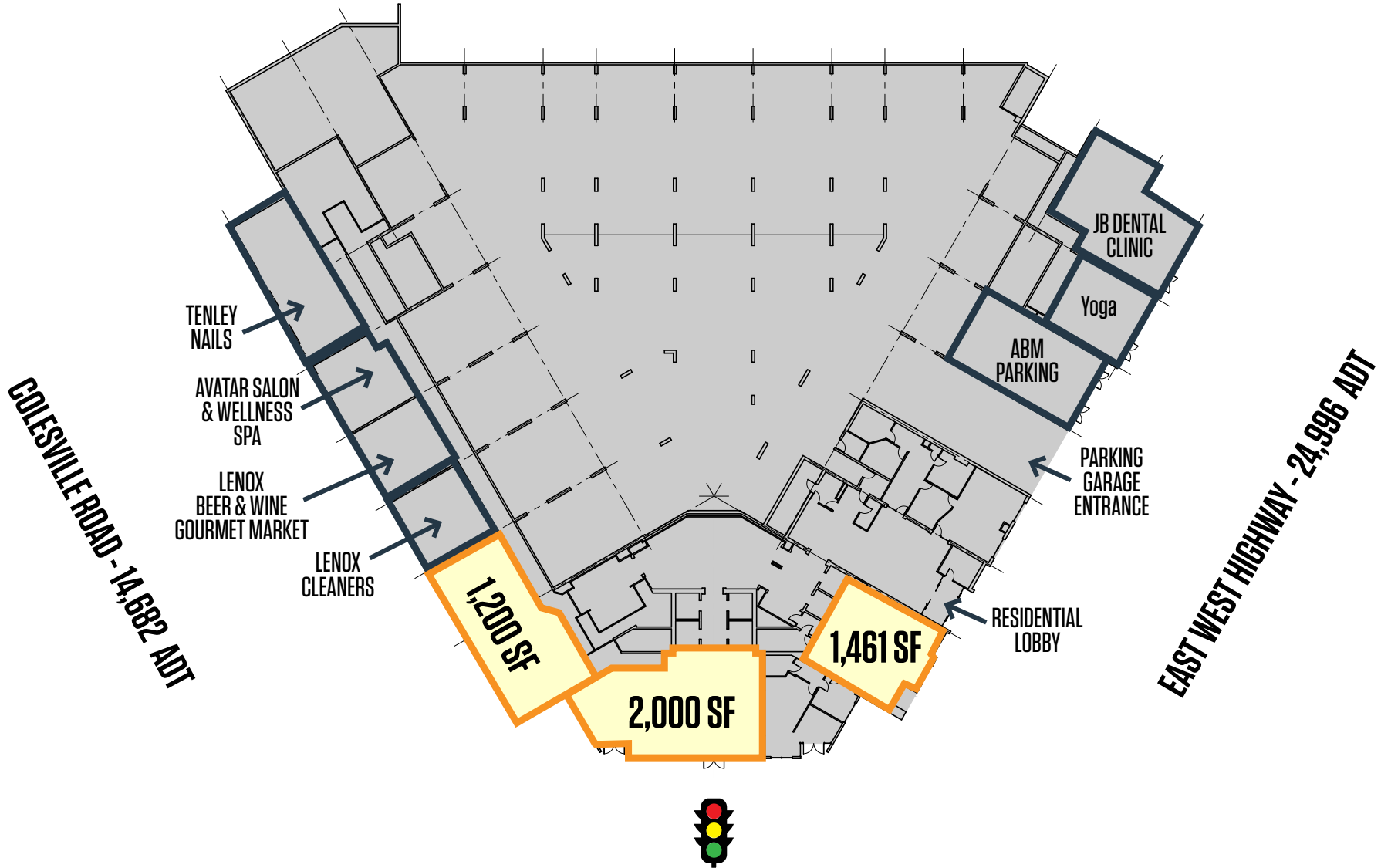

MATT SKALET

maskalet@klnb.com | 202-420-7775

KELLY ATKINSON

katkinson@klnb.com | 202-420-7762



PHOTOS

LENOX PARK - SILVER SPRING

1400 EAST WEST HIGHWAY SILVER SPRING, MARYLAND 20910



2,000 SF AVAILABLE

MATT SKALET

maskalet@klnb.com | 202-420-7775

KELLY ATKINSON

katkinson@klnb.com | 202-420-7762



PHOTOS

LENOX PARK - SILVER SPRING

1400 EAST WEST HIGHWAY SILVER SPRING, MARYLAND 20910



MATT SKALET

maskalet@klnb.com | 202-420-7775

KELLY ATKINSON

katkinson@klnb.com | 202-420-7762

klnb

AERIAL

LENOX PARK - SILVER SPRING

1400 EAST WEST HIGHWAY SILVER SPRING, MARYLAND 20910



MATT SKALET

maskalet@klnb.com | 202-420-7775

KELLY ATKINSON

katkinson@klnb.com | 202-420-7762

klnb





LENOX PARK - SILVER SPRING

1400 EAST WEST HIGHWAY SILVER SPRING, MARYLAND 20910

FOR MORE INFORMATION, PLEASE CONTACT:

MATT SKALET

mkalet@klnb.com
202-420-7775

KELLY ATKINSON

katkinson@klnb.com
202-420-7762

1130 Connecticut Avenue, Suite 600, Washington, DC 20036

.....

klnb.com



[instagram.com/klnbllc](https://www.instagram.com/klnbllc)



[linkedin.com/company/klnb](https://www.linkedin.com/company/klnb)



[facebook.com/KLNB](https://www.facebook.com/KLNB)

CLICK TO VIEW PROPERTY WEBSITE

While we have no reason to doubt the accuracy of any of the information supplied, we cannot, and do not, guarantee its accuracy. All information should be independently verified prior to a purchase or lease of the property. We are not responsible for errors, omissions, misuse, or misinterpretation of information contained herein and make no warranty of any kind, express or implied, with respect to the property or any other matters.