



NEW OUTPARCEL



Front Elevation

PROPERTY HIGHLIGHTS

- Located just minutes from the University of South Florida (USF), home to **~50,000 students**, faculty, and staff.
- Captures both **weekday campus traffic** and **evening/weekend** social activity from nearby apartments and student hubs.
- In close proximity to several major medical facilities, including:
 - **AdventHealth Tampa**
 - **James A. Haley Veterans' Hospital**
 - **Moffitt Cancer Center**
- **Excellent frontage** on **E Bearss Avenue** (49,500 AADT) with immediate access to **I-75** and **I-275**.
- Easy in-and-out access from both **Bearss Ave** and **Bruce B. Downs Blvd**, key commuter routes for students and professionals.
- Prominent **corner positioning** and **modern façade design** ensure strong brand exposure for tenants.

DEMOGRAPHICS	1 MILE	3 MILES	5 MILES
POPULATION			
2025 Estimated Population	28,048	114,615	246,406
2025 Estimated Households	11,870	44,675	98,449
INCOME			
2025 Estimated Avg HH Income	\$58,992	\$70,445	\$92,337
AGE			
Median Age	37	38.7	39.9
TRAFFIC COUNTS			
E Bearss Avenue	49,500 AADT		



UNIT	TENANT	SF
2802	Don Julio's Mexican	2,452
2806	Jimmy Johns	1,198
2808	Kay's Kitchen	1,198
2810	Steaming Pots West African Cuisine	2,483
2812	Kabs Pharmacy	1,607
2814	Art of Smoke	1,468
2816	Provisions Coffee and Kitchen	1,015
2820	Armerinails	1,362
2822	Available	2,016
2824	Baba Dough Pizza	1,680
2826	Sushi Avenue	1,453
2828	University Boba House	2,260
2830	Gamers Escape	2,265
2832	Balance Salon Spa	1,499
2836	Remington's Steak & Seafood	8,191

E BEARSS AVE (49,500 AADT)

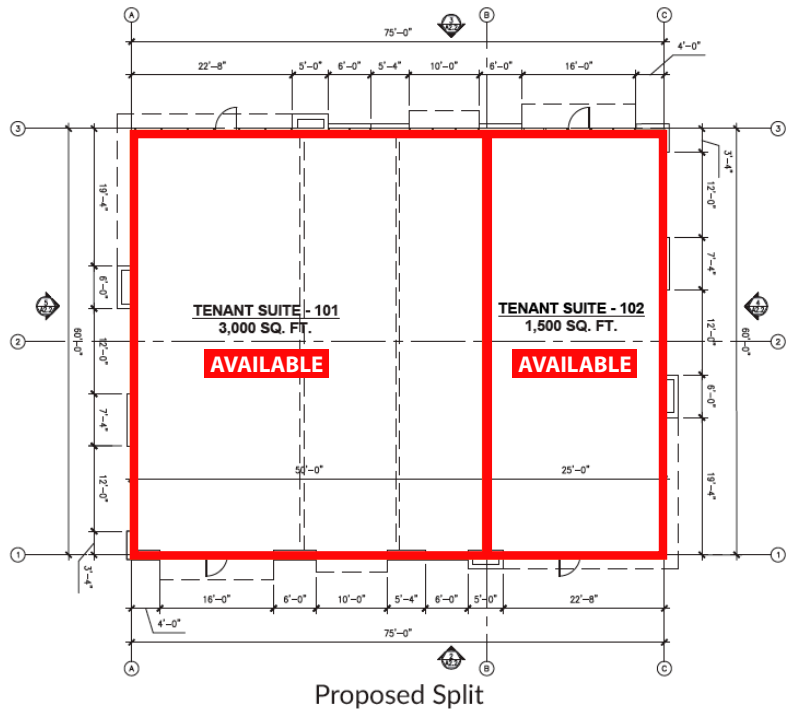

All information given herein is obtained from sources considered reliable. However, we are not responsible for misstatement of facts, errors, omissions, prior sale, withdrawal from market, modification of mortgage commitment, terms and considerations, or change in price without notice. The information supplied herein is for informational purposes only and shall not contain a warranty or assurance that said information is correct. Any person intending to rely upon the information supplied herein should verify said information independently. UPDATED: 112425



8902 N Dale Mabry Hwy
Tampa, FL 33614
800.728.5379
www.RMCPG.com

FOR LEASING INFORMATION:
Erica Nelson
813.712.3055
enelson@rmcp.com

PALMS CONNECTION

2832 E Bearss Avenue
Tampa, FL 33613

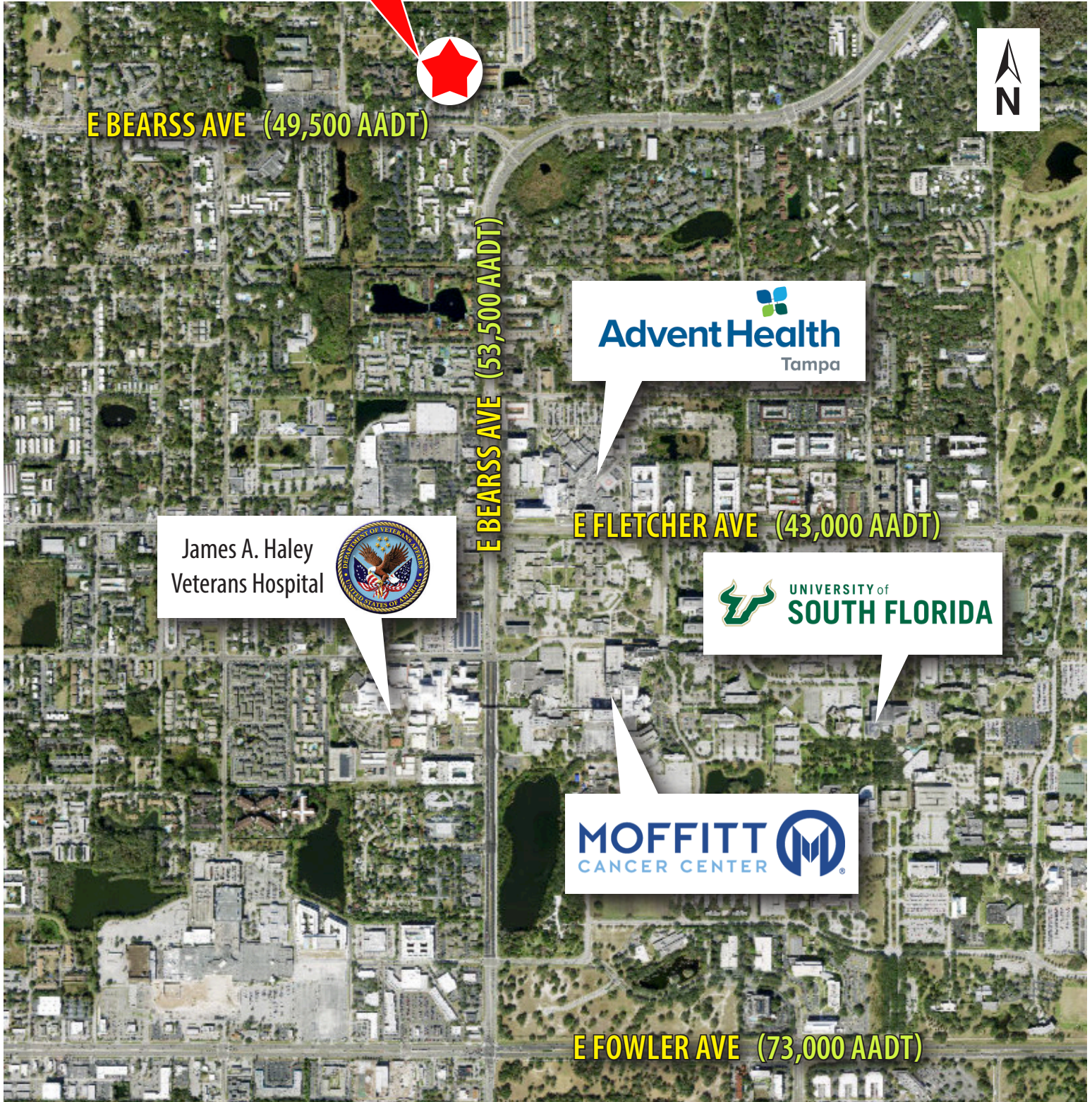

8902 N Dale Mabry Hwy
Tampa, FL 33614
800.728.5379
www.RMCPG.com

FOR LEASING INFORMATION:

Erica Nelson
813.712.3055
enelson@rmcp.com