

# THIRD FLOOR SUITE 300

Available Now | SPEC SUITE | ±12,086 RSF

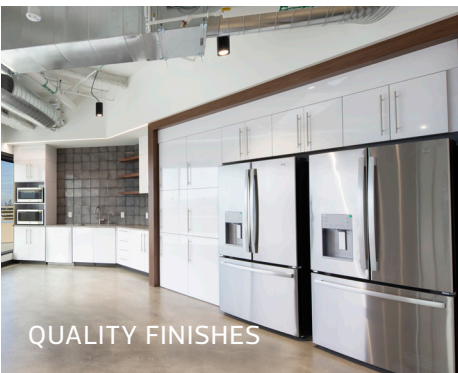

Elevate Your Work Environment: Premier Lab and Office Suites



Virtual Tour

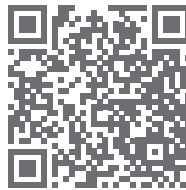

- OFFICE**
- 48 Workstations\*
  - 2 Private Offices
  - 2 Conference Rooms
  - Break Area
  - Copy Area
  - Electrical Room
  - IT Room

- LAB**
- 43 Bench Knee-hole Spaces
  - 4 Lab Support Rooms
  - 6 Lab Sinks
  - 1 6Ft Fume Hood
  - BSL2 - Single Pass Air
  - House Air & Vac Distribution

\*Office furniture shown not included.

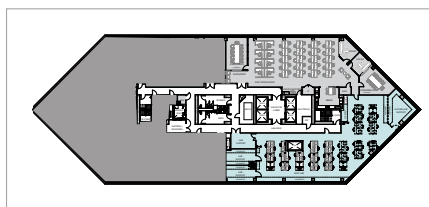

— SPEC    - - - FUTURE    ■ OFFICE    ■ LAB    □ COMMON

1400FASHIONISLAND.COM | 1400 FASHION ISLAND BLVD, SAN MATEO, CA



# BUILDING HIGHLIGHTS

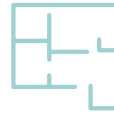

Suite Range  
±10,000 - 23,500 RSF



GENESIS  
Spec Lab Program



Robust MEP,  
Infrastructure Upgrades



Scalable  
Growth



Immediate Freeway Access  
and Visibility on Hwy 92



Parking Ratio  
3.0/1,000



New 1,500kW  
Emergency Generator



New Service Elevator  
5,000lbs Max



Tenant Experience  
Application

**SIMON CLARK**  
650.577.2938  
simon.clark@cbre.com  
RE license #01318652

**JAMES BENNETT**  
650.494.5192  
james.bennett@cbre.com  
RE license #00869074

**EVAN CHANG**  
650.577.2962  
evan.chang@cbre.com  
RE license #02010044

**BECKA STUDER**  
951.663.2997  
studer@p3re.com  
RE license #02004534



© 2025 CBRE, Inc. All rights reserved. This information has been obtained from sources believed reliable, but has not been verified for accuracy or completeness. You should conduct a careful, independent investigation of the property and verify all information. Any reliance on this information is solely at your own risk. CBRE and the CBRE logo are service marks of CBRE, Inc. All other marks displayed on this document are the property of their respective owners, and the use of such logos does not imply any affiliation with or endorsement of CBRE. Photos herein are the property of their respective owners. Use of these images without the express written consent of the owner is prohibited.