

**MEDICAL SPACE FOR SUB-LEASE**



# 1598 SOUTH COUNTY TRAIL

East Greenwich, RI 02818

**LEEDS MITCHELL IV, SIOR**  
Executive Vice President  
401.751.3200 x307  
leeds@mgcommercial.com

**MG COMMERCIAL**  
365 Eddy Street, Penthouse Suite  
Providence, RI 02903  
401.751.3200 | mgcommercial.com

# PROPERTY SUMMARY



## PROPERTY DESCRIPTION

1598 South County Trail is a 59,800 SF class "A" medical office building that underwent a major rehab in 2019. The last available space remaining is a 5,000 SF corner suite, in shell condition with large windows, and is ready for a custom fit-up. Join existing tenants, Coastal Medical, University Orthopedics, OrthoDIRECT, Advanced Dermatology, and Velocity Clinical Research in this Class "A" medical office building.

## LOCATION DESCRIPTION

1598 South County Trail is located on Route 2 in East Greenwich on the "medical-mile" and is surrounded by all of the top medical providers in Rhode Island. Easy access from Route I-95 and Route 4 with many amenities close by.

## PROPERTY HIGHLIGHTS

- Covered patient drop-off
- Space currently in shell condition, ready for a custom buildout
- Ample parking @ 6/1,000 SF
- Street signage
- Last suite available in the building
- Professional Property Management

## OFFERING SUMMARY

Lease Rate:	\$24.50 SF/yr (NNN)
Available SF:	5,000 SF
Building Size:	60,000 SF

**LEEDS MITCHELL IV, SIOR**  
 Executive Vice President  
 401.751.3200 x307  
 leeds@mgcommercial.com

365 Eddy Street, Penthouse Suite  
 Providence, RI 02903  
 mgcommercial.com



# ADDITIONAL PHOTOS



**LEEDS MITCHELL IV, SIOR**  
Executive Vice President  
401.751.3200 x307  
leeds@mgcommercial.com

365 Eddy Street, Penthouse Suite  
Providence, RI 02903  
mgcommercial.com



# LOCATION MAPS

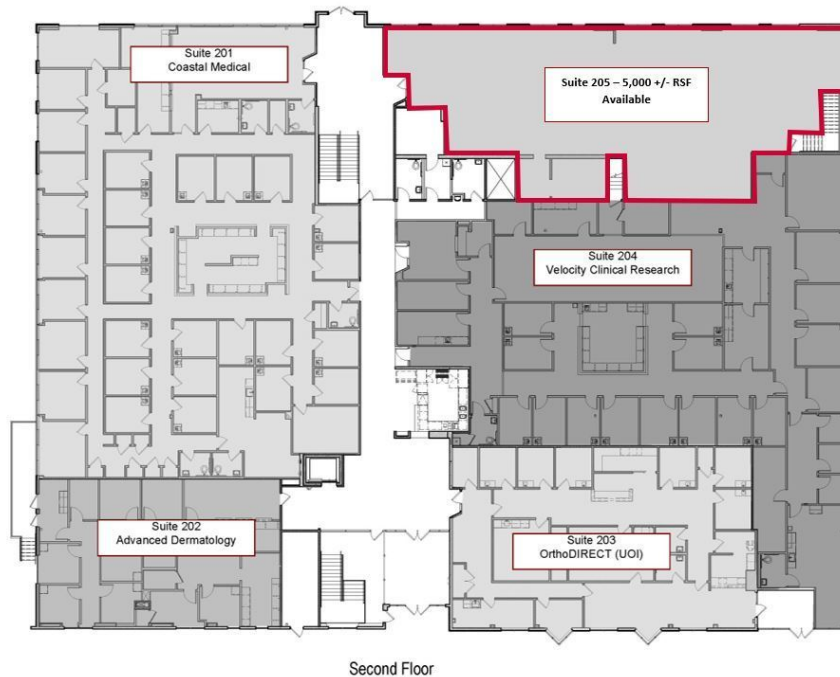
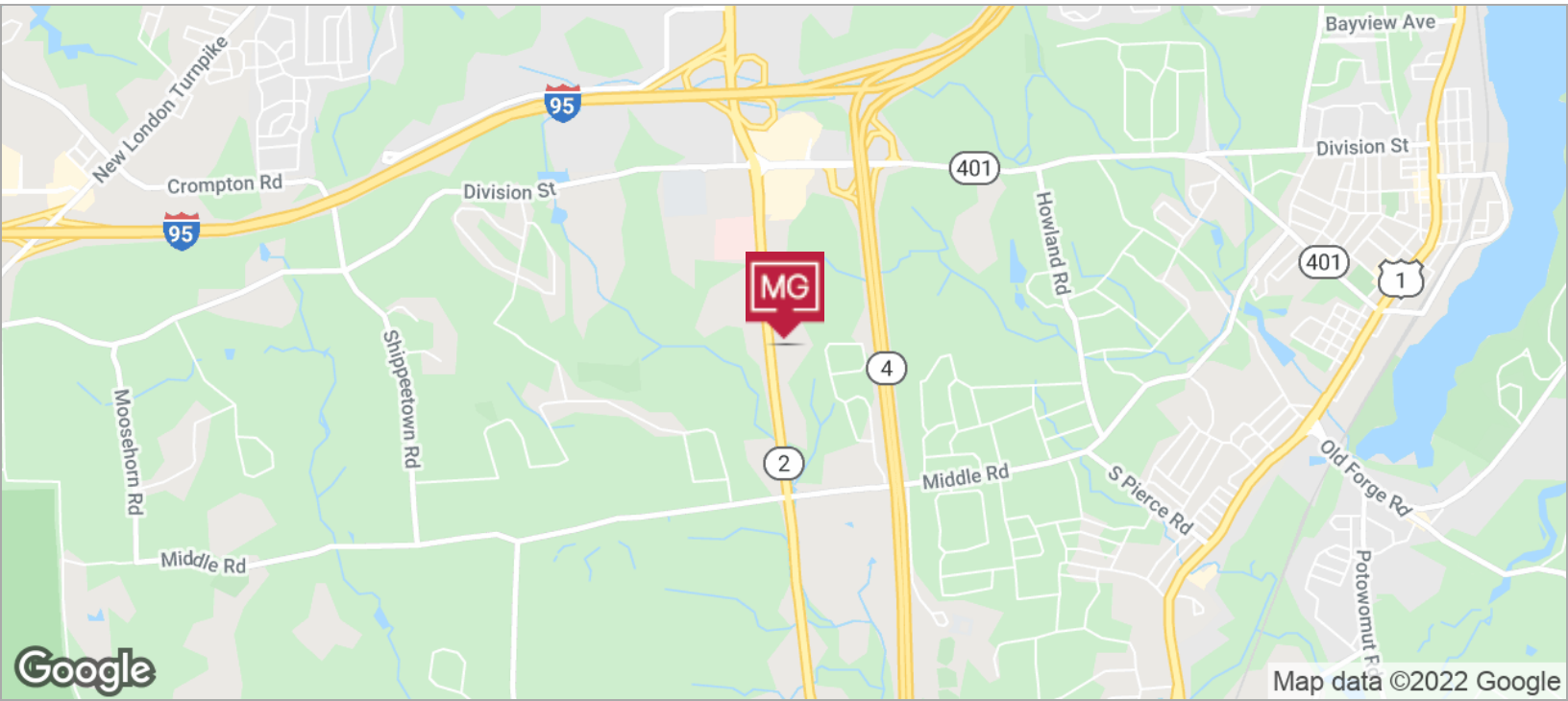

**LEEDS MITCHELL IV, SIOR**  
Executive Vice President  
401.751.3200 x307  
leeds@mgcommercial.com

365 Eddy Street, Penthouse Suite  
Providence, RI 02903  
mgcommercial.com

