



FOR LEASE | ± 18,865 SF

Industrial Building

15248 Texaco Avenue, Paramount, CA



BUILDING FEATURES

- ± 18,865 SF Industrial Building
- ± 1,500 SF Functional Office Space
- Large Fenced Yard
- 17' - 18' Warehouse Clear Height (*Verify*)
- Three (3) Ground Level Doors
- Two (2) Dock High Loading Positions
- 600 Amps, 277/480 V (*Verify*)
- Fully Fire Sprinklered
- 17 Parking Stalls
- Professionally Managed and Maintained Project
- Excellent Access to    Freeways and Port of Long Beach



LOREN CARGILE

Vice President | Partner

424.329.7515

Lic. #01431329

lcargile@voitco.com

2020 Main Street, Suite 100, Irvine, CA 92614 • 949.851.5100 • 949.261.9092 Fax

Voit

REAL ESTATE SERVICES

www.VoitCo.com

FOR LEASE | ± 18,865 SF

Industrial Building

15248 Texaco Avenue, Paramount, CA

Site Plan: ± 18,885 SF

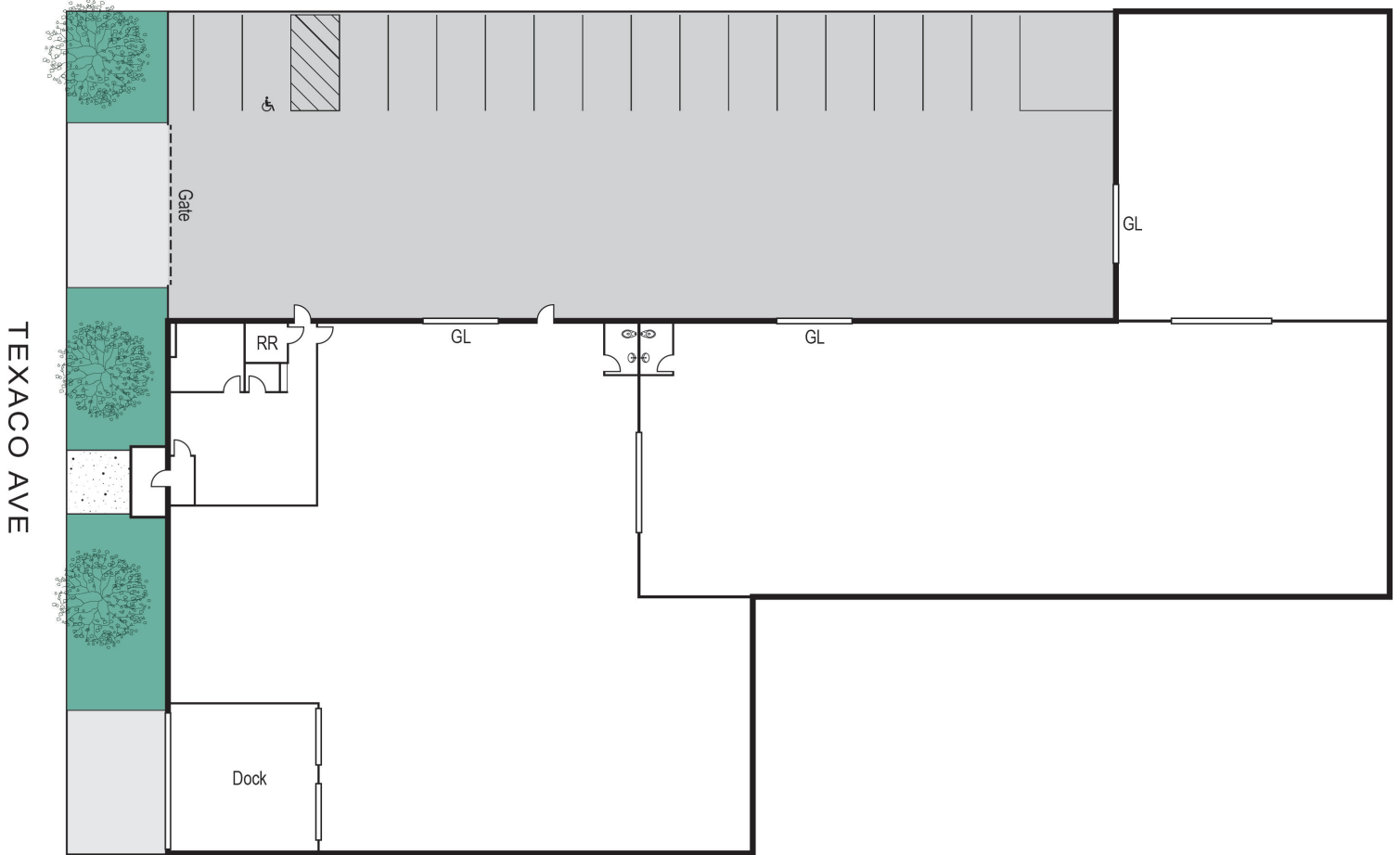

LOREN CARGILE
Vice President | Partner
424.329.7515
Lic. #01431329
lcargile@voitco.com

2020 Main Street, Suite 100, Irvine, CA 92614 • 949.851.5100 • 949.261.9092 Fax

Voit
REAL ESTATE SERVICES

www.VoitCo.com

The information contained herein is based on the best information available and is not intended to constitute an offer of real estate services. We do not guarantee it. Licensed as Real Estate Salespersons by the DRE. ©2024 Voit Real Estate Services, Inc. All Rights Reserved.