

# 3242 PRODUCTION AVE

±8,413 SF INDUSTRIAL SUITE FOR LEASE

**BROKER INCENTIVE**  
\$1.00 PSF BROKER BONUS FOR  
QUALIFIED TENANT & 5 YR LEASE



**BRANT ABERG, SIOR**

Vice Chairman  
License No. 01773573  
Dir +1 858 546 5464  
Main +1 858 413 5600  
brant.oberg@cushwake.com

**JOE CROTTY**

SENIOR DIRECTOR  
License No. 01369821  
Dir +1 760 431 3851  
Main +1 760 473 1811  
joe.crotty@cushwake.com

**TYLER STEMLEY**

DIRECTOR  
License No. 02003867  
Direct +1 760 431 3841  
Mobile +1 760 908 4270  
tyler.stemley@cushwake.com

# SITE FEATURES

3242 PRODUCTION AVE  
OCEANSIDE, CALIFORNIA 92058



PARKING |  
AMPLE



PROXIMITY |  
CLOSE TO AMENITIES



ACCESS |  
OFF HIGHWAY 76 NEAR I-5 FREEWAY



YARD |  
LARGE, FENCED & SECURED

# PROPERTY OVERVIEW

3242 PRODUCTION AVE  
OCEANSIDE, CALIFORNIA 92058



## PROPERTY OVERVIEW

- ±8,413 SF industrial suite available for lease
- Two (2) grade level loading doors
- One (1) dock high loading door
- Fenced, secured yard
- Sprinklered
- Gas service available
- Lease Rate: \$1.40/SF NNN

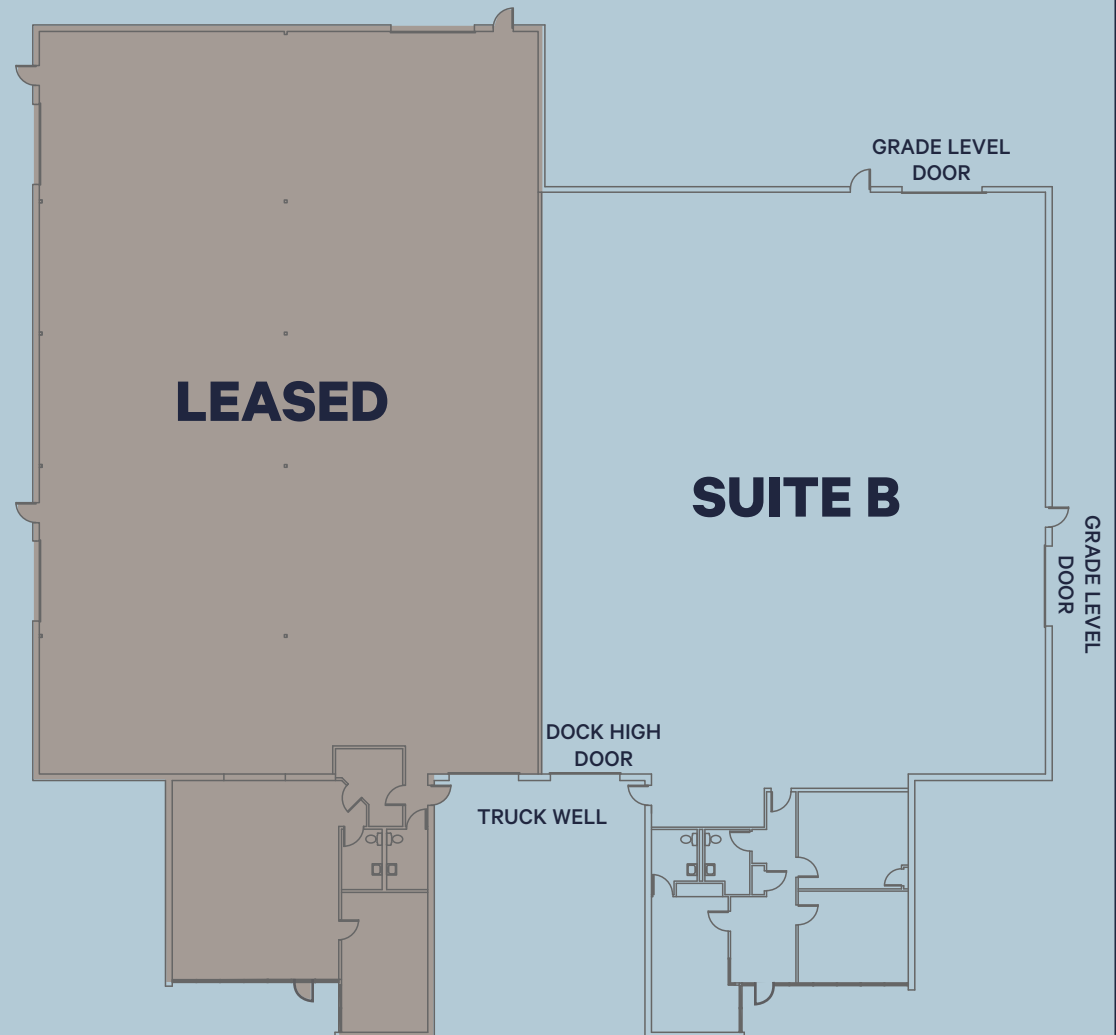

# LOCATION

3242 PRODUCTION AVE  
OCEANSIDE, CALIFORNIA 92058

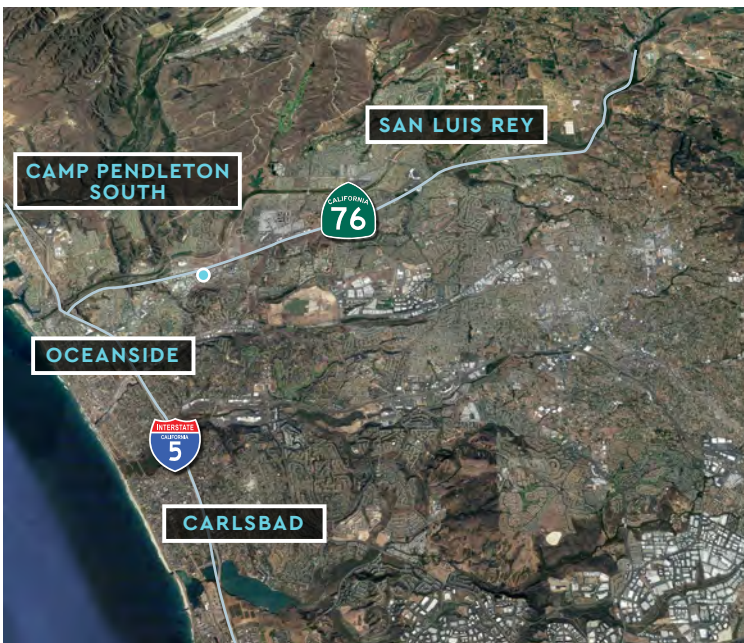

±18,617 SF  
INDUSTRIAL BUILDING

+ SECURED FENCED  
YARD AREA

# DRIVE TIMES

MILES FROM PROPERTY

3242 PRODUCTION AVE  
OCEANSIDE, CALIFORNIA 92058



# SAN DIEGO

## REGIONAL OVERVIEW



Located along the Pacific Coast in Southern California, San Diego is world-famous for its 70 miles of pristine coastline, abundant sunshine and vast array of tourist attractions and amenities. As a scenic backdrop in which to live, work and play, the region is home to residents and businesses that have transformed San Diego into an economic powerhouse.

San Diego County attracts companies seeking a well-educated workforce, multifaceted transportation infrastructure, desirable quality of life and access throughout the region and around the globe.

## POPULAR ATTRACTIONS



HOTEL DEL CORONADO

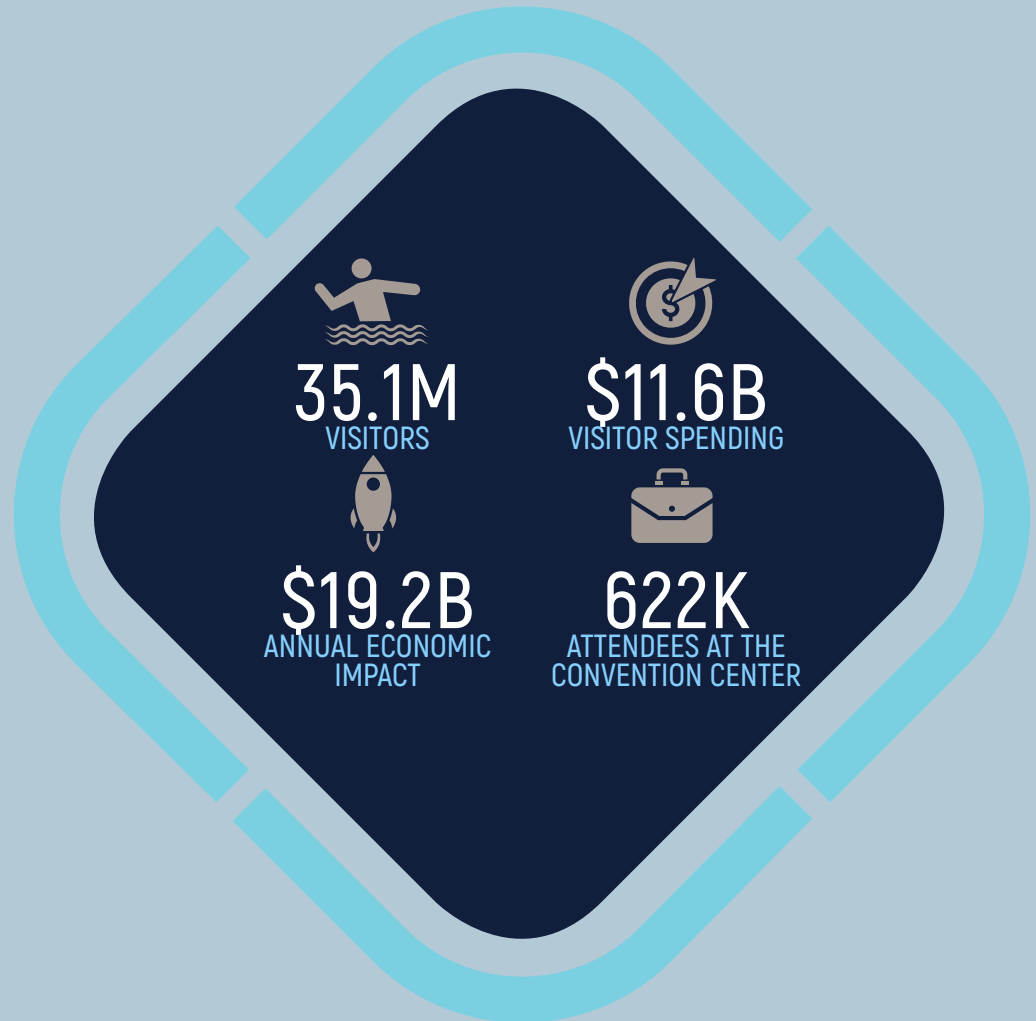

# NORTH COUNTY

## REGIONAL OVERVIEW



### BUILDING & DESIGN

Hunter Industries  
Nitto Group – Hydranautics | Watkins Manufacturing Group



### CLEAN TECHNOLOGY

Baker Electric Solar | Poseidon Water  
NRG Energy | Air Products and Chemicals, Inc.



### INFORMATION & COMMUNICATIONS TECHNOLOGIES

ViaSat | Activision | Nordson Corp.  
L3 Communications | Max-Linear



### BIOTECHNOLOGY, BIOMEDICAL DEVICES & HEALTHCARE

DJO Global | Thermo Fischer Scientific | Genentech, Inc.  
Ionis Pharmaceuticals | Breg, Inc. | Alphatec Spine  
Gilead Sciences | GenMark Diagnostics | Zimmer Dental



### ACTIVE LIFESTYLE SPORT

Taylormade | Callaway Golf | Puma Golf | GoPro | Stone Brewing  
Titleist – Acushnet | Suja Juice | Columbia Sportswear | Reef



### E. COMMERCE

Wayfair | Amazon

## LIFESTYLE

126

MILES OF  
HIKING TRAILS

57%

OF SAN DIEGO  
GOLF COURSES

28

BEACHES

58

SCHOOLS  
(RECEIVED 35% AWARDS)

45+

BREWERIES

## JOB GROWTH FASTEST IN NORTH COUNTY

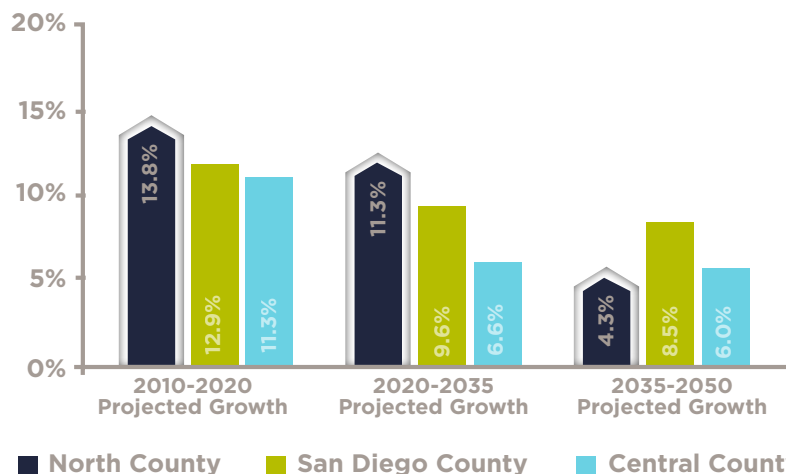



This information has been obtained from sources believed to be reliable but has not been verified. NO WARRANTY OR REPRESENTATION, EXPRESS OR IMPLIED, IS MADE AS TO THE CONDITION OF THE PROPERTY (OR PROPERTIES) REFERENCED HEREIN OR AS TO THE ACCURACY OR COMPLETENESS OF THE INFORMATION CONTAINED HEREIN, AND SAME IS SUBMITTED SUBJECT TO ERRORS, OMISSIONS, CHANGE OF PRICE, RENTAL OR OTHER CONDITIONS, WITHDRAWAL WITHOUT NOTICE, AND TO ANY SPECIAL LISTING CONDITIONS IMPOSED BY THE PROPERTY OWNER(S).



**CUSHMAN &  
WAKEFIELD**

**BRANT ABERG, SIOR**

Vice Chairman

License No. 01773573

Dir +1 858 546 5464

Main +1 858 413 5600

[brant.oberg@cushwake.com](mailto:brant.oberg@cushwake.com)

**JOE CROTTY**

SENIOR DIRECTOR

License No. 01369821

Dir +1 760 431 3851

Main +1 760 473 1811

[joe.crotty@cushwake.com](mailto:joe.crotty@cushwake.com)

**TYLER STEMLEY**

DIRECTOR

License No. 02003867

Direct +1 760 431 3841

Mobile +1 760 908 4270

[tyler.stemley@cushwake.com](mailto:tyler.stemley@cushwake.com)