

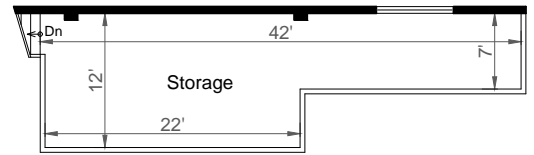

450 VETERANS BOULEVARD | REDWOOD CITY, CA 94063

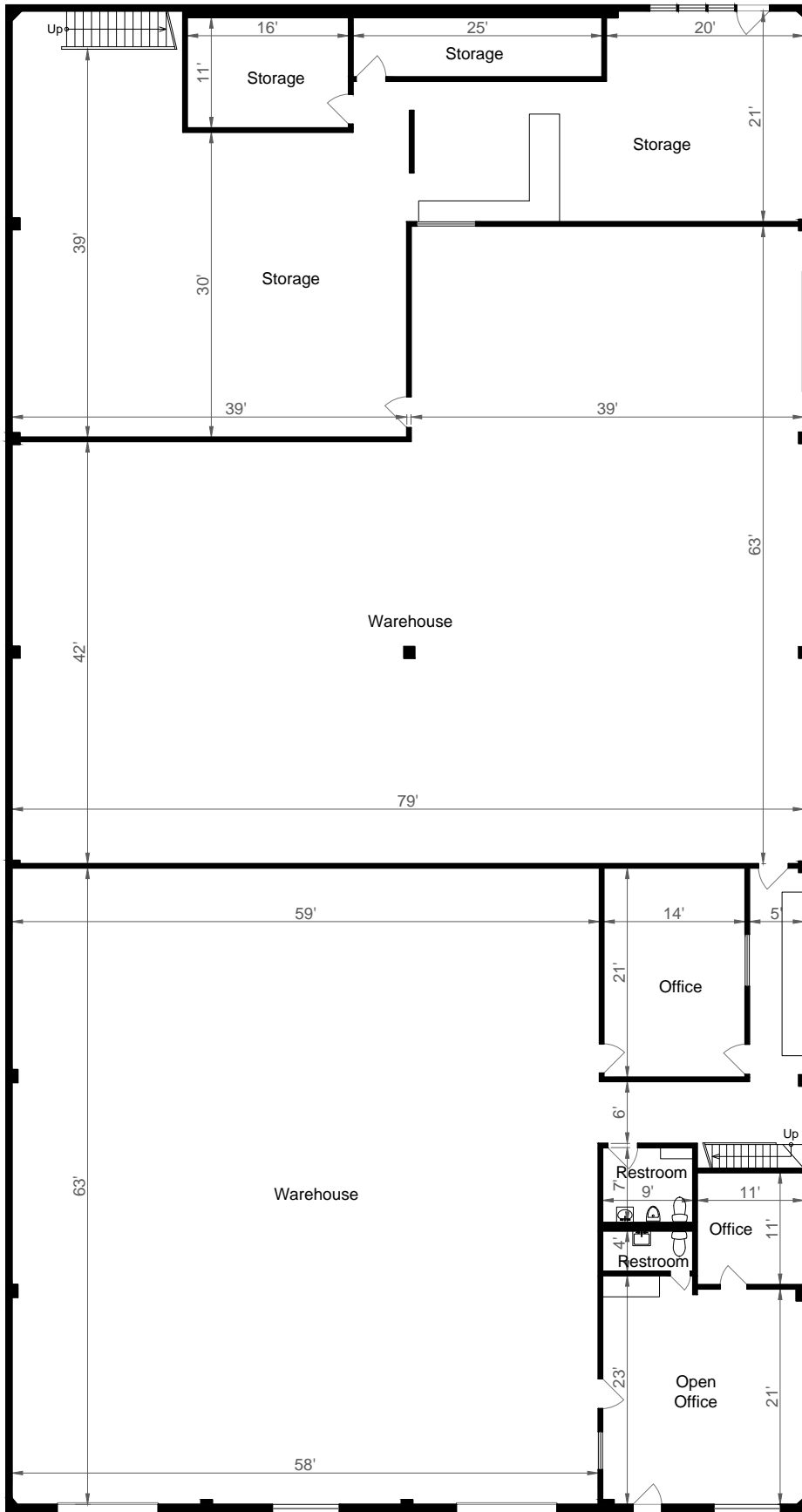

MEZZANINE LEVEL

485 SQ FT

Estimated Total Square Footage: 13,415 SQ FT

Calculated from outside face of exterior walls and center line of demising walls.

First Floor: 12,010 SQ FT
Mezzanine Level: 1,405 SQ FT

MEZZANINE LEVEL

920 SQ FT

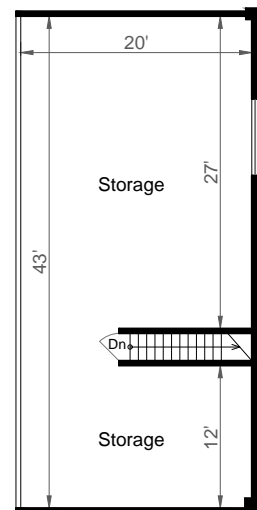

FIRST FLOOR

12,010 SQ FT