

# CORONA GATEWAY

OFFICE BUILDING FOR LEASE

4740 GREEN RIVER RD  
CORONA | CA 92878

NOW WITH  
FREE EV  
CHARGING  
STATIONS

## ANDREW PEAKE

Senior Vice President  
951.276.3644  
apeake@leeriverside.com  
DRE #01398894

## DAVID NEWTON, SIOR, CCIM, CFP

Principal  
714.564.7130  
dnewton@lee-associates.com  
DRE #01041650

## MASON WILSON

Associate  
951.276.3603  
mwilson@leeriverside.com  
DRE #02163918

# AVAILABILITIES

CORONA GATEWAY AVAILABLE SUITES				
TOTAL SQUARE FEET   ±68,027 RENTABLE SQUARE FEET				
Suite	Sq. Ft.	Description	Floor Plan	Video
107	±1,800	Reception, five (5) private offices, and conference room		
113	±200	EXECUTIVE SUITES. Reception/lobby and conference room One (1) private office. Lease Rate starting \$900 per month		
208/209	±2,532	Reception, seven (7) private offices, kitchen, and large conference room		
210/211	±2,529	Reception, seven (7) private offices, kitchen, and large conference room		
306	±200	EXECUTIVE SUITES. Reception/lobby and conference room One (1) private office. Lease Rate starting \$900 per month		
315/316	±2,400	Open area, six (6) private offices, two (2) conference rooms		

LEASE RATE

\$2.35 PSF

LEASE TYPE

Modified Gross (All tenants pay their separately metered interior electricity)

# Property Highlights

- ◇◇◇ Three story office building
- ◇◇◇ ±68,027 total building square footage
- ◇◇◇ 2 hours of free EV charging per day
- ◇◇◇ Executive suite offices available
- ◇◇◇ Prominent building signage available
- ◇◇◇ Professionally managed for “best of class” service
- ◇◇◇ Abundant free parking
- ◇◇◇ Two elevators
- ◇◇◇ Access controlled system after hours
- ◇◇◇ Fully sprinklered with fire/life safety
- ◇◇◇ Easy access from Green River Drive
- ◇◇◇ On-site ownership and management office
- ◇◇◇ Visibility from the 91 freeway
- ◇◇◇ Owner occupied

4740 GREEN RIVER RD  
CORONA | CA 92878



# CORONA GATEWAY



# BEAUTIFUL OFFICE SETTING WITH WATERFALL ATRIUM



Andrew Peake | David Newton, SIOR, CCIM, CFP, Mason Wilson

Lee & Associates Commercial Real Estate Services, Inc. - Riverside | DRE #01048055 | 01011260

# FIRST FLOOR

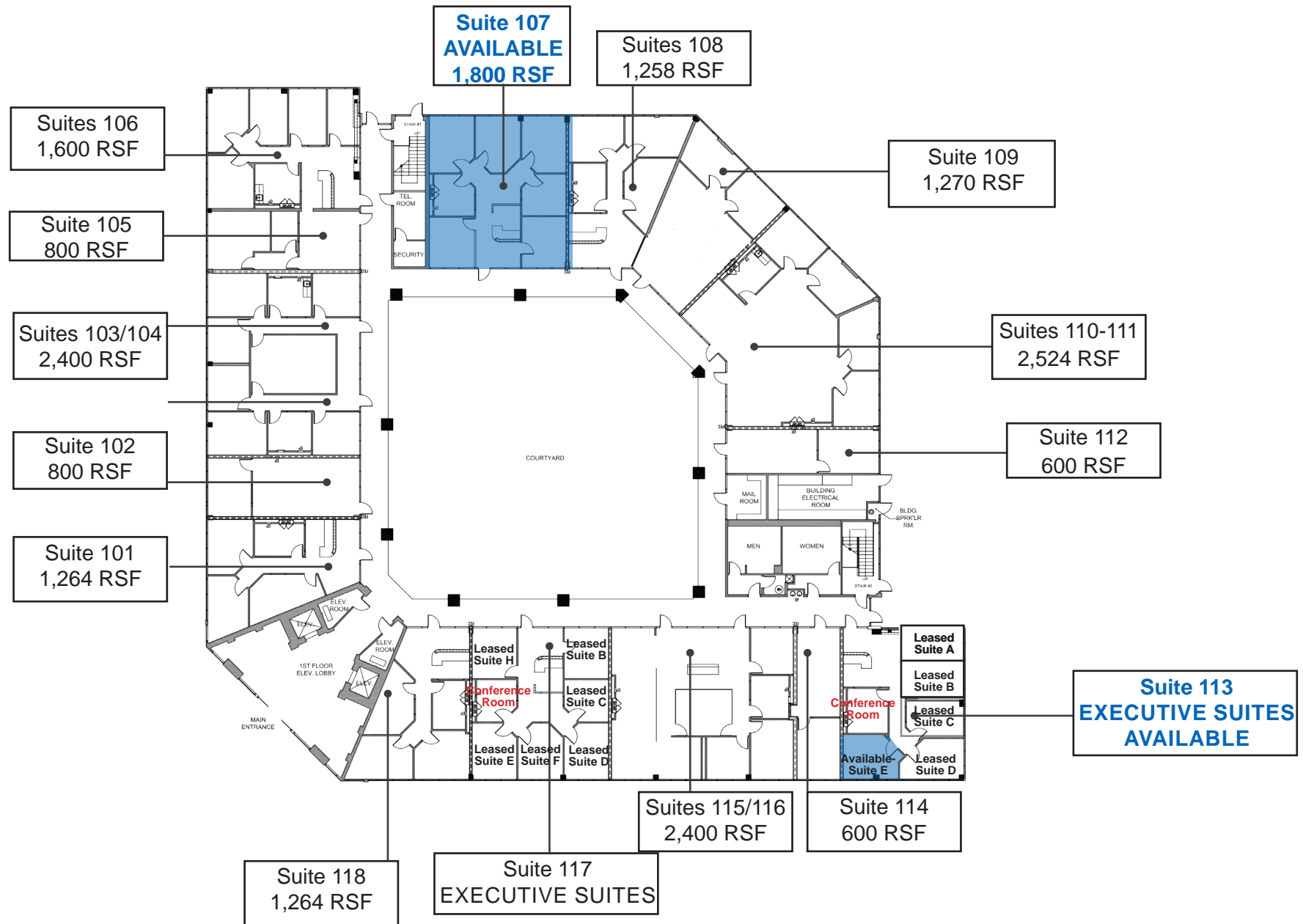

# SECOND FLOOR

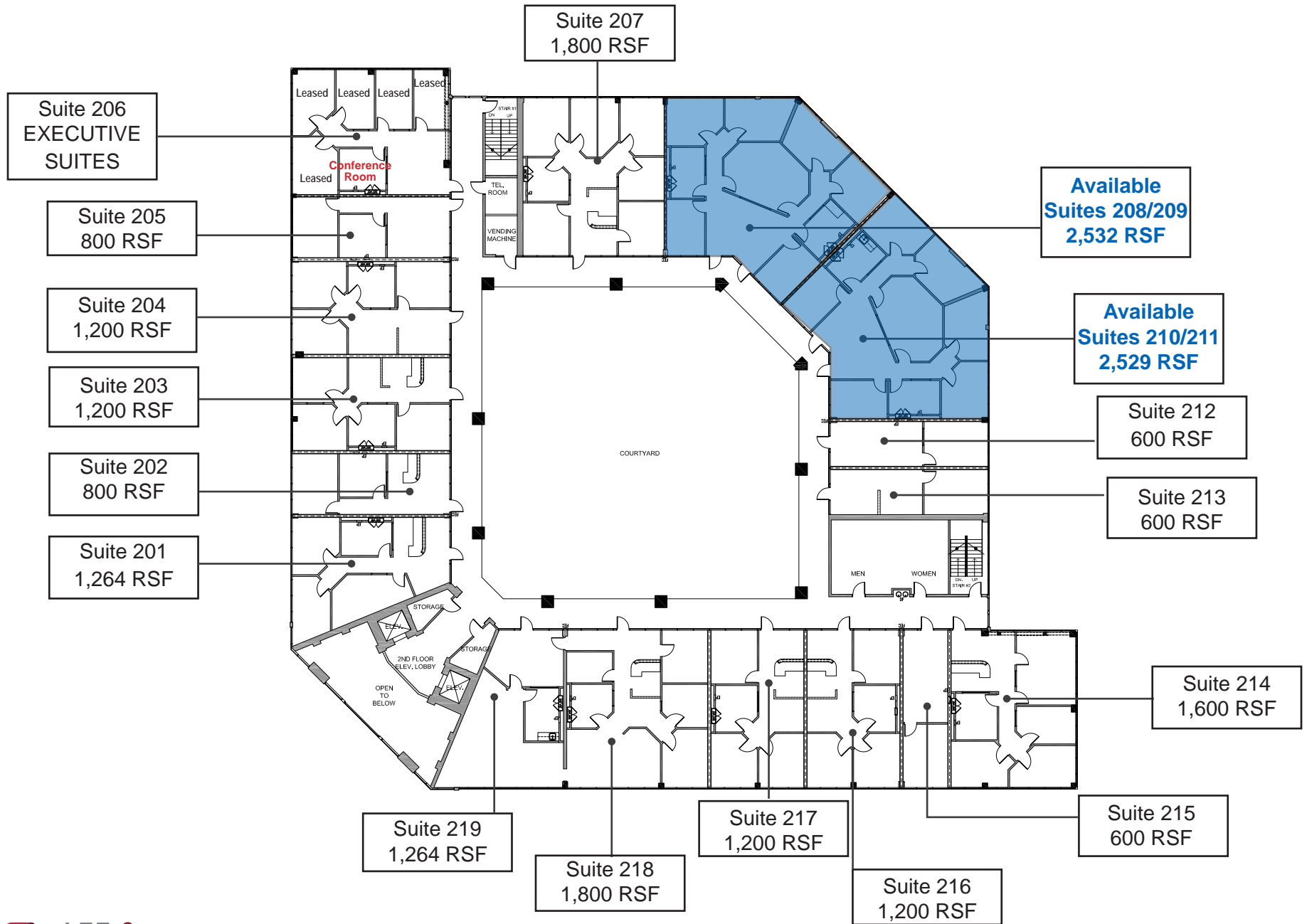

# THIRD FLOOR

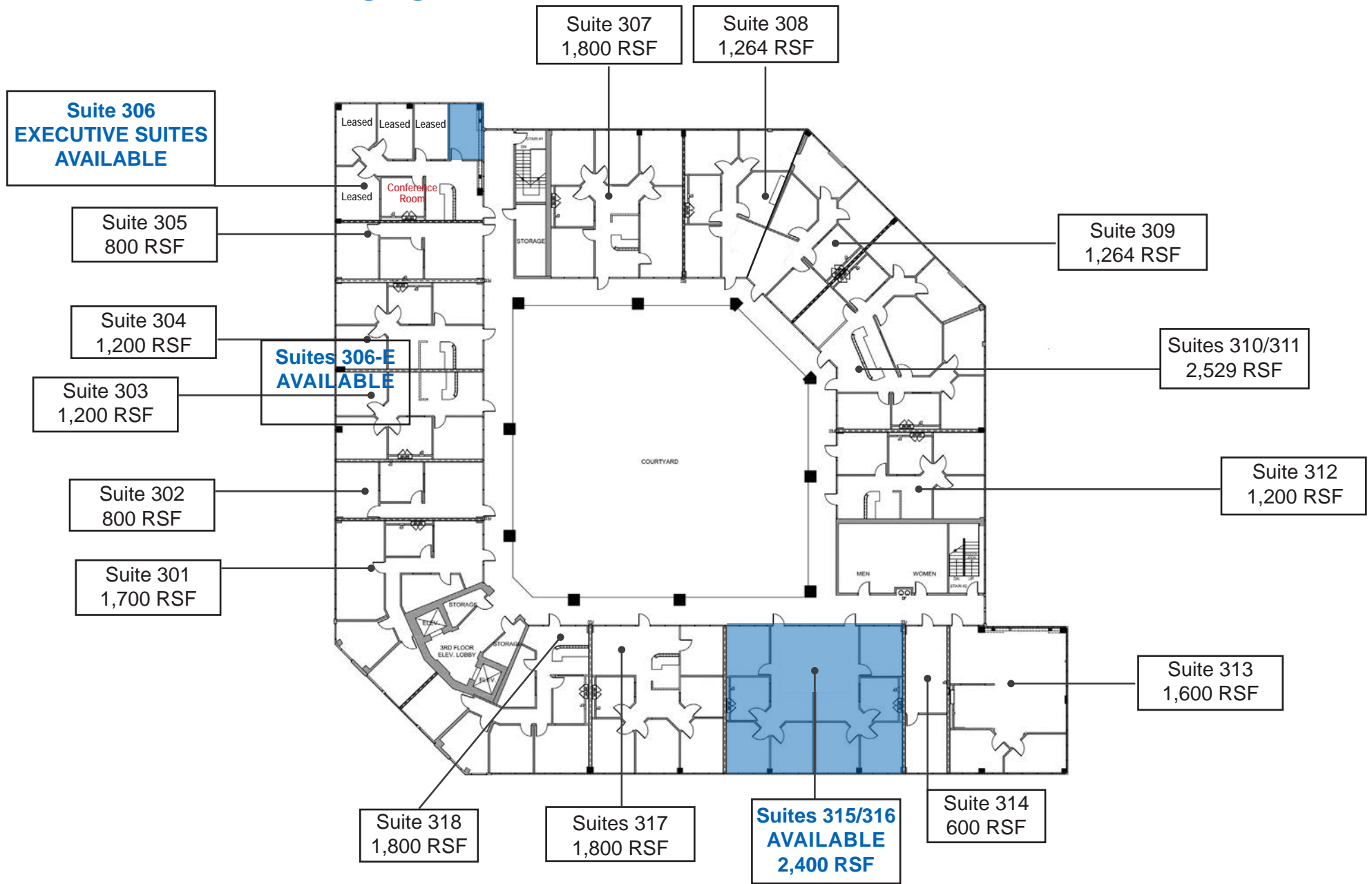

# 4740 GREEN RIVER RD CORONA | CA 92878

GREEN RIVER RD

GREEN RIVER RD ON RAMP

GREEN RIVER RD

GREEN RIVER RD OFF-RAMP



## ANDREW PEAKE

Senior Vice President  
951.276.3644  
[apeake@leeriverside.com](mailto:apeake@leeriverside.com)  
DRE #01398894

## DAVID NEWTON, SIOR, CCIM, GFP

Principal  
714.564.7130  
[dnewton@lee-associates.com](mailto:dnewton@lee-associates.com)  
DRE #01041650

## MASON WILSON

Associate  
951.276.3603  
[mwilson@leeriverside.com](mailto:mwilson@leeriverside.com)  
DRE #02163918



No warranty or representation has been made to the accuracy of the foregoing information. Terms of sale or lease and availability are subject to change or withdrawal without notice. Lee & Associates Commercial Real Estate Services, Inc. - Riverside/Orange  
4193 Flat Rock Drive, Suite 100 - Riverside, CA 92505  
1004 West Taft Avenue, Suite 150 - Orange, CA 92865  
Corporate DRE 01048055/01011260