



**ZACUTO GROUP**  
COMMERCIAL REAL ESTATE



**15001**

**FIGUEROA  
STREET**

47,000 SF 24HR ACCESS  
**OFFICE | WAREHOUSE**

**FOR LEASE**

*Gardena*

# DETAILS

## **SIZE**

**47,000 SF**  
*Up to 110,000 SF*

## **TERM**

**1-10 years**

## **RATE**

**\$1.50/SF IG**

## **LOCATION**

**Gardena**

### **STRATEGIC GARDENA LOCATION**

Immediate access to major freeways, optimizing regional distribution and reducing transit times

### **HIGH-CAPACITY WAREHOUSE**

47K-110K SF + up to 30' storage height. High power (240V, 420V, 3 Phase) & full HVAC

### **EFFICIENT LOADING INFRASTRUCTURE**

Multiple loading dock positions designed for fast turnaround and streamlined logistics

### **SECURE, 24/7 OPERATIONS**

Gated access with 24 hour entry, including Sundays

### **AMPLE ON-SITE PARKING**

Plenty of spaces accommodating standard vehicles & box trucks + overnight parking

## **LISTING TEAM**



**ANDREW SINASOHN**

*Executive Vice President*

310.469.9023

andrew@zacutogroup.com

DRE# 01951740

**JACOB DE LA HOYA**

*Director*

213.509.8899

jacob@zacutogroup.com

DRE# 02243676





**15001**  
FIGUEROA  
STREET  
*Gardena*





**15001**  
FIGUEROA  
STREET  
*Gardena*

FOR LEASE

15001 S FIGUEROA STREET, GARDENA, CA 90248



FOR LEASE

15001 S FIGUEROA STREET, GARDENA, CA 90248

# FLOOR PLAN | GROUND FLOOR

FIGUEROA STREET

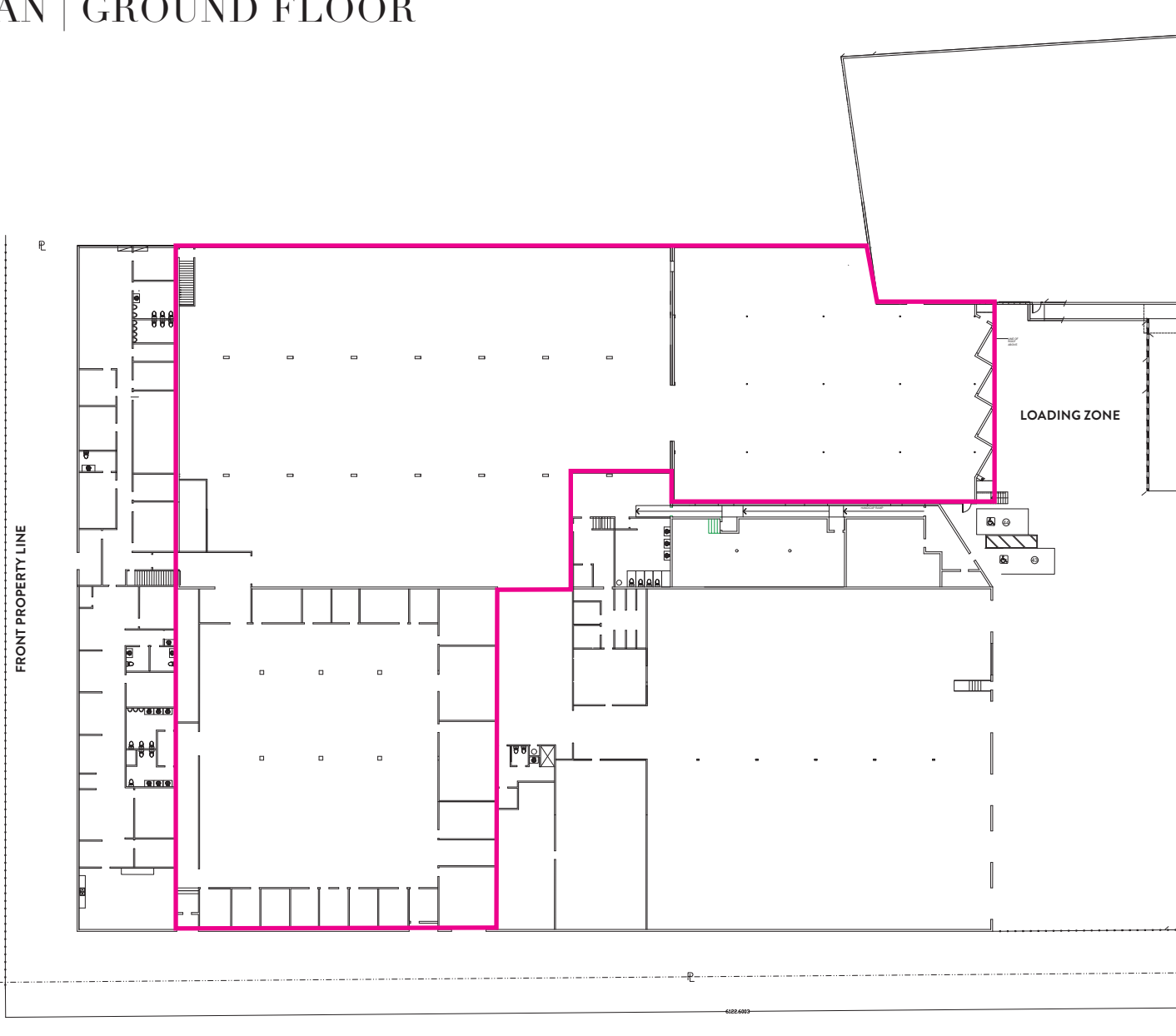

**15001**  
FIGUEROA  
STREET  
*Gardena*

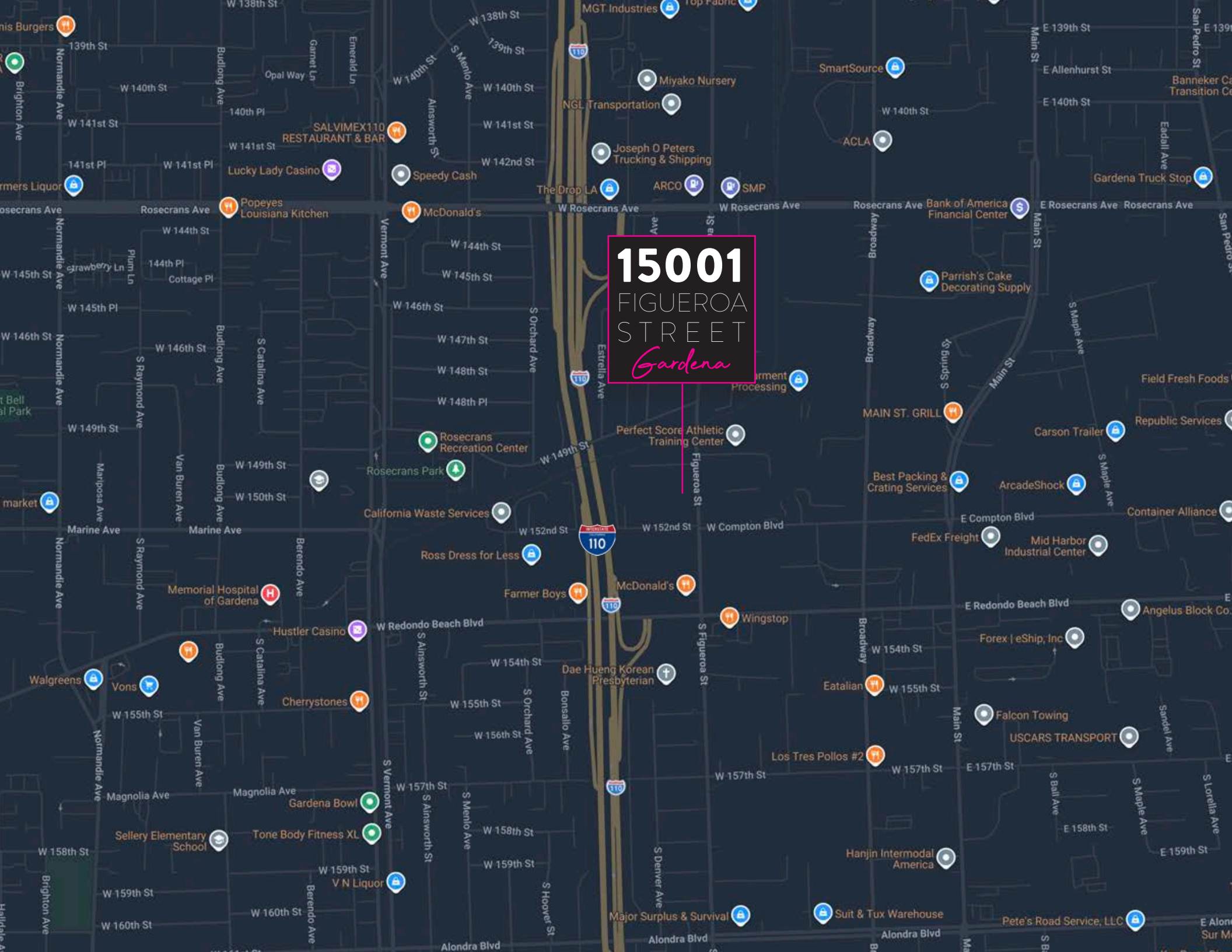

# 15001

FIGUEROA  
STREET

*Gardena*



**ZACUTO GROUP**  
COMMERCIAL REAL ESTATE

**ANDREW SINASOHN**

*Executive Vice President*

310.469.9023

[andrew@zacutogroup.com](mailto:andrew@zacutogroup.com)

DRE# 01951740

**JACOB DE LA HOYA**

*Director*

213.509.8899

[jacob@zacutogroup.com](mailto:jacob@zacutogroup.com)

DRE# 02243676

*No warranty, express or implied, is made as to the accuracy of the information contained herein. This information is submitted subject to errors, omissions, change of price, rental or other conditions, withdrawal without notice. All parties who receive this material should not rely on it, but should use it as a starting point of analysis, and should independently confirm the accuracy of the information contained herein through a due diligence review of the books, records, files and documents that constitute reliable sources of the information described herein. Logos and images are for identification purposes only and may be trademarks of their respective companies. All terms provided are approximate. Leasee to verify. 4/2026*

**ZACUTOGROUP.COM | 310-469-9300**

