

MSC

FRANKFORD AVENUE

FISHTOWN | PHILADELPHIA, PA

IMPECCABLY RESTORED WAREHOUSE
11,500 SF FOR LEASE



1811 FRANKFORD AVENUE

JOIN NEIGHBORING TENANTS



PROPERTY DETAILS

- ▶ *Impeccable restoration of two-story warehouse for lease*
- ▶ *Architectural details include two-story atrium, exposed beams and ductwork, and spectacular wooden A-frame roof with skylights*
- ▶ *Owner-occupied gallery with flexible possession date for next tenant*
- ▶ *Rare large format turn-key space located at 50-yard line of bustling Frankford Avenue in Fishtown*
- ▶ *Surrounded by restaurants, boutiques and cultural destinations*

DEMOGRAPHICS

Center City Trade Area
From the River to River between Girard Avenue & Tasker Avenue

EST. POPULATION	EST. MEDIAN HH INCOME
206,964	\$95,215
EST. MEDIAN AGE	EST. EMPLOYEES
35.5	227,743

The information contained herein has been obtained from sources deemed reliable. MSC cannot verify it and makes no guarantee, warranty or representation about its accuracy. Any projections, opinions, assumptions or estimates provided by MSC are for discussion purposes only and do not represent the current or future performance of a property, location or market.

















Rosetk
21 E. Street
Rajmian VII, Mm 1123
315040261

07/11/23

RFP

FLOOR PLAN

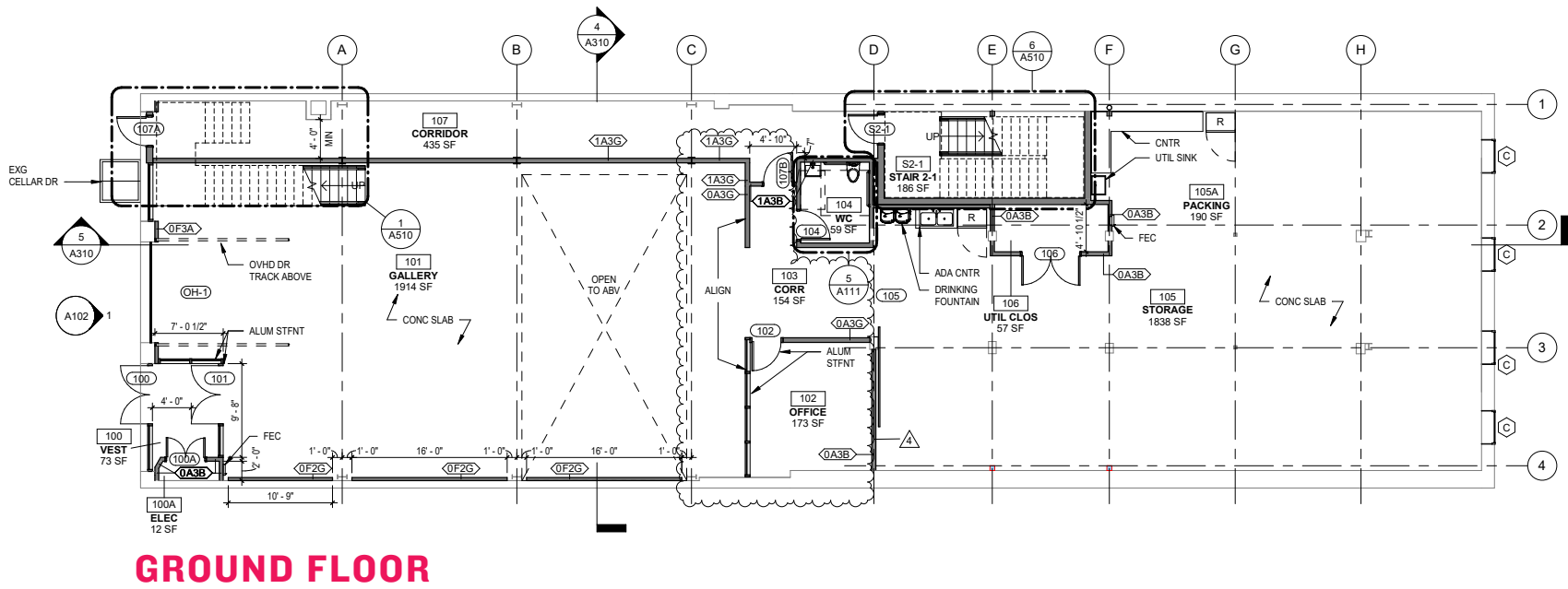
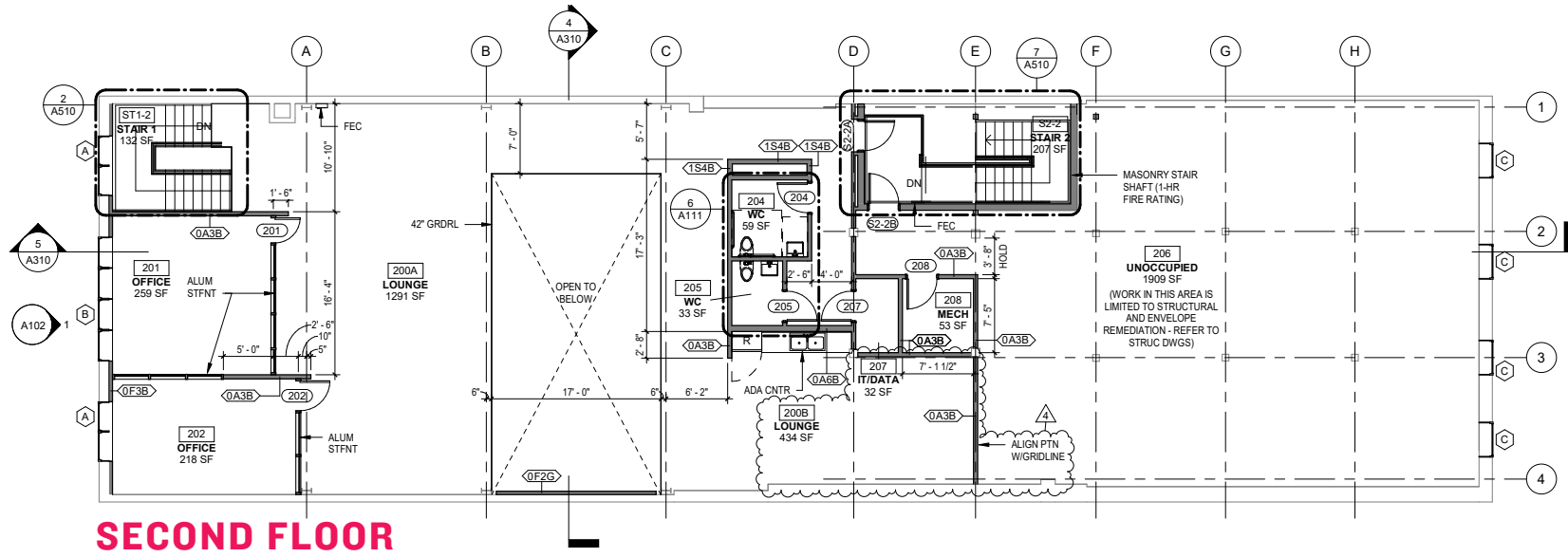

AERIAL



JOSH WEISS

jweiss@hellomsc.com

215.883.7389

STEFANIE GABEL

sgabel@hellomsc.com

215.570.5486

MSC

