

2451

CRYSTAL DRIVE

5,091 - 30,616 RSF
OF CLASS A SUBLET SPACE



7TH FLOOR



15,003 SF



5,091 SF



10,522 SF

Not Currently Demised - Up to 30,616 SF Available



PROPERTY HIGHLIGHTS



Collaborative
lobby lounge



Fitness center



1/1,000 SF Parking ratio



Childcare facility



Secure bike storage,
showers, & lockers



Immediate
availability



Term through
January 2034

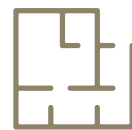

Entire 7th floor:
30,616 SF
(Not demised)





SPACE FEATURES

- ▶ Class A Buildout in Like-New Condition
- ▶ Fully Furnished and Equipped with A/V
- ▶ 15 Conference Rooms
- ▶ 2 Private Showers
- ▶ 2 Large Kitchens on the Window-line
- ▶ Great Views of Reagan National and DC
- ▶ 110 Workspaces
- ▶ 35 Interior Offices
- ▶ 10 Minute Walk to Crystal City Metro



WALKABLE RETAIL

● RESTAURANTS

- ▶ Buffalo Wild Wings
- ▶ Sweetgreen
- ▶ Starbucks
- ▶ We, The Pizza
- ▶ Chick-fil-A
- ▶ Chipotle

● RETAIL

- ▶ CVS
- ▶ Whole Foods Market
- ▶ Costco
- ▶ T.J. Maxx

● FITNESS

- ▶ Movement Crystal City

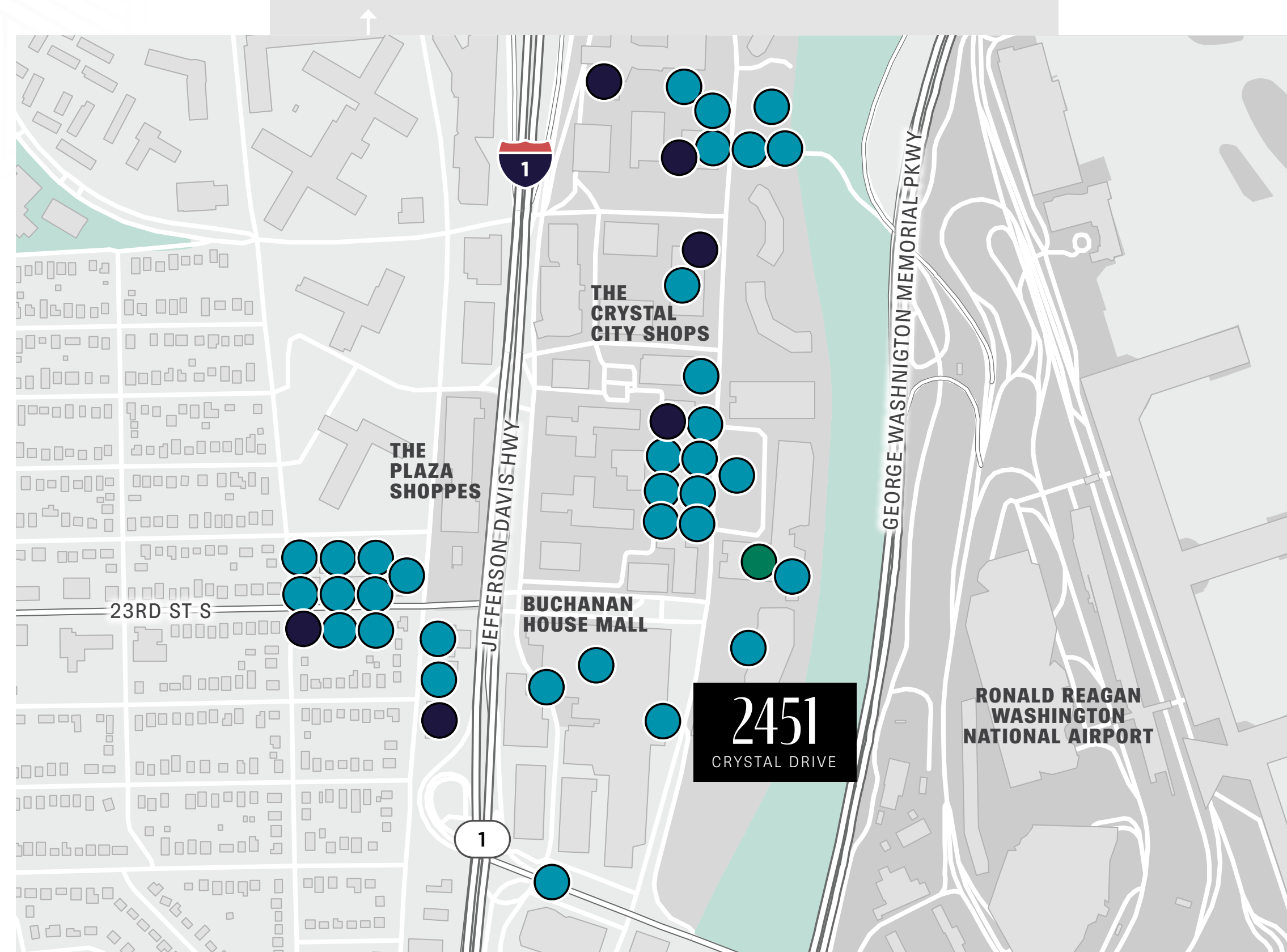

2451

CRYSTAL DRIVE

FOR MORE INFORMATION, PLEASE CONTACT

LAURIE MCMAHON | 202 369 1219 | laurie.mcmahon@cushwake.com

MICHAEL KATCHER | 202 739 0360 | michael.katcher@cushwake.com

WILL THOMAS | 703 770 3417 | williamson.thomas@cushwake.com

GEOFF DYE | 202 266 1142 | geoff.dye@cushwake.com



©2025 Cushman & Wakefield. All rights reserved. The information contained in this communication is strictly confidential. This information has been obtained from sources believed to be reliable but has not been verified. NO WARRANTY OR REPRESENTATION, EXPRESS OR IMPLIED, IS MADE AS TO THE CONDITION OF THE PROPERTY (OR PROPERTIES) REFERENCED HEREIN OR AS TO THE ACCURACY OR COMPLETENESS OF THE INFORMATION CONTAINED HEREIN, AND SAME IS SUBMITTED SUBJECT TO ERRORS, OMISSIONS, CHANGE OF PRICE, RENTAL OR OTHER CONDITIONS, WITHDRAWAL WITHOUT NOTICE, AND TO ANY SPECIAL LISTING CONDITIONS IMPOSED BY THE PROPERTY OWNER(S). ANY PROJECTIONS, OPINIONS OR ESTIMATES ARE SUBJECT TO UNCERTAINTY AND DO NOT SIGNIFY CURRENT OR FUTURE PROPERTY PERFORMANCE.