



2201 Renaissance Boulevard
King of Prussia, PA

+/- 37,710 SF (Divisible) Full Floor Sublease in Renaissance Park

2201 Renaissance Blvd Sublease

BUILDING OVERVIEW

2201 Renaissance Boulevard is a premier trophy office building in Renaissance Park located in the King of Prussia. The light-filled building features an expansive two-story lobby with direct access to an outdoor terrace with patio seating overlooking a fountain and pond feature. Tenants will enjoy best-in-class amenities, including an on-site café, full-service fitness center with shower and locker rooms, and direct access to walking and biking trails that wind through the 100-acre campus. The building is served by an abundant surface parking area with a 5.3/1,000 parking ratio.

SUBLEASE HIGHLIGHTS

- Full floor sublease opportunity +/- 37,710 SF (divisible)
- Existing furniture can be made available
- Lease expiration of 10/31/2032
- Asking rental rate of \$22.50/SF + Electric
- Minutes from I-76, I-476 and PA Turnpike (I-276)
- Walking distance to public transportation
 - Hughes Park Transit Stop (Norristown High Speed Line)
 - SEPTA 95, 124, and 125 routes

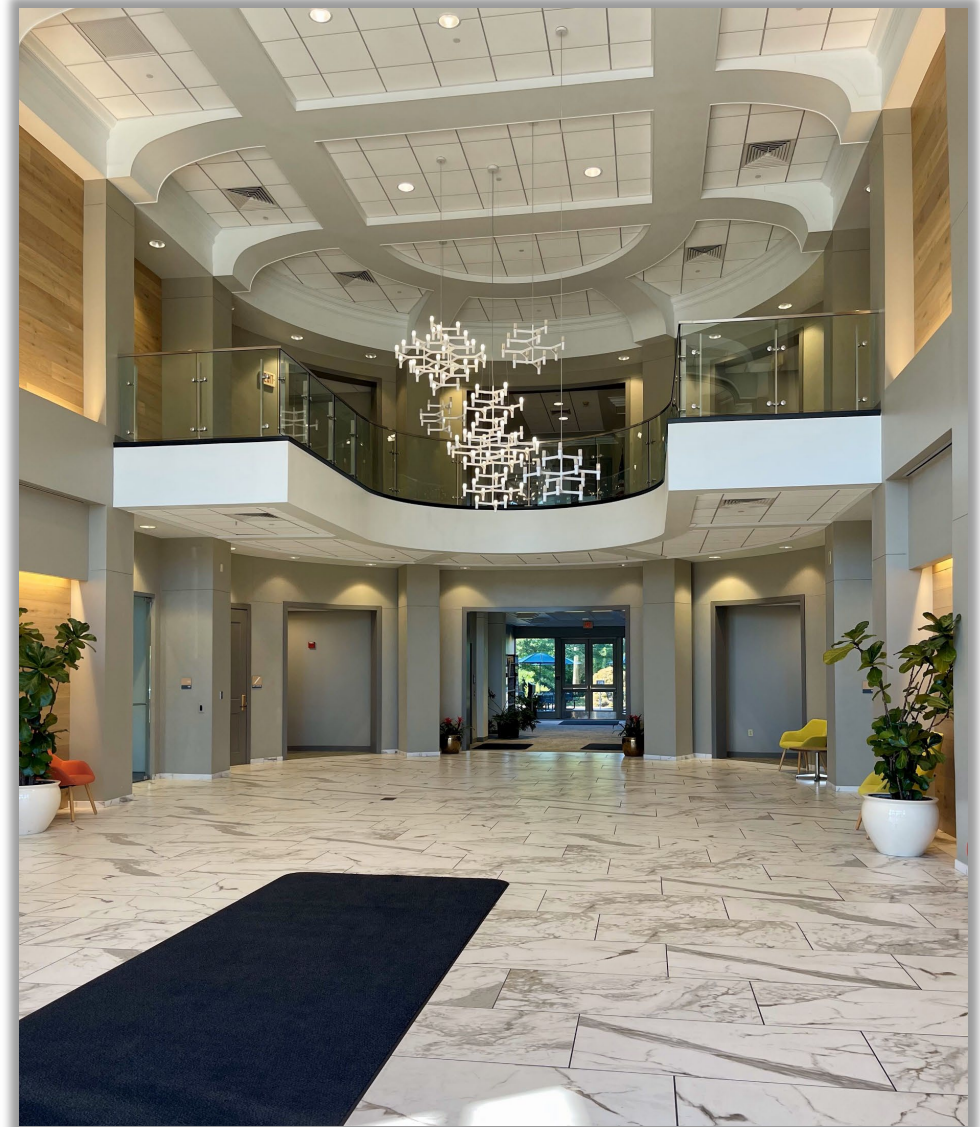

2201 Renaissance Blvd Photos



FOR MORE INFORMATION
PLEASE CONTACT:

BRIAN LAFOND
Tenant Representative
215-519-3077
blafond@gola.com

SHANE ALLEN
Tenant Representative
610-906-6850
sallen@gola.com

GOLA CORPORATE REAL ESTATE, INC.

2490 Boulevard Of The Generals
Suite 100
Norristown, PA 19403
610-631-0333

www.gola.com

