

AVISON  
YOUNG

# 200

GREAT POND DRIVE  
WINDSOR, CT



**UP TO 9,382 SF OF OFFICE**  
**SUBLEASE AVAILABLE IMMEDIATELY**

TERM THROUGH OCTOBER 2031



## PROPERTY DETAILS

- Rate is negotiable
- Lease expires 10/31/2031
- Furniture available
- Fitness room
- Un-staffed cafeteria
- Outdoor patio area

FLOOR 1  
9,382 SF

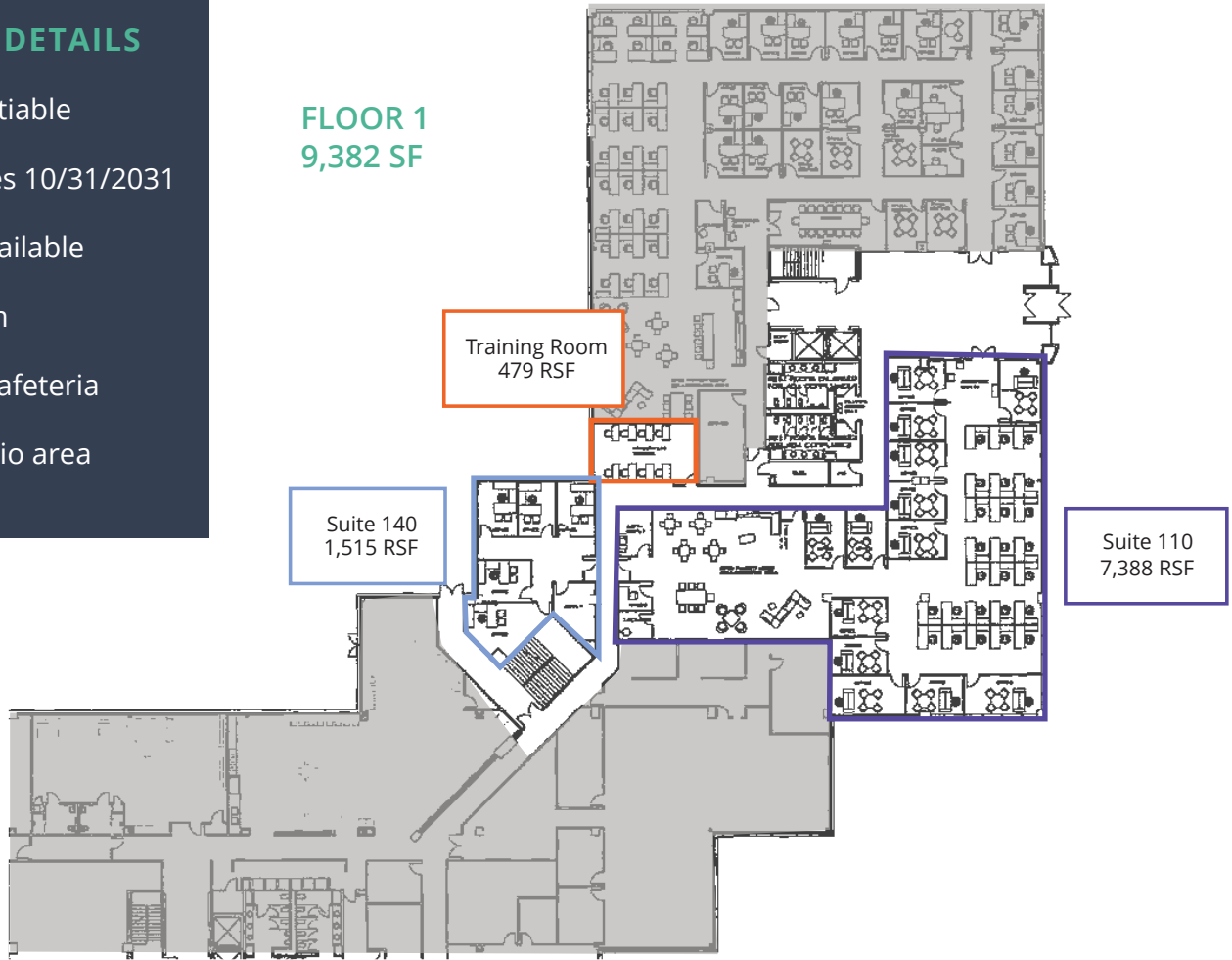

For more information, please contact:

**Maury Smith**, Principal  
860.327.8304  
maury.smith@avisonyoung.com

Avison Young - New England, LLC  
225 Asylum Street, Floor 16  
Hartford, CT 06103

**AVISON  
YOUNG**