

San Felasco Tech City

Class A Flex Space for Lease

13000 Tech City Circle | Alachua, FL 32615



Dan Drotos, MSRE, CCIM, SIOR
Executive Vice President
+1 954 551 9846
dan.drotos@colliers.com

Rory Causseaux, P.E.
Vice President
+1 352 317 6341
rory.causseaux@colliers.com

Lauren Edwards
Senior Associate
+1 352 222 4590
lauren.edwards2@colliers.com

Colliers
104 SW 6th Street
Gainesville, FL 32601
colliers.com/gainesville





San Felasco Tech City

Opened in 2019, **San Felasco Tech City** is an innovative mixed-use development site serving 60+ companies in various sectors, such as start-ups, biomedical, research, labs, offices, retail, industrial and light manufacturing. Based on a “live, work, play” concept, this 82-acre, fully solar-powered community exists in the midst of walking and biking trails, playgrounds, community and meditation center, café, coffee shops, breweries, a preschool and unfettered access to the gorgeous 7,200-acre San Felasco Hammock State Park within walking distance.



Building Specs



Building Class

A



Zoning

CI



Electricity

Solar Powered



Min. Divisible

2,500± SF

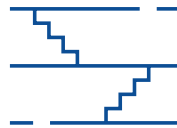

Max. Contiguous

270,000± SF



Year Built

2019

San Felasco Tech City



A mixed use development site serving startups and accelerating growth. Located in North Central Florida with direct routes to all parts of the state.

Building	Lease Rate	Available SF
A	-	Fully Leased
B	-	Fully Leased
C	-	Fully Leased
D	-	Fully Leased
E	-	Fully Leased
F (2-story)	\$30.00/SF NNN	15,000 SF
G	\$25.00/SF NNN	Entire Building*
H (2-story)	\$30.00/SF NNN	Entire Building*
I	-	Fully Leased
Cafe	-	Fully Leased

Pass thru expenses: \$3.85/SF

*Entire building is 30,000± SF



441

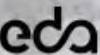

San Felasco Tech City



The **San Felasco Tech City** inspiration board includes stilt homes, town houses, Native American architecture, repetitive design and shade.

The site merges into the San Felasco Hammock Preserve, essentially opening the project up to 7,200± acres of nature and 30 miles of bike paths.



San Felasco Tech City



The project affords the wonderfully mixed community of tech and like-minded employees to live, work and play in an inclusive and exciting atmosphere.

The new preschool building allows employees in **San Felasco Tech City** the ease of high-quality child care just steps away from work and residents in the Alachua area a brand new childcare option.

- Preschool - ages 6 months to 5 years



San Felasco Tech City



Solar Pathways



Features include solar panels over pedestrian areas, solar roofs and solar trees to generate more than 1 megawatt of power that should sustainably cover the community's energy consumption.

Solar Trees



Solar Roof



San Felasco Tech City



The Domains



The “Live” aspect of SFTC is here! The first phase of 252 residential homes is nearing completion. The neighborhood named “The Domains” has four different floor plans to choose from ranging from 836 SF to 1,678 SF -- all with direct-entry garages. The Domains is nestled within SFTC embracing a lifestyle that takes advantage of an array of modern conveniences and recreational offerings just moments away.



[CLICK TO LEARN MORE](#)

San Felasco Tech City



Additional Photos



San Felasco Tech City



Master Plan

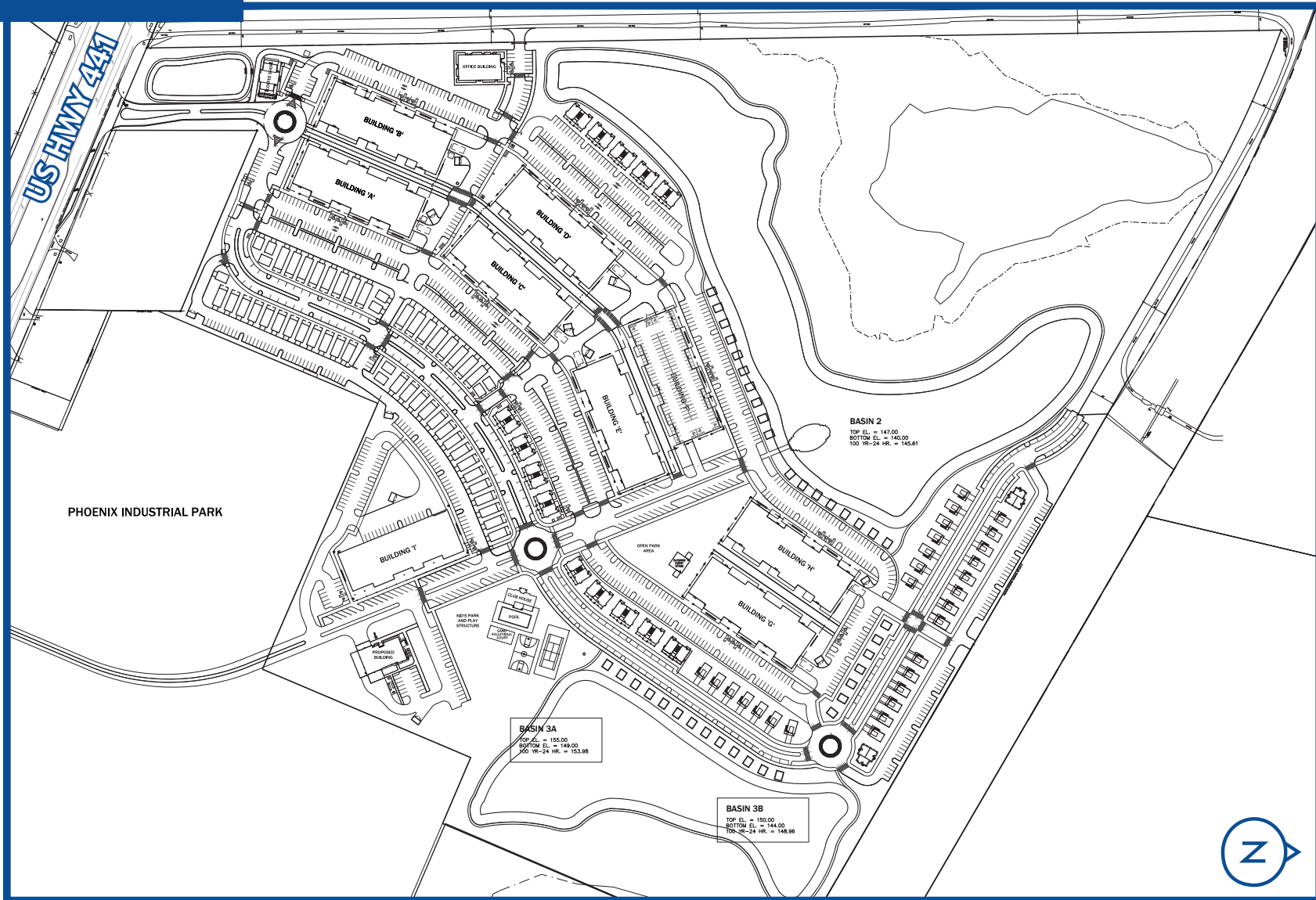

San Felasco Tech City



A Robust Tenant List

KEITH WATSON
EVENTS • DESIGN • FLORALS • WEDDINGS



LAUNCH PAD
@SFTC



ANAMAR ENVIRONMENTAL CONSULTING



NEXTGEN
BIOLOGICS



KWEHEALTH

borealis



SANDBERG
PHOENIX



Dignity & Trust Law

Protecting your roots so your legacy will flourish

Edward Jones
Serving Individual Investors Since 1871



dfracture



SIEMENS



San Felasco Tech City



Highway Access from Site



US HWY 441
Interstate 75

City of Alachua

TO Gainesville (7 miles)

Area Overview

Alachua

North of Gainesville, among fields of wildflowers and piney woods is the town of Alachua, Florida. It's a place rarely found this day and age right down to a Main Street that looks like exactly how small-town America should with small family-owned shops and restaurants. It's a healthy dose of nostalgia and Old South charm for sure, but that's not all. While a far cry from Silicon Valley, there are a number of high-tech and manufacturing companies that call Alachua home. Not bad for a town whose name is taken from an Timucua word meaning "sinkhole."



Demographics

ESRI Business Analyst, 5 mile radius



2024 Estimated
Population

17,267

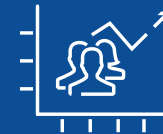

2029 Projected
Population

18,355



2024 Estimated
Average Income

\$101,485



2029 Projected
Average Income

\$122,042

San Felasco Tech City



Area Overview Gainesville



Site is located just **12 miles** from

Gainesville is centrally located (midway between the Gulf of Mexico and the Atlantic Ocean) between the three major Florida cities of Jacksonville, Orlando and Tampa. Situated at the heart of North Central Florida, the city of Gainesville serves as one of Florida's major centers of culture, education, medicine, sports and commerce. Gainesville is home to Florida's largest and oldest university, the University of Florida, as well as Santa Fe College, City College, UF Health and North Florida Regional Medical Center. Gainesville has frequently been recognized as one of the nation's "best cities to live in" due to its unique intersection of urban life with surrounding abundance of natural parks, springs, lakes and untouched landscapes. The climate consists of mild winters and warm summers, with an average of 28,000 hours of sunshine annually. The average high temperature in June is 89°F, while the average high in January is 65°F, and we have a 255-day growing season.





SAN FELASCO TECH CITY

Contact Us

Dan Drotos, MSRE, CCIM, SIOR
Executive Vice President
+1 954 551 9846
dan.drotos@colliers.com

Rory Causseaux, P.E.
Vice President
+1 352 317 6341
rory.causseaux@colliers.com

Lauren Edwards
Senior Associate
+1 352 222 4590
lauren.edwards2@colliers.com

Colliers

104 SW 6th Street
Gainesville, FL 32601
colliers.com/gainesville