

HARBOUR BUSINESS CENTER

880 HARBOUR WAY SOUTH

RICHMOND, CA

880

880

**SUITE 600
FOR LEASE**

±20,669 SF

**RARE MFG/R&D
SPACE**

NEWMARK

MIKE SPIRO

510.681.7918 // mike.spiro@nmrk.com // CA RE Lic #01433395

HIGHLIGHTS

SIZE: ±20,669 SF

FIRE SUPPRESSION: Wet

LIGHTING: LED

PARKING: 3.5/1000

POWER: 1,000 amps of
480/277

LOADING: Two (2) Oversized
Grade level doors

**CEILING
HEIGHTS:** 24'

- Class A Advanced MFG / R&D Space
- Modern kitchen & breakroom
- Private patio
- Fully conditioned

- Polished concrete
- Natural light/skylights
- Open production area
- Walk to Richmond Ferry/ Bay Trail
- Developing advanced manufacturing cluster
- High ceilings w/ drop ceiling clouds (can be removed)
- Heavy Power: dedicated 1,000 amps @ 480 volt power service

FLOORPLAN

SUITE 600 • ±20,669 SQUARE FEET

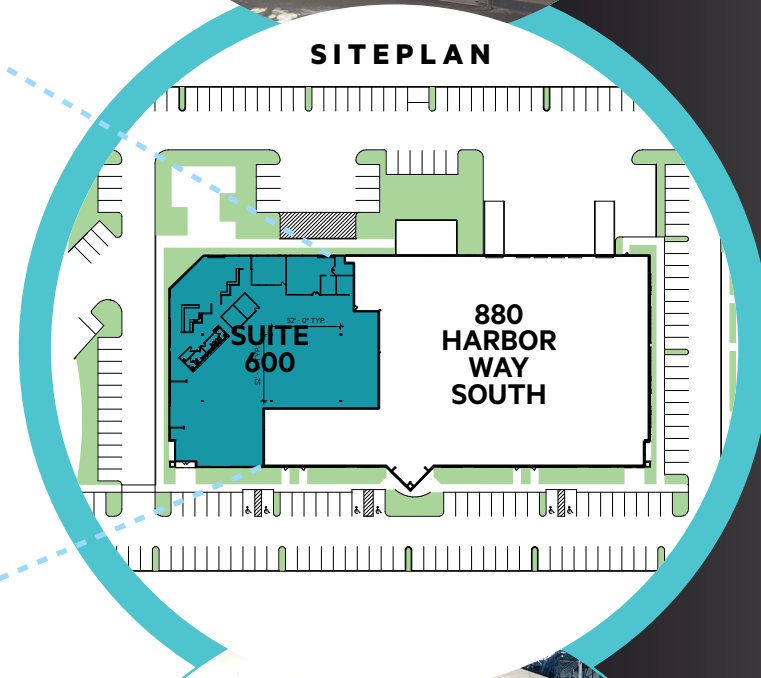
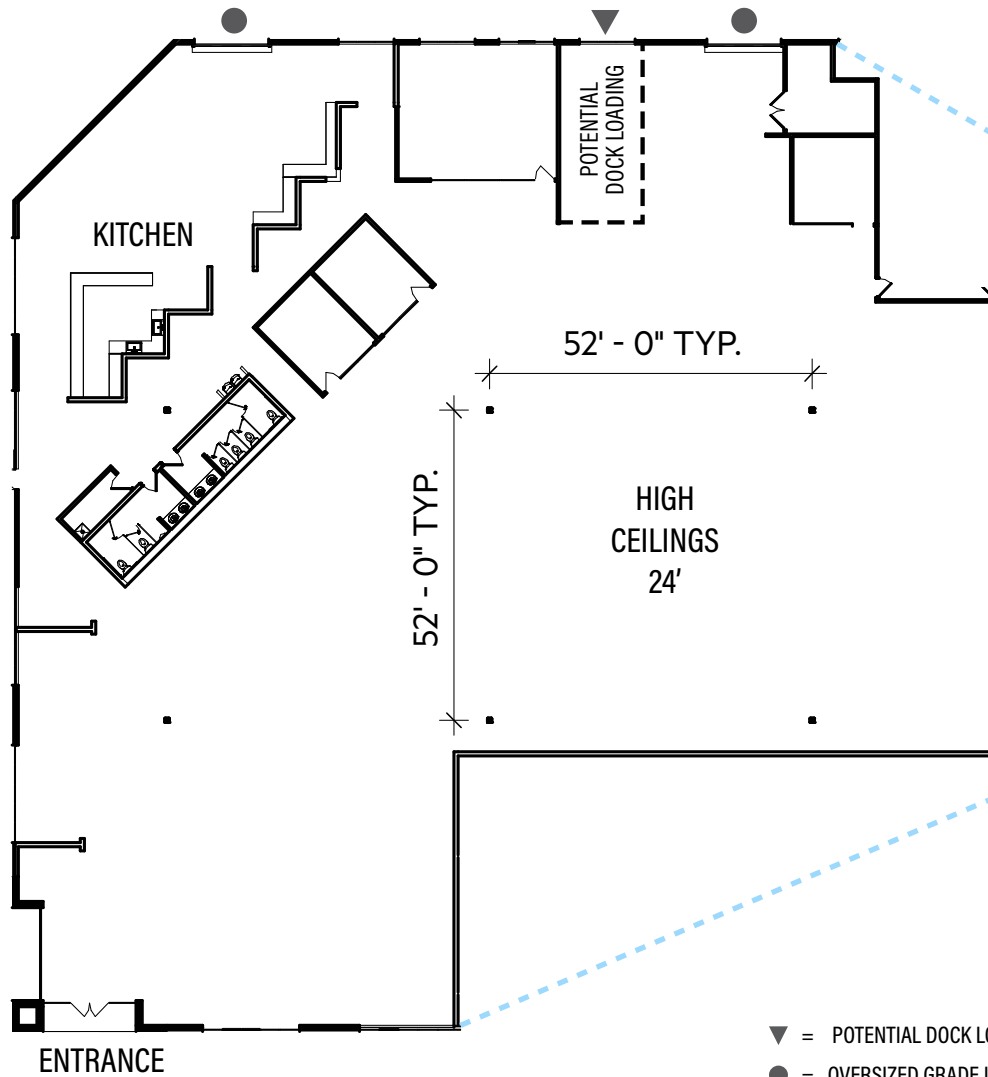

- ▼ = POTENTIAL DOCK LOADING
- = OVERSIZED GRADE LEVEL DOOR

FLOORPLAN NOT TO SCALE



POLISHED CONCRETE FLOOR



HIGH CEILINGS & OPEN PRODUCTION AREA



MODERN KITCHEN & BREAKROOM



NATURAL LIGHT

RENDERINGS FOR POTENTIAL DOCK LOADING



AERIAL



WINE WAREHOUSE

880 HARBOUR WAY SOUTH

DESIGN VERONIQUE®

San Francisco Bay Ferry

GALAXY DESSERTS®

KAISER PERMANENTE®

0.3 MILES
5 MINUTE WALK

MARINA WAY S

ARTISAN COVE



KAISER PERMANENTE®

880 HARBOUR WAY SOUTH

ARTISAN COVE

DESIGN VERONIQUE®

MARINA WAY S

REGATTA BLVD

HARBOUR BUSINESS CENTER

880 HARBOUR WAY SOUTH

RICHMOND, CA



Contact Listing Broker For More Information

MIKE SPIRO // 510.681.7918 // mike.spiro@nrmk.com // CA RE Lic #01433395

NEWMARK

The distributor of this communication is performing acts for which a real estate license is required. The information contained herein has been obtained from sources deemed reliable but has not been verified and no guarantee, warranty or representation, either express or implied, is made with respect to such information. Terms of sale or lease and availability are subject to change or withdrawal without notice. MP-1502 | 10/24