

Long Term Direct Deals Available

905 Lakeside Drive

Gurnee, IL

905 Lakeside Drive
Gurnee, IL
CBRE Properties: 905 Lakeside Dr.

5,958 SF Available for Sublease | Short Term Overflow Space | Long Term Direct Deals Available



5,958 SF For Sublease

905 Lakeside Drive | Gurnee, IL

5,958 SF

Available For Sublease

905 Lakeside Drive is located in Gurnee IL. The facility is 62,940 SF industrial building with 5,958 SF available for sublease. The space features 18.5' ceiling height, 6 shared loading docks, 6 drive-in doors, and 1,107 SF of office space. Sublease term through 5/1/2027.

Conveniently located in Lake County, 1 mile from a four-way interchange at I-94 via Grand Ave, and close to local amenities and retail.

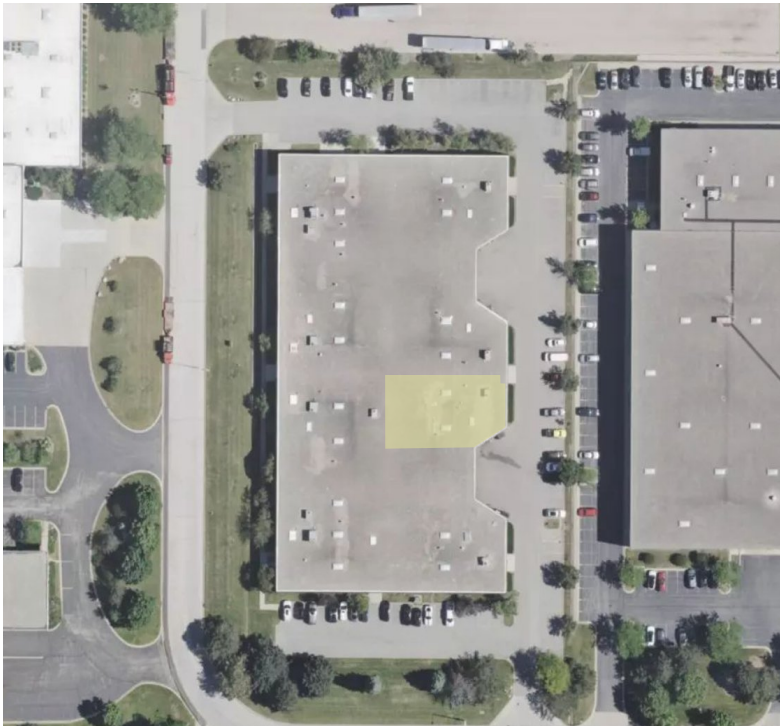

Building Specifications

Total Building	62,940 SF
Total Available	5,958 SF
Office	1,107 SF
Year Built	1994
Loading	3 shared docks, 1 DID
Ceiling Height	18.5'
Sprinklered	Yes
Parking	1 stall per 1,000 SF
Sublease Term Through	5/1/2027
Asking Rate	\$9.00 PSF Gross

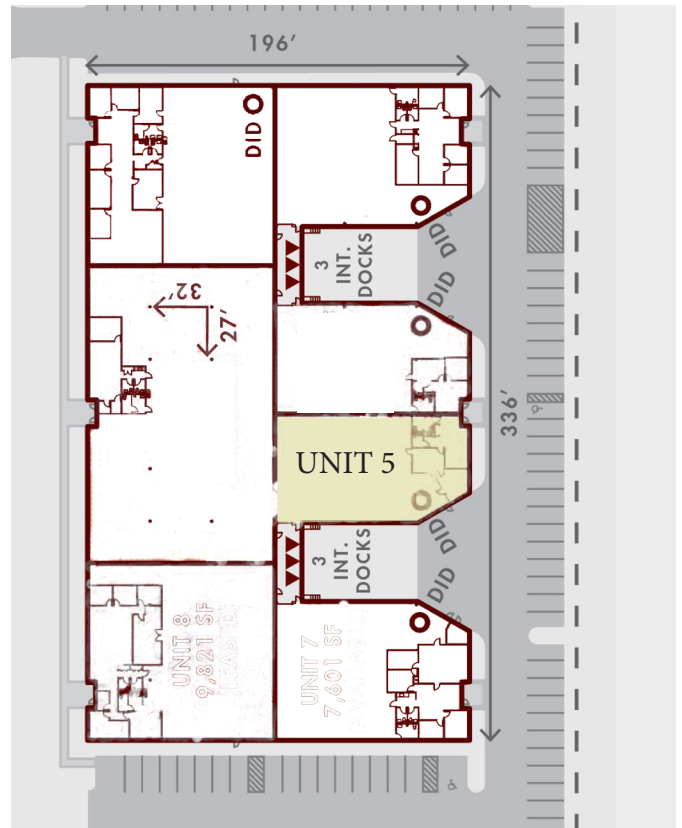

Immediate Availability

905 Lakeside Drive is an industrial facility with 5,958 SF available for sublease. Can be used as short term or overflow space.

- + 1 mile to I-94 Interchange
- + Business Park Atmosphere



Contact Us

Johnny Connors

Vice President

+1 630 368 7321

johnny.connors@cbre.com

© 2026 CBRE, Inc. All rights reserved. This information has been obtained from sources believed reliable, but has not been verified for accuracy or completeness. You should conduct a careful, independent investigation of the property and verify all information. Any reliance on this information is solely at your own risk. CBRE and the CBRE logo are service marks of CBRE, Inc. All other marks displayed on this document are the property of their respective owners, and the use of such logos does not imply any affiliation with or endorsement of CBRE. Photos herein are the property of their respective owners. Use of these images without the express written consent of the owner is prohibited.