

	NEW WALL/PARTITION
	EXISTING WALL/PARTITION
	DEMOUNTABLE WALL, SOLID PANEL. BASIS OF DESIGN: KI LIGHTLINE OR EQUAL. REFER TO DETAIL 2'G1.
	DEMOUNTABLE WALL, GLAZED PANEL. BASIS OF DESIGN: KI LIGHTLINE OR EQUAL. REFER TO DETAIL 3'G1.
	COLUMN GRID LINE
	PARTITION TYPE SEE WALL TYPES FOR DETAILS
	NEW DOOR DOOR AND HARDWARE BY DEMOUNTABLE WALL CONTRACTOR.
	EXISTING DOOR SEE DOOR SCHEDULE
	AREA NOT IN CONTRACT (N.I.C.)
	FIRE EXTINGUISHER CABINET (SURFACE MOUNTED) FIRE EXTINGUISHER CABINET (SEMI-RECESSED) FIRE EXTINGUISHER CABINET (RECESSED)
	WALL MTD SIGN SEE SIGNAGE LEGEND
	WORKING POINT
	MILLWORK
	FLOOR OUTLET. SEE ELECT DWGS.
	PROJECTION SCREEN
	WHITE BOARD
	TACK BOARD - SELF HEALING
	DRINKING FOUNTAIN
	CENTER LINE (WINDOW)
	THERMOSTAT
	LEASE LINE

Clarke Catton Hintz
 Architecture
 Planning
 Landscape Architecture

100 Barrack Street
 Tremonton, NJ 08868
 Tel: (609) 883-9893
 Fax: (609) 883-9444
 www.clarkecattonhintz.com

Drawings Copyright © 2019 Clarke Catton Hintz, P.C.

OWNER/LANDLORD:
 Atlantic County Improvement Authority
 1333 Atlantic Avenue, Suite 700
 Atlantic City, NJ 08401
 (609) 992-0714

HVAC ENGINEER:

ELECTRICAL ENGINEER:

GENERAL CONTRACTOR:
 Hensert Construction Management, LLC
 15 W. Stew Road
 Marlton, NJ 08053
 (856) 988-5007

SUBMISSIONS		
NO.	DATE	DESCRIPTION
1	05/15/19	ISSUED TO OWNER
REVISIONS		

ARCHITECT
 NJ LICENSE NO. 21A01030000

 DATE: _____

**NATIONAL AVIATION
 RESEARCH AND
 TECHNOLOGY PARK
 BUILDING #3:**
 THUNDERBOLT TENANT FIT-OUT

DATE: 5/15/2019
 SCALE:
 DRAWN BY: DCZ
 CHECKED BY: SD

SHEET TITLE:
 FLOOR PLAN

DRAWING NO.:
A1
 CCH PROJECT NO.: 2075

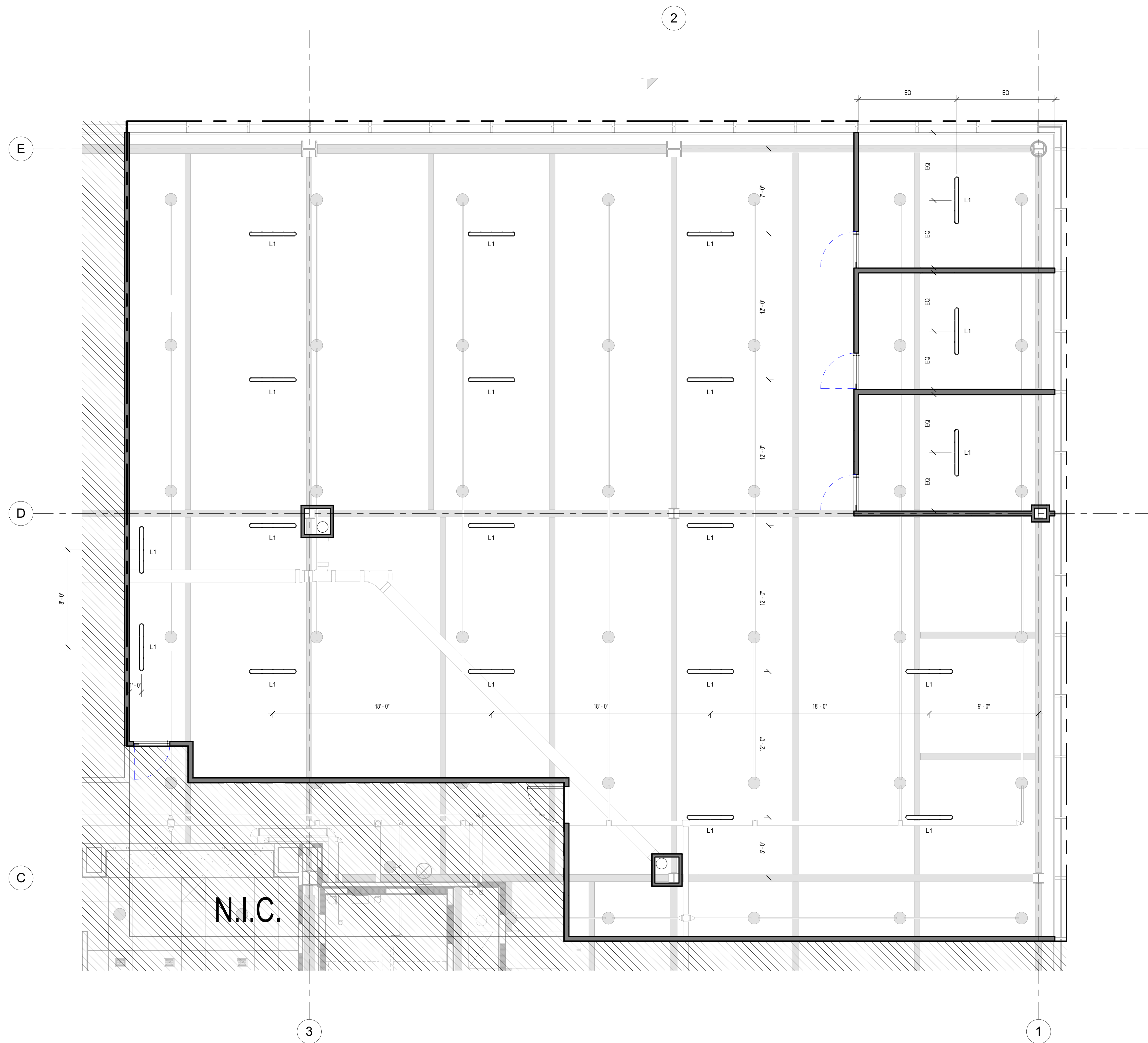

- CEILING PLAN LEGEND -

INDICATED INTERIOR FINISH SURFACE ELEVATION AFF. ← 0'-0"

ABBREVIATIONS:

- CH = CEILING HEIGHT
- BH = BEAM HEIGHT
- SH = SOFFIT HEIGHT

STL BEAM OR LINTEL. SEE STRUCT DWGS.

STEEL BEAMS IN EXPOSED CEILING. SEE STR. DWGS FOR SIZES AND DETAILS. SEE FIRE PROTECTION PLANS FOR FIREPROOFING

2'X2' ACOUSTICAL CEILING TILE

2' X 6' ACOUSTICAL CEILING TILE

GYP. BOARD CEILING

FRAMED GWB OPENING

CEILING ACCESS DOOR

ROOF SCUTTLE

RECESSED CEILING MTD PROJECTION SCREEN

CLG MTD. PROJECTOR. SEE ELECT/AV DWGS.

SUPPLY AIR DIFFUSER. SEE MECH. DWGS.

RETURN AIR REGISTER. SEE MECH. DWGS.

LINEAR DIFFUSER. SEE MECH. DWGS.

SPRINKLER HEAD. SEE FP DWGS.

SPRINKLER HEAD AND SUPPLY PIPE. SEE FP DWGS.

EXIT SIGN, WALL MTD

PENDANT MOUNTED LINEAR LIGHT FIXTURE. SEE ELEC. DWGS.

NOTE: MECHANICAL & ELECTRICAL DEVICES, LIGHTING, FIRE ALARM DEVICES ARE NOT SHOWN ON THIS DRAWING. REFER TO MEP DRAWINGS FOR TYPES, NUMBERS & APPROXIMATE LOCATION OF DEVICES.

100 Barrack Street
 Tremonton, NJ 08868
 Tel: (908) 883-9933
 Fax: (908) 883-9444
 www.clarkecatonhintz.com

Clarke Caton Hintz
 Architecture
 Planning
 Landscape Architecture
 Drawings Copyright © 2019 Clarke Caton Hintz, PC

OWNER/LANDLORD:
 Atlantic County Improvement Authority
 1333 Atlantic Avenue, Suite 700
 Atlantic City, NJ 08401
 (609) 992-0714

HVAC ENGINEER:
 Fox & Associates Engineering, Inc.
 25 Bala Avenue, Suite 204
 Bala Cynwyd, PA 19004
 (610) 664-8555

ELECTRICAL ENGINEER:
 Muthern Consulting Engineers
 321 South York Road
 Hatboro, PA 19040
 (215) 293-9900

GENERAL CONTRACTOR:
 Hensert Construction Management, LLC
 15 W. Shaw Road
 Marlton, NJ 08053
 (856) 988-5507

SUBMISSIONS	
NO.	DESCRIPTION
1	01/15/19 ISSUED TO OWNER
2	01/18/19 ISSUED FOR PERMITS
3	02/25/19 ISSUED FOR CONSTRUCTION
REVISIONS	

ARCHITECT
 NJ LICENSE NO. 21A0130000

 DATE: _____

**NATIONAL AVIATION
 RESEARCH AND
 TECHNOLOGY PARK
 BUILDING #3:
 NJ11 TENANT FIT-OUT**

DATE: 5/15/2019
 SCALE:
 DRAWN BY: DCZ
 CHECKED BY: SD

SHEET TITLE:
**REFLECTED CEILING
 PLAN**

DRAWING NO.:
A2
 CCH PROJECT NO.: 2075