

Warner-Susan Business Park

3140 W. Warner Avenue, Santa Ana

Recent Interior Improvements

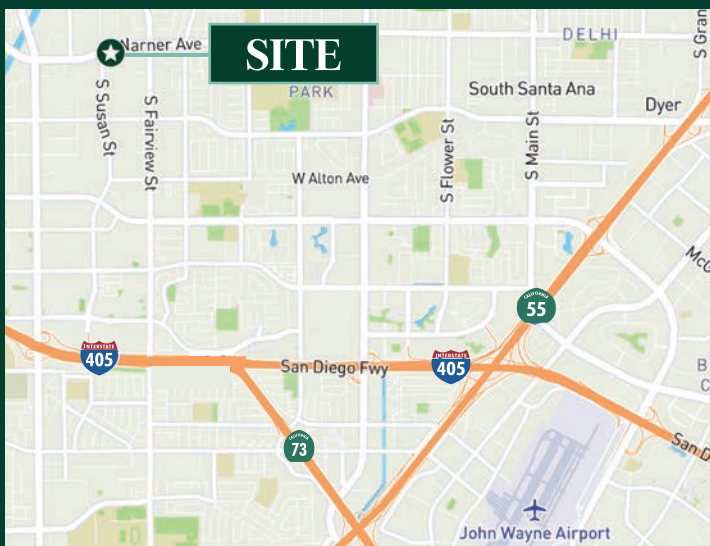

Sublease Highlights

- + ±12,408 SF Freestanding Industrial Building
- + ±2,385 SF of Office Space
- + Two (2) Ground Level Doors
- + 16' Warehouse Clearance
- + 800 Amps, 277/480 Volts Power (Verify)
- + 1.5:1,000 SF Parking
- + Fenced Parking Area
- + Bonus Mezzanine Space
- + Sublease Term through February 28, 2030
- + Minutes from the San Diego (405) Freeway

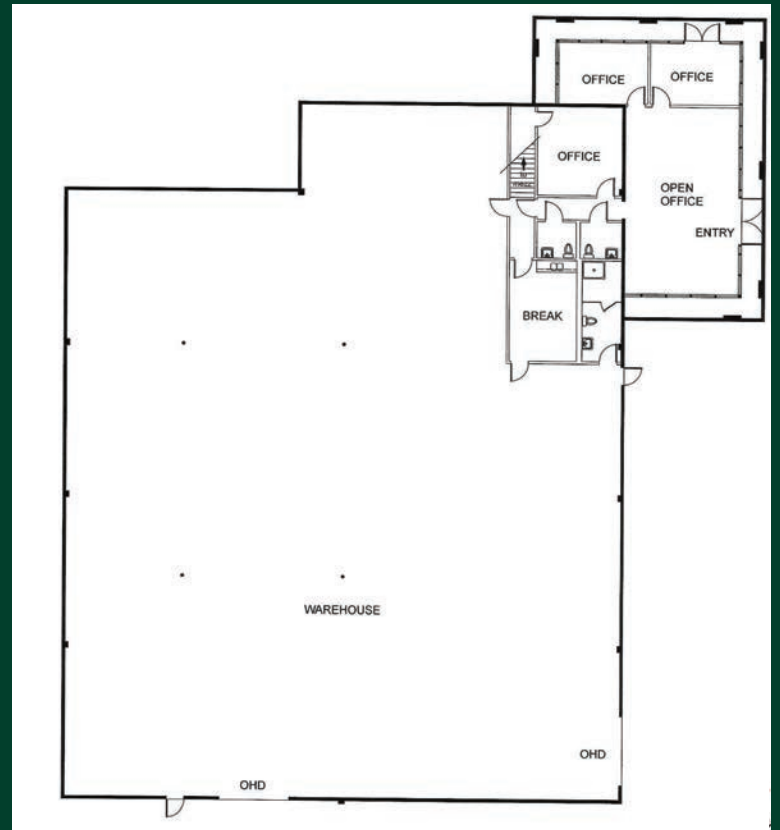

Contact Us

Jake Marthens
Senior Associate
+1 949 725 8536
jake.marthens@cbre.com
Lic. 02096966

Nick Spatafore
Senior Vice President
+1 949 725 8657
nick.spatafore@cbre.com
Lic. 01353378

© 2025 CBRE, Inc. All rights reserved. This information has been obtained from sources believed reliable, but has not been verified for accuracy or completeness. You should conduct a careful, independent investigation of the property and verify all information. Any reliance on this information is solely at your own risk. CBRE and the CBRE logo are service marks of CBRE, Inc. All other marks displayed on this document are the property of their respective owners, and the use of such logos does not imply any affiliation with or endorsement of CBRE. Photos herein are the property of their respective owners. Use of these images without the express written consent of the owner is prohibited.