

INDUSTRIAL SPACE  
FOR LEASE

# 7528-7550

## BATH ROAD

Mississauga, Ontario

~~7534 - Unit 2 - 1,590 SF~~ *Leased!*

**531 SF to 5,072 SF**

**Available for Lease!**



**MICHELLE VIGNA**

Leasing Manager | Real Estate Broker

**Colonnade BridgePort Realty Inc., Brokerage**

[mvigna@colonnadebridgeport.ca](mailto:mvigna@colonnadebridgeport.ca)

416.363.3063 m 647-267-5746



**COLONNADE  
BRIDGEPORT**

Realty Inc., Brokerage

# 7528-7550

## BATH ROAD

Mississauga, Ontario

### LEASE DETAILS

**Basic Rental Rate:** Please inquire

**Taxes & Operating:** \$9.58/SF

Operating costs, tax estimates and rental ranges are based on 2026 figures and are subject to change.



### OPPORTUNITY

~~7534 - Unit 2 - 1,590 SF~~ *Leased!*

**7542 Bath Rd. - 1,622 SF\***

**7544-7548 Bath Rd. - 2,919 SF\***

**7550 Bath Rd. - 531 SF\***

**\* Can be combined to 5,072 SF**

**AVAILABLE IMMEDIATELY**

### HIGHLIGHTS

- ✓ One minute walk to MiWay bus service - route 45
- ✓ 15 minute drive to:
  - UP Express
  - Toronto Airport Express
  - Pearson International
- ✓ 35 minute drive to Billy Bishop Toronto City (Accessible to Mississauga via UP Express train)
- ✓ Minutes from HWY 427 and 407
- ✓ On site parking available -
- ✓ Many nearby restaurants and amenities including Tim Hortons, Quiznos, gas station and more
- ✓ Plenty of natural light
- ✓ Excellent street exposure

# 7528-7550 BATH ROAD

Mississauga, Ontario

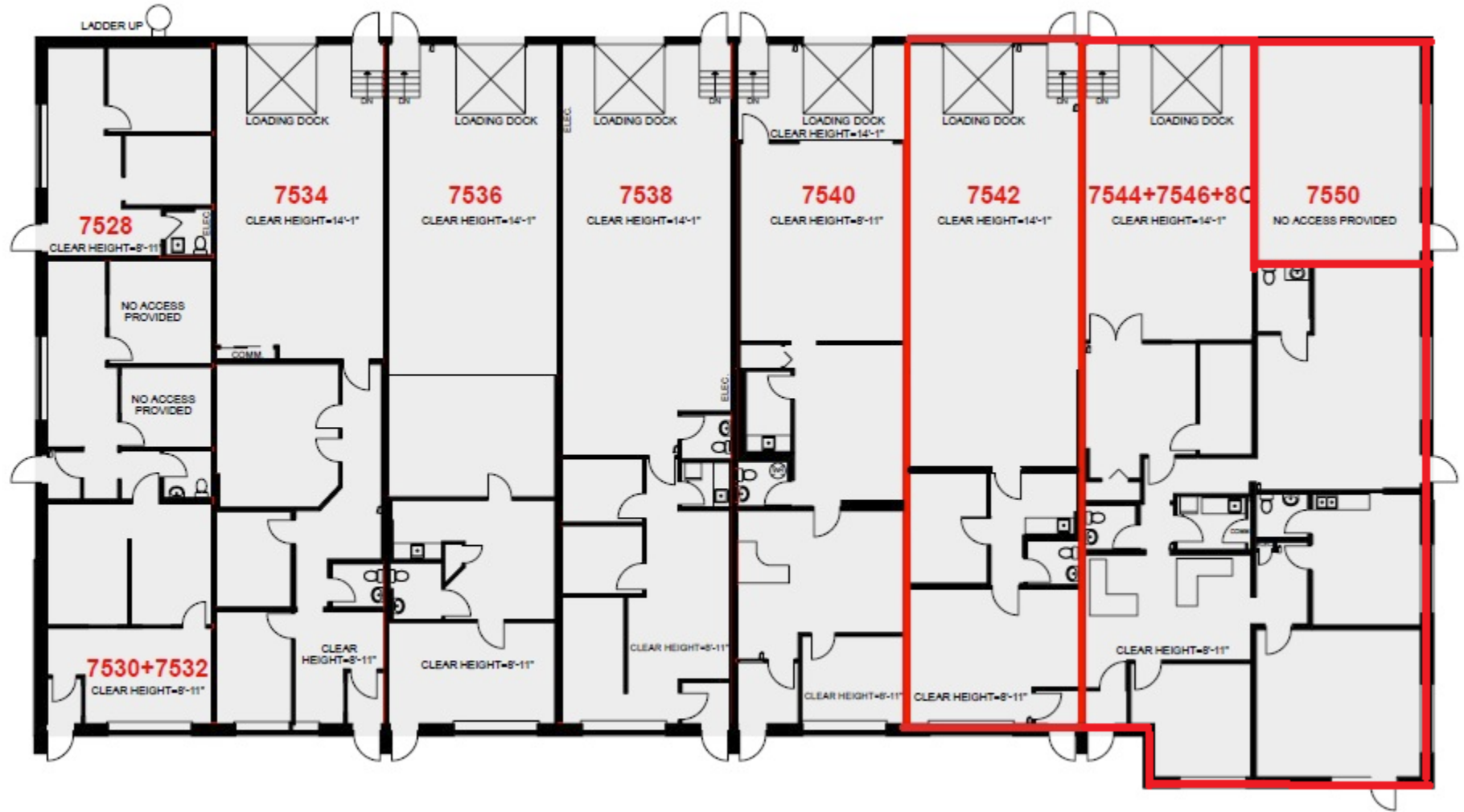

# AREA MAP

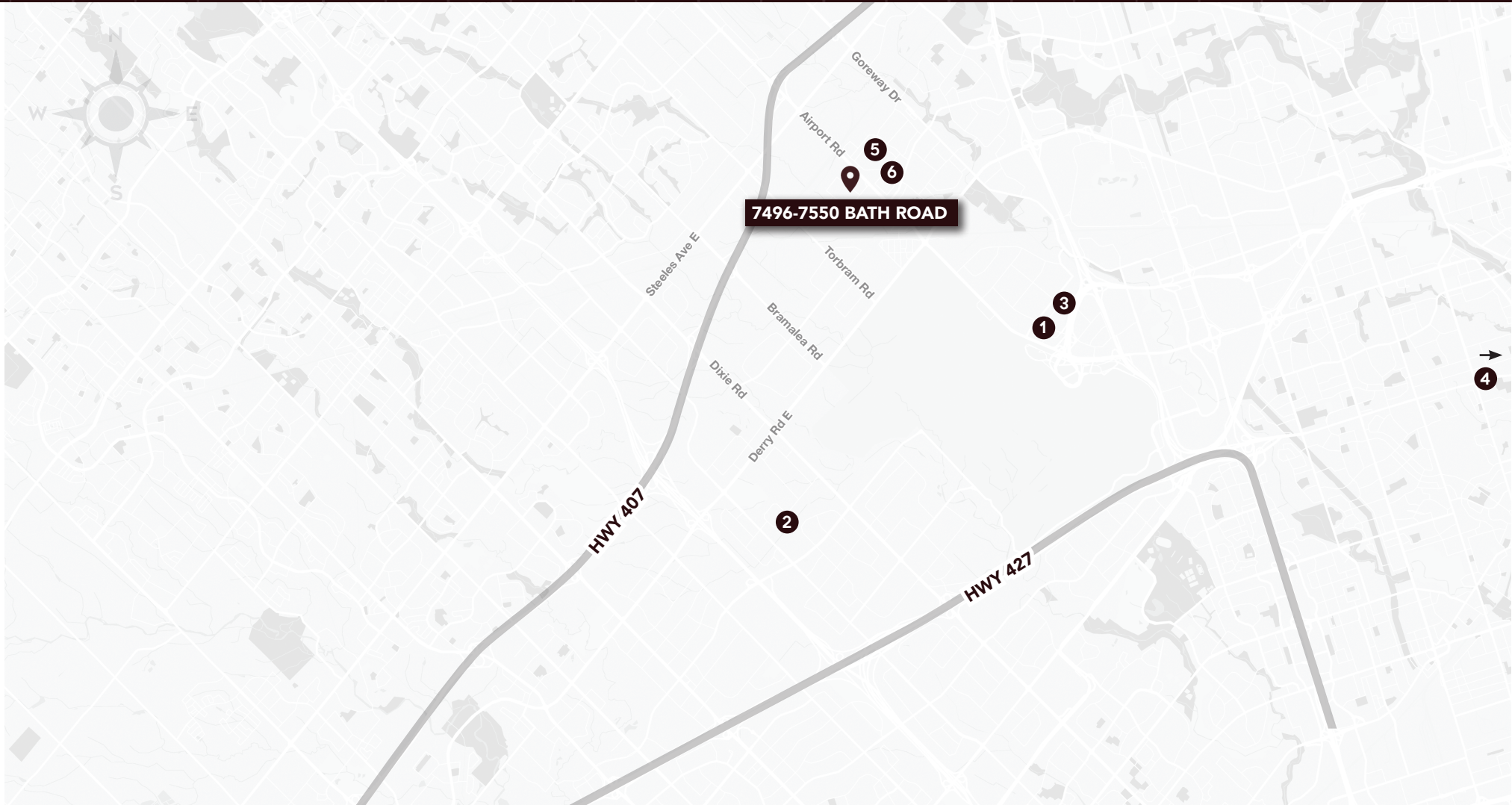

**7528-7550**  
**BATH ROAD**  
Mississauga, Ontario

- 1 UP Express
- 2 Toronto Airport Express
- 3 Pearson International Airport
- 4 Billy Bishop Toronto City Airport
- 5 Tim Hortons
- 6 Elmvale Acres Shopping Centre