

FOR LEASE
±26,256 SF AVAILABLE

SAN POLO BUSINESS PARK
1773 WRIGHT AVE., LA VERNE, CA 91750

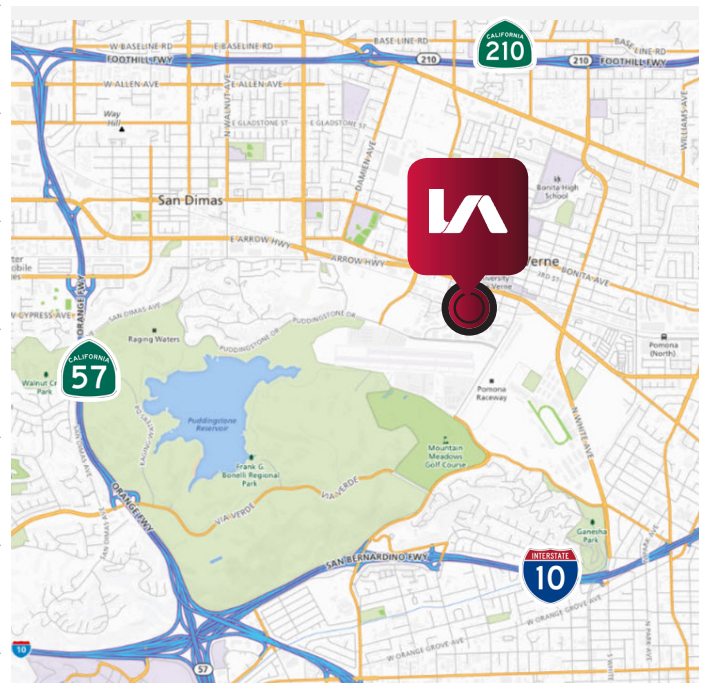

- Excellent Corporate Headquarters
- Located in San Polo Business Park
- ±13,714 SF of 2-Story Office Space
- Potential to be used as Assembly or R&D
- 400 Amps, Possible 800 Amps, 277/480 Volts
- Great Access to the I-10, CA-210, and CA-57 Freeways



TODD LAUNCHBAUGH
tlaunchbaugh@lee-assoc.com
D 909.373.2911
DRE #01059250

JUSTIN LEEWOOD
jleewood@lee-assoc.com
D 909.373.2989
DRE #01837452

LEE & ASSOCIATES
COMMERCIAL REAL ESTATE SERVICES
Corporate ID: 00976995

FOR LEASE

±26,256 SF AVAILABLE

SAN POLO BUSINESS PARK

1773 WRIGHT AVE., LA VERNE, CA 91750

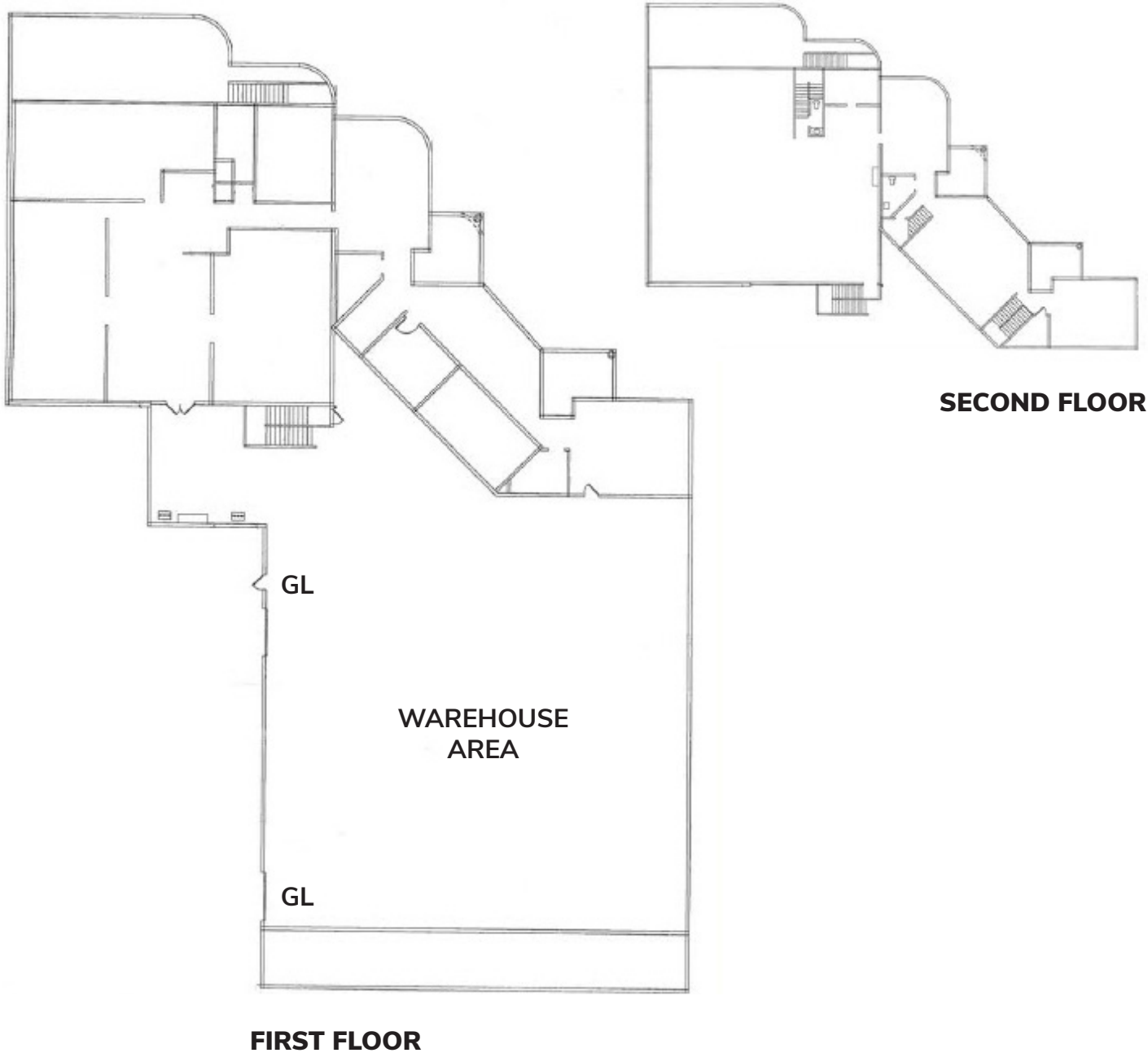

TODD LAUNCHBAUGH
tlaunchbaugh@lee-assoc.com
D 909.373.2911
DRE #01059250

JUSTIN LEEWOOD
jleewood@lee-assoc.com
D 909.373.2989
DRE #01837452

LEE & ASSOCIATES
COMMERCIAL REAL ESTATE SERVICES
Corporate ID: 00976995