



Industrial Building Available **FOR LEASE**

3401 N. Sillect Avenue ▪ Bakersfield, CA



- Property Highlights**
- 67,200 SF
 - 10,000 SF of office and showroom
 - Fenced yard area
 - Dock High Loading Ramp
 - 24' - 28' Clear Height
 - Zoned M-2 PD



John A. Ritchie ▪ Senior Vice President ▪ 661 616 3583 ▪ johnr@asuassociates.com ▪ CA RE #00900552
11601 Bolthouse Drive Suite 110 ▪ Bakersfield, CA 93311 ▪ 661 862 5454 main ▪ 661 862 5444 fax

The information contained herein may have been obtained from sources other than ASU Commercial. We have not verified such information and make no guarantees, warranties or representations about such information. It is your responsibility to independently confirm its accuracy and completeness prior to purchasing/leasing the property.

Industrial Building Available For Lease

3401 N. Sillect Avenue ■ Bakersfield, CA

Floor Plan

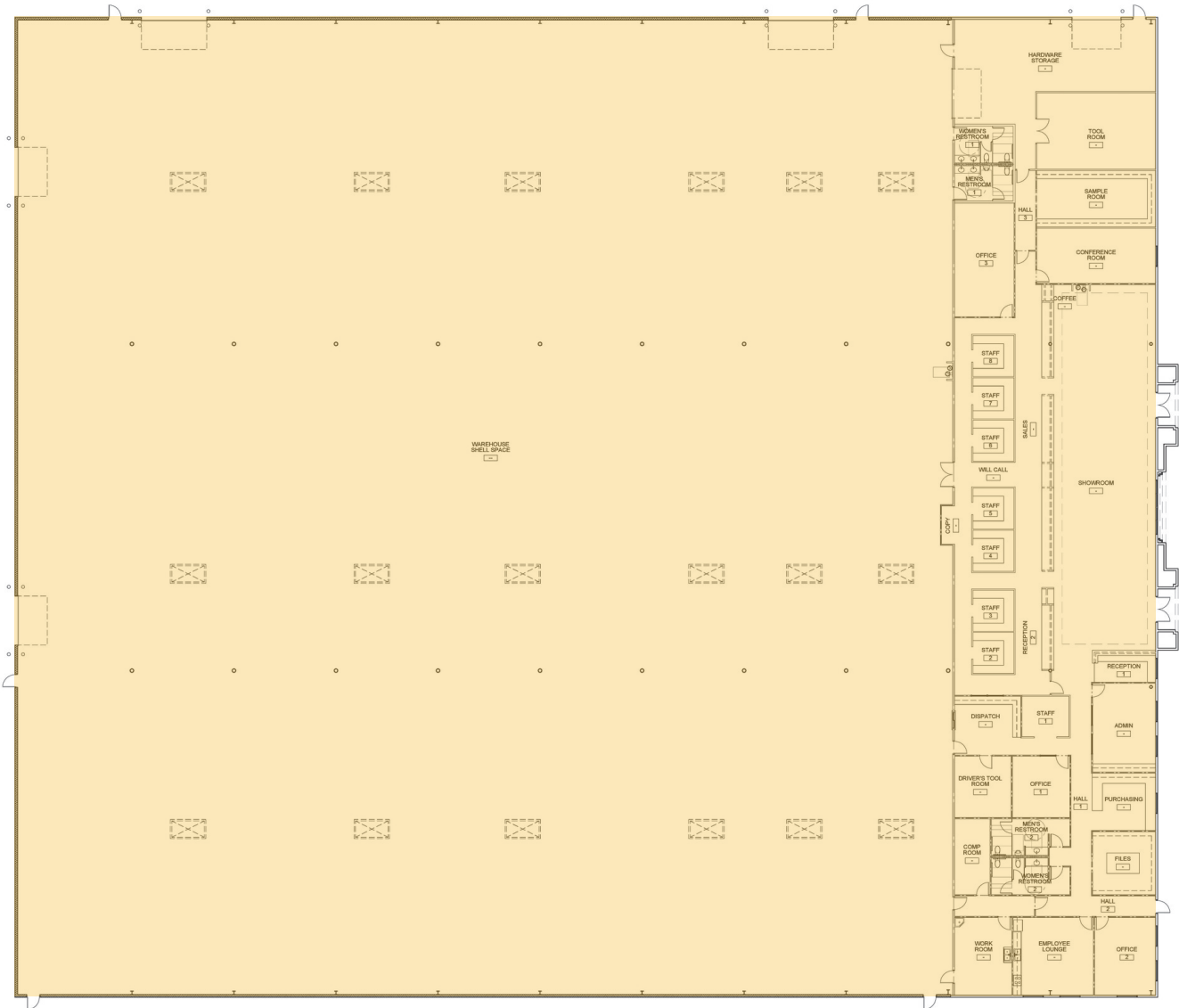

John A. Ritchie ■ Senior Vice President ■ 661 616 3583 ■ johnr@asuassociates.com ■ CA RE #00900552
11601 Bolthouse Drive Suite 110 ■ Bakersfield, CA 93311 ■ 661 862 5454 main ■ 661 862 5444 fax



Industrial Building Available For Lease

3401 N. Sillect Avenue ■ Bakersfield, CA

Area Aerial Map



3401 N. Sillect Avenue

