

# 2630 W. BROOKS AVENUE

North Las Vegas, Nevada 89032

AVAILABLE  
For Sale

OPPORTUNITY ZONE



5960 S. Jones Blvd, Las Vegas, NV 89118  
(702) 388-1800 MAIN • (702) 388-1010 FAX  
www.mdlgroup.com

**Myles Johnson**  
Advisor  
Lic#: BS.1002160  
(702) 600-3307  
mjohnson@mdlgroup.com

**Jerdin Lindquist**  
Senior Associate  
Lic#: BS.0146806  
(702) 755-1528  
jlindquist@mdlgroup.com

**Kenneth Arevalo**  
Associate  
Lic#: BS.0146340.PLLC  
(702) 773-0881  
karevalo@mdlgroup.com



## Listing Snapshot

 **\$3,400,000**  
Sale Price

 **\$324.55**  
Price per Square Foot

 **±10,476 SF**  
Available Space

 **North Las Vegas**  
Submarket

## Property Highlights

- ±10,476 SF (Includes ±1,078 SF of Office)
- Fire Sprinklers
- 17 parking stalls
- 18' clear height
- Five (5) 12' W x 14' T grade-level doors
- 400-amp, 480-volt, 3-phase
- New Construction to be completed April 2026
- Close proximity to the North Las Vegas Airport. Immediate access to the I-15 Freeway via W Cheyenne Ave.a

## Property Overview

Presenting 2630 W. Brooks Avenue, North Las Vegas, Nevada 89032 – a ±10,476 SF newly constructed industrial building currently under development and scheduled for completion in April 2026. Situated on a ±0.63-acre site and zoned M-2 (Industrial Light), the property offers ±1,078 square feet of office space, ±18' clear height, five (5) 12' x 14' grade-level doors, fire sprinklers, and 17 parking stalls—ideal for a variety of owner-user or investment needs. Strategically located in the North Las Vegas submarket near Simmons St. and W. Cheyenne Ave., the property provides immediate access to the I-15 freeway and close proximity to the North Las Vegas Airport, offering strong connectivity within a thriving industrial corridor.

## Key Demographics (within a 3-mile radius)

 **±160,707**  
Population Size

 **\$83,210**  
Ave. Household Income

APN 139-17-510-005

Zoning General Industrial (M-2)

Year Built 2026

Property Size ±10,476 SF

Cross Streets Brooks Avenue & Coleman Street

Lot Size ±0.63 AC

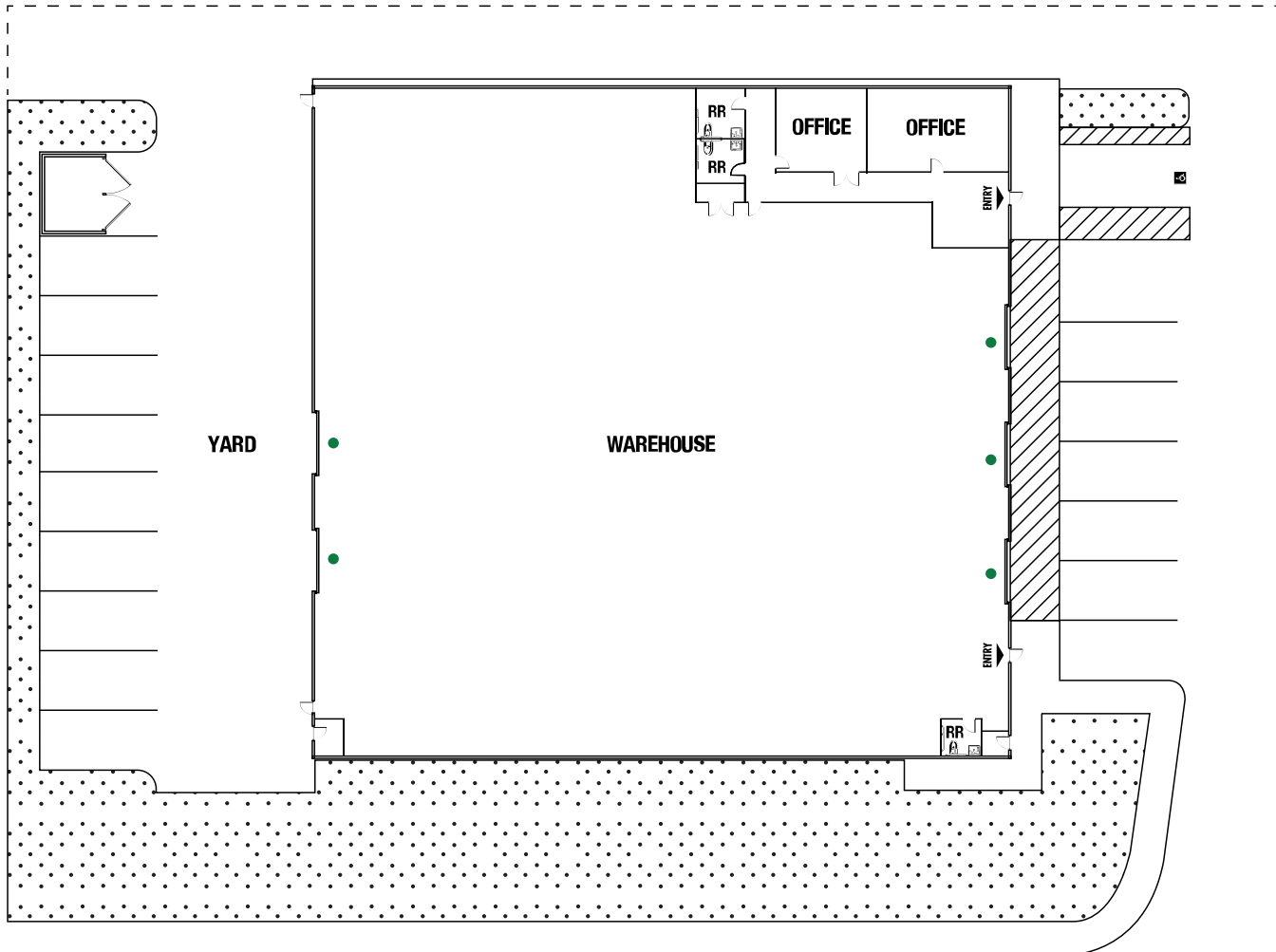

← BROOKS AVE →

### Listing Snapshot

 **\$3,400,000**  
Sale Price

 **\$324.55**  
Price per Square Foot

 **±10,476 SF**  
Available Space

 **Immediately**  
Availability

### Suite Specs

Total SF ±10,476

Office SF ±1,078

Warehouse SF ±9,398

Grade Level [●] 5 roll-up doors (12'x14')

Clear Height 18'

Power 400 A • 480 V • 3-phase  
*(to be verified by tenant)*

2630 W. BROOKS AVENUE  
North Las Vegas, Nevada 89032



For Sale

## Aerial Map



 **MDL Group**  
Service you deserve. People you trust.

 **CORFAC**  
INTERNATIONAL  
MEMBER | PARTNER

 5960 S. Jones Boulevard, Las Vegas, Nevada 89118  
 (702) 388-1800 MAIN • (702) 388-1010 FAX  
 [www.mdlgroup.com](http://www.mdlgroup.com)

## Property Photos





# Clark County Nevada

## Synopsis

As of the 2020 census, the population was 2,265,461, with an estimated population of 2,506,458 in 2025. Most of the county population resides in the Las Vegas Census County Divisions across ±435 square miles. It is by far the most populous county in Nevada, and the 11th most populous county in the United States. It covers 7% of the state's land area but holds 73% of the state's population, making Nevada one of the most centralized states in the United States.

With jurisdiction over the world-famous Las Vegas Strip and covering an area the size of New Jersey, Clark County is the nation's 14th-largest county. The County is a mix of urban and rural locales that offers the convenience of city living with access to some of the nation's best outdoor recreational areas just a short drive away.

Clark County employs more than 10,000 people over 38 departments. The County has an annual budget of \$11.4 billion, which surpasses that of the state government.

## Quick Facts



**±7,892**

Land Area  
(Square Miles)



**2,265,461**

Population  
(County Data per Census)



**298**

Pop. Density  
(Per Square Mile)

Sources: [clarkcountynv.gov](http://clarkcountynv.gov), [data.census.gov](http://data.census.gov), [lvgea.org](http://lvgea.org), [wikipedia.com](http://wikipedia.com)

# North Las Vegas

## Synopsis

North Las Vegas, NV, offers a premier, business-friendly environment known for its “fast and faster” development approach. This commitment has positioned the city as one of the nation’s top locations for development opportunities and job creation. The city is a magnet for global brands, innovative industries, and large-scale manufacturing, e-commerce, and distribution centers, driving significant economic diversification. Strategically located with unparalleled logistics advantages, North Las Vegas provides swift access to major transportation corridors, rail lines, and two key airports (North Las Vegas Airport and Harry Reid International). Its proximity to interstates, rail, and Southern California ports has cemented its status as the epicenter for e-commerce and logistics in the Southwestern U.S. This critical connectivity, coupled with high demand from cold storage and food production users, ensures easy and efficient access to the massive, growing markets of California, Arizona, and Utah. North Las Vegas is the strategic choice for investors and businesses seeking growth, efficiency, and a competitive edge in the Western United States.

## Quick Facts



# Nevada Tax Advantages

## NEVADA

has always been a popular choice for businesses due to various factors such as low-cost startup, regulatory benefits, and competitive utility rates.

The Tax Climate Index rankings: California ranks 48th, Arizona 14th, Idaho 9th, Oregon 35th, and Utah 15th.

### Here are the main tax advantages of this state:

- No income tax
- No tax on pensions
- No tax on social security
- No tax on estate or inheritance
- Low property taxes
- No gross receipts tax
- No franchise tax
- No inventory tax
- No tax on issuance of corporate shares
- No tax on sale or transfer of shares

### Nevada Tax System:

Nevada is ranked 20th in the Tax Foundation's 2025 State Business Tax Climate Index, focusing on corporate taxes, individual income taxes, sales taxes, unemployment insurance taxes, and property taxes.

*Source: Nevada Governor's Office of Economic Development; www.TaxFoundation.org*

**MDLGroup**  
Service you deserve. People you trust.

**CORFAC**  
INTERNATIONAL  
MEMBER | PARTNER

## 2025 State Business Tax Climate Index

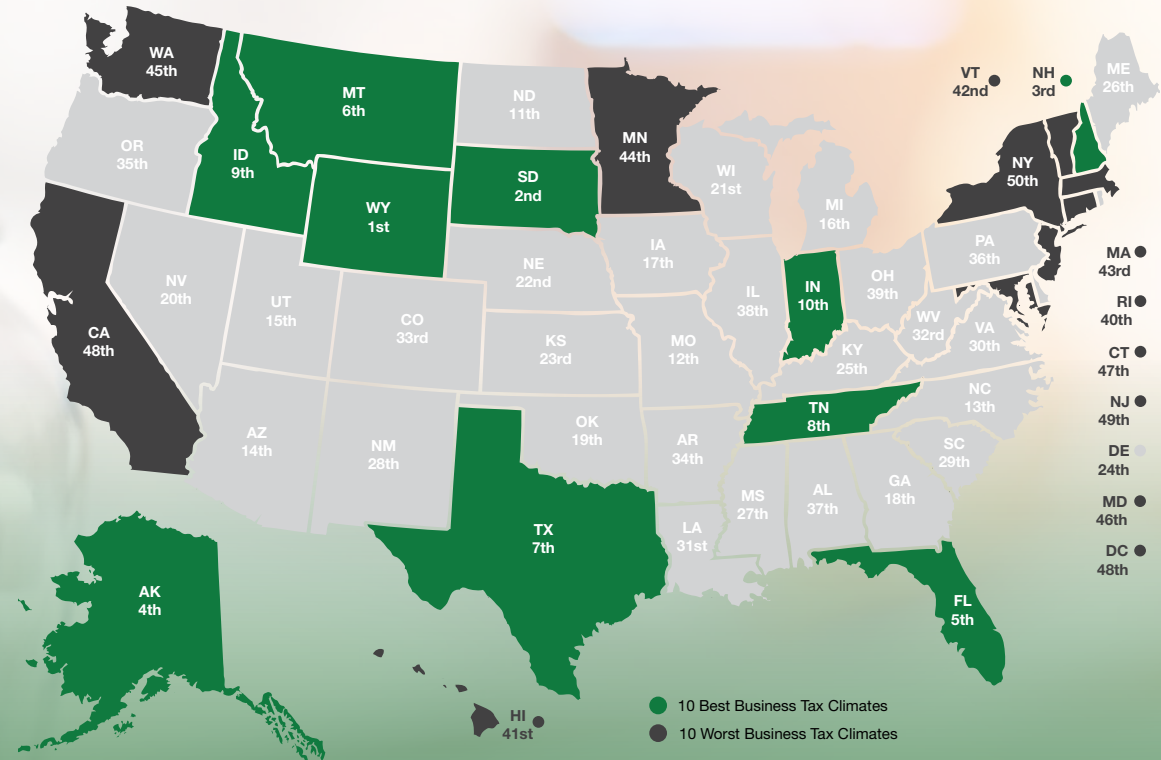

### Road Transportation

Las Vegas, and surrounding towns are less than one day's drive over arterial interstate highways to nearly 60 million consumers as well as to the major U.S. deep water seaports serving the Pacific Rim.



### Rail Transportation

Major Union Pacific and Southern Pacific rail connections in Las Vegas and Reno also, too, play an essential role in carrying the world's freight from the Pacific Coast to America's Heartland and beyond.



### Air Transportation

Globally, Harry Reid International Airport in Las Vegas has been a Top 20 airport for more than five years, annually serving more than 40 million and handling more than 189 million pounds of cargo.

5960 S. Jones Boulevard, Las Vegas, Nevada 89118  
(702) 388-1800 MAIN • (702) 388-1010 FAX  
www.mdlgroup.com

# Logistics

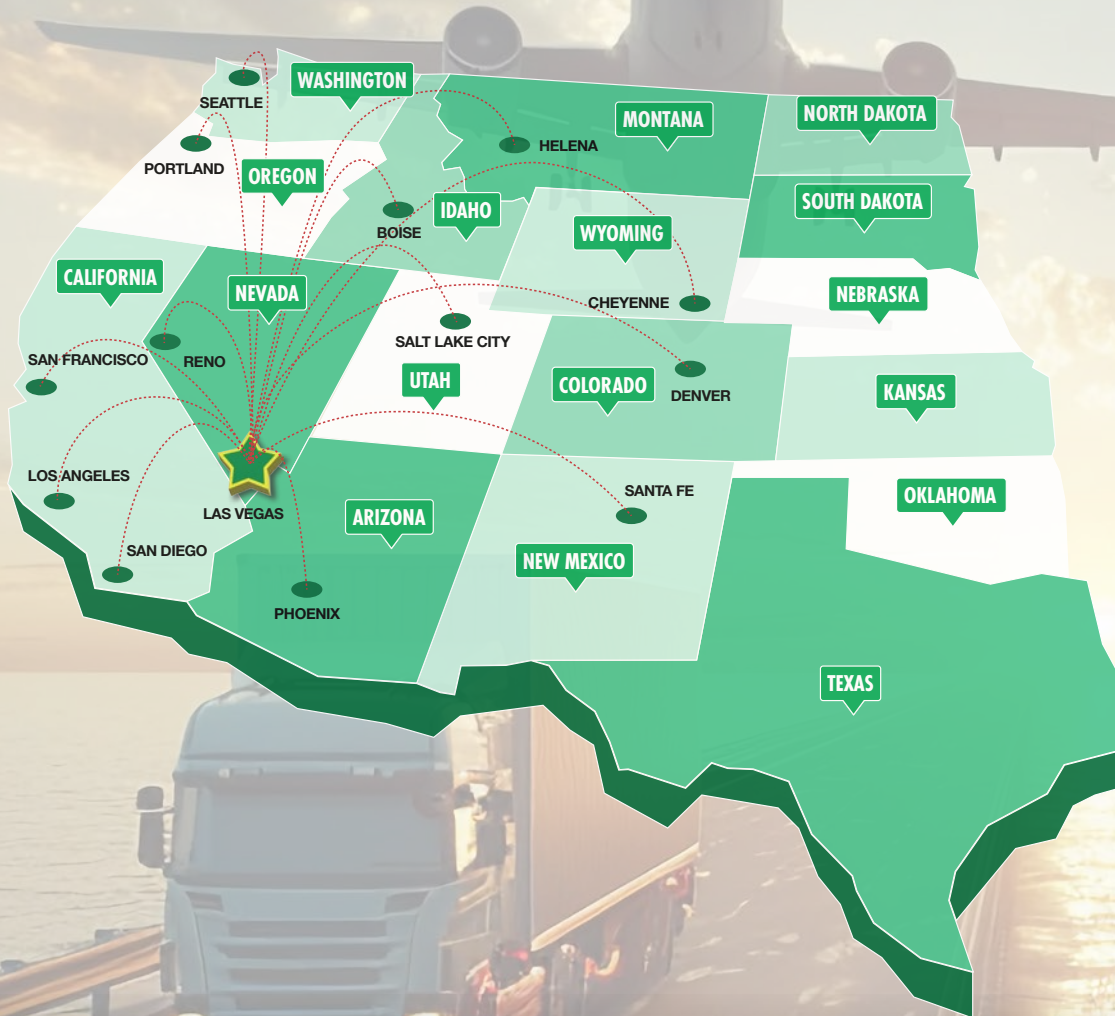

## Transit From Las Vegas

DESTINATION	EST. TRAVEL TIME	DISTANCE (MILES)
Los Angeles, CA	3 hrs, 55 min	±265
Phoenix, AZ	4 hrs, 40 min	±300
San Diego, CA	4 hrs, 45 min	±327
Salt Lake City, UT	5 hrs, 50 min	±424
Reno, NV	6 hrs, 55 min	±452
San Francisco, CA	8 hrs, 15 min	±565
Boise, ID	9 hrs, 30 min	±634
Santa Fe, NM	9 hrs, 10 min	±634
Denver, CO	10 hrs, 45 min	±752
Cheyenne, WY	11 hrs, 50 min	±837
Helena, MT	12 hrs, 55 min	±907
Portland, OR	15 hrs, 45 min	±982
Seattle, WA	16 hrs, 50 min	±1,129

### SHIPPING & MAILING SERVICES



Freight Service Center  
(3 miles)  
Distribution Center  
(10 miles)  
UPS Air Cargo  
(18 miles)



Freight Center  
(3 miles)  
Ship Center  
(8 miles)  
Air Cargo  
(20 miles)



Customer Service Center  
(5 miles)  
Cargo Center  
(3 miles)  
--

## Disclaimer

This package is provided to you by MDL Group and is intended solely for your limited use and benefit in determining whether you desire to express further interest in purchasing the property described in the attached documentation (the "Property"). The providing of "this package" to you and your use thereof is conditioned upon your agreement to the terms set forth below.

This package contains selected information pertaining to the Property. It does not purport to be a representation of the state of affairs of the current owner, nor should it be construed to contain all or part of the information which prospective investors would deem necessary to evaluate the Property for purchase. Any financial projections and information provided are for general reference purposes only, are based on assumptions relating to the general economy, market conditions, competition, and other factors beyond the control of the current owner and MDL Group. All projections, assumptions and other information provided herein are subject to material variation. MDL Group has not independently investigated the accuracy of the information within the package, as such information was obtained from the owner and/or public records. Additional information and an opportunity to inspect the Property will be made available to interested and qualified prospective purchasers.

Neither the owner, MDL Group, nor any of their respective directors, officers, agents, affiliates, or representatives make any representation or warranty, expressed or implied, as to the accuracy or completeness of the information contained within this package or any supplemental information provided after the delivery of this package to you, and no legal commitment or obligation shall arise by reason of your receipt of this package or use of its contents. Please also refer to the disclaimer at the bottom of each page of this package, which disclaimer is incorporated herein by reference.

You should understand and be advised that the owner of the Property expressly reserves the right, at their sole discretion, to reject any or all expressions of interest or offers to purchase the Property, and/or to terminate discussions with you or any other party at any time with or without notice which may arise as a result of this package. The owner shall have no legal commitment or obligation to you or any other party reviewing this package, nor shall the owner be required to accept an offer to purchase the Property unless and until written agreement(s) for the purchase of the Property have been fully executed, delivered, and approved by the Owner.

By receipt of "this package", you agree that the package and its contents are of a confidential nature, that you will hold and treat it in the strictest confidence and that you will not disclose the package or any of its contents to any other entity without the prior written authorization of owner. You also agree that you will not use the package or any of its contents in any manner detrimental to the interest of the owner or MDL Group.

This package describes certain documents including leases and other materials, which documents are described in summary form only. These summaries do not purport to be complete, nor necessarily accurate descriptions of the full agreements referenced. Interested parties are expected and advised to review all such summaries and other documents of whatever nature independently with legal counsel, tax and other professionals of their choice who have the expertise to assist in investigating this information in detail. You are therefore advised not to rely solely on the package as part of your investigations on this Property. If you have no interest in further pursuing this Property, please return this package to MDL Group.

*Although the information has been obtained from sources deemed reliable, Owner, MDL Group, and / or their representatives, brokers or agents make no guarantee as to the accuracy of the information contained herein, and offer the Property without express or implied warranties of any kind. The Property, Units and / or Rates may be withdrawn and/or changed without notice.*

## INVESTMENT SALES TEAM

### Jerdin Lindquist

Senior Associate

Lic#: BS.0146806

702.755.1528

[jlindquist@mdlgroup.com](mailto:jlindquist@mdlgroup.com)

### Myles Johnson

Advisor

Lic#: BS.1002160

702.600.3307

[mjohnson@mdlgroup.com](mailto:mjohnson@mdlgroup.com)

### Kenneth Arevalo

Associate

Lic#: BS.0146340.PLLC



702.773.0881

[karevalo@mdlgroup.com](mailto:karevalo@mdlgroup.com)

**MDL Group**  
Service you deserve. People you trust.

**CORFAC**  
INTERNATIONAL  
MEMBER | PARTNER

Copyright © MDL Group. All rights reserved.

 5960 S. Jones Boulevard, Las Vegas, Nevada 89118  
 (702) 388-1800 MAIN • (702) 388-1010 FAX  
 [www.mdlgroup.com](http://www.mdlgroup.com)



Service you deserve. People you trust.



LAS VEGAS, NEVADA



SALT LAKE CITY, UTAH



[WWW.MDLGROUP.COM](http://WWW.MDLGROUP.COM)

