

FOR LEASE

Rosecrans Center

3740 Rosecrans St | San Diego, CA 92110



Join Dainese Flagship San Diego Store

Retail Space Opportunity

1,050 SF - 4,126 SF

Able to Combine

DESCRIPTION

- Trophy hard corner for retail opportunity at one of San Diego's highest traffic count intersections
- Strategically located along established top performing retail arterial, with many national retailers immediately adjacent
- Dense population & strong daytime population (over 300,000 population within 5 miles radius)
- Well above average demographics with average household incomes of \$130,000+ within a 3 and 5 mile radius

2024 DEMOGRAPHICS

| | 1 Mile | 3 Miles | 5 Miles |
|----------------------|-----------|-----------|-----------|
| Population | 12,725 | 132,025 | 395,836 |
| Avg Household Income | \$122,805 | \$146,704 | \$139,079 |
| Daytime Population | 36,663 | 139,145 | 321,694 |

Source: Esri

TRAFFIC COUNTS

| | |
|-------------------|--------------------|
| Camino Del Rio W | approx. 53,200 cpd |
| Rosecrans St | approx. 19,900 cpd |
| Sports Arena Blvd | approx. 30,900 cpd |
| Kurtz St | approx. 11,000 cpd |

Source: Costar

CONTACT

Casey Mahony

949.698.1108 | casey.mahony@srsre.com
CA License No. 01886184

Adam Handfield

949.698.1109 | adam.handfield@srsre.com
CA License No. 01959419

© SRS Real Estate Partners

610 Newport Center Drive, Suite 1500
Newport Beach, CA 92660

The information presented was obtained from sources deemed reliable; however SRS Real Estate Partners does not guarantee its completeness or accuracy.

SRSRE.COM

Rosecrans Center

3740 Rosecrans St | San Diego, CA 92110



RETAIL SPACE AVAILABLE
1,050 SF – 4,126 SF

SPACE A: 3,076 SF
SPACE D: 1,050 SF

Able to Combine

PARKING:
30 Existing Spaces

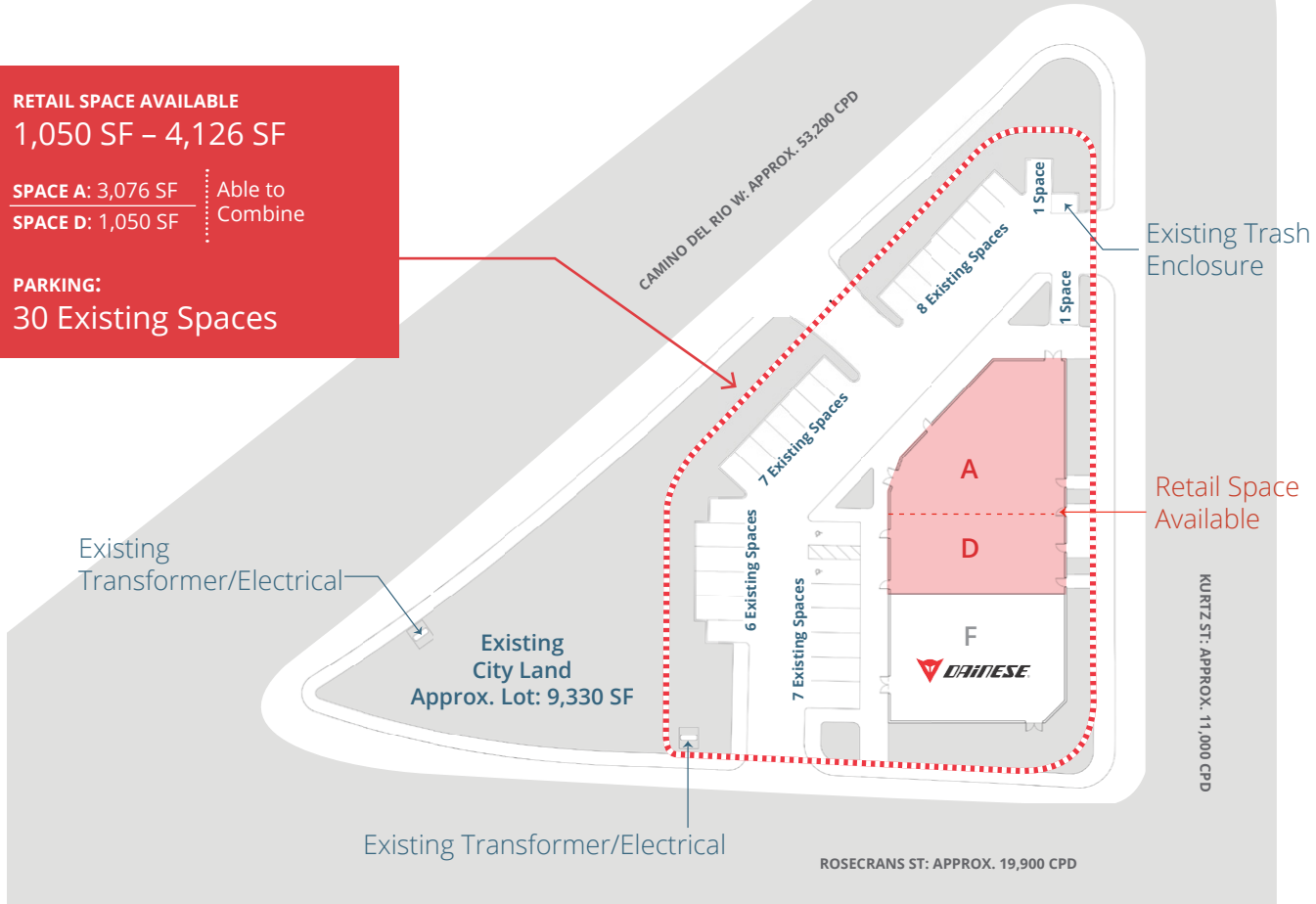

Rosecrans Center

3740 Rosecrans St | San Diego, CA 92110



RETAIL SPACE AVAILALBE

Contiguous up to 4,126 SF

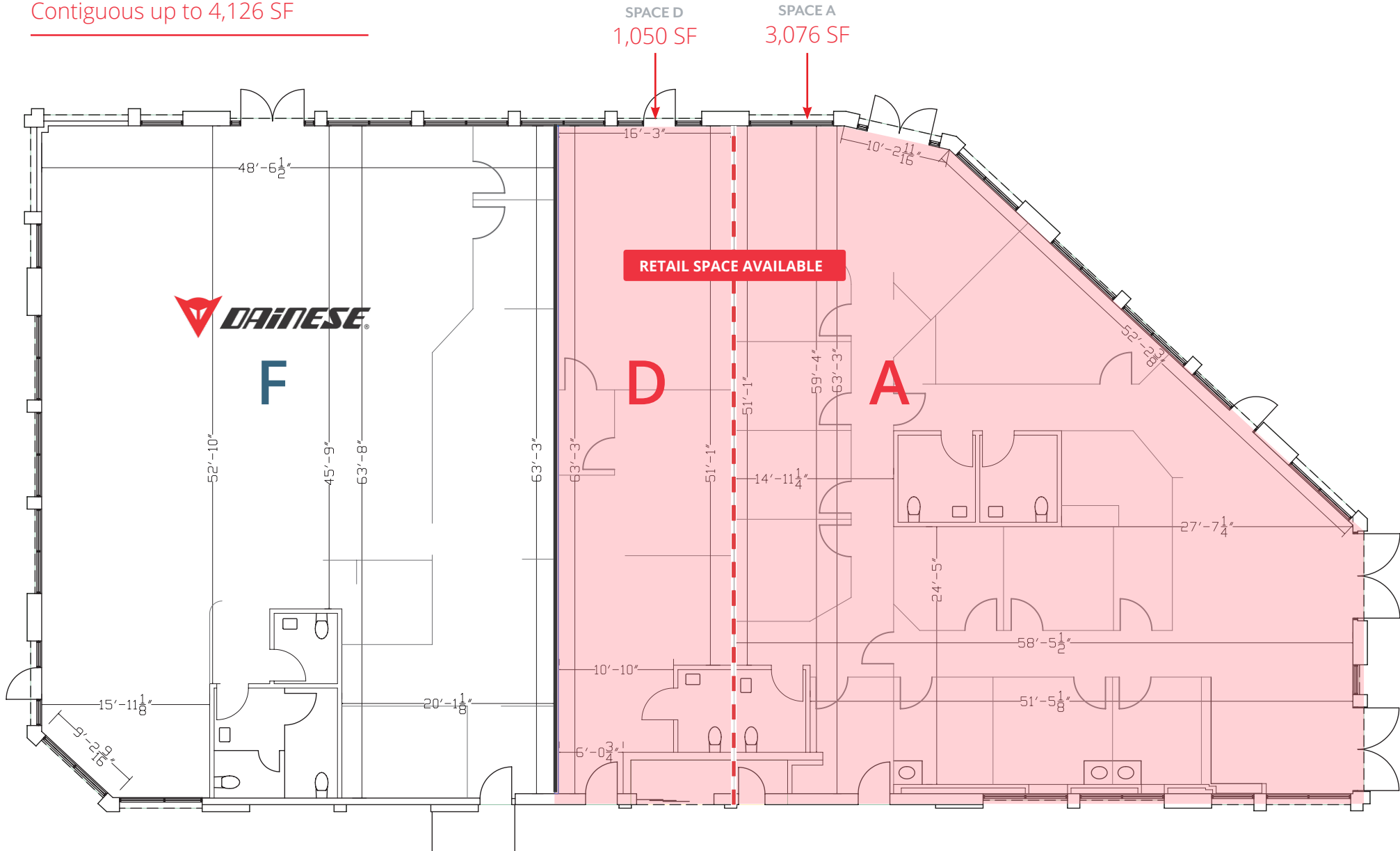

Rosecrans Center

3740 Rosecrans St | San Diego, CA 92110

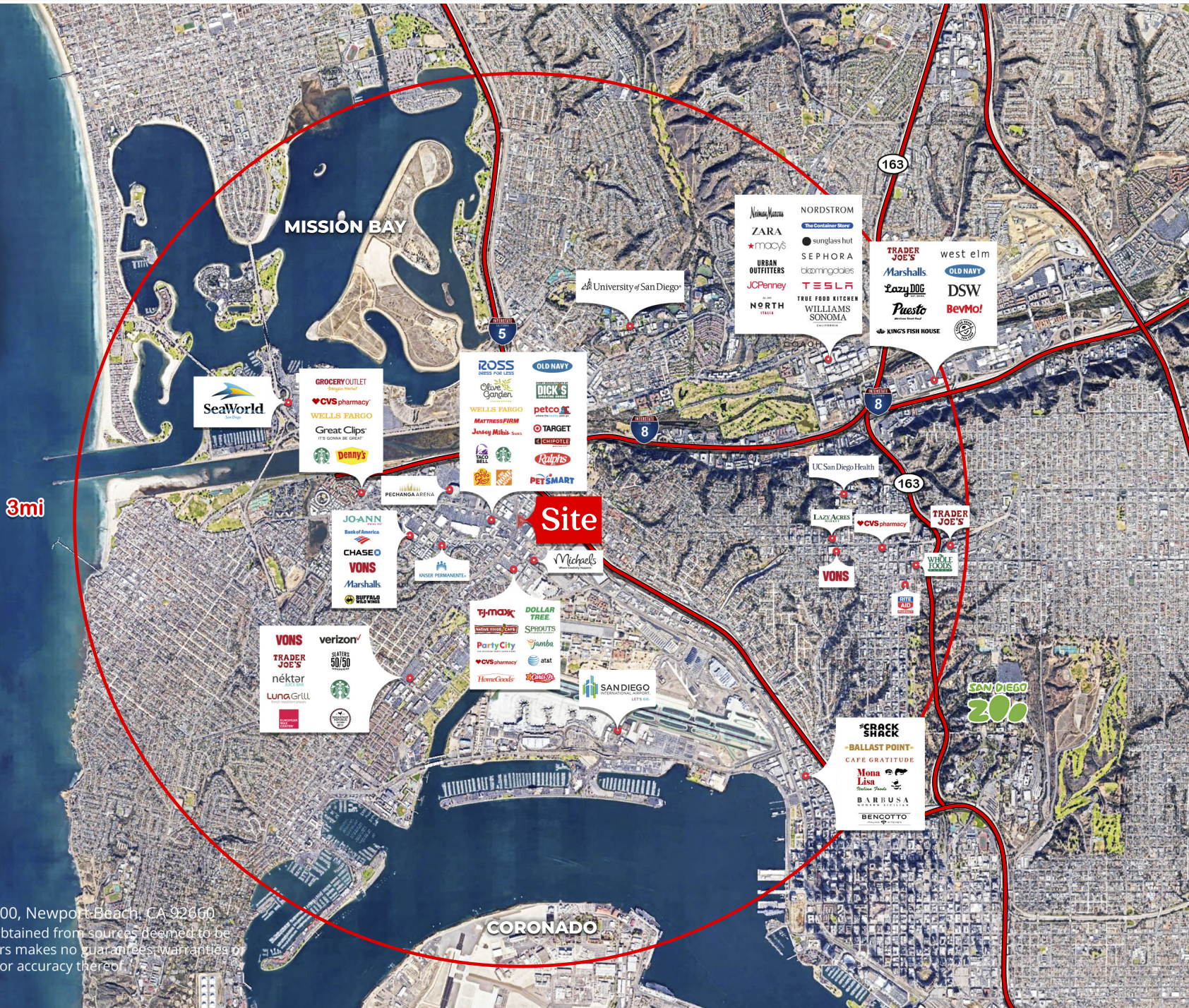

3mi

CONTACT

Casey Mahony

949.698.1108

casey.mahony@srsre.com

CA License No. 01886184

Adam Handfield

949.698.1109

adam.handfield@srsre.com

CA License No. 01959419



SRS REAL ESTATE PARTNERS

610 Newport Center Drive, Suite 1500, Newport Beach, CA 92660

This information contained herein was obtained from sources deemed to be reliable; however SRS Real Estate Partners makes no guarantees, warranties or representations as to the completeness or accuracy thereof.