

# BANK STREET CENTRE



IN THE CENTER OF DOWNTOWN SUMMIT, NJ



## NOW AVAILABLE FOR LEASE SUITE 208 aprox. 600sf

- **Bright and Airy on the Second Floor**
- **Quality Professional Building Overlooking Bank Street**
- **On-Site Building Management**
- **One Block to NJ Transit Station to NYC**
- **Three Blocks to Post Office, One Block to UPS and FedEx Store**
- **Four Blocks to Library and YMCA**
- **All the Amenities of Unparalleled Downtown Summit at your Fingertips**

**CONTACT PARAS AND PARAS  
FOR MORE INFORMATION AND SHOWINGS**



**BRANDON SNOOK**  
Realtor / Property Manager  
785-218-5143  
bsnook@parasandparas.com  
25 DeForest Ave, Summit, NJ 07901

**PARAS AND PARAS**  
Brokerage - Property Management - Appraisals - Expert Advice



**18-22 BANK STREET**

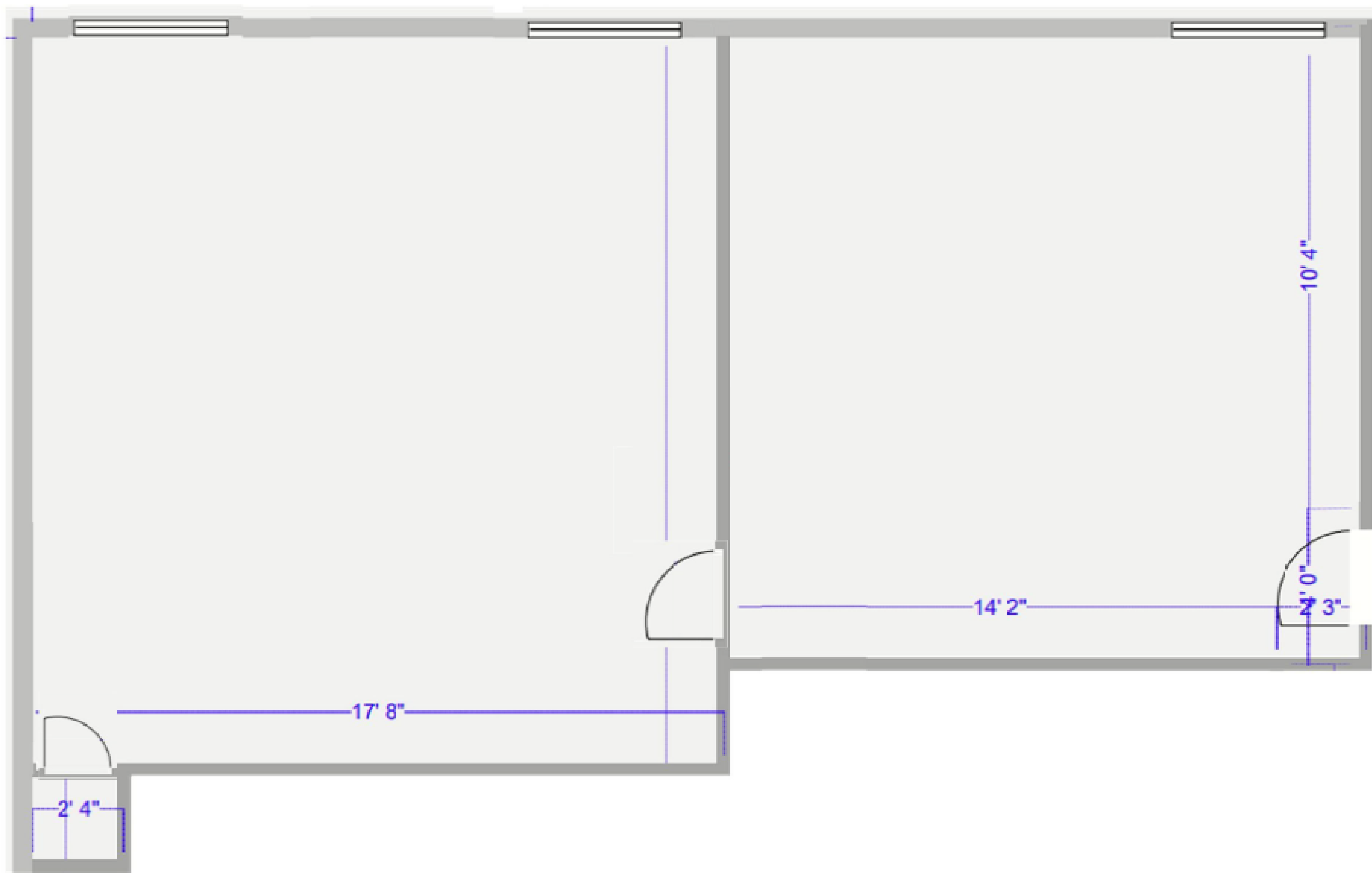

## SUITE 208 aprox. 600sf

- **Two Private Offices**
- **Vestibule Can be Added for Reception / Private Office Entry**
- **Move-In Ready**
- **Well-Suited for Attorneys, Consultants, and Corporate Satellites**

**CONTACT PARAS AND PARAS  
FOR MORE INFORMATION AND SHOWINGS**



**BRANDON SNOOK**

Realtor / Property Manager

785-218-5143

[bsnook@parasandparas.com](mailto:bsnook@parasandparas.com)

25 DeForest Ave, Summit, NJ 07901

**PARAS AND PARAS**

Brokerage - Property Management - Appraisals - Expert Advice



**18-22 BANK STREET**