

For Lease

1,833 SF
Office Space



Abele Business Park | Suite 801

10 Emerson Lane, Bridgeville, PA 15017

Property Features

Abele Business Park offers a variety of flexible workspace solutions within a welcoming campus setting encompassing over 300,000 square feet of office and flex products.

- Dedicated Client Experience Team
- Exclusive Access to Partner Perks Program
- Private Entrance
- Free Parking
- Built-To-Suit Options
- Daycare in Park
- Convenient Accessibility from I-79 (Bridgeville Exit)



Joe Sheerer

+1 412 925 8356 • jsheerer@naiburnsscalo.com

Gus Scalo

+1 412 721 7713 • gscalo@naiburnsscalo.com

NAI Burns Scalo

COMMERCIAL REAL ESTATE SERVICES, WORLDWIDE

Suite 801 Floor Plan

- 1,833 SF
- 5 Private Offices
- Conference Room
- Reception Area
- Cafe
- Private Restrooms

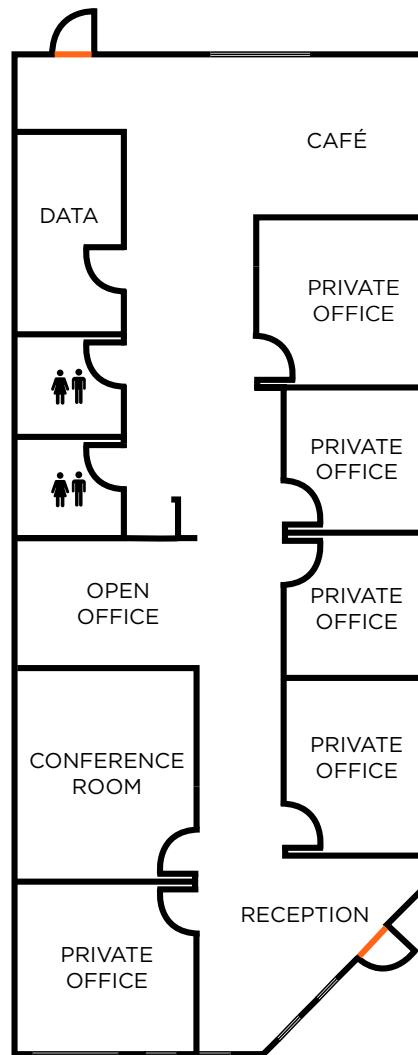

Nearby Amenities

