

7467 Ridge Road

Hanover, MD

Class A Office / For Sublease



12,329 CONTIGUOUS SF AVAILABLE FOR SUBLEASE ON THE 2ND FLOOR

- Suite 250 – 8,181 RSF (through 5/31/25)
- Suite 270 – 4,448 RSF (through 7/31/26)

SUBLEASE HIGHLIGHTS

- Two (2) separate sublease suites
- High-end office finishes
- Easy access from Route 100 and in close proximity to I-95, I-97, and Route 32
- Abundant amenities within minutes including Arundel Mills and BWI

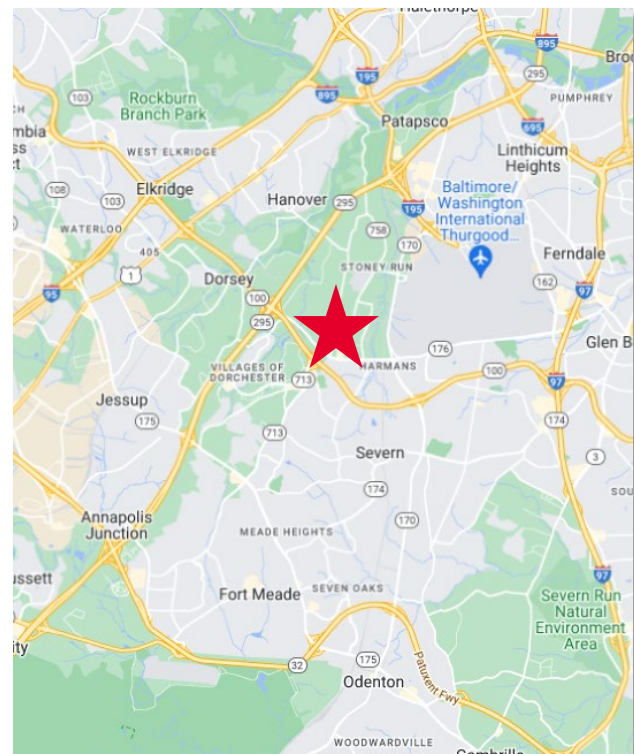

Scott Matthews / scott.matthews@cushwake.com / +1 410 953 6697

Charlie Fenwick / charles.fenwick@cushwake.com / +1 410 953 6693

CUSHMANWAKEFIELD.COM

Cushman & Wakefield Copyright 2023. No warranty or representation, express or implied, is made to the accuracy or completeness of the information contained herein, and same is submitted subject to errors, omissions, change of price, rental or other conditions, withdrawal without notice, and to any special listing conditions imposed by the property owner(s). As applicable, we make no representation as to the condition of the property (or properties) in question.



7467 Ridge Road

Hanover, MD

Class A Office / For Sublease

FLOORPLAN

SECOND FLOOR
12,329 CONTIGUOUS
SF AVAILABLE

8,181 SF
LED 5/31/2025

4,448 SF
LED 7/31/2026

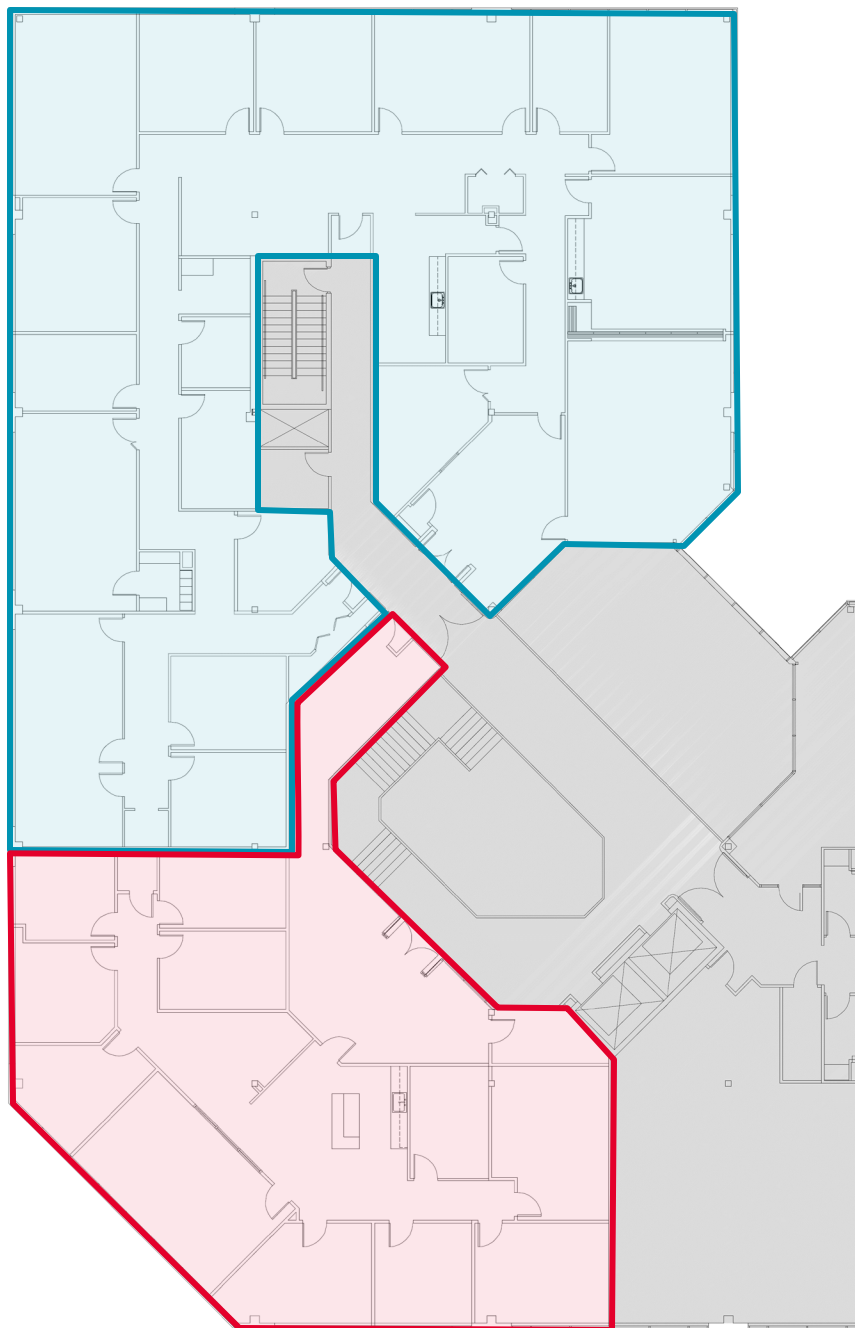

Scott Matthews / scott.matthews@cushwake.com / +1 410 953 6697

Charlie Fenwick / charles.fenwick@cushwake.com / +1 410 953 6693

CUSHMANWAKEFIELD.COM

Cushman & Wakefield Copyright 2023. No warranty or representation, express or implied, is made to the accuracy or completeness of the information contained herein, and same is submitted subject to errors, omissions, change of price, rental or other conditions, withdrawal without notice, and to any special listing conditions imposed by the property owner(s). As applicable, we make no representation as to the condition of the property (or properties) in question.

