



**FOR LEASE**  
**+28,265 SF INDUSTRIAL SPACE**

**22420-C TEMESCAL CANYON RD | CORONA, CA 92883**



**LAWRENCE C. NULL, SIOR | SENIOR VICE PRESIDENT**

951.276.3616 | [lnull@leeriverside.com](mailto:lnull@leeriverside.com)

DRE# 00822133

**JUSTIN NULL, SIOR | VICE PRESIDENT**

951.276.3634 | [jnull@leeriverside.com](mailto:jnull@leeriverside.com)

DRE# 01899025

# FLOOR PLAN & BUILDING FEATURES

## BUILDING FEATURES

- Located in Wildrose Business Park
- Rear Portion of Larger 198,030 SF Building
- ±2,200 SF Ground Floor Office Space
- One (1) Extra Wide Ground Level Door (24' x 14')
- Four (4) Dock High Doors
- 400 Amps; 277/480 Volts (Verify)
- ESFR Fire Sprinkler System
- 2 Restrooms
- 30' Clear Height in Warehouse
- Gated, Concrete Truck Court
- MSC Zoning



Broker Contacts: Lawrence C. Null, SIOR, 951.276.3616, DRE #00822133 | Justin Null, SIOR, 951.276.3634, DRE #01899025

LEE & ASSOCIATES, INC. - RIVERSIDE | 4193 FLAT ROCK DRIVE, SUITE 100 | RIVERSIDE, CA 92505

No warranty or representation has been made as to the accuracy of the foregoing information. Terms of sale or lease and availability are subject to change or withdrawal without notice. Corporate DRE #01048055

# SITE PLAN

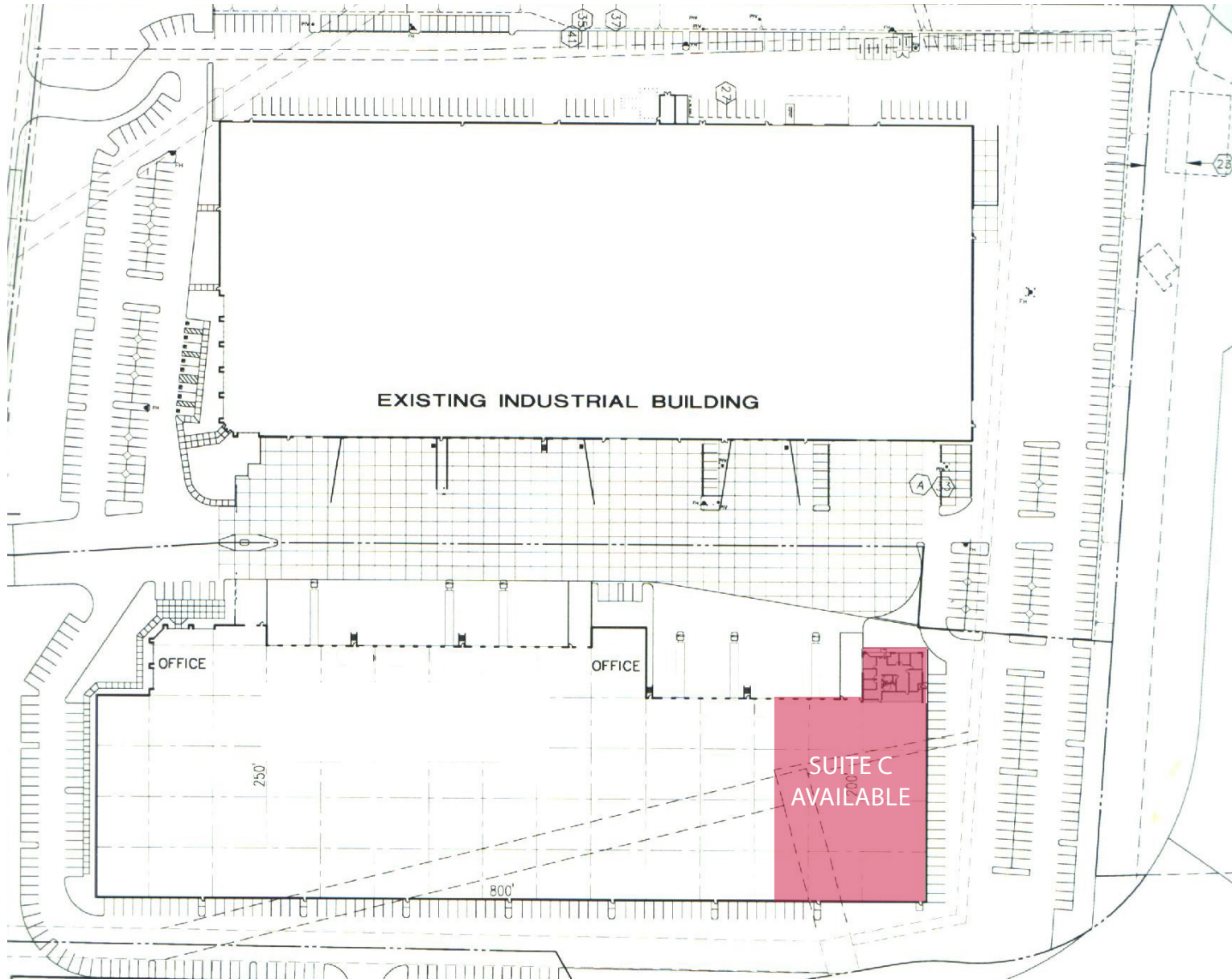

Broker Contacts: Lawrence C. Null, SIOR, 951.276.3616, DRE #00822133 | Justin Null, SIOR, 951.276.3634, DRE #01899025

LEE & ASSOCIATES, INC. - RIVERSIDE | 4193 FLAT ROCK DRIVE, SUITE 100 | RIVERSIDE, CA 92505

No warranty or representation has been made as to the accuracy of the foregoing information. Terms of sale or lease and availability are subject to change or withdrawal without notice. Corporate DRE #01048055

# PROPERTY PHOTOS



Broker Contacts: Lawrence C. Null, SIOR, 951.276.3616, DRE #00822133 | Justin Null, SIOR, 951.276.3634, DRE #01899025

LEE & ASSOCIATES, INC. - RIVERSIDE | 4193 FLAT ROCK DRIVE, SUITE 100 | RIVERSIDE, CA 92505

No warranty or representation has been made as to the accuracy of the foregoing information. Terms of sale or lease and availability are subject to change or withdrawal without notice. Corporate DRE #01048055

# PROPERTY AERIAL

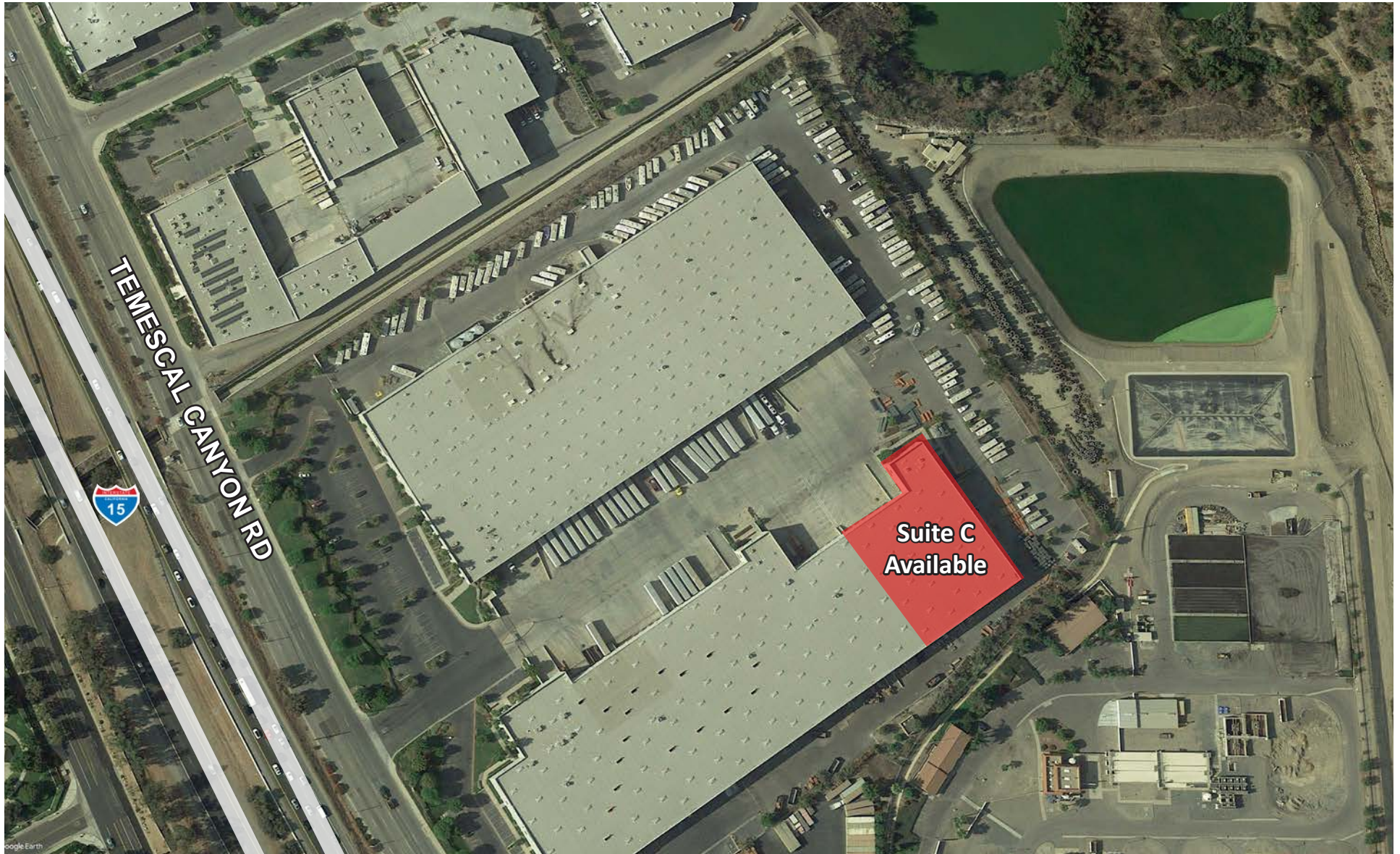

Broker Contacts: Lawrence C. Null, SIOR, 951.276.3616, DRE #00822133 | Justin Null, SIOR, 951.276.3634, DRE #01899025

LEE & ASSOCIATES, INC. - RIVERSIDE | 4193 FLAT ROCK DRIVE, SUITE 100 | RIVERSIDE, CA 92505

No warranty or representation has been made as to the accuracy of the foregoing information. Terms of sale or lease and availability are subject to change or withdrawal without notice. Corporate DRE #01048055

# LOCATION MAP

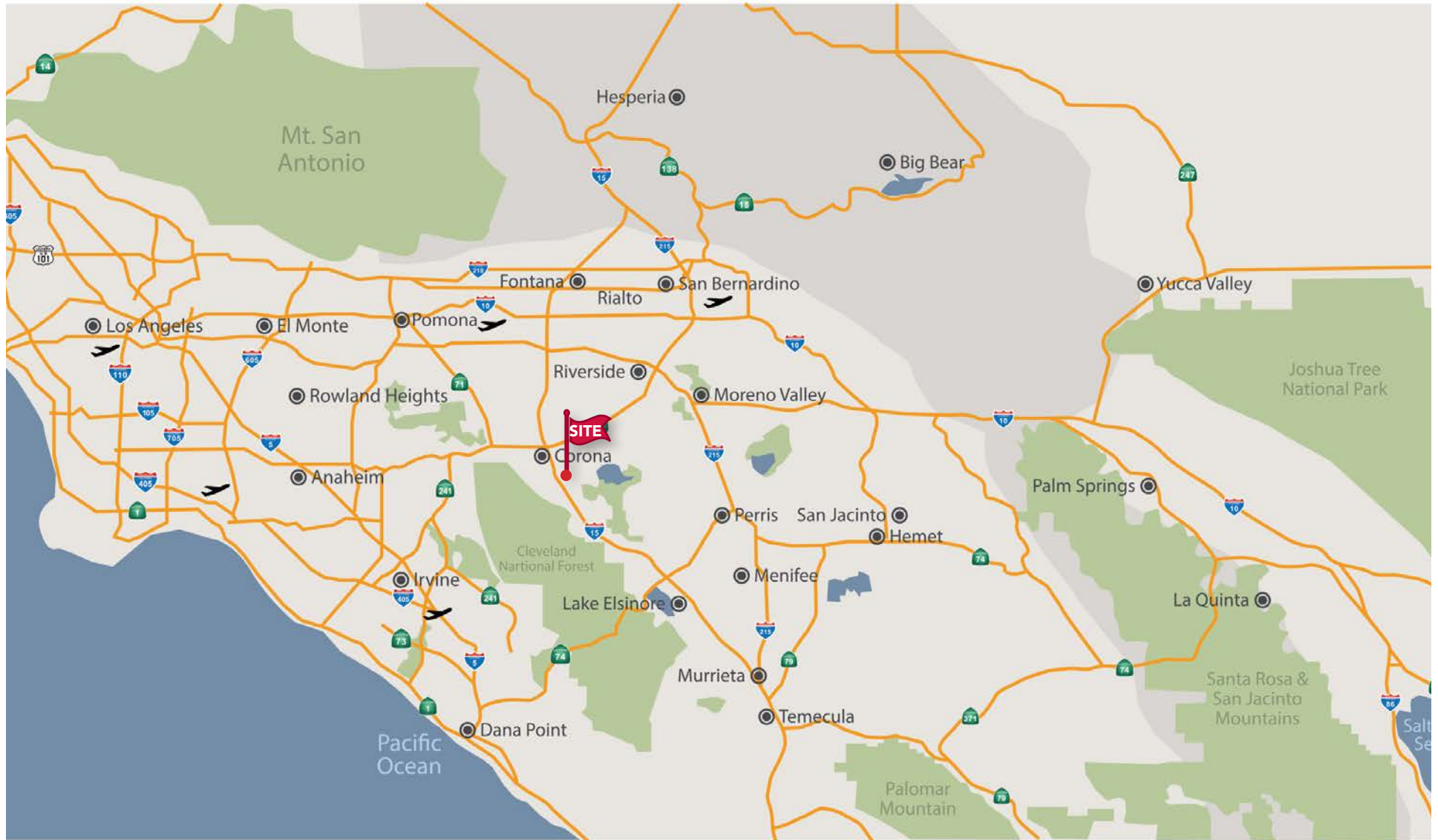

Broker Contacts: Lawrence C. Null, SIOR, 951.276.3616, DRE #00822133 | Justin Null, SIOR, 951.276.3634, DRE #01899025

LEE & ASSOCIATES, INC. - RIVERSIDE | 4193 FLAT ROCK DRIVE, SUITE 100 | RIVERSIDE, CA 92505

No warranty or representation has been made as to the accuracy of the foregoing information. Terms of sale or lease and availability are subject to change or withdrawal without notice. Corporate DRE #01048055